

**INDEX OF SHEETS**

TITLE SHEET	1
TYPICAL SECTIONS	2
QUANTITY SHEET	3
ITEM DETAIL & DRAINAGE SHEET	4
EARTHWORKS	5
PROJECT PLAN	5-7
PROJECT PROFILE	8
PAVEMENT MARKING PLAN	9
SIGNING PLAN	10
STREET LIGHTING PLAN	11-12
LANDSCAPING AND EROSION CONTROL PLAN	13
TRAFFIC SIGN SUMMARY SHEET	14
PAVEMENT MARKING AND SIGNING DETAILS	15
STREET LIGHTING NOTES AND DETAILS	16
SHELTER AND BICYCLE RACK DETAILS	17
CROSS SECTIONS	18-22

**STANDARDS**

B-5	SLOPE GRADING, EMBANKMENTS	06-01-94
B-71	COMMERCIAL DRIVES	03-10-95
C-1	CAST-IN-PLACE CONCRETE CURB	06-01-94
D-2	UNDERDRAIN & CARRIER PIPE CONSTRUCTION DETAILS	06-01-94
D-3	TREATED GUTTERS	06-01-94
D-4	UNDERDRAIN FLUSHING BASIN	06-01-94
D-20	HIGHWAY CROSSING FOR UNDERGROUND UTILITIES	03-10-95
E-100	CONSTRUCTION APPROACH SIGNS	08-08-95
E-101	CONSTRUCTION SIGN DETAILS	08-08-95
E-102	CONSTRUCTION SIGN DETAILS	08-08-95
E-106	TRAFFIC CONTROL - MISCELLANEOUS DETAILS	08-08-95
E-107	DELINEATION, BARRICADES AND DETOURS FOR CONSTRUCTION AREAS	08-08-95
E-107A	BREAKAWAY BARRICADE DETAILS	08-08-95
E-110	MAJOR MAINTENANCE OPERATION LANE CLOSURE	08-08-95
E-121	STANDARD SIGN PLACEMENT - CONVENTIONAL ROAD	08-08-95
E-132	GENERAL MOTORIST SERVICE - SIGN DETAILS	08-18-95
E-143	REGULATORY SIGN DETAILS	09-20-95
E-144	REGULATORY SIGN DETAILS	09-20-95
E-160	FLANGED CHANNEL STEEL SIGN POST DETAIL	08-18-95
E-175	POWER DROP STANCHIONS	11-17-93
E-180A	STREET LIGHTING DETAILS	08-09-95
E-180B	STREET LIGHTING DETAILS	08-09-95
E-191	PAVEMENT MARKING DETAILS	08-18-95
E-193	PAVEMENT MARKING DETAILS	08-18-95
F-2	CHAIN-LINK FENCE, TYPE I	06-01-94
G-1	STEEL BEAM GUARDRAIL	06-01-94
G-4	STEEL MARKER POSTS	06-01-94
G-17a	MODIFIED ECCENTRIC LOADER TERMINAL W/ WOOD POSTS	01-18-96
G-17b	MODIFIED ECCENTRIC LOADER TERMINAL W/ WOOD POSTS	06-30-95
J-5	BRACING OF TREES	12-19-72
T-2	TEMPORARY EROSION CONTROL DETAILS	06-01-94

# STATE OF VERMONT AGENCY OF TRANSPORTATION



## PROPOSED IMPROVEMENT TOWN OF RICHMOND COUNTY OF CHITTENDEN COMMUTER PARKING LOT

THIS PROJECT IS LOCATED ON US RTE. 2, IN THE TOWN OF RICHMOND,  
APPROXIMATELY 250 m SOUTHERLY OF THE VT. RTE. 117/US RTE. 2 INTERSECTION,  
ON THE EASTERLY SIDE OF US RTE 2, AT I-89 (INTERCHANGE #11).

WORK ON THIS PROJECT CONSISTS OF CONSTRUCTION OF A NEW LOT, WHICH WILL INCLUDE  
SUBBASE, PAVEMENT, PAVEMENT MARKINGS, STREET LIGHTING, AND MISCELLANEOUS APPURTENANCES.

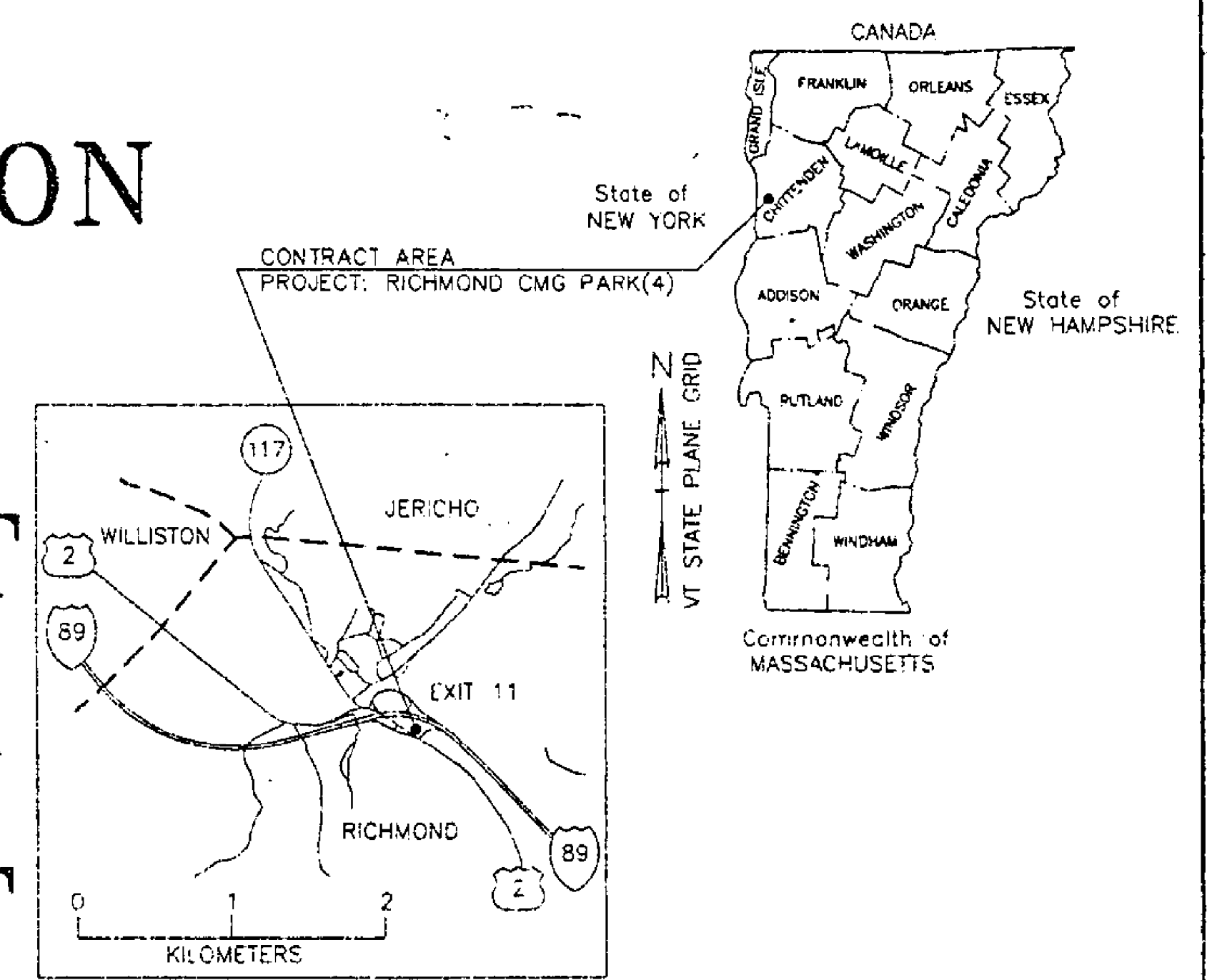

**CONTRACT PLANS**  
THESE PLANS DO NOT REFLECT  
CHANGES MADE ON THE PROJECT.

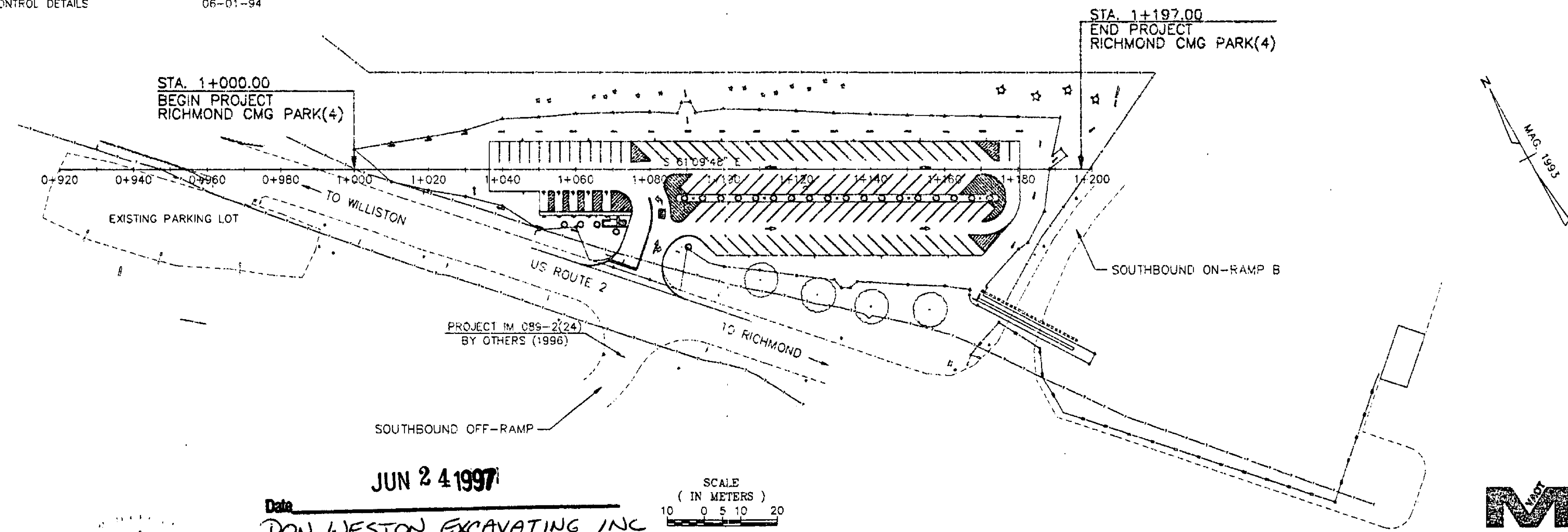

**CONVENTIONAL SIGNS**

COUNTY LINE	---
TOWN LINE	- - - -
LIMITS OF ACCESS	—○—○—
POINT OF ACCESS	—○— X
FENCE LINE	—x—x—
STONE WALL	—o—o—o—
TRAVELED WAY	— — — —
GUARD RAIL	—o—o—o—
RAILROAD	—+—+—+—
SURVEY LINE	—+—+—+—
CULVERT	—+—+—+—
POWER POLE	—○—
TELEPHONE POLE	—○—
TREES	—*—*—*—
CONTROL OF ACCESS	—/—/—/—
PROPERTY LINE	— — — —
R.O.W. TAKING LINE	— — — —
SLOPE RIGHTS	—○—
TOP OF CUT	—△—
TOE OF SLOPE	—○—

**DATUM**

VERTICAL	NAVD88 (meters)
HORIZONTAL	N/A

**JUN 24 1997**

Date \_\_\_\_\_  
**DON WESTON EXCAVATING INC**  
 Contractor  
*Don Weston*  
 Signature  
**PREG**  
 Title  
*Glen Giesler*  
 Secretary of Transportation's Signature

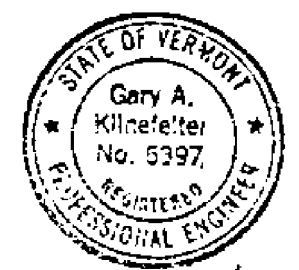
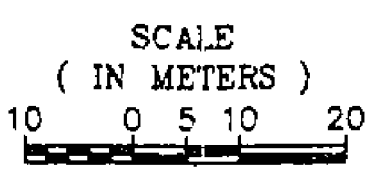

*Gary A. Klinefelter*  
 Vermont Survey and Engineering, Inc.  
 79 RIVER STREET - MONTPELIER, VT

THESE PLANS ARE SUBJECT TO SUCH ENGINEERING CHANGES AS MAY BE REQUIRED BY THE FEDERAL HIGHWAY ADMINISTRATION OR THE CHIEF ENGINEER. CONSTRUCTION IS TO BE CARRIED ON IN ACCORDANCE WITH THESE PLANS AND THE STANDARD SPECIFICATIONS FOR CONSTRUCTION DATED 1995, AS APPROVED BY THE FEDERAL HIGHWAY ADMINISTRATION ON AUGUST 21, 1995 FOR USE ON THIS PROJECT, INCLUDING ALL SUBSEQUENT REVISIONS AND SUCH REVISED SPECIFICATIONS AND SPECIAL PROVISIONS AS ARE INCORPORATED IN THESE PLANS.

**Metric**

APPROVED <i>[Signature]</i> DATE 4/1/97 DIRECTOR OF ENGINEERING
DEPARTMENT OF TRANSPORTATION FEDERAL HIGHWAY ADMINISTRATION
APPROVED _____ DATE _____ DIVISION ADMINISTRATOR
PROJECT RICHMOND CMG PARK(4)
SHEET 1 OF 22 SHEETS