

VT ROUTE 15 18+22.74-46.50' LT
MAST ARM POLE #4

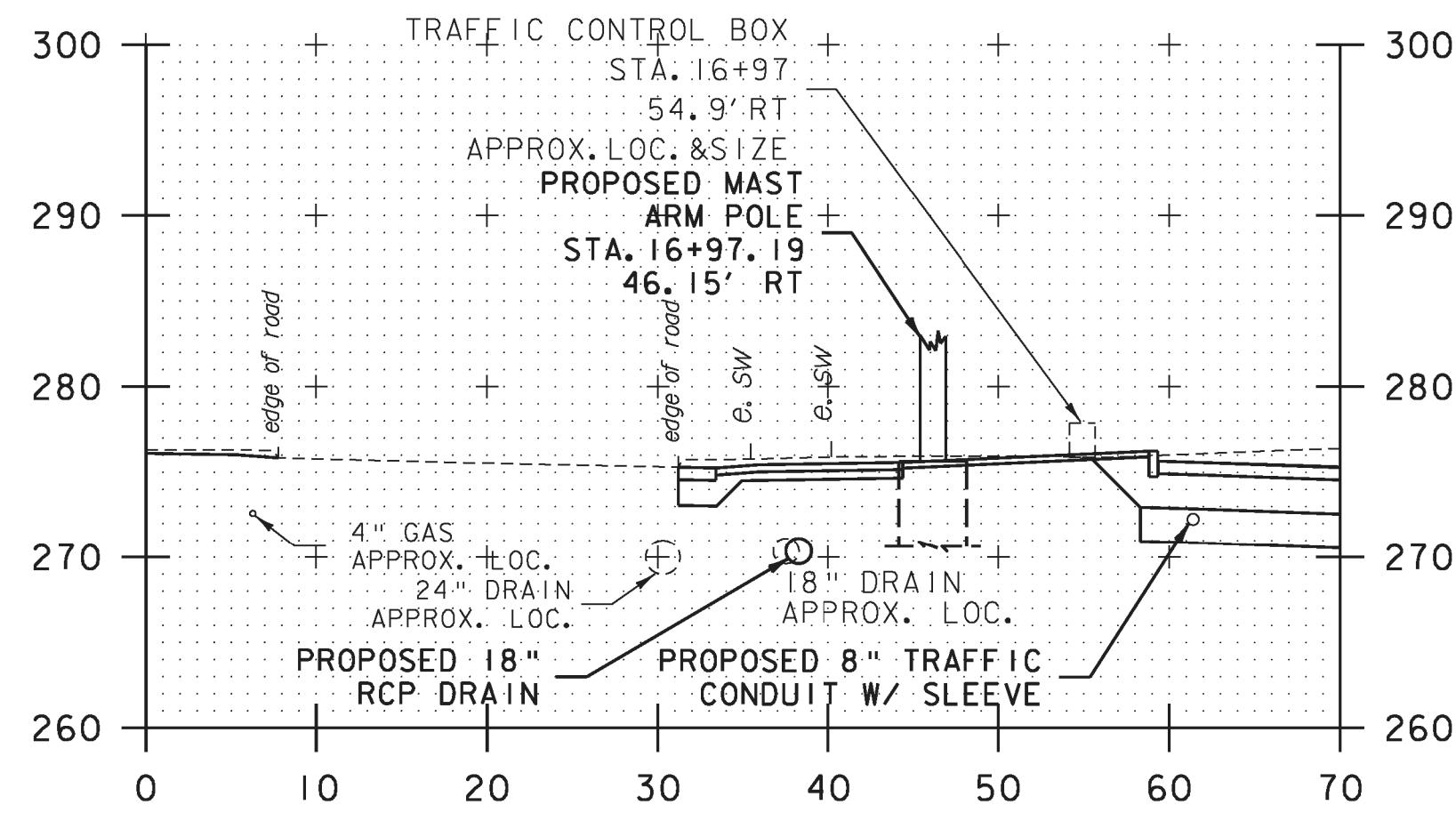

VT ROUTE 15 16+97.17-46.15' RT
MAST ARM POLE #2

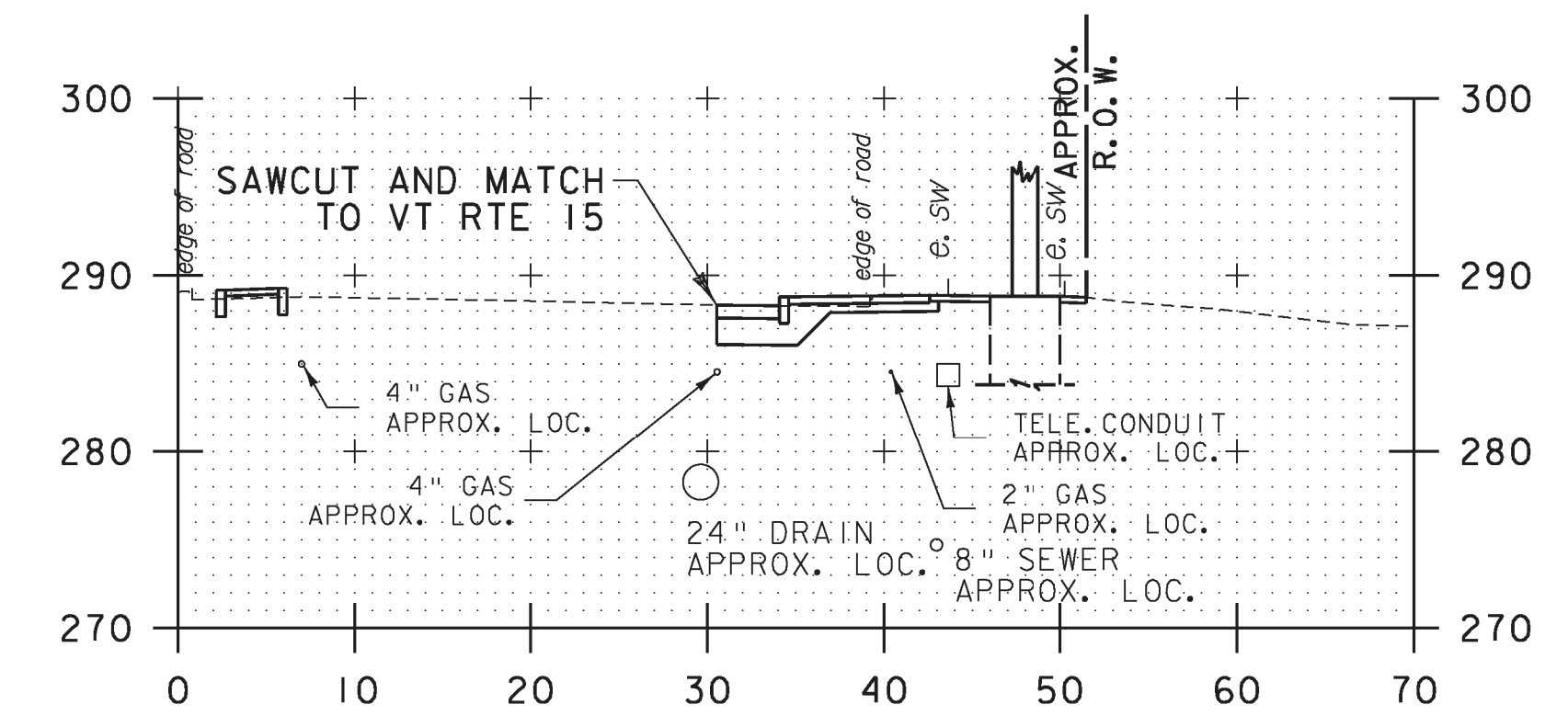

VT ROUTE 15 18+93.83-47.42' RT
MAST ARM POLE #5

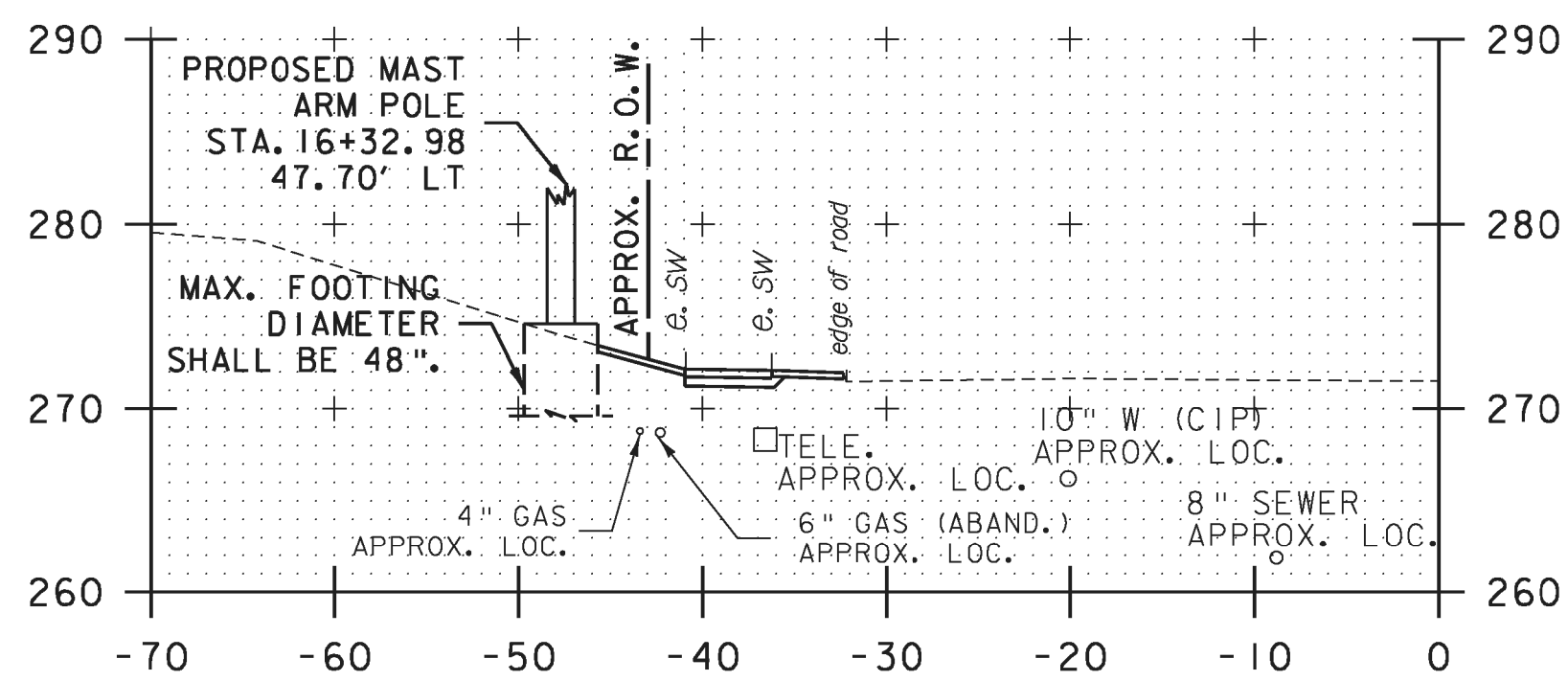

VT ROUTE 15 16+32.98-47.70' LT
MAST ARM POLE #1

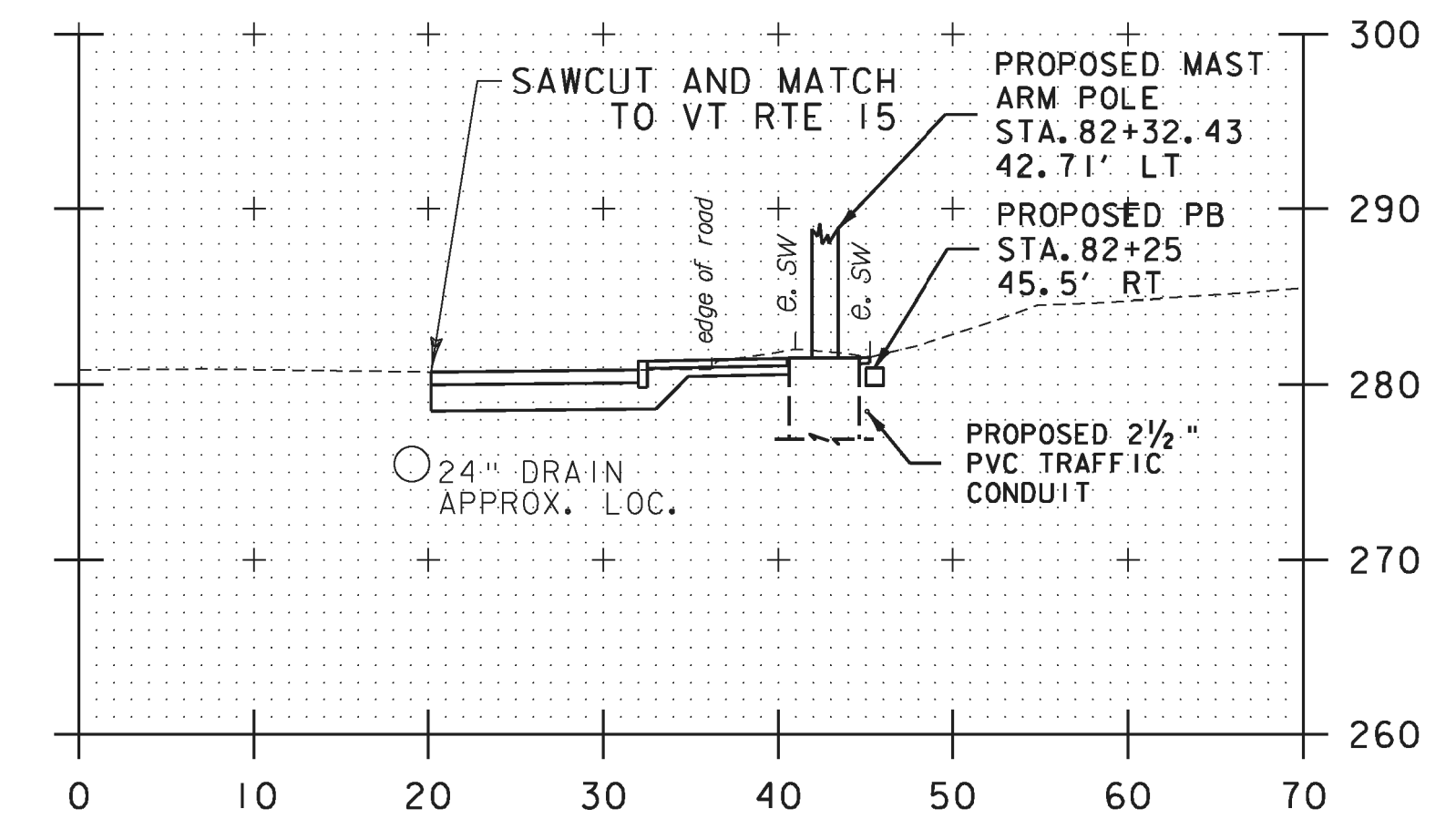

RAMP "B" SLIP RAMP 82+19.06-42.62' RT
MAST ARM POLE #3

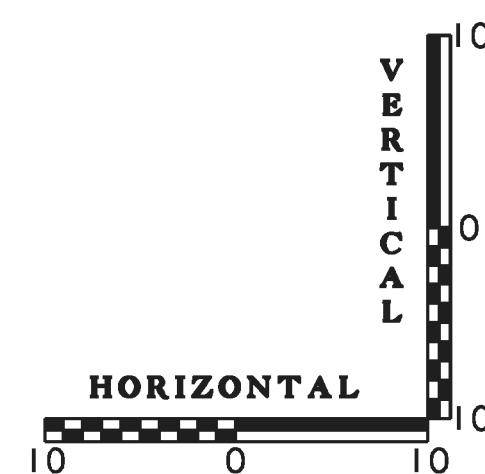

GENERAL NOTES:

- 1) EXCEPT FOR MP#1 AND MP#4, THE DIAMETER OF MAST ARM FOUNDATIONS ARE SHOWN FOR GRAPHICAL REPRESENTATION ONLY. REFER TO THE GEOTECHNICAL REPORT FOR FOUNDATION REQUIREMENTS.
- 2) STATION AND OFFSETS INDICATED ARE TO THE CENTER OF THE MAST ARM FOUNDATION.
- 3) THE LOCATIONS AND DEPTHS OF EXISTING GAS, SEWER, TELEPHONE AND WATER LINES SHOWN IN THE SECTIONS ARE APPROXIMATE. THE CONTRACTOR SHALL FIELD VERIFY ALL UTILITY LOCATIONS.

PROJECT NAME: WINOOSKI
PROJECT NUMBER: NH 089-3(65)

FILE NAME: z94c198xsl.dgn
PROJECT LEADER: KEN UPMAL
DESIGNED BY: T.BIGELOW
CROSS SECTIONS AT MAST-ARMS

PLOT DATE: 2/26/2010
DRAWN BY: T.BIGELOW
CHECKED BY: E.ATKINS
SHEET 67 OF 67