

LABEL	BEGIN		END		RADIUS (ft)	LENGTH (ft)
	STA.	OFFSET (ft)	STA.	OFFSET (ft)		
C1	VT ROUTE 15 16+82.91 LT	35.99	VT ROUTE 15 16+87.75 LT	32.32	5.00	6.52
L1	VT ROUTE 15 16+87.75 LT	32.32	VT ROUTE 15 16+93.36 LT	32.34	NA	5.61
L2	VT ROUTE 15 16+98.39 LT	32.36	VT ROUTE 15 17+10.00 LT	32.37	NA	11.60
C2	VT ROUTE 15 20+29.63 LT	38.93	VT ROUTE 15 20+33.65 LT	43.41	30.00	6.14
C3	VT ROUTE 15 20+36.19 LT	47.65	VT ROUTE 15 20+38.80 LT	55.44	30.00	8.29
L3	VT ROUTE 15 20+38.80 LT	55.44	VT ROUTE 15 20+39.38 LT	61.10	NA	5.69
L4	VT ROUTE 15 16+24.63 RT	31.64	VT ROUTE 15 16+38.18 RT	31.54	NA	13.55
C4	VT ROUTE 15 16+38.18 RT	31.54	VT ROUTE 15 16+43.17 RT	35.85	5.00	7.20
C5	RAMP "B" 59+18.63 LT	14.00	RAMP "B" 59+54.01 LT	14.00	486.00	34.39
L5	RAMP "B" 59+00.00 LT	14.00	RAMP "B" 59+18.63 LT	14.00	NA	18.63
C6	VT ROUTE 15 16+65.62 RT	36.40	VT ROUTE 15 16+70.21 LT	33.40	5.00	5.80
L6	VT ROUTE 15 16+70.21 RT	33.40	VT ROUTE 15 16+94.90 RT	33.38	NA	24.69
L7	VT ROUTE 15 16+99.90 RT	33.38	VT ROUTE 15 17+21.27 RT	33.36	NA	21.38
C7	VT ROUTE 15 17+21.27 RT	33.36	VT ROUTE 15 17+23.00 RT	36.36	2.00	4.19
C8	SLIP RAMP 80+97.00 LT	2.00	SLIP RAMP 81+50.35 LT	2.00	194.00	53.91
C9	SLIP RAMP 80+75.23 LT	2.00	SLIP RAMP 81+97.00 LT	2.00	1000.00	22.06
C10	RAMP "B" 58+96.29 RT	11.77	RAMP "B" 58+97.22 RT	8.00	2.00	5.32
L8	RAMP "B" 58+97.22 RT	8.00	RAMP "B" 59+18.63 RT	8.00	NA	21.42

LABEL	BEGIN		END		RADIUS (ft)	LENGTH (ft)
	STA.	OFFSET (ft)	STA.	OFFSET (ft)		
C11	RAMP "B" 59+18.63 RT	8.00	RAMP "B" 59+53.87 RT	8.00	508.00	35.80
C12	SLIP RAMP 80+00.00 RT	32.00	SLIP RAMP 81+55.89 RT	32.00	160.00	129.91
C13	SLIP RAMP " 81+62.23 RT	32.00	VT ROUTE 15 18+22.22 RT	33.64	160.00	86.21
C14	VT ROUTE 15 18+22.22 RT	33.64	VT ROUTE 15 18+44.98 RT	43.94	25.00	26.17
C15	ROLAND CT 29+34.56 LT	12.32	ROLAND CT 29+48.36 LT	16.48	25.00	14.62
L9	ROLAND CT 29+15.00 LT	12.31	ROLAND CT 29+34.56 LT	12.32	NA	19.56
L10	ROLAND CT 29+15.00 RT	12.35	ROLAND CT 29+41.84 RT	12.55	NA	26.84
C16	ROLAND CT 29+41.84 LT	12.55	ROLAND CT 29+54.04 LT	14.83	35.00	12.48
C17	ROLAND CT 29+58.58 LT	16.94	VT ROUTE 15 19+09.37 RT	30.35	35.00	31.35
L11	VT ROUTE 15 19+09.37 RT	30.35	VT ROUTE 15 19+25.48 RT	30.27	NA	16.11
L12	VT ROUTE 15 16+92.42 LT	2.04	VT ROUTE 15 16+92.60 RT	7.82	NA	9.86
L13	VT ROUTE 15 17+00.40 LT	3.19	VT ROUTE 15 17+00.60 RT	7.79	NA	10.98
C18	VT ROUTE 15 19+93.12 RT	6.17	VT ROUTE 15 18+93.12 RT	2.17	2.00	6.28
L14	VT ROUTE 15 18+93.13 RT	2.17	VT ROUTE 15 19+34.06 RT	2.23	NA	40.93
C19	VT ROUTE 15 19+34.05 RT	6.23	VT ROUTE 15 19+34.06 RT	2.23	2.00	6.28
L15	VT ROUTE 15 18+93.12 RT	6.17	VT ROUTE 15 19+34.05 RT	6.23	NA	40.93
L16	VT ROUTE 15 19+03.03 LT	32.96	VT ROUTE 15 19+09.03 LT	32.04	NA	6.00
L17	VT ROUTE 15 19+77.10 LT	31.05	VT ROUTE 15 19+83.10 LT	30.76	NA	6.00

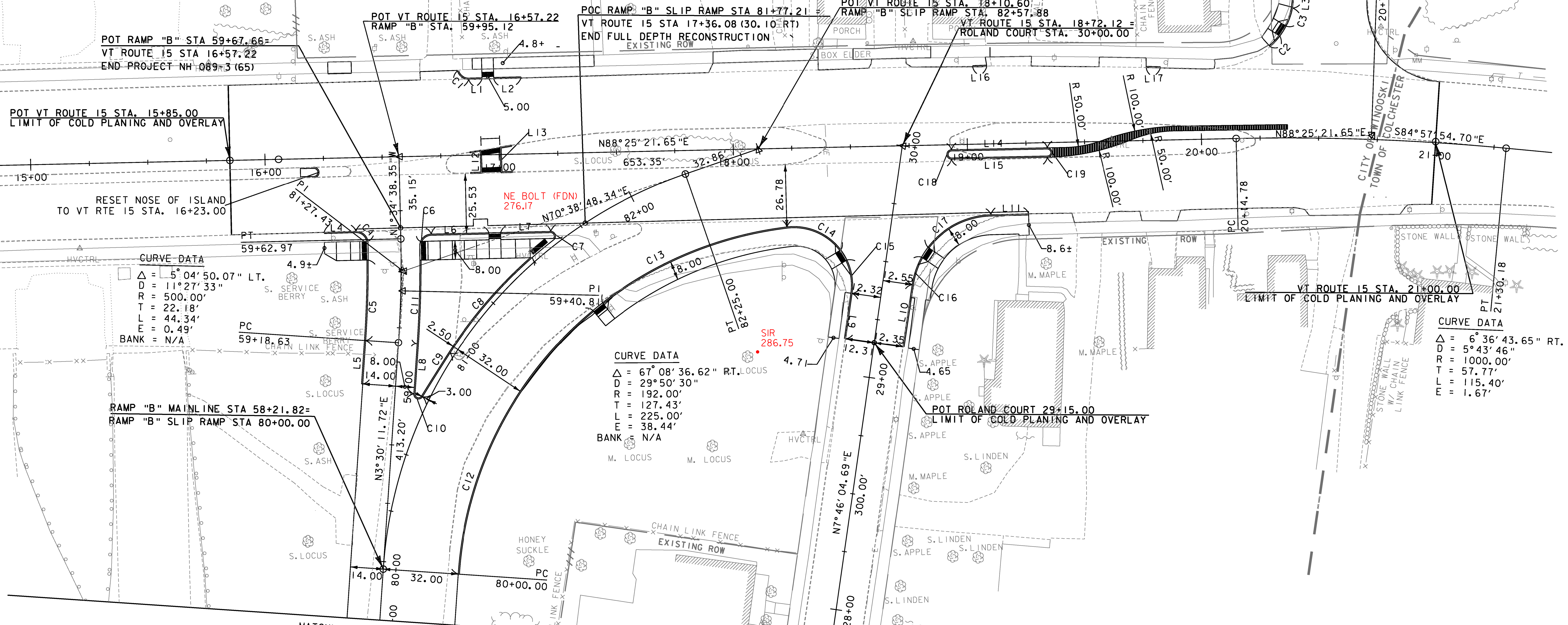

**CURVE DATA**  
 $\Delta = 5^{\circ} 04' 50.07''$  LT.  
 $D = 11^{\circ} 27' 33''$   
 $R = 500.00'$   
 $T = 22.18'$   
 $L = 44.34'$   
 $E = 0.49'$   
 $BANK = N/A$

**CURVE DATA**  
 $\Delta = 67^{\circ} 08' 36.62''$  RT.  
 $D = 29^{\circ} 50' 30''$   
 $R = 192.00'$   
 $T = 127.43'$   
 $L = 225.00'$   
 $E = 38.44'$   
 $BANK = N/A$

**CURVE DATA**  
 $\Delta = 6^{\circ} 36' 43.65''$  RT.  
 $D = 5^{\circ} 43' 46''$   
 $R = 1000.00'$   
 $T = 57.77'$   
 $L = 115.40'$   
 $E = 1.67'$

PROJECT NAME: WINOOSKI  
PROJECT NUMBER: NH 089-3(65)

FILE NAME: z94a198curbbdr.dgn  
PROJECT LEADER: KEN UPMAL  
DESIGNED BY: A. ACHARYA  
CURB TIE AND LAYOUT SHEET 2

PLOT DATE: 2/23/2010  
DRAWN BY: A. ACHARYA  
CHECKED BY: E. ATKINS  
SHEET 18 OF 67

