

STATE OF VERMONT
AGENCY OF TRANSPORTATION



PROPOSED IMPROVEMENT
TOWNS OF SHERBURNE,
PITTSFIELD AND STOCKBRIDGE
COUNTIES OF RUTLAND AND WINDSOR
VT ROUTE 100

BEGINNING IN SHERBURNE AT THE INTERSECTION OF VT ROUTE 100 AND
US ROUTE 4 AND EXTENDING NORTHERLY ALONG VT ROUTE 100 FOR A DISTANCE
OF 10.829 MILES TO MILE MARKER 1.871 IN THE TOWN OF STOCKBRIDGE.

LENGTH OF ROADWAY 57,177.12 FEET = 10.829 MILES
LENGTH OF PROJECT 57,177.12 FEET = 10.829 MILES

WORK TO BE PERFORMED UNDER THIS PROJECT INCLUDES: RECLAIMED STABILIZED BASE,
RESURFACING EXISTING HIGHWAY WITH A BINDER COURSE AND A WEARING COURSE,
GUARD RAIL WORK, ASSOCIATED PAVEMENT MARKINGS AND INCIDENTAL ITEMS.

INDEX OF SHEETS

- 1 TITLE SHEET
- 2 TYPICAL SECTIONS
- 3 TRANSITION DETAILS
- 4 QUANTITY SHEET
- 5 BLANK
- 6 GUARD RAIL DETAILS
- 7-12 LAYOUTS
- 13 INTERSECTION DETAIL SHEET
- 14 CONSTRUCTION SIGN DETAIL SHEET
- 15-20 TRAFFIC SIGN SUMMARY SHEETS
- 21 PAVEMENT MARKING DETAILS

STANDARDS

D-8	REINFORCED CONCRETE DROP INLET WITH PRECAST COVER & GRATE	6-01-94
D-11	GRATES & COVERS (TYPE A)	6-01-94
D-15	PRECAST CONCRETE MANHOLE GRATES	6-01-94
D-16	PRECAST CURB C1, GRATE, AND END SECTION	6-01-94
E-100	CONSTRUCTION APPROACH SIGNS	10-21-92
E-101	CONSTRUCTION SIGN DETAILS	10-21-92
E-102	CONSTRUCTION SIGN DETAILS	10-21-92
E-106	TRAFFIC CONTROL - MISC. DETAILS	9-20-93
E-107	DELINEATION, BARRICADES AND DETOURS FOR CONSTRUCTION AREAS	9-20-93
E-107A	BREAKAWAY BARRICADE DETAILS	9-20-93
E-108	CONSTRUCTION ZONE LONGITUDINAL DETAILS	9-20-93
E-110	MAJOR MAINTENANCE OPERATION LANE CLOSURE	9-20-93
E-121	STANDARD SIGN PLACEMENT - CONVENTIONAL ROAD	1-23-89
E-138	MILE MARKER DETAILS STATE & TOWN HIGHWAYS	10-20-88
E-141	REGULATORY SIGN DETAILS	10-30-87
E-143	REGULATORY SIGN DETAILS	10-30-87
E-145A	REGULATORY SIGN DETAILS	12-23-94
E-150	WARNING SIGN DETAILS	10-30-87
E-160	FLANGED CHANNEL STEEL SIGN POST DETAIL	10-21-92
E-191	PAVEMENT MARKING DETAILS	1-23-89
G-1	STEEL BEAM GUARD RAIL	6-01-94
G-10	ANCHOR FOR CABLE GUARD RAIL AT OPENINGS	6-01-94
G-15	BREAKAWAY CABLE TERMINAL W/ STEEL POSTS	6-01-94

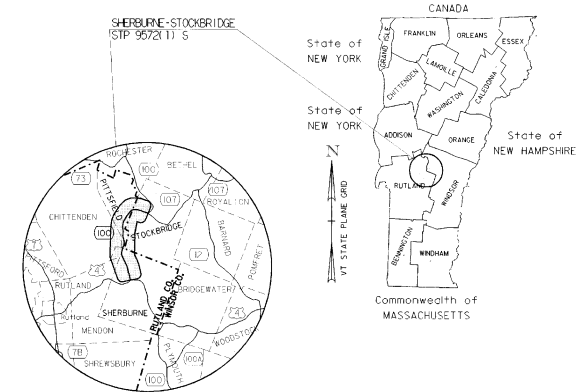

RECORD PLANS

CONTRACTOR: Pike Industries, Tilton, N.H.
 RESIDENT ENGINEER: Robert Rippey
 CONSTRUCTION BEGAN: Oct. 19, 1995
 CONSTRUCTION COMPLETED: Sept. 7, 1996
 RECORD PLANS BY: P.K. Nye & CADD
 I HEREBY CERTIFY THAT ALL THE CONSTRUCTION REQUIRED BY THIS SET
 OF DRAWINGS HAS BEEN ACCOMPLISHED AS INDICATED HEREIN.
 BY: Robert Rippey RESIDENT ENGINEER
 DATE: 8-28-97

NOTES: Any further information concerning final quantities, amounts or other
 details relative to this project may be found in microfilm in Central Files.

TRAFFIC DATA

	1995 ADT (DHW)	2005 ADT (DHW)	'95-'05 ESAL'S
US 4 TO TH 1 (SHERBURNE)	3350 (465)	3980 (550)	1,028,000
TH 1 TO TH 1 (PITTSFIELD)	3290 (460)	3910 (540)	1,010,000
TH 1 (PITTSFIELD) TO VT 107 (STOCKBRIDGE)	3120 (435)	3700 (515)	956,000

UNLESS OTHERWISE NOTED, ALL DRAWINGS
 AND DETAILS OF THE PROJECT PLANS ARE
 "NOT TO SCALE."

RIGHT-OF-WAY LIMITS, IF APPLICABLE, ARE PROVIDED
 SOLELY FOR THE CONVENIENCE OF THE STATE AND ITS
 CONTRACTOR DURING THE COURSE OF THIS PAVING
 PROJECT. ANY REFERENCES TO OFFSETS ON THESE
 PLANS ARE APPROXIMATE AND SHOULD NOT BE RELIED
 UPON FOR ANY OTHER PURPOSES.

THESE PLANS ARE SUBJECT TO SUCH ENGINEERING
 CHANGES AS MAY BE REQUIRED BY THE FEDERAL HIGHWAY
 ADMINISTRATION OR THE DIRECTOR OF CONSTRUCTION
 AND MAINTENANCE.
 CONSTRUCTION IS TO BE CARRIED ON IN ACCORDANCE
 WITH THESE PLANS AND THE STANDARD SPECIFICATIONS
 FOR CONSTRUCTION DATED 1990 AS APPROVED BY THE
 FEDERAL HIGHWAY ADMINISTRATION ON MARCH 16, 1990
 FOR USE ON THIS PROJECT, INCLUDING ALL SUBSEQUENT
 REVISIONS AND SUCH REVISED SPECIFICATIONS AND
 SPECIAL PROVISIONS AS ARE INCORPORATED IN THESE
 PLANS.
 21-JUL-1995
 /pva/94b268/pb268.ccr

APPROVE: [Signature] DATE: 7/11/95
 DIRECTOR OF CONSTRUCTION AND MAINTENANCE
 DEPARTMENT OF TRANSPORTATION
 FEDERAL HIGHWAY ADMINISTRATION
 APPROVED: _____ DATE: _____
 DIVISION ADMINISTRATOR
 PROJECT: SHERBURNE - STOCKBRIDGE
 STP 9572 (113)
 SHEET 1 OF 21 SHEETS

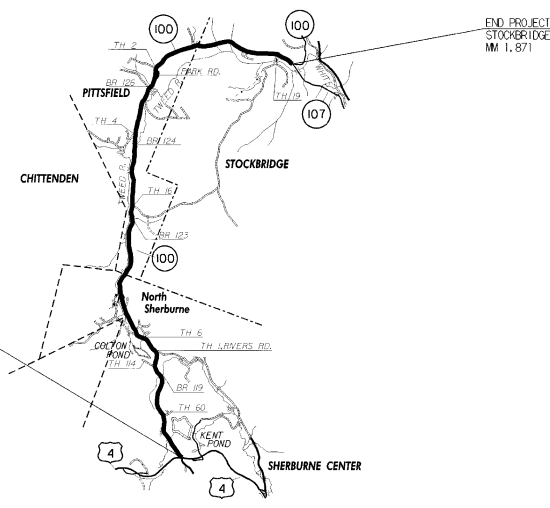
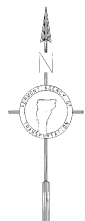

CONVENTIONAL SIGNS

COUNTY LINE	---
TOWN LINE	---
LIMITS OF ACCESS	○---○
POINT OF ACCESS	○---○ X
FENCE LINE	---x---x---
STONE WALL	○○○○○○○○○○○○○○○○○○
TRAVELED WAY	---
GUARD RAIL	○---○
RAILROAD	
SURVEY LINE	---
CULVERT	---
POWER POLE	⊕
TELEPHONE POLE	⊕
TREES	⊕
CONTROL OF ACCESS	---
PROPERTY LINE	---
R.O.W. TAKING LINE	---
SLOPE RIGHTS	○---○
TOP OF CUT	△
TOE OF SLOPE	○

DATUM

VERTICAL	N/A
HORIZONTAL	N/A

VT ROUTE 100 - PAVEMENT SECTIONS

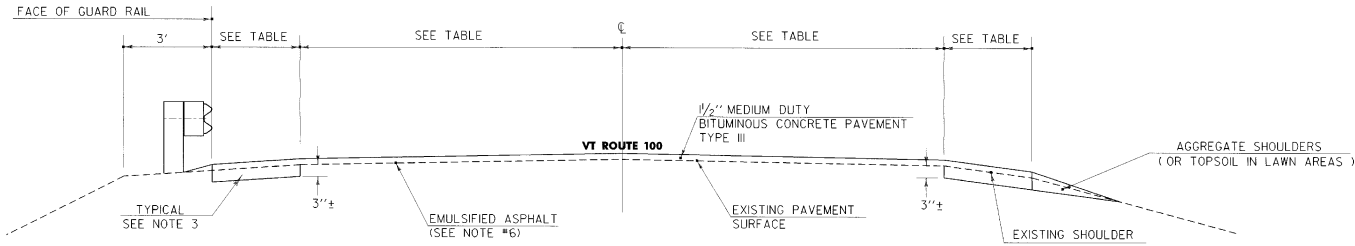

OVERLAY TYPICAL SECTION

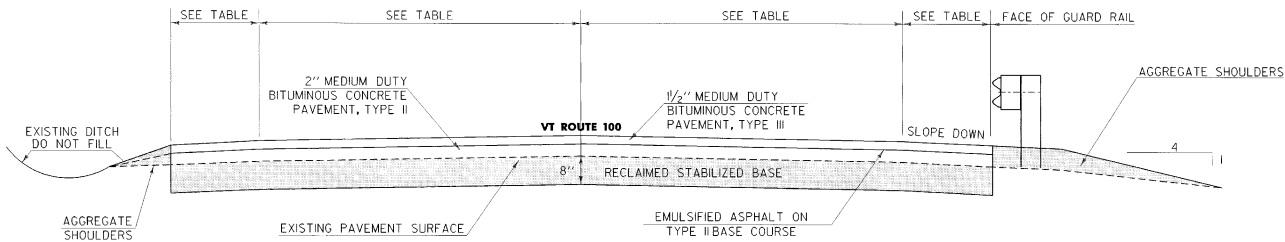

RECLAIMED TYPICAL SECTION

NOTES

1. THE PAVEMENT WEARING COURSE SHALL BE TYPE III, MEDIUM DUTY BITUMINOUS CONCRETE PAVEMENT, ITEM 406.27.
2. THE LEVELING COURSE SHALL BE TYPE III OR TYPE IV AS DIRECTED BY THE ENGINEER.
3. EXISTING SHOULDER MATERIAL DEEMED UNSUITABLE BY THE RESIDENT ENGINEER, SHALL BE EXCAVATED TO A DEPTH OF 3"± OR AS DIRECTED BY THE ENGINEER. EXCAVATED MATERIAL SHALL BE SPREAD ON THE ADJACENT SLOPES OR REMOVED FROM THE PROJECT, AS DIRECTED BY THE ENGINEER.
- EXCAVATION WILL BE PAID FOR AS ALL PURPOSE EXCAVATOR OR GRADER RENTAL.
- MATERIAL REMOVED SHALL BE REPLACED WITH SUBBASE OF CRUSHED GRAVEL (FINE GRADED).
4. COLD PLANING TO BE COMPLETED ACCORDING TO TYPICAL OR AS NOTED OTHERWISE ON THE PLANS. ALL COLD PLANED AREAS SHALL BE TACKED WITH EMULSIFIED ASPHALT AS DIRECTED.
5. THREE FEET OF BACKING IS REQUIRED BEHIND THE FACE OF GUARD RAIL WITH 6" POST. IF THIS CANNOT BE OBTAINED THEN 8" POSTS WILL BE USED.
6. EMULSIFIED ASPHALT SHALL BE APPLIED ON ALL EXISTING SURFACES ON ALL COLD PLANED SURFACES AND BETWEEN ALL COURSES OF PAVEMENT AT THE RATE OF 0.015 GAL./SY. OR AS DIRECTED BY THE RESIDENT ENGINEER.
7. BITUMINOUS CONCRETE PAVEMENT TOLERANCE = ± 1/4" (TOTAL PAVEMENT THICKNESS EXCLUDING LEVELING).

SEEDING FORMULA URBAN AREAS

% WT.	LBS./A.	NAME	PUR %	GERM %
42.5	34.0	CREeping RED FESCUE	98	85
10.0	8.0	PERENNIAL RYE GRASS	95	90
42.5	34.0	KENTUCKY BLUE GRASS	85	85
5.0	4.0	ANNUAL RYE GRASS	95	85
100.00	80.0			

THE SEED MIXTURE SHALL NOT HAVE A WEED CONTENT EXCEEDING 0.40% BY WEIGHT AND SHALL BE FREE OF ALL NOXIOUS WEED SEED.

SEED- TO BE APPLIED PER SEEDING FORMULA DIRECTED BY THE ENGINEER.

FERTILIZER- FORMULA 10-20-10 TO BE USED WITH SEED, APPLIED AT THE RATE OF 500 LBS./ACRE. (HYDRO SEEDERS MAY USE 19-19-19 FORMULA)

AGRICULTURAL LIMESTONE- TO BE APPLIED AT THE RATE OF 2 TONS/ACRE OR AS DIRECTED BY THE ENGINEER.

HAY MULCH- TO BE PLACED ON EARTH SLOPES AT THE RATE OF 2 TONS/ACRE, OR AS DIRECTED BY THE ENGINEER.

TOPSOIL- TO BE USED WITH SEED AS INDICATED ON THE PLANS, OR AS DIRECTED BY THE ENGINEER.

MARKER POSTS- TO BE PLACED AS DIRECTED BY THE ENGINEER.

VT ROUTE 100

TOWN	BEGIN MILE MARKER	END MILE MARKER	TYPICAL LANE WIDTH (FEET)	WEARING DEPTH (INCHES)	BASE DEPTH (INCHES)	LEVELING COURSE (TONS/MILE)	NOTES
SHERBURNE	0.000	0.084	3-11-11-3	1.5		650	EAST SPUR (SEE COLD PLANE 1)
	0.000	0.084	6-12-8-12-6	1.5		1000	WEST SPUR (SEE COLD PLANE 2)
	0.084	0.159	4-12-12-12-3	1.5	2.0		RECLAIMED SECTION
	0.159	0.289	VARIES	1.5	2.0		RECLAIMED SECTION
	0.289	0.475	2-12-12-4	1.5	2.0		RECLAIMED SECTION
	0.475	0.525	VARIES	1.5	2.0		RECLAIMED SECTION
	0.525	0.728	2-11-11-2	1.5	2.0		RECLAIMED SECTION
	0.728	0.842	VARIES	1.5	2.0		RECLAIMED SECTION
	0.842	0.975	8-11-11-2	1.5	2.0		RECLAIMED SECTION
	0.975	1.025	VARIES	1.5	2.0		RECLAIMED SECTION
	1.025	1.375	8-11-11-6	1.5	2.0		RECLAIMED SECTION
	1.375	1.425	VARIES	1.5	2.0		RECLAIMED SECTION
	1.425	1.775	6-11-11-6	1.5	2.0		RECLAIMED SECTION
	1.775	1.825	VARIES	1.5	2.0		RECLAIMED SECTION
	1.825	2.175	2-11-11-4	1.5	2.0		RECLAIMED SECTION
	2.175	2.225	VARIES	1.5	2.0		RECLAIMED SECTION
	2.225	2.600	2-11-11-2	1.5	2.0		RECLAIMED SECTION
	2.600	3.964	2-11-11-2	1.5		600	
	3.964	3.969	VARIES	1.5		600	
	PITTSFIELD	0.000	0.005	VARIES	1.5		600
0.005		4.873	1.5-11-11-1.5	1.5		568	
STOCKBRIDGE	0.000	1.871	1.5-11-11-1.5	1.5		560	

TYPICAL SECTIONS

SURVEYED BY	N/A	DATE	N/A
DRAWN BY	CONSTRUCTION	DATE	5/95
SQUAD LEADER	N/A		
DESIGN FILE NO.	/pave/94b268/pb268.dgn	DATE PLOTTED	19-JUL-1995
IPARM FILE	N/A		
PROJ. NAME	SHERBURNE - STOCKBRIDGE		
PROJ. NO.	STP 9572(1) S		
SHEET	2 OF 21 SHEETS		

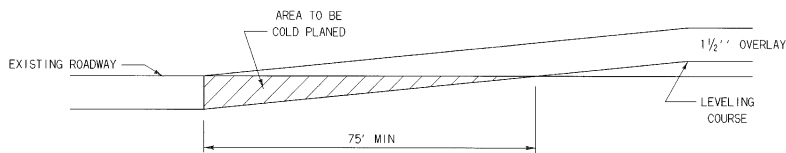

**BR 162 APPROACHES, PITTSFIELD MM 3.630
END OF PROJECT, STOCKBRIDGE MM 1.871**

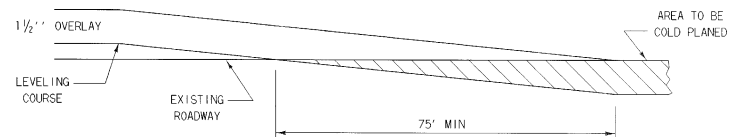

**BR 124, PITTSFIELD MM 2.52
COLD PLANE 1" AND REPAVE 1"**

COLD PLANING DETAILS

NOT TO SCALE

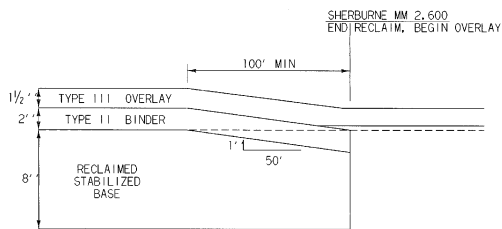

**RECLAIMED STABILIZED BASE
TRANSITION, SHERBURNE MM 2.600**

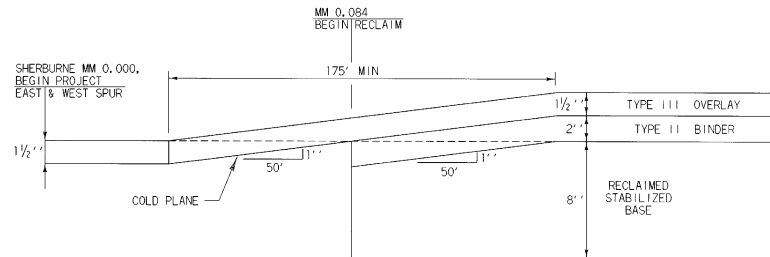

**RECLAIMED STABILIZED BASE
TRANSITION, BEGIN PROJECT**

RECLAIMING DETAILS

NOT TO SCALE

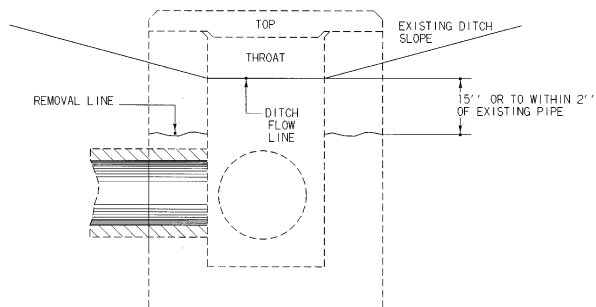

THROAT D.I. TOP REMOVAL

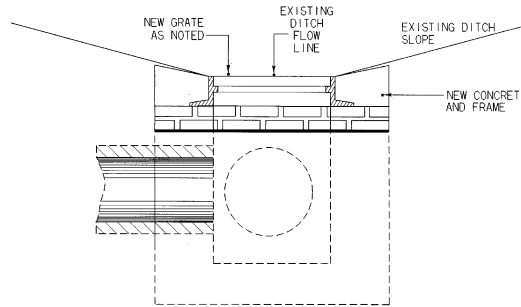

NEW D.I. TOP PLACEMENT

NOTES:

- 1.) REMOVE THROAT DROP INLET TOPS, PEDESTALS AND DROP INLET WALLS TO ACCOMMODATE NEW BRICKS, D.I. COVERS, FRAMES AND GRATES TO MAINTAIN EXISTING DITCH FLOW LINES (SEE STD. D-8 FOR EXISTING D.I. DETAILS).
- 2.) REDUCE BRICK COURSES AS NECESSARY TO MAINTAIN EXISTING DITCH FLOW LINE.
- 3.) SEE STANDARDS D-11, D-15 AND D-16 FOR GRATE DETAIL.
- 4.) ALL REMOVAL AND RECONSTRUCTION, INCLUDING ALL MATERIALS AND LABOR, SHALL BE PAID FOR UNDER ITEM 604.41.
- 5.) IF NECESSARY, ITEM 604.41 SHALL INCLUDE THE COMPLETE RECONSTRUCTION OF THE DROP INLET, CATCH BASIN OR MANHOLE TO CURRENT STANDARDS.

**TRANSITION
DETAILS**

SURVEYED BY	N/A	DATE	N/A
DRAWN BY	CONSTRUCTION	DATE	5/95
SQUAD LEADER	N/A		
DESIGN FILE NO.	/pave/94b268/pb268.dgn		
IPARM	N/A	DATE	19-JUL-1995
FILE		PLOTTED	
PROJ. NAME	SHERBURNE - STOCKBRIDGE		
PROJ. NO.	STP 9572111 S		
SHEET	3 OF 21	SHEETS	

**DROP
INLET
DETAILS**

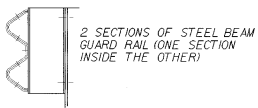

DETAIL A

NOTES:

1. SEE STANDARD G-1 & G-1D FOR STEEL BEAM GUARD RAIL DETAILS
2. THIS WORK SHALL BE PAID UNDER ITEM 62120, STEEL BEAM GUARD RAIL OR 62121, HEAVY DUTY STEEL BEAM GUARD RAIL AT A PAY FACTOR OF 1.0.
3. THIS DETAIL TO BE USED AS INDICATED ON THE ITEM DETAIL AND DRAINAGE SHEET OR AS DIRECTED BY THE ENGINEER.

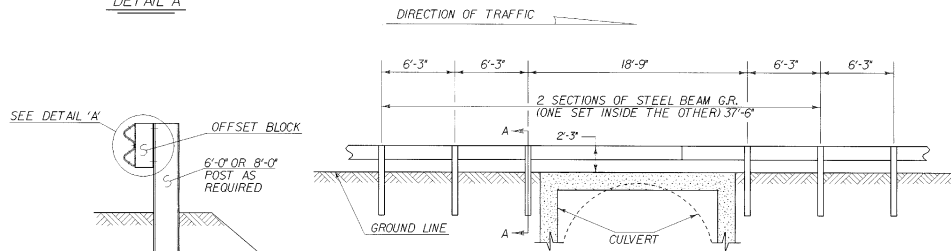

DETAIL OF STEEL BEAM GUARD RAIL AT LARGE CULVERTS

SECTION A-A

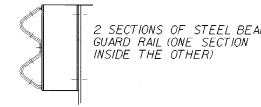

DETAIL A

NOTES:

1. SEE STANDARD G-1 & G-1D FOR STEEL BEAM GUARD RAIL DETAILS
2. THIS WORK SHALL BE PAID UNDER ITEM 62120, STEEL BEAM GUARD RAIL OR 62121, HEAVY DUTY STEEL BEAM GUARD RAIL AT A PAY FACTOR OF 1.0.
3. THIS DETAIL TO BE USED AS INDICATED ON THE ITEM DETAIL AND DRAINAGE SHEET OR AS DIRECTED BY THE ENGINEER.

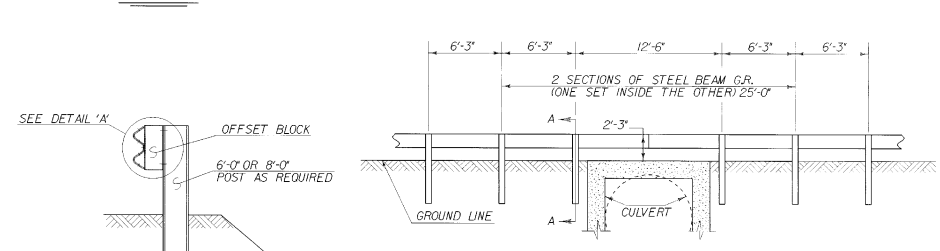

DETAIL OF STEEL BEAM GUARD RAIL AT LARGE CULVERTS

SECTION A-A

NOTES:

1. "HIGH SHOULDER" WARNING SIGNS SHALL BE PLACED EVERY 1000 FT. WITHIN THE WORK ZONES THAT ARE TO BE COLD PLANED.
2. "HIGH SHOULDER" WARNING SIGNS SHALL BE GATEPOSTED
3. SIDE ROADS WITHIN COLD PLANED AREAS SHALL BE SIGNED

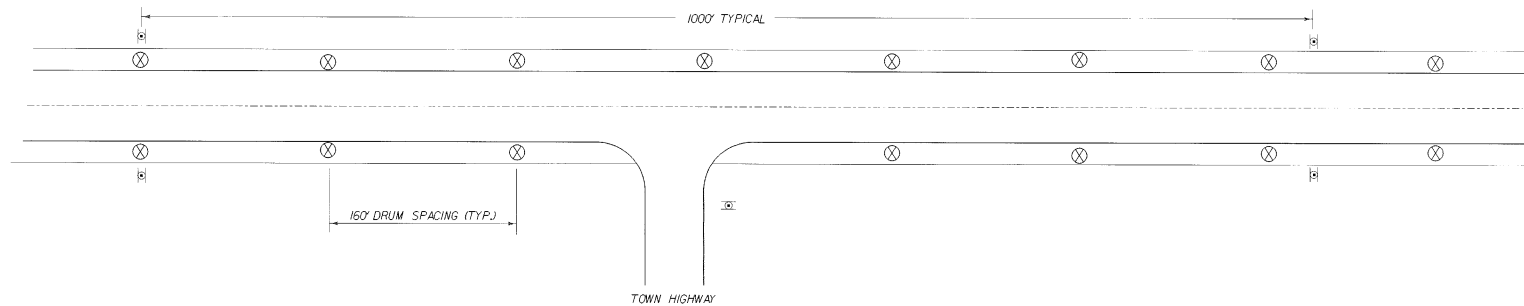

TRAFFIC CONTROL DETAIL FOR COLD PLANED AREAS

THIS DETAIL APPLIES WHERE THE COLD PLANING IS GREATER THAN 1" IN DEPTH AND GREATER THAN 100' IN LENGTH.

LEGEND

- ⊗ REFLECTORIZED PLASTIC DRUM SEE STD E-106
- ⊓ "HIGH SHOULDER" WARNING SIGN SEE STD E-101

DATUM	
VERTICAL	N/A
HORIZONTAL	N/A

GUARD RAIL AND TRAFFIC CONTROL DETAILS

SURVEYED BY	N/A	DATE	N/A
DRAWN BY	CONSTRUCTION	DATE	7/95
SQUAD LEADER	N/A		
DESIGN FILE NO.	/pave/94b268/pb268.dgn		
PARM FILE	pb268gr.i	DATE	19-JUL-1995
PROJ. NAME	SHERBURNE - STOCKBRIDGE		
PROJ. NO.	STP 9572(1)S		
SHEET	6 OF 21	SHEETS	

*** See Intersection of
VT Route 100
& US Route 4
Detail Sheet #4
For This Area**

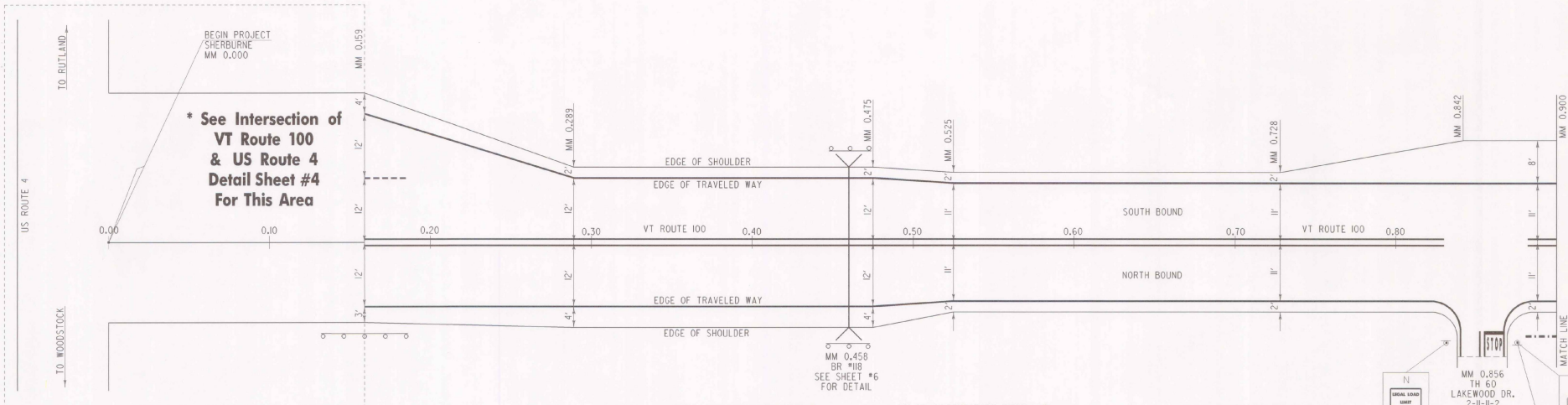

646.40 DURABLE 4" WHITE LINE
(ALL LINES WILL INCLUDE EDGE LINE BREAKS AND RADIUS FOR TOWN HIGHWAYS)
SHERBURNE:
MM 0.159 ~ MM 1.800 SOLID LT & RT
MM 0.159 ~ MM .197 LT (DASH)

646.41 DURABLE 4" YELLOW LINE
(ALL LINES WILL INCLUDE C/L BREAKS FOR TOWN HIGHWAYS)
SHERBURNE:
MM 0.159 ~ MM 1.800 SOLID LT & RT
TH 60 (50 LF, LT & RT)

646.46 DURABLE 24" STOP BAR
SHERBURNE:
MM 0.856 RT (15 LF) 19.5

646.50 DURABLE LETTER OR SYMBOL
SHERBURNE:
MM 0.856 RT "STOP" (4 EACH)

646.60 4" TEMPORARY WHITE LINE
(ALL LINES WILL INCLUDE EDGE LINE BREAKS AND RADIUS FOR TOWN HIGHWAYS)
SHERBURNE:
MM 0.159 ~ MM 1.800 SOLID LT & RT
MM 0.159 ~ MM .197 LT (DASH)

646.66 TEMPORARY 24" STOP BAR
SHERBURNE:
MM 0.856 RT (5 LF)

646.70 TEMPORARY LETTER OR SYMBOL
SHERBURNE:
MM 0.856 RT "STOP" (4 EACH)

646.61 TEMPORARY 4" YELLOW LINE
(ALL LINES WILL INCLUDE C/L BREAKS FOR TOWN HIGHWAYS)
SHERBURNE:
MM 0.159 ~ MM 1.800 SOLID LT & RT

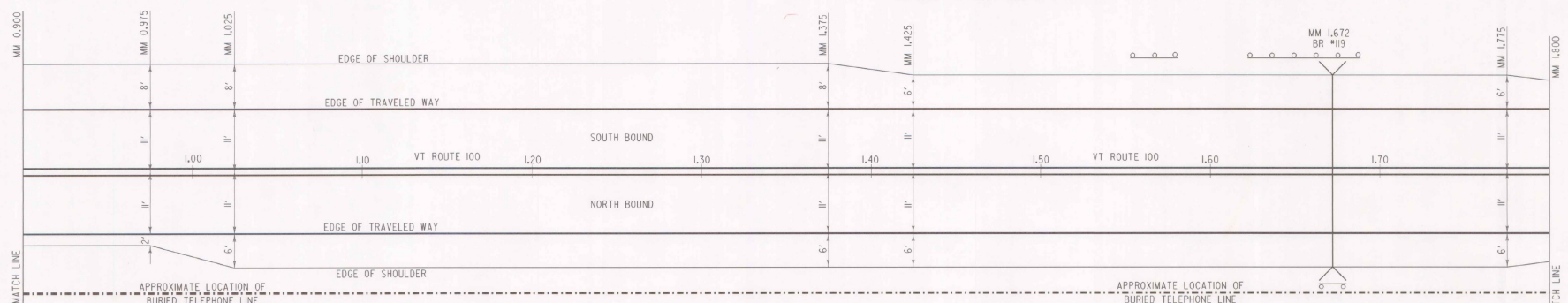
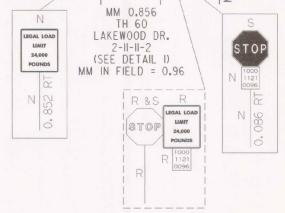

621.20 STEEL BEAM G.R.
0.141 ~ 0.188 RT 250.0
0.450 ~ 0.471 LT 375.0
0.450 ~ 0.462 RT 375.0
1.666 ~ 1.687 RT 112.5
1.309 ~ 1.350 LT 132.5
1.619 ~ 1.675 LT 289.5

621.20 STEEL BEAM GUARD RAIL
SHERBURNE:
MM 0.137 ~ MM 0.184 RT (250 LF)
MM 0.450 ~ MM 0.466 RT (75 LF)
MM 0.455 ~ MM 0.469 LT (75 LF)
MM 1.553 ~ MM 1.580 LT (150 LF)
MM 1.617 ~ MM 1.677 LT (325 LF)
MM 1.660 ~ MM 1.677 RT (100 LF)

621.50 BREAKAWAY CABLE TERMINAL
SHERBURNE:
MM 0.132 ~ MM 0.137 RT (1 EACH) ✓
MM 0.184 ~ MM 0.189 RT (1 EACH) ✓
MM 0.446 ~ MM 0.450 RT (1 EACH) ✓
MM 0.450 ~ MM 0.455 LT (1 EACH) ✓
MM 0.466 ~ MM 0.469 RT (1 EACH) ✓
MM 0.469 ~ MM 0.474 LT (1 EACH) ✓
MM 1.549 ~ MM 1.553 LT (1 EACH) ✓
MM 1.580 ~ MM 1.584 LT (1 EACH) ✓
MM 1.613 ~ MM 1.617 LT (1 EACH) ✓
MM 1.656 ~ MM 1.660 RT (1 EACH) ✓
MM 1.677 ~ MM 1.681 LT (1 EACH) ✓
MM 1.677 ~ MM 1.681 RT (1 EACH) ✓

621.80 REMOVAL & DISPOSAL OF GUARD RAIL
SHERBURNE:
MM 0.133 ~ MM 0.189 RT (296 LF)
MM 0.453 ~ MM 0.465 RT (162 LF)
MM 0.455 ~ MM 0.467 LT (162 LF)
MM 1.553 ~ MM 1.580 LT (143 LF)
MM 1.617 ~ MM 1.677 LT (347 LF)
MM 1.660 ~ MM 1.677 RT (190 LF)
MM 0.132 ~ 0.137 RT 300
0.450 ~ 0.455 RT 60
0.450 ~ 0.455 LT 300
1.666 ~ 1.687 LT 135.0
1.660 ~ 1.675 RT 90

675.50 REMOVING SIGNS
SHERBURNE:
3 EACH ✓ R&S RT 500, 44, 44.

675.60 ERECTING SALVAGED SIGNS
SHERBURNE:
1 EACH

DATUM

VERTICAL	N/A
HORIZONTAL	N/A



LAYOUT #1 SHERBURNE MM 0.000 TO MM 1.800		SURVEYED BY	N/A	DATE	N/A
		DRAWN BY	CONSTRUCTION	DATE	5/95
		SQUAD LEADER	N/A		
		DESIGN FILE NO.	/pave/94b268/pb268.dgn		
		PARM FILE	N/A	DATE PLOTTED	19-JUL-1995
		PROJ. NAME	SHERBURNE - STOCKBRIDGE		
		PROJ. NO.	STP 9572(1) S		
		SHEET	7 OF 21	SHEETS	

646.40 DURABLE 4" WHITE LINE
(ALL LINES WILL INCLUDE C/L BREAKS FOR TOWN HIGHWAYS)

SHERBURNE:
MM 1.800 ~ MM 3.600 SOLID LT & RT

646.41 DURABLE 4" YELLOW LINE
(ALL LINES WILL INCLUDE EDGE LINE BREAKS AND RADIUS FOR TOWN HIGHWAYS)

SHERBURNE:
MM 1.800 ~ MM 2.803 SOLID LT & RT
MM 2.803 ~ MM 2.950 SOLID LT DASHED RT
MM 2.950 ~ MM 3.095 DASH LT SOLID RT
MM 3.095 ~ MM 3.600 SOLID LT & RT
TH 14 (MM 2,058), TH 11 (MM 2,355 BOTH LEGS), TH 6 (MM 2,589) & TH 32 (MM 3,556) LT & RT 50 LF EACH

646.46 DURABLE 24" STOP BAR

SHERBURNE:
MM 2.058 LT (45 LF) 19.5
MM 2.335 RT (45 LF) 17.5
MM 2.355 RT (45 LF) 9.5
MM 2.589 RT (45 LF) 20.5
MM 3.556 LT (45 LF) 25.0

646.60 TEMPORARY 4" WHITE LINE
(ALL LINES WILL INCLUDE C/L BREAKS FOR TOWN HIGHWAYS)

SHERBURNE:
MM 1.800 ~ MM 3.600 SOLID LT & RT

646.61 TEMPORARY 4" YELLOW LINE
(ALL LINES WILL INCLUDE EDGE LINE BREAKS AND RADIUS FOR TOWN HIGHWAYS)

SHERBURNE:
MM 1.800 ~ MM 2.803 SOLID LT & RT
MM 2.803 ~ MM 2.950 SOLID LT DASHED RT
MM 2.950 ~ MM 3.095 DASH LT SOLID RT
MM 3.095 ~ MM 3.600 SOLID LT & RT

646.66 TEMPORARY 24" STOP BAR

SHERBURNE:
MM 2.058 LT (45 LF)
MM 2.335 RT (45 LF)
MM 2.355 RT (45 LF)
MM 2.589 RT (45 LF)
MM 3.556 LT (45 LF)

646.70 TEMPORARY LETTER OR SYMBOL

SHERBURNE:
MM 2.058 LT "STOP" (4 EACH)
MM 2.335 RT "STOP" (4 EACH)
MM 2.355 RT "STOP" (4 EACH)
MM 2.589 RT "STOP" (4 EACH)
MM 3.556 LT "STOP" (4 EACH)

646.50 DURABLE LETTER OR SYMBOL

SHERBURNE:
MM 2.058 LT "STOP" (4 EACH)
MM 2.335 RT "STOP" (4 EACH)
MM 2.355 RT "STOP" (4 EACH)
MM 2.589 RT "STOP" (4 EACH)
MM 3.556 LT "STOP" (4 EACH)

675.50 REMOVING SIGNS

SHERBURNE:
46 EACH

675.60 ERECTING SALVAGED SIGNS

SHERBURNE:
4 EACH

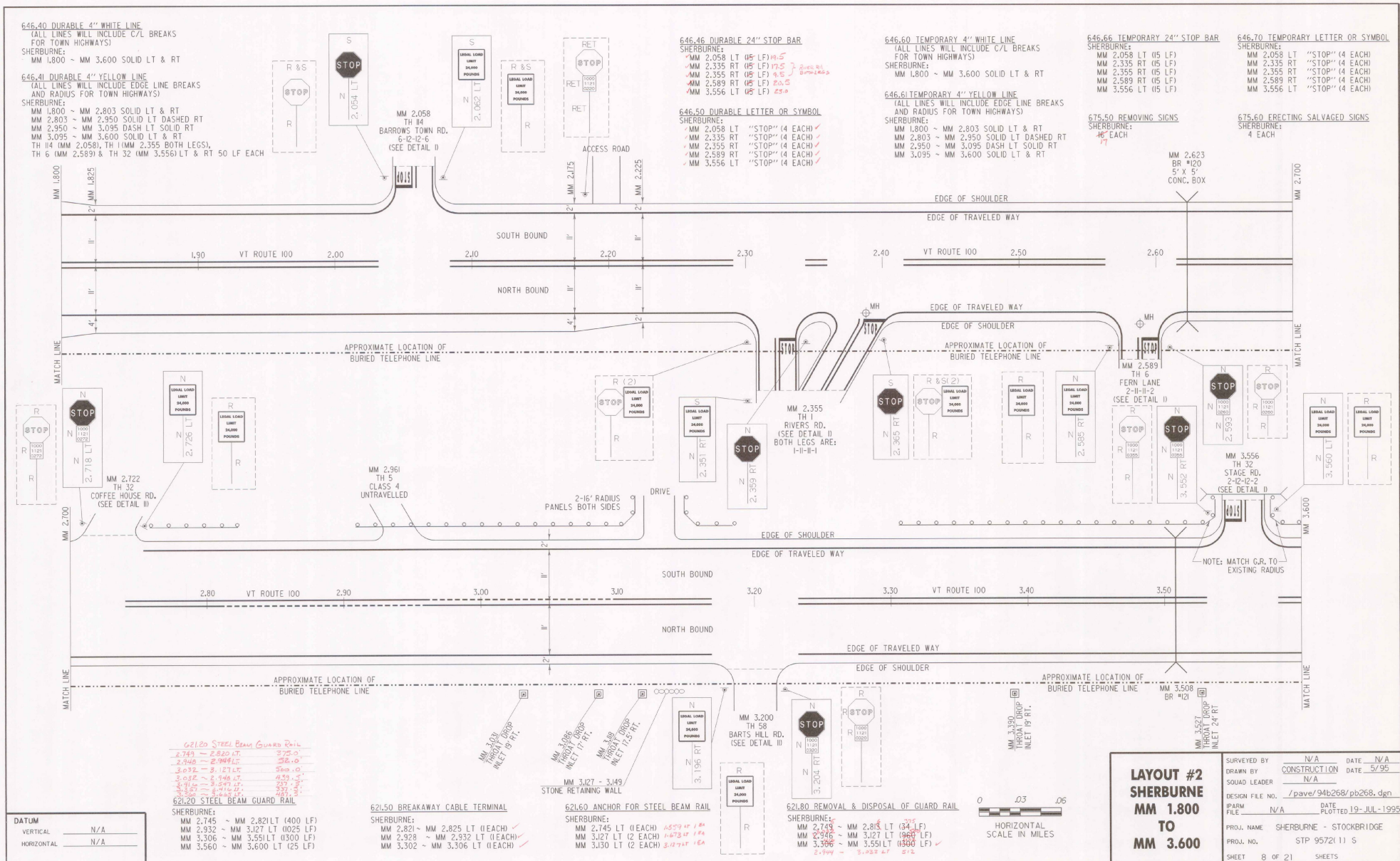

62120 STEEL BEAM GUARD RAIL

2.749	~	2.820	LT	372.0
2.948	~	2.994	LT	52.0
2.992	~	3.171	LT	300.0
3.052	~	3.594	LT	453.5
3.556	~	3.514	LT	357.0
3.556	~	3.514	LT	357.0

62120 STEEL BEAM GUARD RAIL
SHERBURNE:
MM 2.745 ~ MM 2.821 LT (400 LF)
MM 2.932 ~ MM 3.127 LT (1025 LF)
MM 3.306 ~ MM 3.551 LT (1500 LF)
MM 3.560 ~ MM 3.600 LT (25 LF)

62150 BREAKAWAY CABLE TERMINAL
SHERBURNE:
MM 2.821 ~ MM 2.825 LT (EACH)
MM 2.928 ~ MM 2.932 LT (EACH)
MM 3.302 ~ MM 3.306 LT (EACH)

62160 ANCHOR FOR STEEL BEAM RAIL
SHERBURNE:
MM 2.745 LT (EACH) 157.0 LF
MM 3.127 LT (2 EACH) 167.3 LF
MM 3.130 LT (2 EACH) 312.7 LF

62180 REMOVAL & DISPOSAL OF GUARD RAIL
SHERBURNE:
MM 2.745 ~ MM 2.815 LT (34 LF)
MM 2.946 ~ MM 3.127 LT (960 LF)
MM 3.306 ~ MM 3.551 LT (1500 LF)
2.744 ~ 3.022 LT 512

DATUM

VERTICAL	N/A
HORIZONTAL	N/A

LAYOUT #2
SHERBURNE
MM 1.800
TO
MM 3.600

DESIGNED BY	N/A	DATE	N/A
DRAWN BY	CONSTRUCTION	DATE	5/95
SQUAD LEADER	N/A		
DESIGN FILE NO.	/pave/94b268/pb268.dgn		
IP/AM FILE	N/A	DATE PLOTTED	19-JUL-1995
PROJ. NAME	SHERBURNE - STOCKBRIDGE		
PROJ. NO.	STP 9572(1) S		
SHEET	8	OF 21	SHEETS

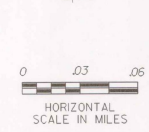

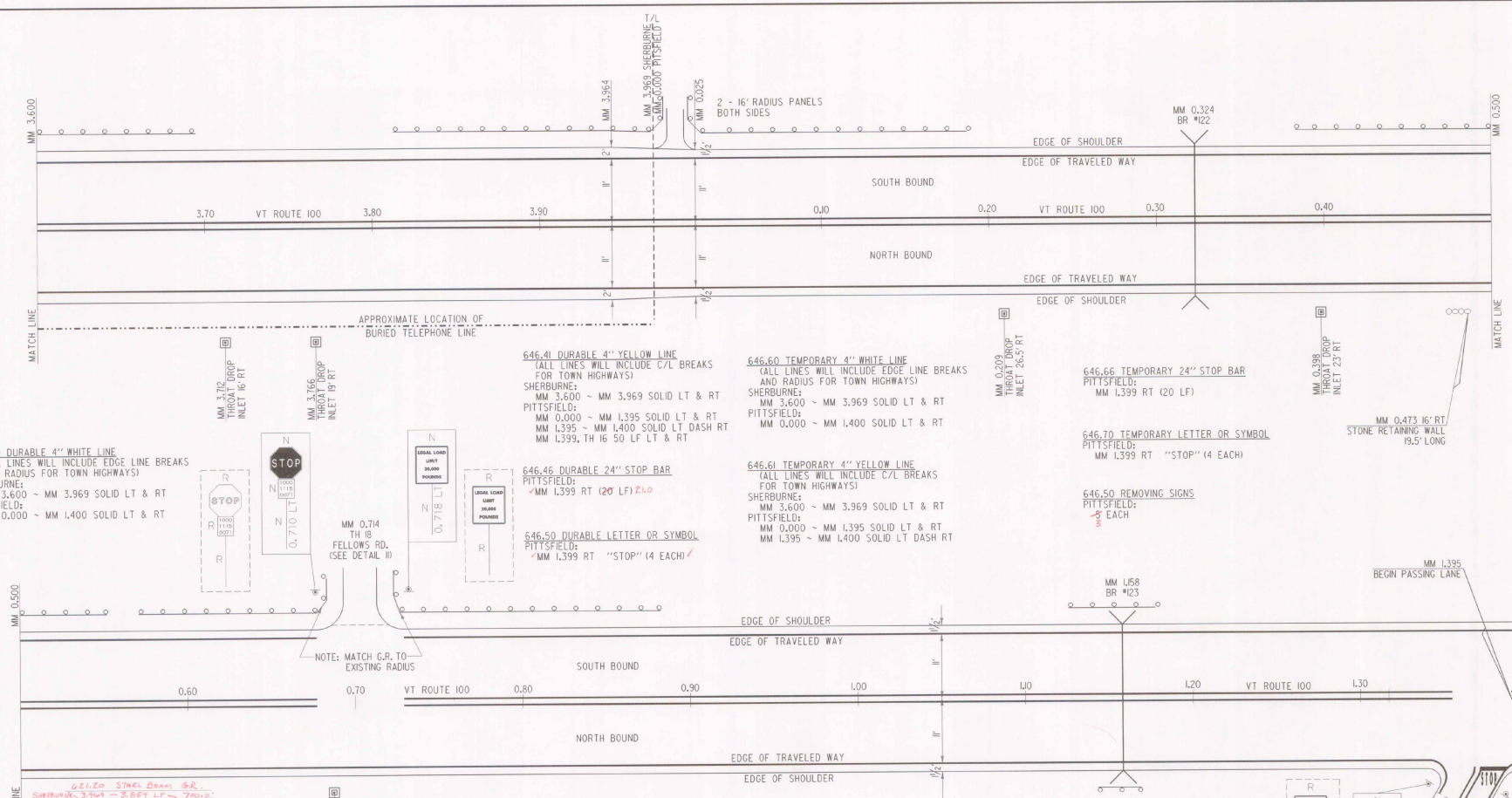

646.40 DURABLE 4" WHITE LINE
 (ALL LINES WILL INCLUDE EDGE LINE BREAKS AND RADIUS FOR TOWN HIGHWAYS)
 SHERBURNE:
 MM 3.600 ~ MM 3.969 SOLID LT & RT
 PITTSFIELD:
 MM 0.000 ~ MM 1.400 SOLID LT & RT

646.41 DURABLE 4" YELLOW LINE
 (ALL LINES WILL INCLUDE C/L BREAKS FOR TOWN HIGHWAYS)
 SHERBURNE:
 MM 3.600 ~ MM 3.969 SOLID LT & RT
 PITTSFIELD:
 MM 0.000 ~ MM 1.395 SOLID LT & RT
 MM 1.395 ~ MM 1.400 SOLID LT DASH RT
 MM 1.399, TH 16 50' LF LT & RT

646.60 TEMPORARY 4" WHITE LINE
 (ALL LINES WILL INCLUDE EDGE LINE BREAKS AND RADIUS FOR TOWN HIGHWAYS)
 SHERBURNE:
 MM 3.600 ~ MM 3.969 SOLID LT & RT
 PITTSFIELD:
 MM 0.000 ~ MM 1.400 SOLID LT & RT

646.66 TEMPORARY 24" STOP BAR
 PITTSFIELD:
 MM 1.399 RT (20 LF)

646.70 TEMPORARY LETTER OR SYMBOL
 PITTSFIELD:
 MM 1.399 RT "STOP" (4 EACH)

646.50 REMOVING SIGNS
 PITTSFIELD:
 3 EACH

646.61 TEMPORARY 4" YELLOW LINE
 (ALL LINES WILL INCLUDE C/L BREAKS FOR TOWN HIGHWAYS)
 SHERBURNE:
 MM 3.600 ~ MM 3.969 SOLID LT & RT
 PITTSFIELD:
 MM 0.000 ~ MM 1.395 SOLID LT & RT
 MM 1.395 ~ MM 1.400 SOLID LT DASH RT

646.46 DURABLE 24" STOP BAR
 PITTSFIELD:
 MM 1.399 RT (20 LF) 2.00

646.50 DURABLE LETTER OR SYMBOL
 PITTSFIELD:
 MM 1.399 RT "STOP" (4 EACH)

0.2120 STEEL BEAM GR
 SHERBURNE 3.700 - 3.857 LF 7.000'
 PITTSFIELD 0.015 - 0.000 LF 7.000'
 PITTSFIELD 0.015 - 0.180 LF 200.0'
 0.182 - 0.187 LF 200.0'
 0.187 - 0.191 LF 200.0'
 0.191 - 0.194 LF 200.0'
 0.194 - 0.197 LF 200.0'
 0.197 - 0.200 LF 200.0'
 0.200 - 0.203 LF 200.0'
 0.203 - 0.206 LF 200.0'
 0.206 - 0.209 LF 200.0'

621.20 STEEL BEAM GUARD RAIL
 SHERBURNE:
 MM 3.600 ~ MM 3.661 LT (325 LF)
 MM 3.790 ~ MM 3.969 LT (850 LF)
 PITTSFIELD:
 MM 0.000 ~ MM 0.018 LT (100 LF)
 MM 0.022 ~ MM 0.190 LT (1900 LF)
 MM 0.395 ~ MM 0.538 LT (775 LF)
 MM 0.571 ~ MM 0.709 LT (750 LF)
 MM 0.716 ~ MM 0.874 LT (850 LF)
 MM 1.123 ~ MM 1.161 LT (200 LF)
 MM 1.132 ~ MM 1.151 RT (100 LF)

621.50 BREAKAWAY CABLE TERMINAL
 SHERBURNE:
 MM 3.661 ~ MM 3.665 LT (EACH) ✓
 MM 3.709 ~ MM 3.790 LT (EACH) ✓
 MM 3.786 ~ MM 3.790 LT (EACH) ✓
 PITTSFIELD:
 MM 0.190 ~ MM 0.195 LT (EACH) ✓
 MM 0.386 ~ MM 0.395 LT (EACH) ✓
 MM 0.538 ~ MM 0.548 LT (EACH) ✓
 MM 0.571 ~ MM 0.576 LT (EACH) ✓
 MM 0.874 ~ MM 0.878 LT (EACH) ✓
 MM 1.110 ~ MM 1.123 LT (EACH) ✓
 MM 1.127 ~ MM 1.132 RT (EACH) ✓
 MM 1.161 ~ MM 1.165 LT (EACH) ✓

621.60 ANCHOR FOR STEEL BEAM RAIL
 PITTSFIELD:
 MM 0.018 LT (EACH) 1.0710 LF 18A
 MM 0.022 LT (EACH) 2.0710 LF 18A
 MM 1.151 RT (EACH) 1.181 RT 18A

60180 REM & DIS OF GC
 SHERBURNE 3.700 - 3.969 LF 100.5'
 PITTSFIELD 0.015 - 0.000 LF 7.5'
 0.015 - 0.180 LF 200.0'
 0.182 - 0.187 LF 200.0'
 0.187 - 0.191 LF 200.0'
 0.191 - 0.194 LF 200.0'
 0.194 - 0.197 LF 200.0'
 0.197 - 0.200 LF 200.0'
 0.200 - 0.203 LF 200.0'
 0.203 - 0.206 LF 200.0'
 0.206 - 0.209 LF 200.0'

621.80 REMOVAL & DISPOSAL OF GUARD RAIL
 SHERBURNE:
 MM 3.790 ~ MM 3.969 LT (1945 LF) ✓
 PITTSFIELD:
 MM 0.000 ~ MM 0.018 LT (95 LF) ✓
 MM 0.022 ~ MM 0.190 LT (988 LF)
 MM 0.395 ~ MM 0.538 LT (755 LF)
 MM 0.571 ~ MM 0.709 LT (729 LF)
 MM 0.716 ~ MM 0.874 LT (834 LF)
 MM 1.117 ~ MM 1.154 LT (811 LF)
 MM 1.132 ~ MM 1.149 RT (92 LF)
 1.161 - 1.165 RT 200'

DATUM

VERTICAL	N/A
HORIZONTAL	N/A



LAYOUT #3
SHERBURNE
MM 3.600
TO
PITTSFIELD
MM 1.400

SURVEYED BY	N/A	DATE	N/A
DRAWN BY	CONSTRUCTION	DATE	5/95
SQUAD LEADER	N/A		
DESIGN FILE NO.	/pave/94b268/pb268.dgn		
IFARM FILE	N/A	DATE	19-JUL-1995
PROJ. NAME	SHERBURNE - STOCKBRIDGE		
PROJ. NO.	STP 9572111 S		
SHEET	9 OF 21	SHEETS	

646.40 DURABLE 4" WHITE LINE
 (ALL LINES WILL INCLUDE EDGE LINE BREAKS
 AND RADIUS FOR TOWN HIGHWAYS)
 PITTSFIELD:
 MM 1,400 ~ MM 3,200 SOLID LT & RT

646.41 DURABLE 4" YELLOW LINE
 (ALL LINES WILL INCLUDE C/L BREAKS
 FOR TOWN HIGHWAYS)
 PITTSFIELD:
 MM 1,400 ~ 1,545 SOLID LT DASH RT
 MM 1,545 ~ MM 1,680 DASH LT SOLID RT
 MM 1,680 ~ MM 2,710 SOLID LT & RT
 MM 2,710 ~ MM 2,845 SOLID LT DASH RT
 MM 2,845 ~ MM 3,010 DASH C/L
 MM 3,010 ~ MM 3,140 DASH LT SOLID RT
 MM 3,140 ~ MM 3,200 SOLID LT & RT

646.60 TEMPORARY 4" WHITE LINE
 (ALL LINES WILL INCLUDE EDGE LINE BREAKS
 AND RADIUS FOR TOWN HIGHWAYS)
 PITTSFIELD:
 MM 1,400 ~ MM 3,200 SOLID LT & RT

675.50 REMOVING SIGNS
 PITTSFIELD:
 8' EACH

646.50 DURABLE LETTER OR SYMBOL
 PITTSFIELD:
 MM 2,611 LT STOP 4 ea
 2,700 LT STOP 4 ea

646.40 DURABLE 2 1/2" STOP BAR
 MM 2,611 LT 115 ea
 2,700 LT 100 ea

646.61 TEMPORARY 4" YELLOW LINE
 (ALL LINES WILL INCLUDE C/L BREAKS
 FOR TOWN HIGHWAYS)

PITTSFIELD:
 MM 1,400 ~ 1,545 SOLID LT DASH RT
 MM 1,545 ~ MM 1,680 DASH LT SOLID RT
 MM 1,680 ~ MM 2,710 SOLID LT & RT
 MM 2,710 ~ MM 2,845 SOLID LT DASH RT
 MM 2,845 ~ MM 3,010 DASH C/L
 MM 3,010 ~ MM 3,140 DASH LT SOLID RT
 MM 3,140 ~ MM 3,200 SOLID LT & RT

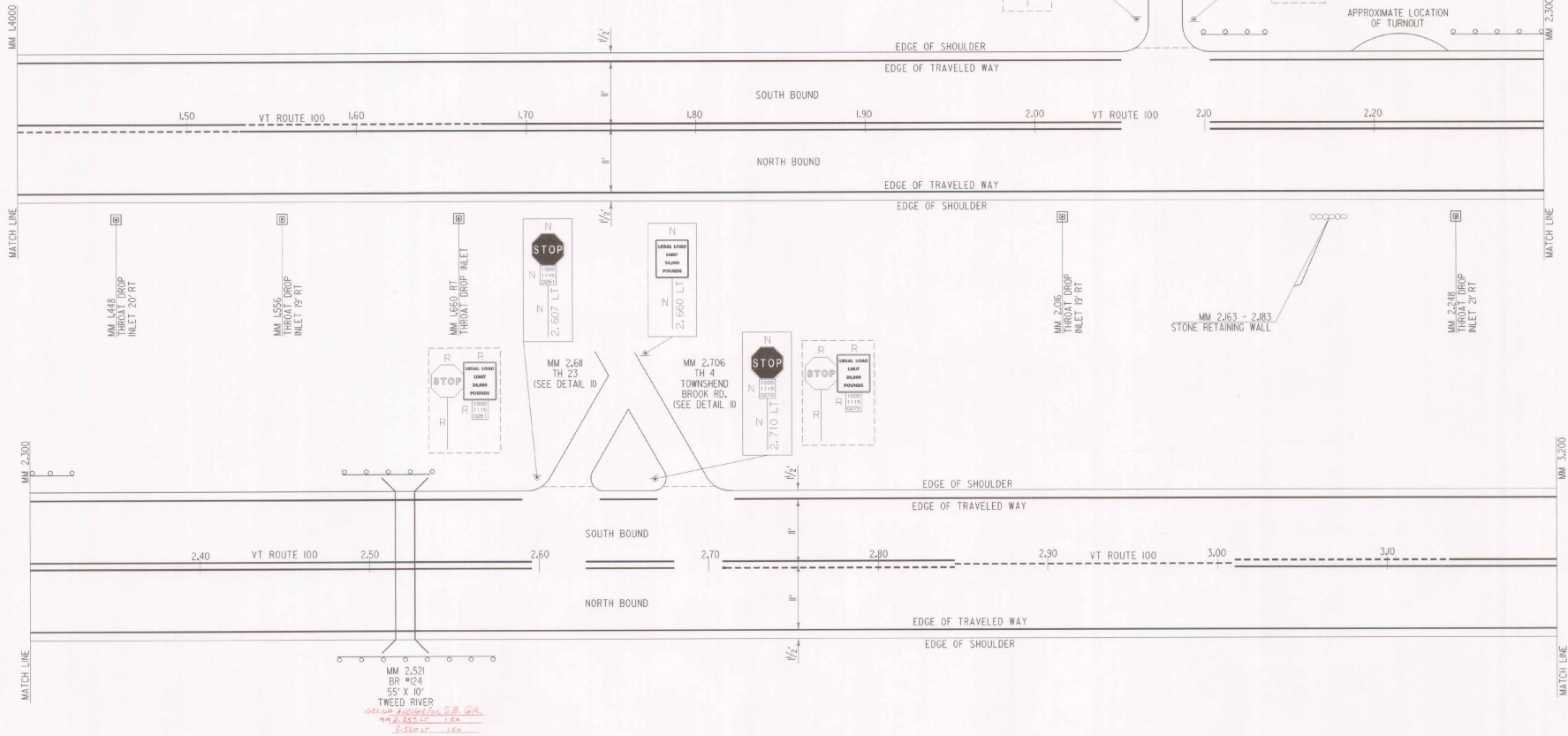

621.20 STEEL BEAM GUARD RAIL

PITTSFIELD:

MM 2,098 ~ MM 2,138 LT (225 LF)
MM 2,248 ~ MM 2,313 LT (380 LF)
MM 2,462 ~ MM 2,555 RT (500 LF)
MM 2,470 ~ MM 2,520 LT (1275 LF)
2,092 ~ 2,138 LT 225'
2,248 ~ 2,313 LT 380'
2,470 ~ 2,520 RT 440'
2,500 ~ 2,970 RT 380.25'
5.977

621.50 BREAKAWAY CABLE TERMINAL

PITTSFIELD:

MM 2,094 ~ MM 2,098 LT (1 EACH)
MM 2,138 ~ MM 2,143 LT (1 EACH)
MM 2,244 ~ MM 2,248 LT (1 EACH)
MM 2,457 ~ MM 2,462 RT (1 EACH)
MM 2,465 ~ MM 2,470 LT (1 EACH)
MM 2,520 ~ MM 2,525 RT (1 EACH)
MM 2,555 ~ MM 2,560 RT (1 EACH)

621.80 REMOVAL & DISPOSAL OF GUARD RAIL

PITTSFIELD:

MM 2,098 ~ MM 2,138 LT (225 LF)
MM 2,248 ~ MM 2,313 LT (380 LF)
MM 2,462 ~ MM 2,555 RT (500 LF)
MM 2,470 ~ MM 2,520 LT (1275 LF)
2,090 ~ 2,141 LT 227.5'
2,248 ~ 2,321 LT 262.5'
2,462 ~ 2,545 RT 493'
2,520 ~ 2,970 LT 380.25'

DATUM

VERTICAL	N/A
HORIZONTAL	N/A

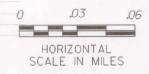

**LAYOUT #4
 PITTSFIELD
 MM 1,400
 TO
 MM 3,200**

SURVEYED BY	N/A	DATE	N/A
DRAWN BY	CONSTRUCTION	DATE	5/95
SQUAD LEADER	N/A		
DESIGN FILE NO.	/paver/94b268/pb268.dgn		
PAEM	N/A	DATE	
FILE	N/A	PLOTTED	19-JUL-1995
PROJ. NAME	SHERBURNE - STOCKBRIDGE		
PROJ. NO.	STP 9572(1) S		
SHEET	10 OF 21	SHEETS	

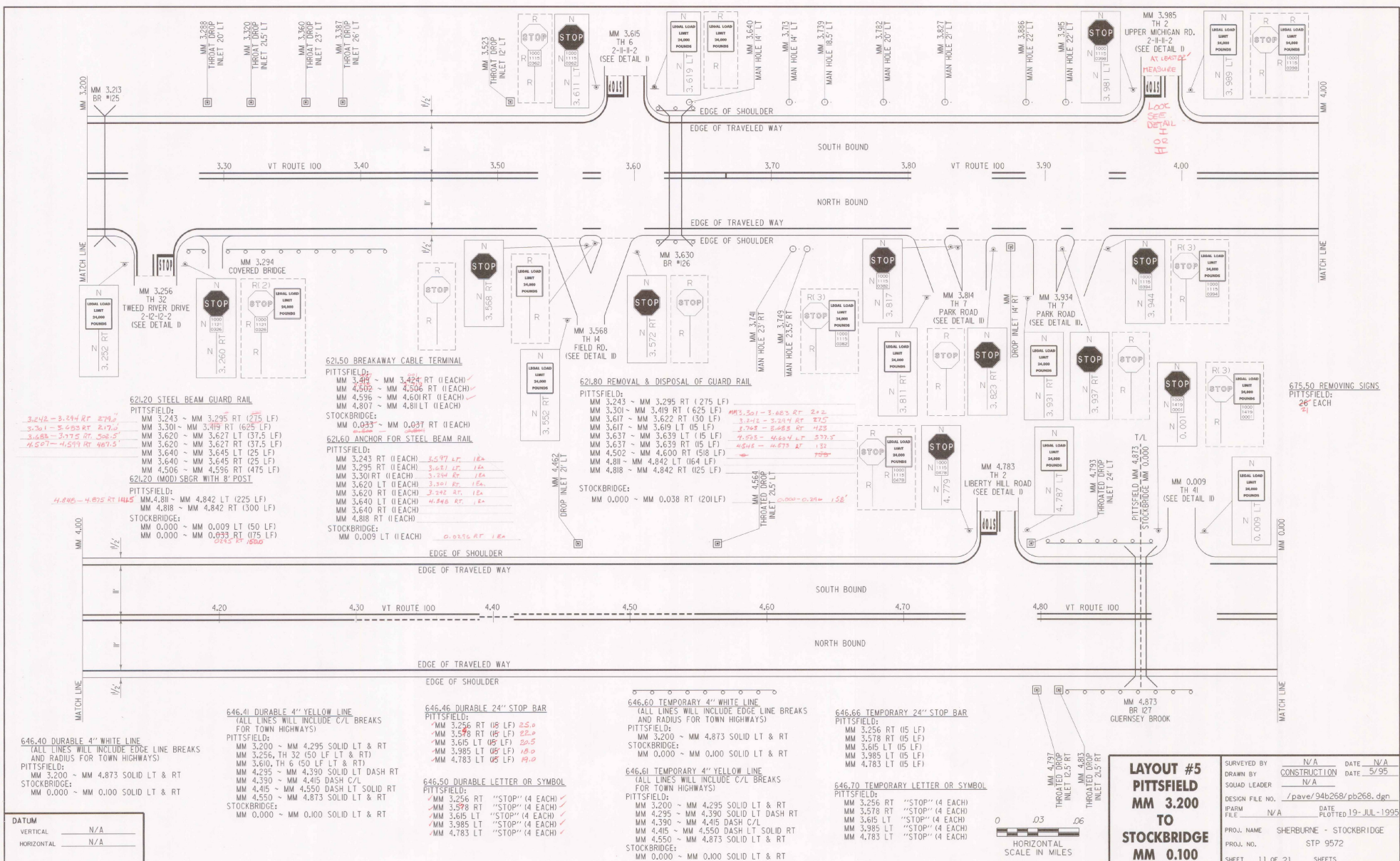

621.20 STEEL BEAM GUARD RAIL
 PITTSFIELD:
 MM 3.243 ~ MM 3.295 RT (275 LF)
 MM 3.301 ~ MM 3.419 RT (625 LF)
 MM 3.620 ~ MM 3.627 RT (37.5 LF)
 MM 3.620 ~ MM 3.627 RT (37.5 LF)
 MM 3.640 ~ MM 3.645 RT (25 LF)
 MM 3.640 ~ MM 3.645 RT (25 LF)
 MM 4.506 ~ MM 4.596 RT (475 LF)
 PITTSFIELD:
 MM 4.818 ~ MM 4.842 LT (225 LF)
 MM 4.818 ~ MM 4.842 RT (300 LF)
 STOCKBRIDGE:
 MM 0.000 ~ MM 0.009 LT (50 LF)
 MM 0.000 ~ MM 0.033 RT (75 LF)

621.50 BREAKAWAY CABLE TERMINAL
 PITTSFIELD:
 MM 3.495 ~ MM 3.424 RT (1 EACH)
 MM 4.502 ~ MM 4.506 RT (1 EACH)
 MM 4.596 ~ MM 4.601 RT (1 EACH)
 MM 4.801 ~ MM 4.811 RT (1 EACH)
 STOCKBRIDGE:
 MM 0.033 ~ MM 0.037 RT (1 EACH)

621.60 ANCHOR FOR STEEL BEAM RAIL
 PITTSFIELD:
 MM 3.243 RT (1 EACH) 3.597 LF 1EA
 MM 3.295 RT (1 EACH) 3.627 LF 1EA
 MM 3.301 RT (1 EACH) 3.627 LF 1EA
 MM 3.620 LT (1 EACH) 3.620 RT 1EA
 MM 3.620 RT (1 EACH) 3.627 LF 1EA
 MM 3.640 LT (1 EACH) 3.640 RT 1EA
 MM 3.640 RT (1 EACH) 4.488 RT 1EA
 MM 4.818 RT (1 EACH) 4.818 RT 1EA
 STOCKBRIDGE:
 MM 0.009 LT (1 EACH) 0.033 RT 1EA

621.80 REMOVAL & DISPOSAL OF GUARD RAIL
 PITTSFIELD:
 MM 3.243 ~ MM 3.295 RT (275 LF)
 MM 3.301 ~ MM 3.419 RT (625 LF)
 MM 3.617 ~ MM 3.619 LT (15 LF)
 MM 3.617 ~ MM 3.619 LT (15 LF)
 MM 3.637 ~ MM 3.639 LT (15 LF)
 MM 3.637 ~ MM 3.639 RT (15 LF)
 MM 4.502 ~ MM 4.600 RT (150 LF)
 MM 4.818 ~ MM 4.842 LT (104 LF)
 MM 4.818 ~ MM 4.842 RT (125 LF)
 STOCKBRIDGE:
 MM 0.000 ~ MM 0.038 RT (20 LF)

646.40 DURABLE 4" WHITE LINE
 (ALL LINES WILL INCLUDE EDGE LINE BREAKS AND RADIUS FOR TOWN HIGHWAYS)
 PITTSFIELD:
 MM 3.200 ~ MM 4.873 SOLID LT & RT
 MM 3.256, TH 32 (50 LF LT & RT)
 MM 3.610, TH 6 (50 LF LT & RT)
 MM 4.235 ~ MM 4.390 SOLID LT DASH RT
 MM 4.390 ~ MM 4.415 DASH LT
 MM 4.415 ~ MM 4.550 DASH LT SOLID RT
 MM 4.550 ~ MM 4.873 SOLID LT & RT
 STOCKBRIDGE:
 MM 0.000 ~ MM 0.100 SOLID LT & RT

646.41 DURABLE 4" YELLOW LINE
 (ALL LINES WILL INCLUDE C/L BREAKS FOR TOWN HIGHWAYS)
 PITTSFIELD:
 MM 3.200 ~ MM 4.295 SOLID LT & RT
 MM 3.256, TH 32 (50 LF LT & RT)
 MM 3.610, TH 6 (50 LF LT & RT)
 MM 4.235 ~ MM 4.390 SOLID LT DASH RT
 MM 4.390 ~ MM 4.415 DASH LT
 MM 4.415 ~ MM 4.550 DASH LT SOLID RT
 MM 4.550 ~ MM 4.873 SOLID LT & RT
 STOCKBRIDGE:
 MM 0.000 ~ MM 0.100 SOLID LT & RT

646.46 DURABLE 24" STOP BAR
 (ALL LINES WILL INCLUDE C/L BREAKS FOR TOWN HIGHWAYS)
 PITTSFIELD:
 MM 3.256 RT (15 LF) 25.0
 MM 3.578 RT (15 LF) 22.0
 MM 3.615 LT (15 LF) 22.5
 MM 3.985 LT (15 LF) 19.0
 MM 4.783 LT (15 LF) 19.0

646.50 DURABLE LETTER OR SYMBOL
 PITTSFIELD:
 MM 3.256 RT "STOP" (4 EACH)
 MM 3.578 RT "STOP" (4 EACH)
 MM 3.615 LT "STOP" (4 EACH)
 MM 3.985 LT "STOP" (4 EACH)
 MM 4.783 LT "STOP" (4 EACH)

646.60 TEMPORARY 4" WHITE LINE
 (ALL LINES WILL INCLUDE EDGE LINE BREAKS AND RADIUS FOR TOWN HIGHWAYS)
 PITTSFIELD:
 MM 3.200 ~ MM 4.873 SOLID LT & RT
 STOCKBRIDGE:
 MM 0.000 ~ MM 0.100 SOLID LT & RT

646.61 TEMPORARY 4" YELLOW LINE
 (ALL LINES WILL INCLUDE C/L BREAKS FOR TOWN HIGHWAYS)
 PITTSFIELD:
 MM 3.200 ~ MM 4.295 SOLID LT & RT
 MM 4.295 ~ MM 4.390 SOLID LT DASH RT
 MM 4.390 ~ MM 4.415 DASH C/L
 MM 4.415 ~ MM 4.550 DASH LT SOLID RT
 MM 4.550 ~ MM 4.873 SOLID LT & RT
 STOCKBRIDGE:
 MM 0.000 ~ MM 0.100 SOLID LT & RT

646.66 TEMPORARY 24" STOP BAR
 PITTSFIELD:
 MM 3.256 RT (15 LF)
 MM 3.578 RT (15 LF)
 MM 3.615 LT (15 LF)
 MM 3.985 LT (15 LF)
 MM 4.783 LT (15 LF)

646.70 TEMPORARY LETTER OR SYMBOL
 PITTSFIELD:
 MM 3.256 RT "STOP" (4 EACH)
 MM 3.578 RT "STOP" (4 EACH)
 MM 3.615 LT "STOP" (4 EACH)
 MM 3.985 LT "STOP" (4 EACH)
 MM 4.783 LT "STOP" (4 EACH)

DATUM
 VERTICAL N/A
 HORIZONTAL N/A

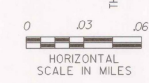

LAYOUT #5		SURVEYED BY	N/A	DATE	N/A
PITTSFIELD		DRAWN BY	CONSTRUCTION	DATE	5/95
MM 3.200		SQUAD LEADER	N/A		
TO		DESIGN FILE NO.	/pave/94b268/pb268.dgn		
STOCKBRIDGE		FARM	N/A	DATE	PLOTTED 19-JUL-1995
MM 0.100		PROJ. NAME	SHERBURNE - STOCKBRIDGE		
		PROJ. NO.	STP 9572		
		SHEET	11 of 21	SHEETS	

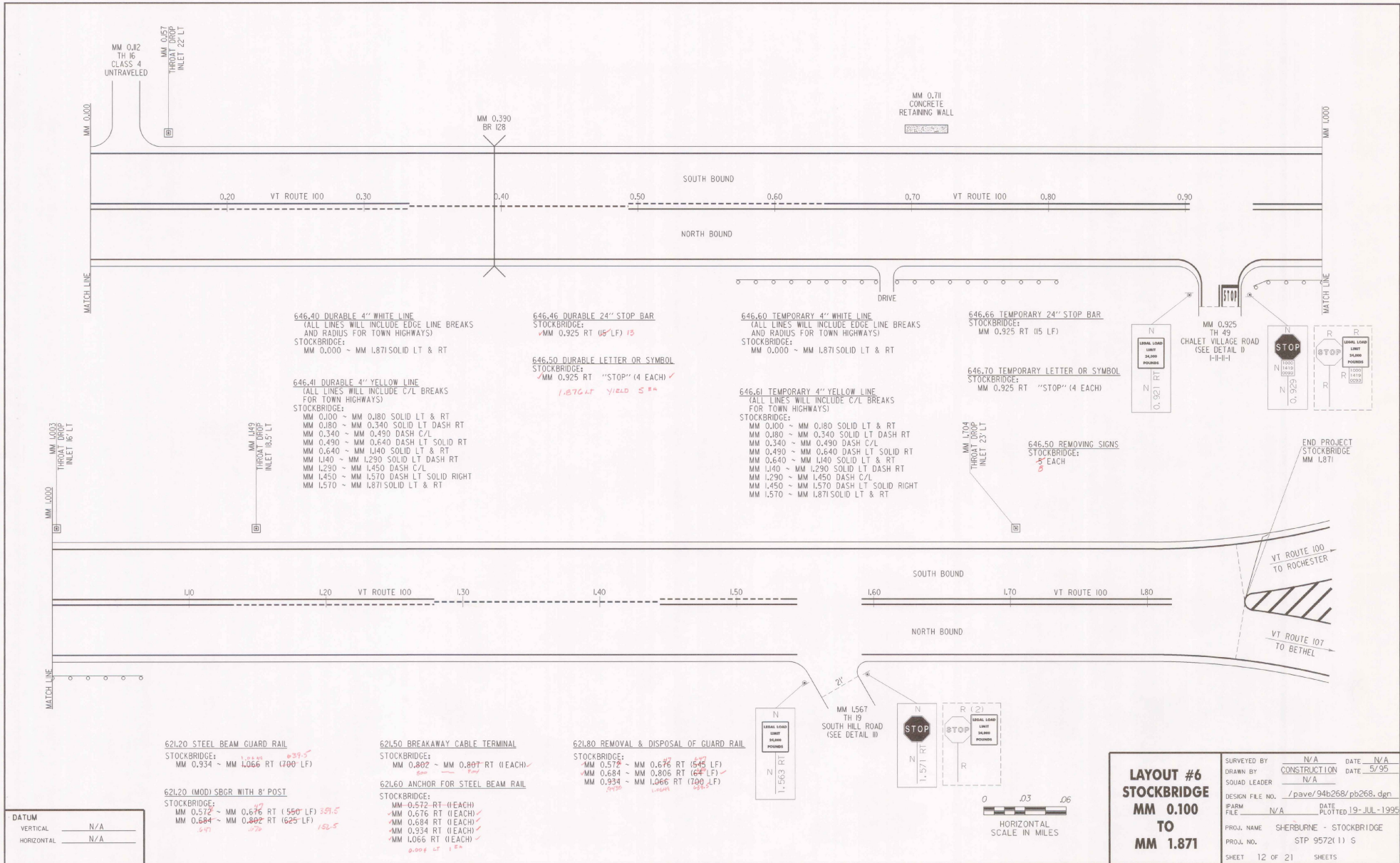

DATUM	
VERTICAL	N/A
HORIZONTAL	N/A

62L20 STEEL BEAM GUARD RAIL
 STOCKBRIDGE:
 MM 0.334 ~ MM 1.066 RT (700 LF)
 289.5
 62L20 (MOD) SBGR WITH 8' POST
 STOCKBRIDGE:
 MM 0.572 ~ MM 0.676 RT (150' LF) 391.5
 MM 0.684 ~ MM 0.802 RT (625 LF) 152.5
 541 270

62L50 BREAKAWAY CABLE TERMINAL
 STOCKBRIDGE:
 MM 0.802 ~ MM 0.807 RT (1 EACH)
 62L60 ANCHOR FOR STEEL BEAM RAIL
 STOCKBRIDGE:
 MM 0.572 RT (1 EACH)
 MM 0.576 RT (1 EACH)
 MM 0.584 RT (1 EACH)
 MM 0.334 RT (1 EACH)
 MM 1.066 RT (1 EACH)
 0.800 RT 1.2"

62L80 REMOVAL & DISPOSAL OF GUARD RAIL
 STOCKBRIDGE:
 MM 0.578 ~ MM 0.676 RT (545 LF)
 MM 0.684 ~ MM 0.806 RT (64 LF)
 MM 0.934 ~ MM 1.066 RT (700 LF)
 545 64 700

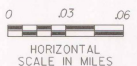

LAYOUT #6		SURVEYED BY N/A DATE N/A	
		DRAWN BY CONSTRUCTION DATE 5/95	
MM 0.100		SQUAD LEADER N/A	
		DESIGN FILE NO. /pave/94b268/pb268.dgn	
TO		#P&M FILE N/A DATE PLOTTED 19-JUL-1995	
		PROJ. NAME SHERBURNE - STOCKBRIDGE	
MM 1.871		PROJ. NO. STP 9572(1) S	
		SHEET 12 OF 21 SHEETS	

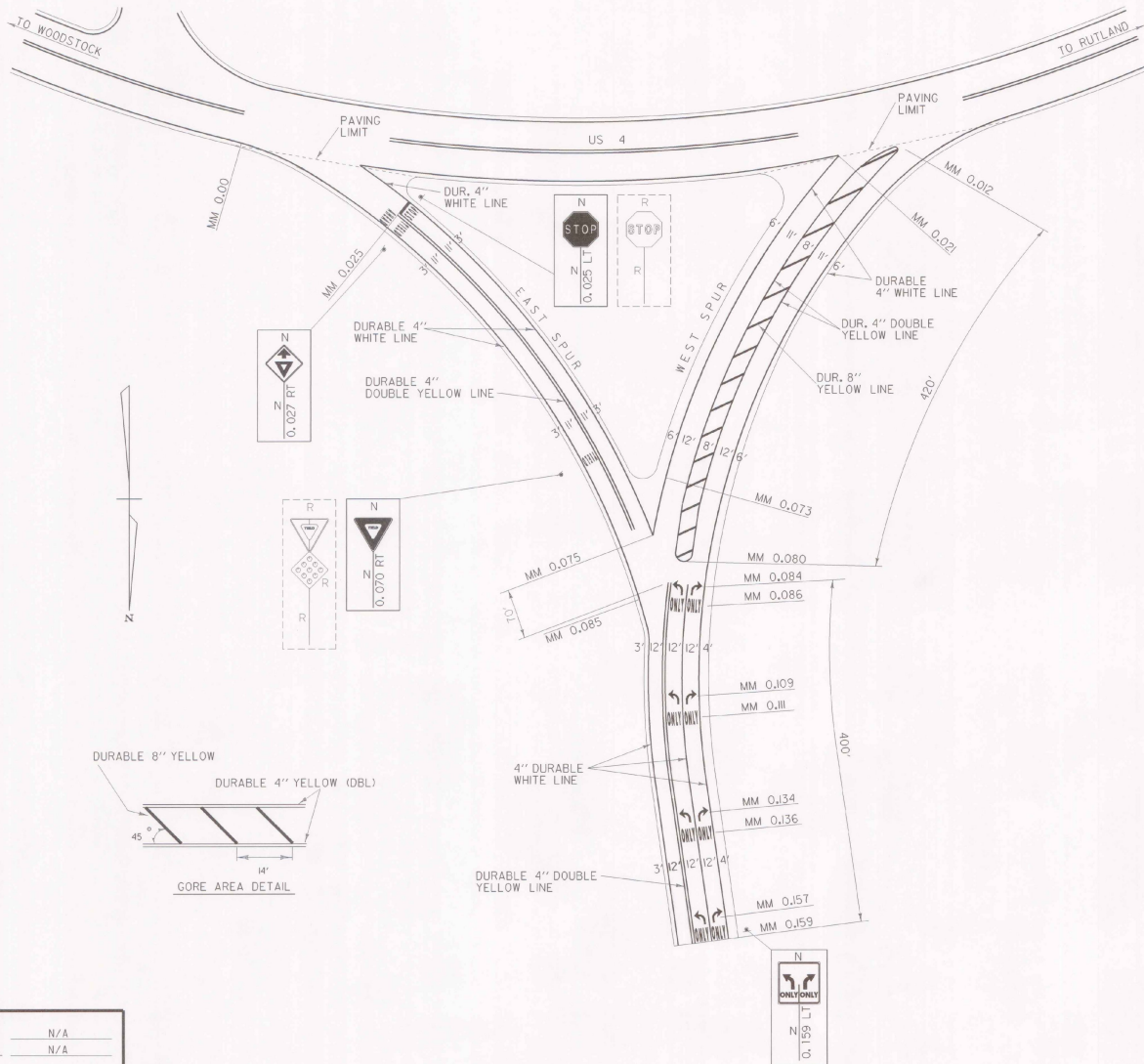

DURABLE 4" WHITE LINE

EAST SPUR
 MM 0.000 ~ MM 0.085 RT
 MM 0.025 ~ MM 0.075 LT
 WEST SPUR
 MM 0.021 ~ MM 0.075 RT
 MM 0.000 ~ MM 0.084 LT
 MM 0.077 ~ MM 0.084 LT-12'
 VT 100
 MM 0.084 ~ MM 0.200 RT-II'
 MM 0.084 ~ MM 0.200 LT-22'
 MM 0.084 ~ MM 0.159 LT-II'
 MM 0.159 ~ MM 0.187 LT-II' (DASH)

TEMPORARY 4" YELLOW LINE

EAST SPUR
 MM 0.025 ~ MM 0.075 (SOLID LT & RT)
 WEST SPUR
 MM 0.012 ~ MM 0.080 (GORE EDGE LINES)
 VT 100
 (DOUBLE LINE)
 MM 0.084 ~ MM 0.200 (SOLID LT & RT)

DURABLE 8" YELLOW LINE

WEST SPUR
 MM 0.012 ~ MM 0.080 (GORE STRIPES)

DURABLE LETTER OR SYMBOL

EAST SPUR
 MM 0.025 LT, "STOP" (4 EACH)
 MM 0.030 LT, "YIELD AHEAD" (10 EACH)
 MM 0.060 LT, "YIELD" (5 EACH)
 VT 100
 MM 0.084 LT, (II EACH)
 MM 0.084 LT, (I EACH)
 MM 0.086 LT, "ONLY" (4 EACH)
 MM 0.086 LT, "ONLY" (4 EACH)
 MM 0.109 LT, (II EACH)
 MM 0.109 LT, (I EACH)
 MM 0.111 LT, "ONLY" (4 EACH)
 MM 0.111 LT, "ONLY" (4 EACH)
 MM 0.134 LT, (II EACH)
 MM 0.134 LT, (I EACH)
 MM 0.136 LT, "ONLY" (4 EACH)
 MM 0.136 LT, "ONLY" (4 EACH)
 MM 0.157 LT, (II EACH)
 MM 0.157 LT, (I EACH)
 MM 0.159 LT, "ONLY" (4 EACH)
 MM 0.159 LT, "ONLY" (4 EACH)

DURABLE 24" STOP BAR

EAST SPUR
 MM 0.026 LT (15')

REMOVING SIGNS

3 EACH

TEMPORARY 4" WHITE LINE

EAST SPUR
 MM 0.000 ~ MM 0.085 RT
 MM 0.025 ~ MM 0.075 LT
 WEST SPUR
 MM 0.021 ~ MM 0.075 RT
 MM 0.000 ~ MM 0.084 LT
 MM 0.077 ~ MM 0.084 LT-12'
 VT 100
 MM 0.084 ~ MM 0.200 RT-II'
 MM 0.084 ~ MM 0.200 LT-22'
 MM 0.084 ~ MM 0.159 LT-II'
 MM 0.159 ~ MM 0.187 LT-II' (DASH)

DURABLE 4" YELLOW LINE

EAST SPUR
 MM 0.025 ~ MM 0.075 (SOLID LT & RT)
 WEST SPUR
 MM 0.012 ~ MM 0.080 (GORE EDGE LINES)
 VT 100
 (DOUBLE LINE)
 MM 0.084 ~ MM 0.200 (SOLID LT & RT)

TEMPORARY LETTER OR SYMBOL

EAST SPUR
 MM 0.025 LT, "STOP" (4 EACH)
 MM 0.030 LT, "YIELD AHEAD" (10 EACH)
 MM 0.060 LT, "YIELD" (5 EACH)
 VT 100
 MM 0.084 LT, (II EACH)
 MM 0.084 LT, (I EACH)
 MM 0.157 LT, (II EACH)
 MM 0.157 LT, (I EACH)

TEMPORARY 24" STOP BAR

EAST SPUR
 MM 0.026 LT (15')

DATUM	
VERTICAL	N/A
HORIZONTAL	N/A

INTERSECTION OF VT ROUTE 100 & US ROUTE 4 DETAIL	SURVEYED BY	N/A	DATE	N/A
	DRAWN BY	CONSTRUCTION	DATE	5/95
	SQUAD LEADER	N/A		
	DESIGN FILE NO.	/pave/94b268/pb268.dgn		
	PARM FILE	N/A	DATE PLOTTED	19-JUL-1995
PROJ. NAME	SHERBURNE - STOCKBRIDGE			
PROJ. NO.	STP 95721 1) S			
SHEET	13	OF	21	SHEETS

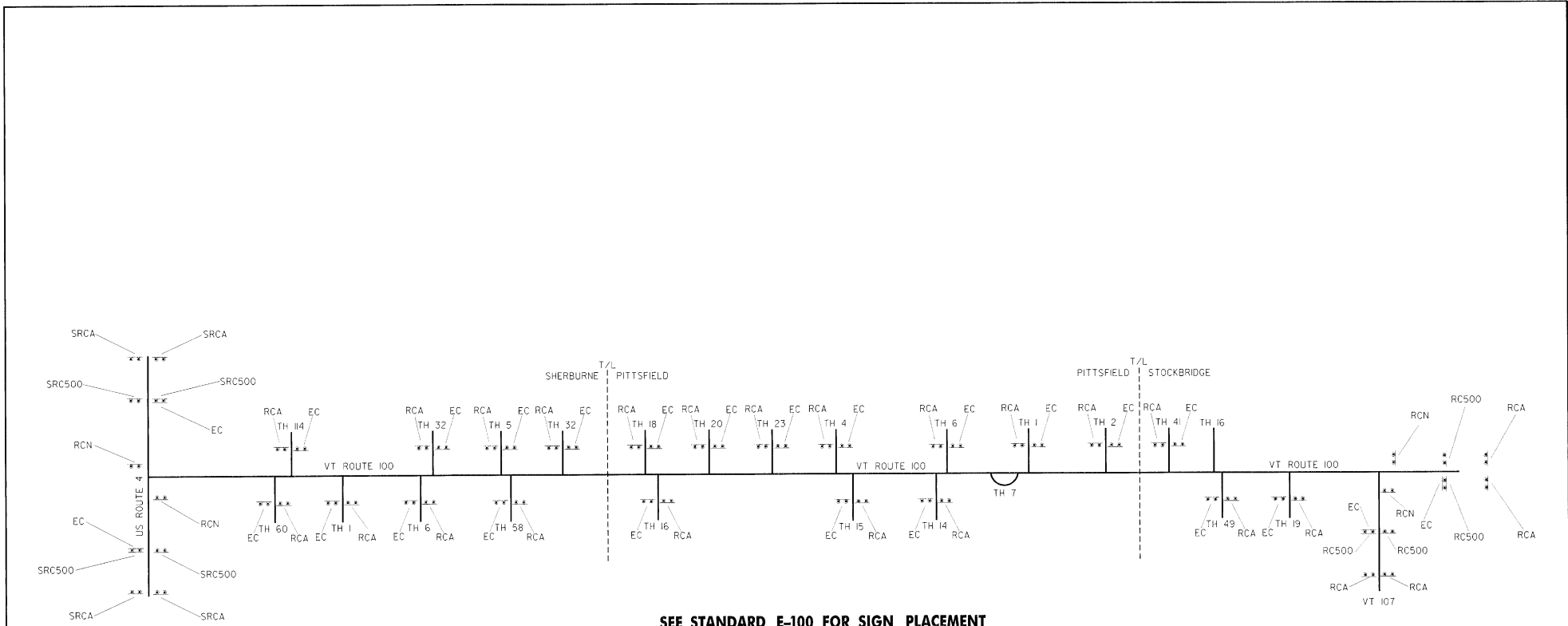

SEE STANDARD E-100 FOR SIGN PLACEMENT

LEGEND
 EC = END CONSTRUCTION
 RC500 = ROAD CONSTRUCTION 500 FT
 RCA = ROAD CONSTRUCTION AHEAD
 RCN = ROAD CONSTRUCTION NEAR
 SRCA = SIDE ROAD CONSTRUCTION AHEAD

DATUM	
VERTICAL	N/A
HORIZONTAL	N/A

CONSTRUCTION SIGN DETAIL SHEET	SURVEYED BY	N/A	DATE	N/A
	DRAWN BY	CONSTRUCTION	DATE	5/95
	SQUAD LEADER	N/A		
	DESIGN FILE NO.	/pave/94b268/pb268.dgn		
	PARM FILE	N/A	DATE	PLOTTED 21-JUL-1995
PROJ. NAME	SHERBURNE - STOCKBRIDGE			
PROJ. NO.	STP 9572111 S			
SHEET	14	OF	21	SHEETS

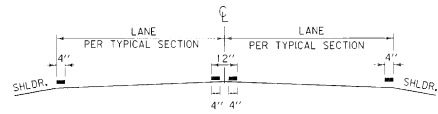

**PAVEMENT MARKING PLACEMENT DETAIL
TYPICAL**

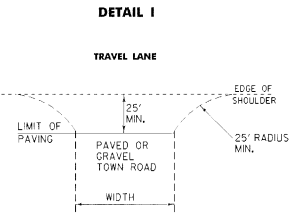

**DETAIL I
PAVING LIMITS FOR TOWN ROADS
NOT TO SCALE**

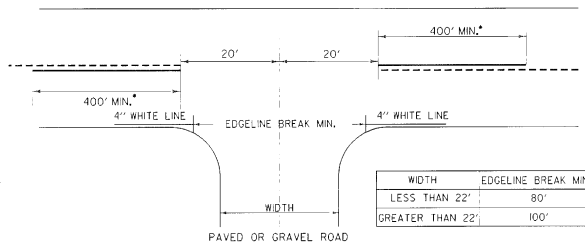

A SOLID LINE IN THE DIRECTION OF TRAVEL IS BEGUN AT A LOCATION 400 FEET IN ADVANCE OF THE INTERSECTION. THE DISTANCE IS MEASURED FROM A POINT 20 FEET IN ADVANCE OF THE CENTERLINE OF THE INTERSECTING ROADWAY.

- CENTERLINE TREATMENT SHALL CONSIST OF A MINIMUM OF 400 FEET OF SOLID LINE IN ADVANCE OF THE INTERSECTION AND SHALL BE PAIRED WITH EITHER A SOLID OR DASHED LINE DEPENDING ON SIGHT DISTANCE AVAILABILITY IN THE OPPOSING LANE.

**APPROACH TO A SIDE ROAD INTERSECTION
TYPICAL**

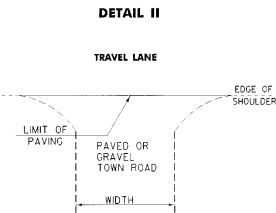

**DETAIL II
PAVING LIMITS FOR TOWN ROADS
NOT TO SCALE**

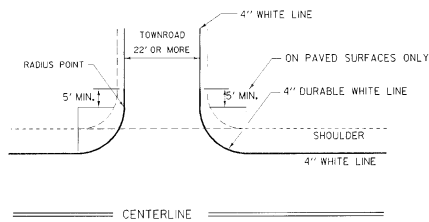

NOTE: EDGELINE RADI WILL BE 35' UNLESS OTHERWISE NOTED ON THE LAYOUTS.

DURABLE EDGELINE RADIUS LAYOUT TYPICAL FOR TOWN ROADS

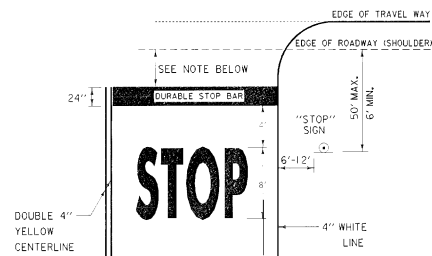

THE "DESIRED STOPPING POINT" IS THE LOCATION BASED ON SITE CONDITIONS THAT BEST ALLOWS THE STOPPED VEHICLE TO VIEW THE APPROACHING TRAFFIC. IN NO CASE MORE THAN 30 FEET OR LESS THAN 4 FEET FROM THE NEAREST EDGE OF THE INTERSECTING ROADWAY.

STOP BAR DETAIL

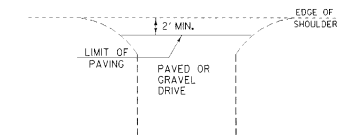

**PAVING LIMITS FOR DRIVES
NOT TO SCALE**

**PAVEMENT
MARKING
AND PAVING
LIMIT SHEET**

SURVEYED BY	N/A	DATE	N/A
DRAWN BY	CONSTRUCTION	DATE	5/95
SQUAD LEADER	N/A		
DESIGN FILE NO.	/pave/94b268/pb268.dgn		
PARM FILE	N/A	DATE PLOTTED	19-JUL-1995
PROJ. NAME	SHERBURNE - STOCKBRIDGE		
PROJ. NO.	STP 9572(1) S		
SHEET	21 OF 21	SHEETS	

Vermont Agency of
Transportation
Phase III- Interstate
#090303-01

INITIALS

Hanger 3662

1996
PAVING
VT. 100 VS. 4

SHERBURNE - STOCKBRIDGE
STP 9572 (1)S