

STATE OF VERMONT  
AGENCY OF TRANSPORTATION

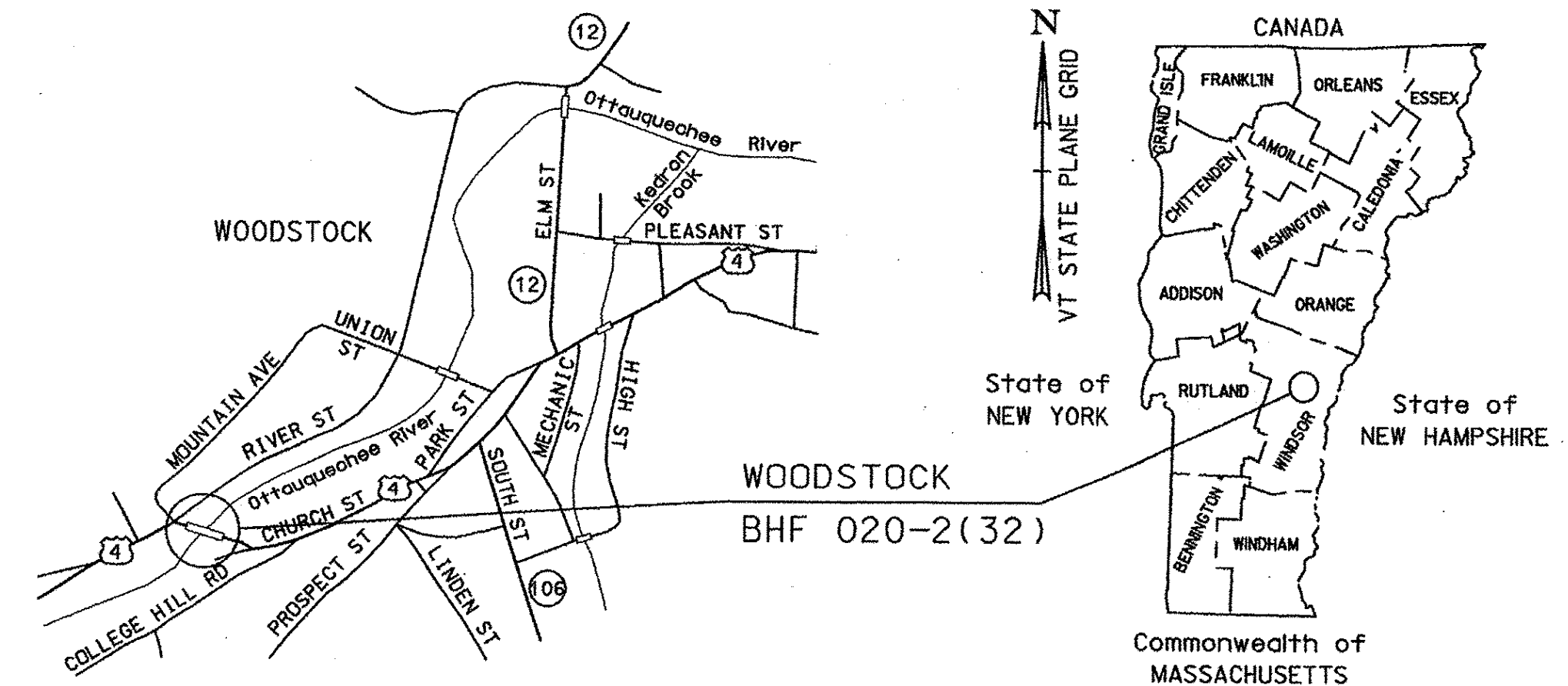

PROPOSED IMPROVEMENT  
BRIDGE PROJECT  
TOWN OF WOODSTOCK  
COUNTY OF WINDSOR

US ROUTE 4 (PRINCIPAL ARTERIAL) BRIDGE NO. 50



LOCATION MAP

INDEX OF SHEETS

- 1 TITLE SHEET
- 2 PRELIMINARY INFORMATION SHEET
- 3 QUANTITY SHEET (1 OF 5)
- 4 QUANTITY SHEET (2 OF 5)
- 5 QUANTITY SHEET (3 OF 5)
- 6 QUANTITY SHEET (4 OF 5)
- 7 QUANTITY SHEET (5 OF 5)
- 8-9 RIGHT-OF-WAY SHEETS
- 10 SURVEY TIE SHEET
- 11 TYPICAL SECTION AND DETAILS
- 12 PLAN
- 13 PROFILE
- 14 TRAFFIC SIGN SUMMARY SHEET
- 15 REGIONAL DETOUR
- 16 REGIONAL DETOUR SIGNS
- 17 VILLAGE TRAFFIC CONTROL PLAN
- 18 BORING LAYOUT
- 19 BORING LOGS (1 OF 2)
- 20 BORING LOGS (2 OF 2)
- 21 BRIDGE PLAN & ELEVATION
- 22 GENERAL NOTES (1 OF 2)
- 23 GENERAL NOTES (2 OF 2)
- 24 BRIDGE TYPICAL SECTION
- 25 MISCELLANEOUS DETAILS
- 26 BRIDGE RAIL AND LIGHTING LAYOUT
- 27 OVERLAY REINFORCEMENT (1 OF 2)
- 28 OVERLAY REINFORCEMENT (2 OF 2)
- 29 SPAN 1 FRAMING PLAN
- 30 SPAN 2 FRAMING PLAN
- 31 SPAN 3 FRAMING PLAN
- 32 SPAN 1 & 3 BOX BEAM TYPICAL SECTIONS
- 33 SPAN 2 BOX BEAM TYPICAL SECTIONS
- 34 BOX BEAM DETAILS (1 OF 2)
- 35 BOX BEAM DETAILS (2 OF 2)
- 36 SUPERSTRUCTURE DETAILS
- 37 ABUTMENT REMOVAL & REPAIR
- 38 ABUTMENT 1
- 39 ABUTMENT 2
- 40 PIER REMOVAL & REPAIR DETAILS
- 41 PIER NO. 1 & NO. 2
- 42 RETAINING WALL LAYOUT (1 OF 2)
- 43 RETAINING WALL LAYOUT (2 OF 2)
- 44 RETAINING WALL DETAILS
- 45 BRIDGE LIGHTING DETAILS
- 46 APPROACH RAILING DETAILS (1 OF 2)
- 47 APPROACH RAILING DETAILS (2 OF 2)
- 48 BRIDGE RAILING DETAILS (1 OF 2)
- 49 BRIDGE RAILING DETAILS (2 OF 2)
- 50 REINFORCING STEEL SCHEDULE
- 51-56 EXISTING PLANS
- 57 EROSION CONTROL NARRATIVE
- 58 EXISTING CONDITIONS PLAN
- 59 EROSION PREVENTION & SEDIMENT CONTROL (EPSC) PLAN
- 60 FINAL CONDITIONS SITE PLAN
- 61 EPSC-1
- 62 EPSC-2
- 63 EPSC-3
- 64 EPSC-4
- 65 EPSC-5
- 66 EPSC-6
- 67-68 US ROUTE 4 CROSS SECTIONS
- 69-71 CHANNEL CROSS SECTIONS

PROJECT LOCATION: BEGINNING AT A POINT 0.31 MILES WEST OF THE JUNCTION OF US ROUTE 4 AND VT 106 AND EXTENDING EASTERLY 0.10 MILES.

PROJECT DESCRIPTION: REMOVAL OF EXISTING SUPERSTRUCTURE, CONSTRUCTION OF PRESTRESSED CONCRETE BOX BEAM AND CONCRETE OVERLAY SUPERSTRUCTURE, REHABILITATION OF EXISTING SUBSTRUCTURE, CONSTRUCTION OF NEW RETAINING WALLS AND RELATED CHANNEL WORK.

LENGTH OF STRUCTURE: 201.72  
202+54 FEET

LENGTH OF ROADWAY: 147.46 FEET

LENGTH OF PROJECT: 350 FEET

STANDARDS

B-5	06-01-94	E-119	03-01-04
B-71	07-08-05	E-121	08-08-95
C-1	01-03-00	E-123	03-16-04
C-2B	10-14-05	E-127	08-08-95
C-3A	09-01-04	E-136A	08-08-95
C-3B	09-01-04	E-143	06-15-04
D-3	06-01-94	E-144	03-29-99
D-15	06-01-94	E-160	05-20-99
D-16	06-01-94	E-163	05-20-99
D-17	06-01-94	E-173	08-09-95
D-20	03-03-03	E-175	11-17-93
E-100	01-02-04	E-181	08-09-95
E-100A	01-02-04	E-191	02-01-99
E-101	05-30-03	E-192	10-12-00
E-102	06-30-03	E-193	08-18-95
E-102A	05-01-04	G-1	01-03-00
E-106	03-01-04	G-1D	01-03-00
E-107	06-30-03	G-18	06-01-94
E-107A	08-08-95	G-19	11-15-02
E-108	08-18-95		

RECORD PLANS

CONTRACTOR: T. BUCK CONSTRUCTION, INC. - AUBURN, ME  
 RESIDENT ENGINEER: DARYL BASSETT  
 CONSTRUCTION BEGAN: MARCH 7, 2007  
 CONSTRUCTION COMPLETE: NOVEMBER 20, 2007  
 RECORD PLANS BY: DARYL BASSETT & AMOS KEMPTON

I HEREBY CERTIFY THAT ALL THE CONSTRUCTION REQUIRED BY THIS SET OF DRAWINGS HAS BEEN ACCOMPLISHED AS INDICATED HEREIN.

BY *Daryl Bassett* RESIDENT ENGINEER  
 DATE 10/2/12

NOTE: Any further information concerning final quantities, amounts or other details relative to this project may be found at Central Files in the electronic archives.

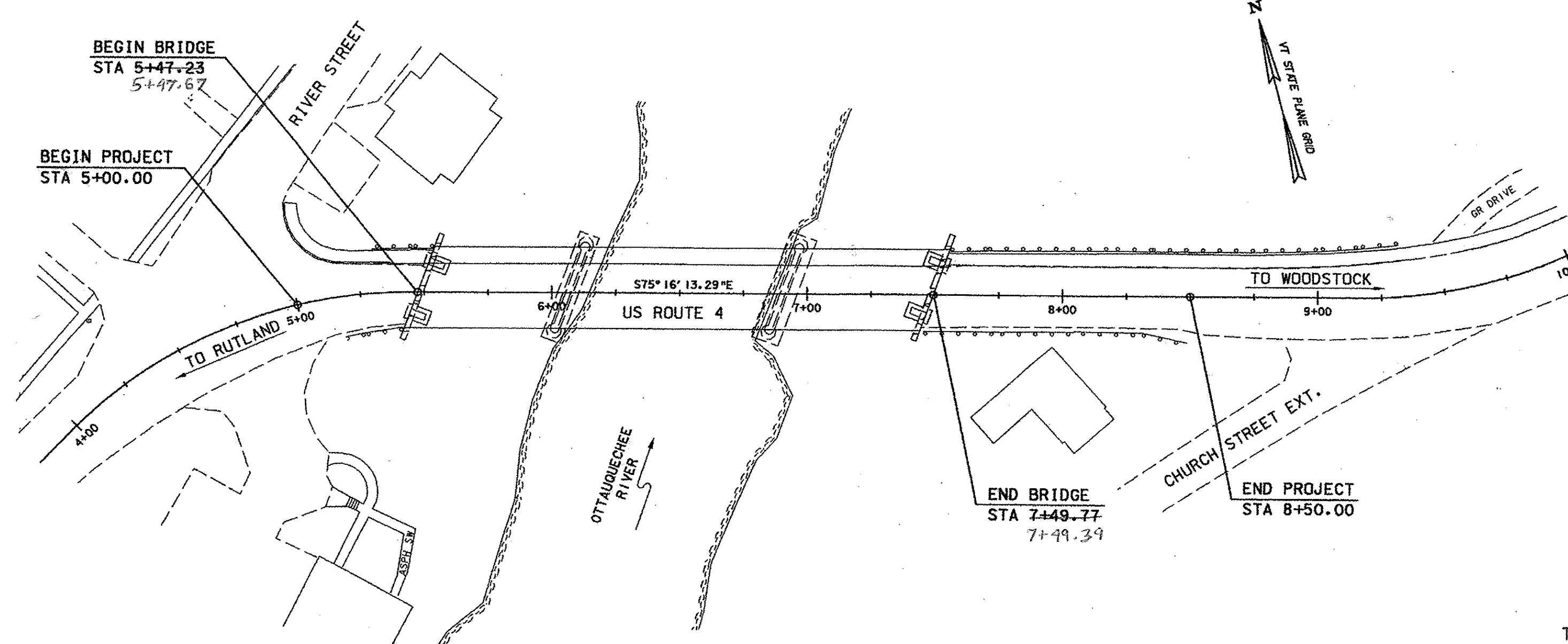

PLAN  
SCALE: 1" = 400'

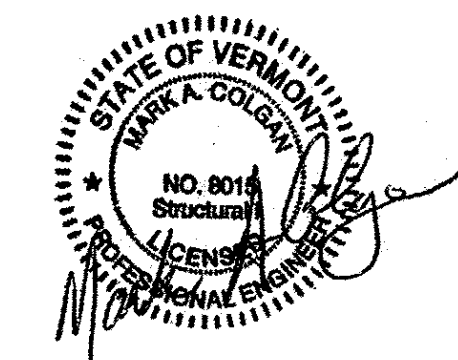

THESE PLANS ARE SUBJECT TO SUCH ENGINEERING CHANGES AS MAY BE REQUIRED BY THE FEDERAL HIGHWAY ADMINISTRATION OR THE DIRECTOR OF PROGRAM DEVELOPMENT. CONSTRUCTION IS TO BE CARRIED ON IN ACCORDANCE WITH THESE PLANS AND THE STANDARD SPECIFICATIONS FOR CONSTRUCTION DATED 2001, AS APPROVED BY THE FEDERAL HIGHWAY ADMINISTRATION ON JANUARY 4, 2001 FOR USE ON THIS PROJECT, INCLUDING ALL SUBSEQUENT REVISIONS AND SUCH REVISED SPECIFICATIONS AND SPECIAL PROVISIONS AS ARE INCORPORATED IN THESE PLANS.

VHB Vanasse Hangen Brustlin, Inc.

DEPARTMENT OF TRANSPORTATION  
FEDERAL HIGHWAY ADMINISTRATOR

APPROVED \_\_\_\_\_ DATE \_\_\_\_\_

DIRECTOR OF PROGRAM DEVELOPMENT

APPROVED *Rick Stearns* DATE 9-19-06

PROJECT MANAGER : CHRISTOPHER P. WILLIAMS

PROJECT NAME : WOODSTOCK

PROJECT NUMBER : BHF 020-2 (32)

SHEET 1 OF 71 SHEETS

CONVENTIONAL SYMBOLS

- COUNTY LINE
- TOWN LINE
- LIMITS OF ACCESS
- POINT OF ACCESS
- FENCE LINE
- STONE WALL
- TRAVELED WAY
- GUARD RAIL
- RAILROAD
- SURVEY LINE
- CULVERT
- POWER POLE
- TELEPHONE POLE
- TREES
- CONTROL OF ACCESS
- R.O.W. LINE
- PROPERTY LINE
- R.O.W. TAKING LINE
- SLOPE RIGHTS
- CLEAR ZONE
- TOP OF CUT
- TOE OF SLOPE

DATUM

VERTICAL NAVD 88  
 HORIZONTAL ASSUMED