

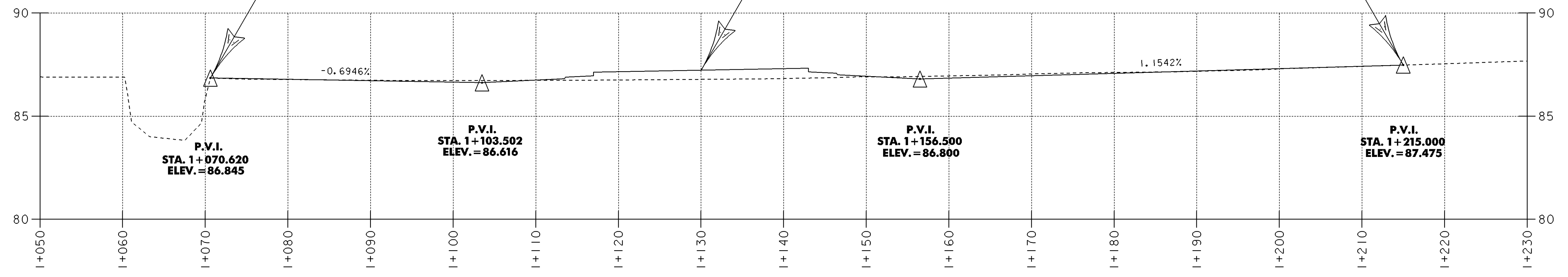

STATION 1 + 070.620
BEGIN PROJECT NH 2000(18)

STATION 1 + 215.000
END PROJECT NH 2000(18)

STATION 1 + 130.000 (U.S. ROUTE 5) =
STATION 2 + 140.000
(BRATTLEBORO STATE HIGHWAY)
(VERMONT ROUTE 9)



Profile

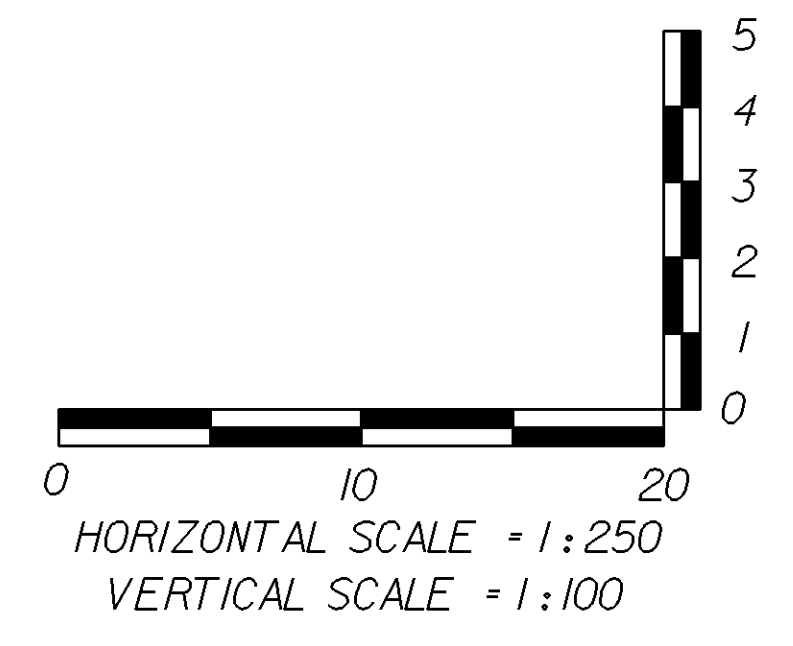

DATUM	
VERTICAL	NAVD88
HORIZONTAL	NAD83(92)

U.S. ROUTE 5

PROJECT:	BRATTLEBORO	PROJECT NO.:	NH 2000(18)
DESIGN FILE NAME:	sqdc/93d191/d191xsl.dgn	PLOT DATE:	8-APR-1999
IPARM FILE NAME:	dd191pl1	SURVEY DATE:	10/95
SURVEYED BY:	R. GILMAN	DRAWN BY:	K. UPMAL
SQUAD LEADER:	S. MENARD	SHEET:	26 OF 67