

VT STATE PLANE GRID

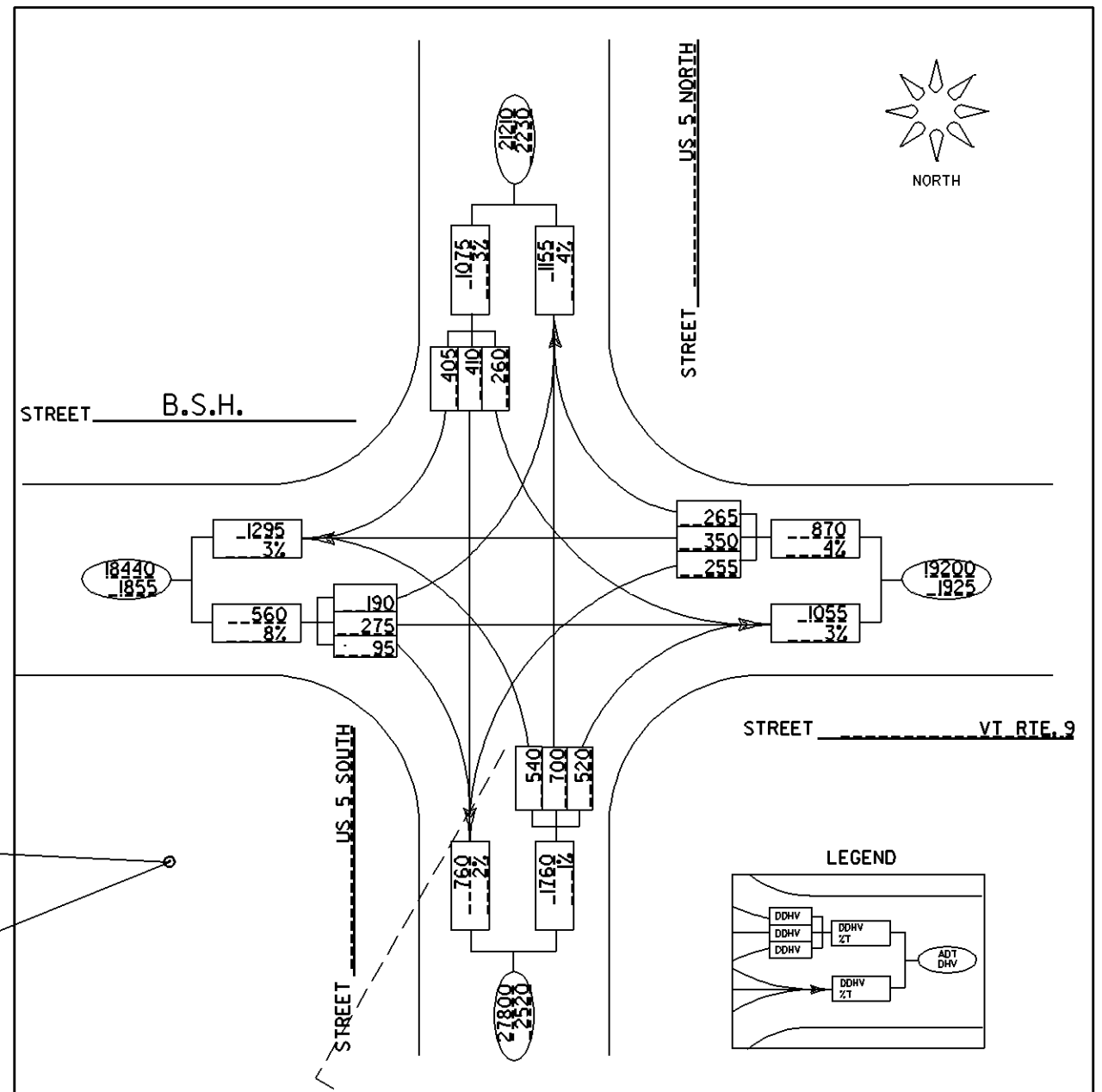
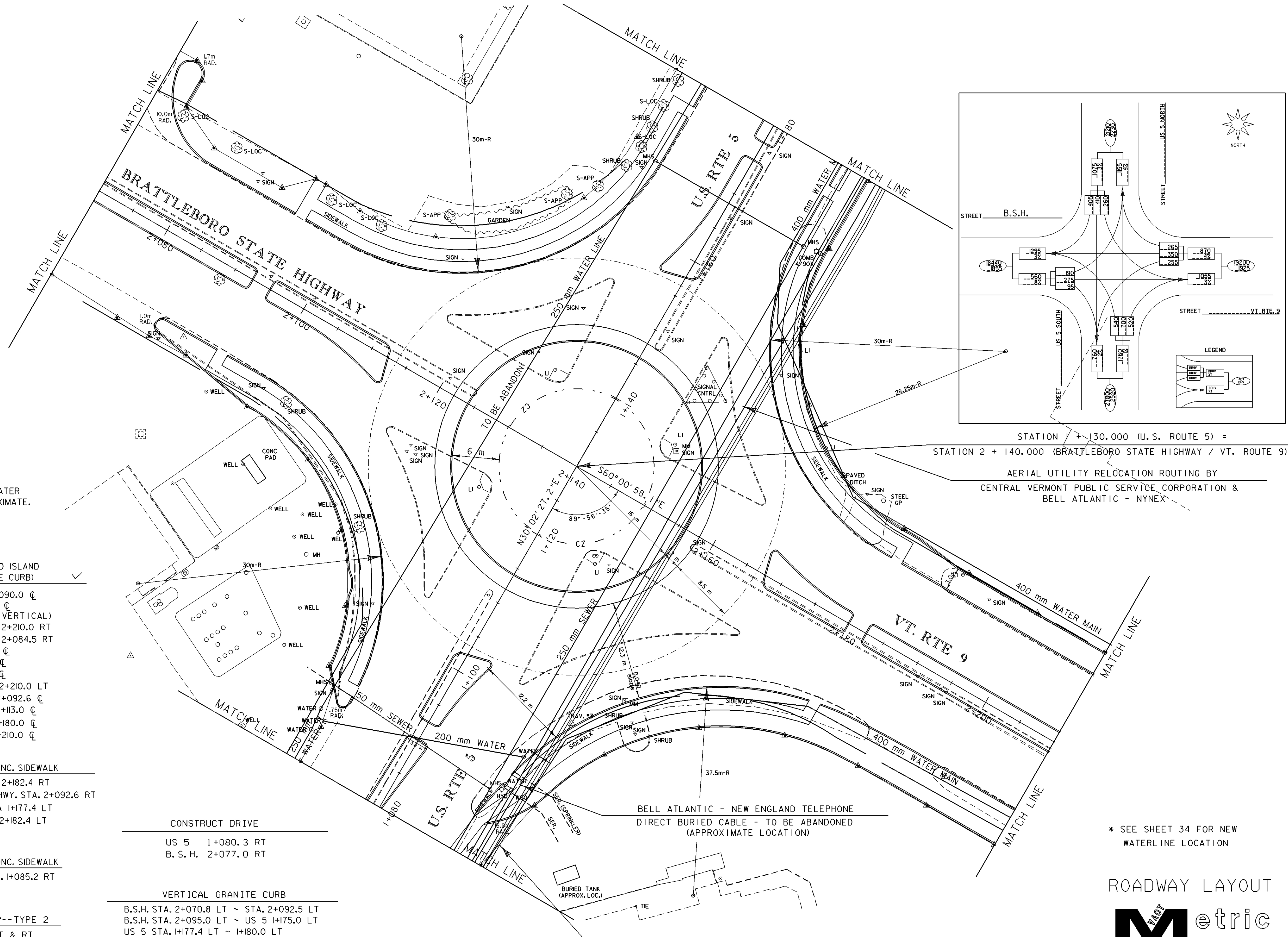

STATION 1 + 130.000 (U.S. ROUTE 5) =  
 STATION 2 + 140.000 (BRATTLEBORO STATE HIGHWAY / VT. ROUTE 9)

AERIAL UTILITY RELOCATION ROUTING BY  
 CENTRAL VERMONT PUBLIC SERVICE CORPORATION &  
 BELL ATLANTIC - NYNEX

NOTE: ALL EXISTING SEWER AND WATER  
 LINE LOCATIONS ARE APPROXIMATE.

CONSTRUCT CURBED ISLAND  
 (VERTICAL GRANITE CURB)

- US 5 STA. 1+080.0 CL ~ STA. 1+090.0 CL  
 (STA. 1+070.6 CL ~ STA. 1+090.0 CL  
 TRANSITION FROM SLOPE TO VERTICAL)
- US 5 STA. 1+084.7 RT ~ VT 9 2+210.0 RT
- US 5 STA. 1+088.5 LT ~ B.S.H. 2+084.5 RT
- US 5 STA. 1+092.4 CL ~ 1+103.0 CL
- US 5 STA. 1+157.0 CL ~ 1+175.0 CL
- US 5 STA. 1+177.4 CL ~ 1+180.0 CL
- US 5 STA. 1+180.0 RT ~ VT 9 2+210.0 LT
- B.S.H. STA. 2+070.0 CL ~ STA. 2+092.6 CL
- B.S.H. STA. 2+095.0 CL ~ STA. 2+113.0 CL
- VT 9 STA. 2+167.0 CL ~ STA. 2+180.0 CL
- VT 9 STA. 2+182.4 CL ~ STA. 2+210.0 CL

125mm PORTLAND CEMENT CONC. SIDEWALK

- US 5 STA. 1+085.2 RT ~ VT 9 STA. 2+182.4 RT
- US 5 STA. 1+090.0 LT ~ BRAT. ST. HWY. STA. 2+092.6 RT
- B.S.H. STA. 2+092.6 LT ~ U.S. 5 STA 1+177.4 LT
- US 5 STA. 1+180.0 RT ~ VT 9 STA. 2+182.4 LT

CONSTRUCT DRIVE

- US 5 1+080.3 RT
- B. S. H. 2+077.0 RT

200mm PORTLAND CEMENT CONC. SIDEWALK

- US 5 STA. 1+080.0 RT ~ STA. 1+085.2 RT

VERTICAL GRANITE CURB

- B.S.H. STA. 2+070.8 LT ~ STA. 2+092.5 LT
- B.S.H. STA. 2+095.0 LT ~ US 5 1+175.0 LT
- US 5 STA. 1+177.4 LT ~ 1+180.0 LT

CONSTRUCT SIDEWALK RAMP--TYPE 2

- B. S. H. 2+093.8 LT & RT
- VT RTE. 9 2+181.2 LT & RT
- US RTE. 5 1+091.1 LT & RT
- US RTE. 5 1+176.2 LT & RT

BELL ATLANTIC - NEW ENGLAND TELEPHONE  
 THREE DUCT CONCRETE ENCASED SYSTEM -  
 ABANDONED (APPROXIMATE LOCATION)

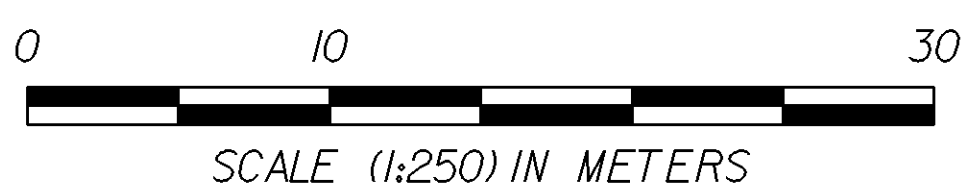

\* SEE SHEET 34 FOR NEW  
 WATERLINE LOCATION

ROADWAY LAYOUT



PROJECT: <b>BRATTLEBORO</b>	PROJECT NO.: <b>NH 2000(18)</b>
DESIGN FILE NAME: /sqdc/93d191/d191bdr.dgn	PLOT DATE: 8-APR-1999
IPARM FILE NAME: dd191L2.1	SURVEY DATE: 10-95
SURVEYED BY: R. GILMAN	DRAWN BY: K. UPMAL
SQUAD LEADER: S. MENARD	SHEET: 22 OF 67