

CON-TEC, INC. TEST BORING LOG (ENGLISH UNITS)									
PROJECT: BRIDGE NO. 36					JOB NO. 9811				
LOCATION: RT. 17, FAYSTON, VERMONT					HOLE NO. B-4				
					SHEET 1 of 1				
					START DATE 2/17/98				
					FINISH DATE 3/30/98				
					DRILLER R. Bourassa				
					HELPER A. Carter				
					INSPECTOR				
DEPTH IN FEET	CASING DEPTH PER FOOT	TYPE	SIZE	WATER	DATE	TIME	DEPTH TO BOTTOM OF CASING	DEPTH TO BOTTOM OF HOLE	SOIL DESCRIPTION
0.5'	4"	HW	NW	SS	NX				ASPHALT SAND, GRAVEL & COBBLES
5.0'	1	5'-7"	18-16	14-15	9"				Light brown, dry, medium dense f/m/c SAND & f/m/c GRAVEL, trace sil
10.0'	2	10'-12"	12-19	14-11	16"				Light brown, dry, dense f/m/c SAND & f/m/c GRAVEL, trace sil
15.0'	3	15'-16.5"	21-33	49-50/0	18"				Gray-brown, wet, very dense f/m/c SAND & embedded c/m/f GRAVEL, little silt occasional cobbles
20.0'	4	20'-20.5"	110	6"					Gray-brown, wet, very dense f/m/c SAND & embedded c/m/f GRAVEL, little silt occasional cobbles
25.0'		25'	50/0	0"					COBBLES & C/GRAVEL
30.0'									Weathered BEDROCK NX RUN - 1 29.0' - 34.0' REC 5.0' - 100% RQD 1.2' - 24% Gray, biotite quartz GNEISS
35.0'									NX RUN - 2 34.0' - 39.0' REC 4.2' - 84% RQD 2.5' - 50% Gray, biotite quartz GNEISS
40.0'									BOTTOM OF BORING Note: 1. Coring time in rock averaged 6 Min/LF; no water loss 2. Typed Driller's Field Log

WINGWALL NO. 1 BOTTOM OF FOOTING
EL. 259.45 (METRIC)

EL. 265.67 (METRIC)

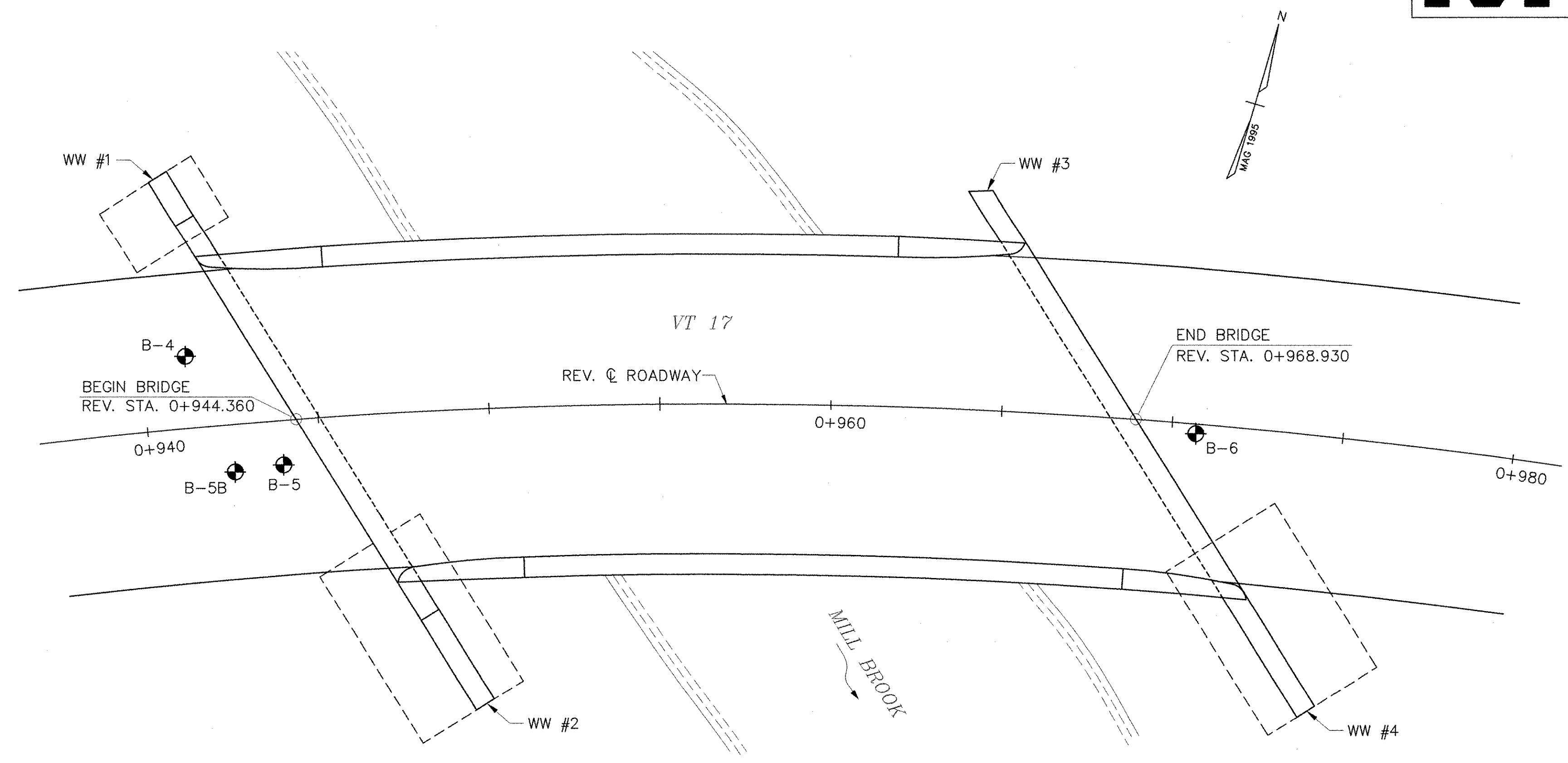

BORING PLAN
SCALE: 1:100

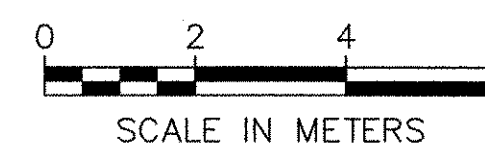

BORING NOTES

- SOIL AND ROCK CLASSIFICATIONS, PROPERTIES, AND DESCRIPTIONS ARE BASED ON ENGINEERING INTERPRETATION FROM AVAILABLE SUBSURFACE INFORMATION AND MAY NOT NECESSARILY REFLECT ACTUAL VARIATIONS IN SUBSURFACE CONDITIONS THAT MAY BE ENCOUNTERED BETWEEN INDIVIDUAL BORING OR SAMPLE LOCATIONS.
- OBSERVED WATER LEVELS AND/OR CONDITIONS INDICATED ARE AS RECORDED AT THE TIME OF EXPLORATION AND MAY VARY ACCORDING TO THE PREVAILING RAINFALL, METHODS OF EXPLORATION, AND OTHER FACTORS.
- ENGINEERING JUDGEMENT WAS EXERCISED IN PREPARING THE SUBSURFACE INFORMATION PRESENTED HEREIN. ANALYSIS AND INTERPRETATION OF SUBSURFACE DATA WAS PERFORMED AND INTERPRETED BY LAMSON ENGINEERING CORP. FOR DESIGN AND ESTIMATING PURPOSES. PRESENTATION OF THE INFORMATION IN THE CONTRACT IS INTENDED TO PROVIDE THE CONTRACTOR ACCESS TO THE SAME DATA. THE SUBSURFACE INFORMATION IS PRESENTED IN GOOD FAITH AND IS NOT INTENDED AS A SUBSTITUTE FOR PERSONAL INVESTIGATION, INDEPENDENT INTERPRETATION, INDEPENDENT ANALYSIS, OR JUDGEMENT BY THE CONTRACTOR.
- PICTORIAL STRUCTURE DETAILS SHOWN ON THE BORING PLAN LAYOUT OR SOIL PROFILES ARE FOR ILLUSTRATIVE PURPOSES ONLY AND MAY NOT ACCURATELY PORTRAY FINAL CONTRACT DETAILS.
- TERMINOLOGY USED ON BORING LOGS TO DESCRIBE THE HARDNESS, DEGREE OF WEATHERING, AND SPACING OF FRACTURES, JOINTS AND OTHER DISCONTINUITIES IN THE BEDROCK IS DEFINED IN THE AASHTO MANUAL ON SUBSURFACE INVESTIGATIONS, 1988.

BORING CHART

BORING HOLE #	STATION	OFFSET (M)	BEDROCK ELEV.
B-4	0+941.3	2.1 LT.	257.2
B-5	0+942.9	1.3 RT.	N/A
B-5B	0+943.5	1.4 RT.	255.4
B-6	0+970.7	0.3 RT.	259.3

THE SUBSURFACE EXPLORATIONS SHOWN HEREIN ARE IN ENGLISH UNITS AS RECORDED BY CON-TEC INC. BORING PLAN AND CHART INFORMATION IS SHOWN IN METRIC UNITS.

**STATE OF VERMONT
AGENCY OF TRANSPORTATION**

Town Of FAYSTON	Bridge No. 36
Highway No. VT 17	Log Sta.
	Surv. Sta.
VT 17 OVER MILL BROOK	
BORING LOGS & INFORMATION (1 OF 2)	
Designed By S.M. GUNN	Drawn By B.J. MASSE
Checked By M.A. COLGAN	Bridge Design Supervisor M.A. COLGAN
Date 1/06	Date 1/06
PROJECT FAYSTON	PROJECT NO. BHF 0200(9)