

TEST PITS		
TEST PIT #1		
HORIZON	DEPTHS	SOIL, MOTTLES, WATER, & COMMENTS
A	0-12"	Dark brown topsoil
B	12-45"	Fine sand/silt loam; mottles @ 18", saturated @ 32"; monitor installed
TEST PIT #2		
HORIZON	DEPTHS	SOIL, MOTTLES, WATER, & COMMENTS
A	0-12"	Dark brown topsoil
B	12-46"	Fine sandy loam w/some silt; mottles @ 18", saturated @ 36"; monitor installed
TEST PIT #3		
HORIZON	DEPTHS	SOIL, MOTTLES, WATER, & COMMENTS
A	0-12"	Dark brown topsoil
B	12-42"	Silty loam; mottles @ 23-24", saturated @ 32"
TEST PIT #4		
HORIZON	DEPTHS	SOIL, MOTTLES, WATER, & COMMENTS
A	0-12"	Dark brown topsoil
B	12-36"	Fine sandy loam; no apparent mottles
TEST PIT #5		
HORIZON	DEPTHS	SOIL, MOTTLES, WATER, & COMMENTS
A	0-12"	Dark brown topsoil
B	12-45"	Fine sandy loam; mottles @ 30"
TEST PIT #6		
HORIZON	DEPTHS	SOIL, MOTTLES, WATER, & COMMENTS
A	0-12"	Dark brown topsoil
B	12-40"	Fine sandy loam; no apparent mottles; one of best holes
TEST PIT #7		
HORIZON	DEPTHS	SOIL, MOTTLES, WATER, & COMMENTS
A	0-12"	Dark brown topsoil
B	12-43"	Fine sandy loam w/small stones; no apparent mottles; good hole
TEST PIT #8		
HORIZON	DEPTHS	SOIL, MOTTLES, WATER, & COMMENTS
A	0-12"	Dark brown topsoil
B	12-42"	Fine sandy loam; distinct mottles @ 32"
TEST PIT #9		
HORIZON	DEPTHS	SOIL, MOTTLES, WATER, & COMMENTS
A	0-12"	Dark brown topsoil
B	12-46"	Fine sandy loam w/many pcs. of small shale; no apparent mottles
TEST PIT #10		
HORIZON	DEPTHS	SOIL, MOTTLES, WATER, & COMMENTS
A	0-12"	Dark brown topsoil
B	12-42"	Silty & fine sandy loam w/some pcs. of fractured shale

PERCOLATION TEST
 TEST #1: Percolation rate - 15 minutes/inch
 TEST #2: Percolation rate - 19 minutes/inch

MONITORING WELLS
 Monitoring wells #1 and #2 were checked once each week beginning March 1, 1995. As of April 28, 1995, well #1 has been dry - depth 45". Highest water level observed in well #2 was 41" on March 24, 1995. Both holes were dry on June 23, 1995.

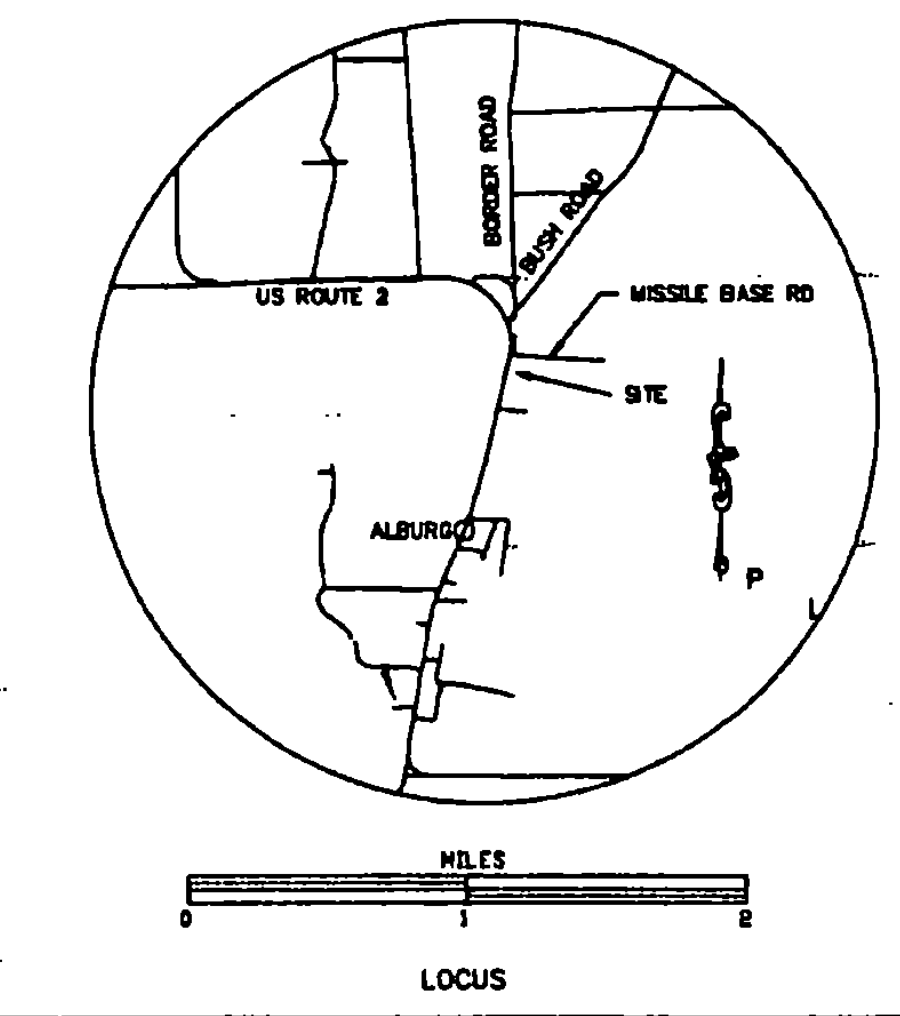
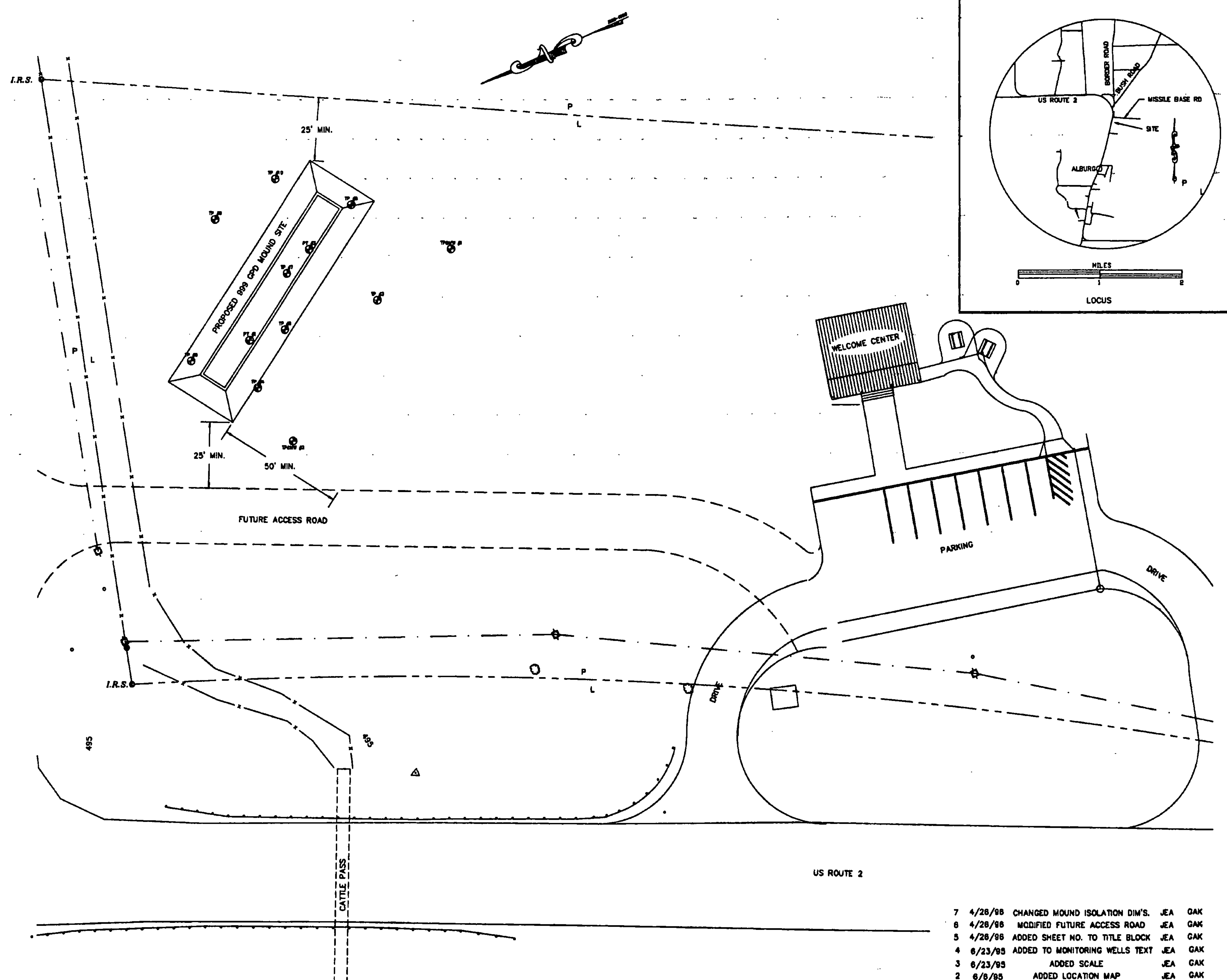

LEGEND

⊙ I.R.S.	IRON ROD SET
---	PROPERTY LINE
---	POWER LINE
---	PROPERTY LINE & FENCE
---	CATTLE FENCE
⊙	UTILITY POLE

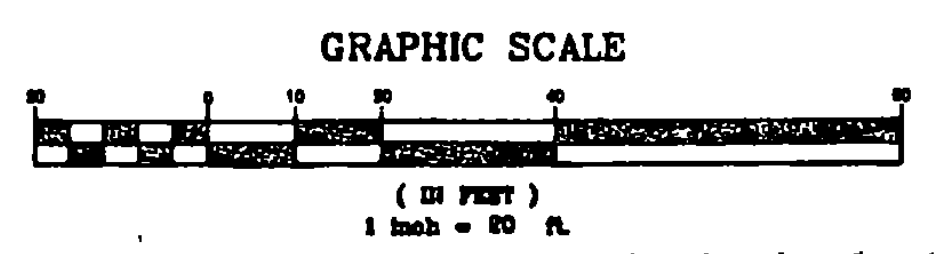

Jon E. Allen
 REGISTERED PROFESSIONAL ENGINEER
 STATE OF VERMONT
 No. 2334

REV. NO.	DATE	DESCRIPTION	MADE BY	CHECKED BY	APPROVED BY
7	4/28/95	CHANGED MOUND ISOLATION DIM'S.	JEA	GAK	
6	4/28/95	MODIFIED FUTURE ACCESS ROAD	JEA	GAK	
5	4/28/95	ADDED SHEET NO. TO TITLE BLOCK	JEA	GAK	
4	6/23/95	ADDED TO MONITORING WELLS TEXT	JEA	GAK	
3	6/23/95	ADDED SCALE	JEA	GAK	
2	6/8/95	ADDED LOCATION MAP	JEA	GAK	
1	6/8/95	ADDED LEGEND	JEA	GAK	

ALBURG WELCOME CENTER ALBURG, VERMONT SEWAGE DISPOSAL SYSTEM SITE & SOILS INVESTIGATION NH028-1(12)					
DESIGN	JEA	VERMONT SURVEY AND ENGINEERING, INC.	PROJECT NO.	11295	
		58 EAST STATE STREET • MONTPELIER, VERMONT • 05602			
SCALE	1" = 20.00'	DRAWN BY	DATE	5/17/95	
			DESIGNED BY	1/5	
			CHECKED BY	14/21	