

ELECTRICAL LEGEND	
SYMBOLS USED ARE INDICATED BY A CHECK	
✓	⊕ JUNCTION BOX
✓	⊖ SINGLE RECEPTACLE 18" A.F.F.
✓	⊖ DUPLEX RECEPTACLE 18" A.F.F.
✓	⊖ DUPLEX 0/1 RECEPTACLE 20" A.F.F.
✓	⊖ TRACK LIGHT HEAD
✓	⊖ POWER PANEL
✓	⊖ FIRE-O-MATIC
✓	⊖ TELEPHONE OUTLET 18" A.F.F.
✓	⊖ MOTOR STARTER
✓	⊖ DISCONNECT
✓	⊖ FIRE HORN & LIGHT
✓	⊖ TRANSFORMER
✓	⊖ HOME RUN TO PANEL P (MIN. 3/4" CONDUIT)
✓	⊖ CONDUIT TURNING UP
✓	⊖ CONDUIT TURNER UP
✓	⊖ EXIT LIGHT
✓	⊖ FLUORESCENT LIGHT
✓	⊖ BATTERY POWERED EMERGENCY LIGHT
✓	⊖ POINT OF ELEC. CONNECTION TO [E]
✓	⊖ NEW
✓	⊖ EXISTING
✓	⊖ SINGLE POLE SWITCH 40" A.F.F.
✓	⊖ THREE-WAY SWITCH 40" A.F.F.
✓	⊖ A.F.F. ABOVE FINISHED FLOOR
✓	⊖ A.F.C. ABOVE FINISHED COUNTER
✓	⊖ INCANDESCENT CEILING LIGHT
✓	⊖ NIGHT LIGHT
✓	⊖ DUPLEX RECEPTACLE IN FLOOR
✓	⊖ CLOCK OUTLET 7'-0" A.F.F.
✓	⊖ SM - MOTOR THERMAL SWITCH
✓	⊖ A.H.U. AIRHANDLING UNIT
✓	⊖ TTY TTY TELEPHONE OUTLET
✓	⊖ COMPUTER OUTLET 18" A.F.F.

LIGHTING FIXTURE SCHEDULE						
TYPE	MANUFACTURER & DESCRIPTION	LAMPS	MOUNTING	FINISH	REMARKS	
A	DAY-O-LITE HANDEL PROOF NO. VFR-240-VR PROVIDE MOUNTING STEMS OR AIRCRAFT CABLE	2-32 F-32 T-8 R. S.	SUSPENDED BOTTOM OF FIXTURES 9'-0" AFF MINIMUM	WHITE	PROVIDE TAMPERPROOF SCREWS	
B	LOBBY PROGRESS NO. P5117-46	1-100 100W A-19	SUSPENDED BOTTOM OF FIXTURES 9'-0" AFF	GREEN SHADE POLISHED BRASS		
C	PORCH WELL LUMINAIRE PROGRESS NO. P6330-11	1-100 100W A-19	WELL 7'-6" AFF.	BRASS	PROVIDE TAMPERPROOF SCREWS	
D	TRACK LIGHTING PROGRESS NO. P6264-10	75 PAR 16	CEILING & WALL	BRASS	PROVIDE BRASS TRACKS (2) 8" & (1) 2" 7 HEADS	
E	EXIT SIGN FAIRSAFE NO. EXT-1-RW-120-EBP	2-9 9W P.L. 81X	SURFACE COORDINATE WITH ARCH.	WHITE WITH RED LETTERS	INTERNAL EMER. BATTERY PACK & TAMPERPROOF SCREWS	
F	CLOSET LIGHT FAIRSAFE NO. F80-14-120	2-7 7W P.L. 81X	WALL 7'-0" AFF.	OPAL/WHITE		
G						
H						

PANELBOARD SCHEDULE							
PANEL	BRANCH BREAKERS				BUS BARS	MTG.	REMARKS
	QTY.	FRAME	TRIP	POLES			
PPI	2	100	20	1	RECEPTACLES	100 A 2 P. 120/208	SEE U-8
	3	100	20	1	INTERIOR LIGHTING		SEE U-8
	3	100	20	1	MECHANICAL EQUIP.		SEE U-8
	3	100	20	1	SPARES		SEE U-8
	7				SPACES		SEE U-8
	1	100	100	2	MAIN BREAKER		SEE U-8

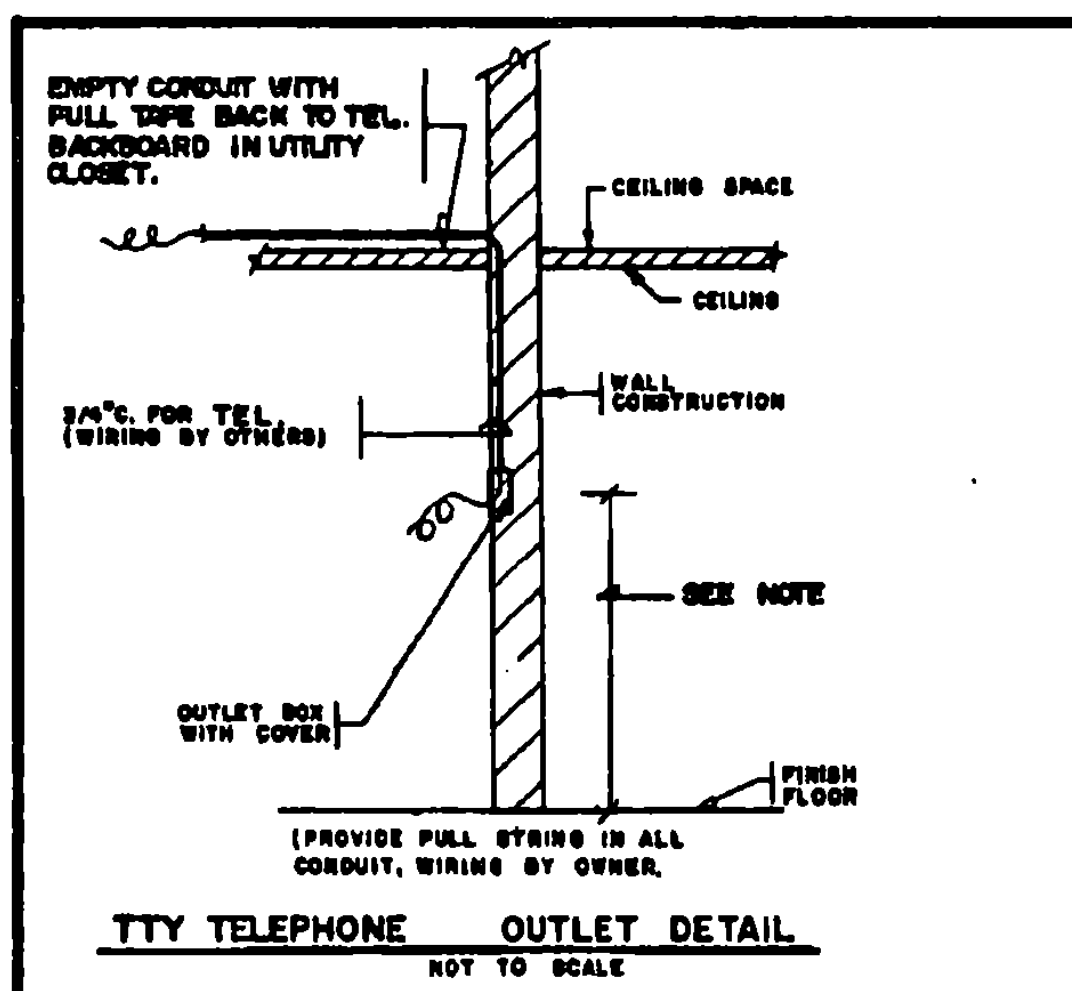

NOTES:

1. THE ELECTRICAL CONTRACTOR SHALL COORDINATE WITH THE OWNER BEFORE INSTALLING TELEPHONE OUTLET BOXES AND CONDUIT TO DETERMINE THE EXACT HEIGHT REQUIREMENTS OF EACH TELEPHONE CUPLET BOX. THESE HEIGHTS MAY VARY DEPENDING ON THE ACTUAL EQUIPMENT PURCHASED BY THE OWNER AND THE INDIVIDUAL TYPE AND ADA REQUIREMENTS OF EACH PHONE LOCATION. THE OWNER SHALL INFORM THE ELECTRICAL CONTRACTOR IN A TIMELY MANNER TO AVOID ANY WORK STOPPAGE OR DELAYS AS TO THE EXACT CHARACTERISTICS OF THE EQUIPMENT TO BE USED.

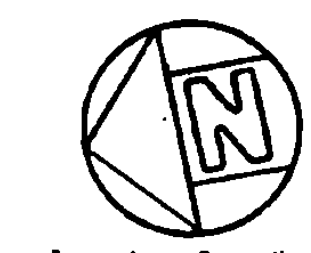
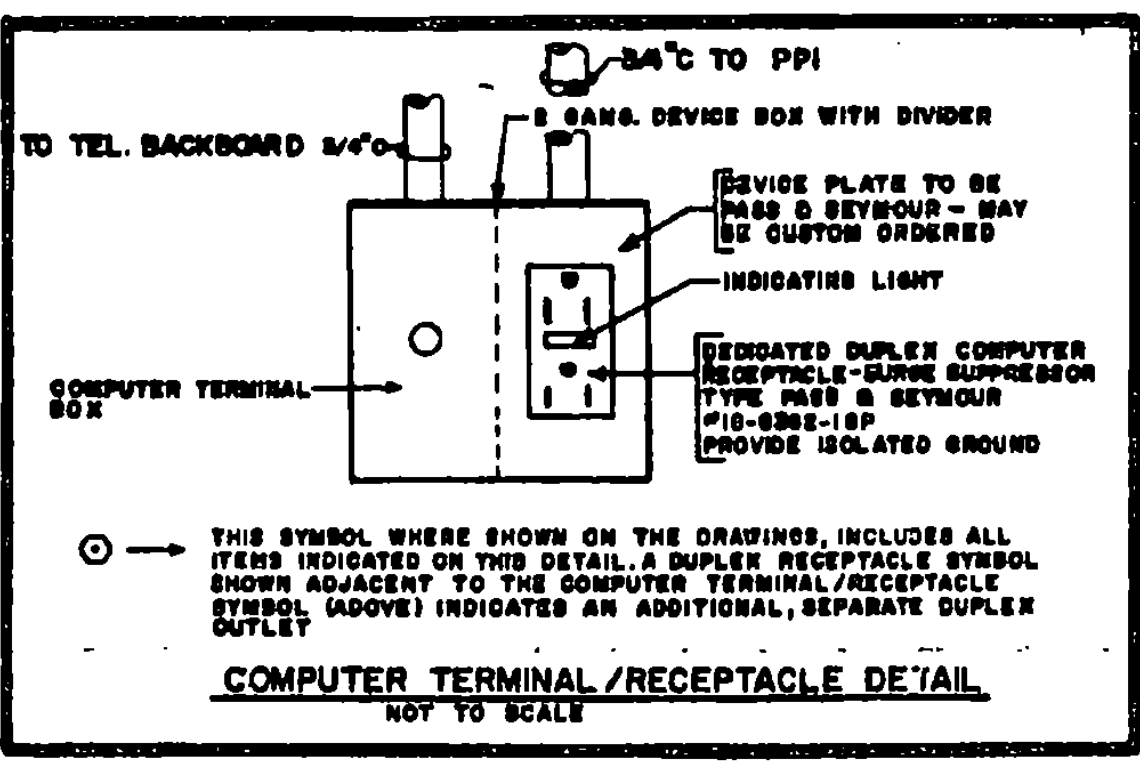
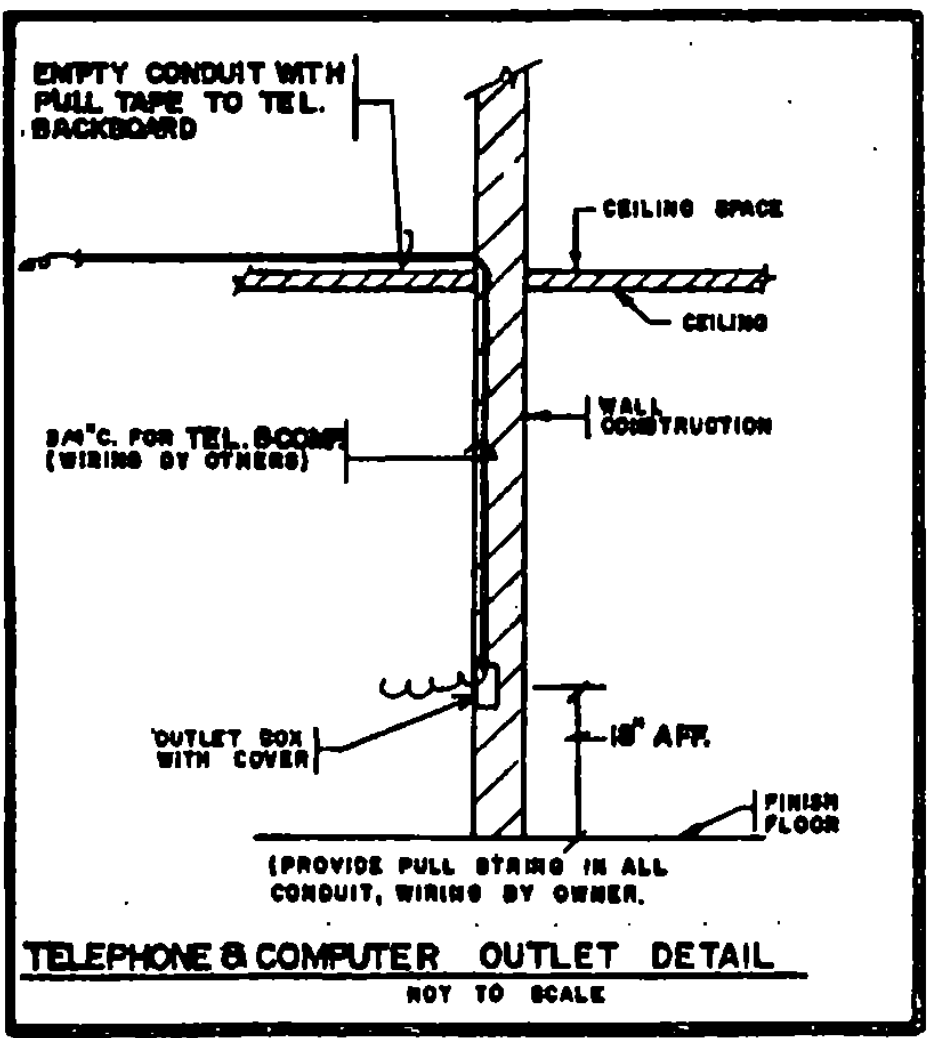
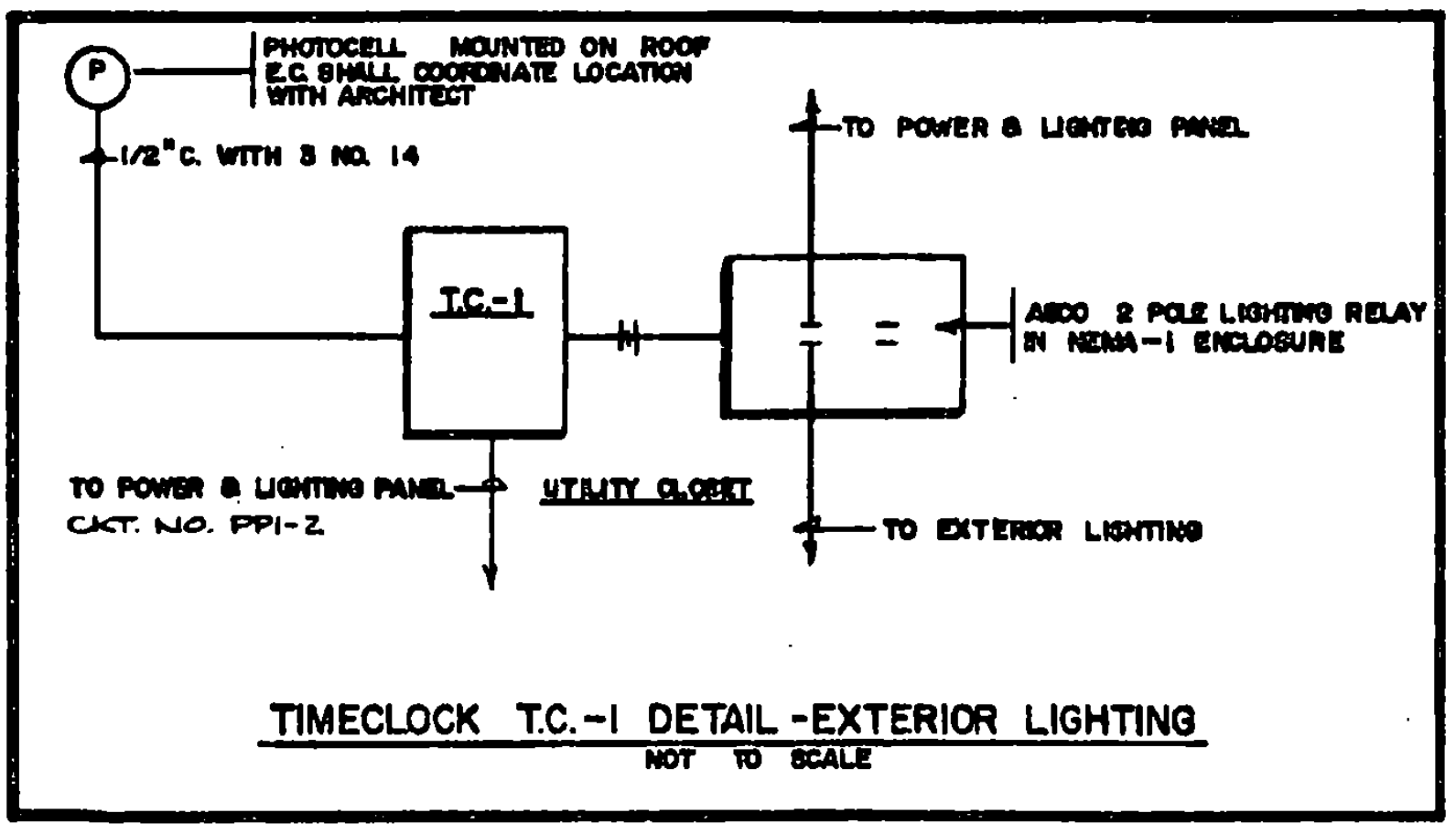

3/4" C. W. 1/2" C. #8 GND FOR SERVICE TO SEWAGE PUMP STATION AND HIGH WATER ALARM. ALARM LOCATION TO BE DETERMINED BY OWNER. E.C. TO WIRE

REMOTE EMERGENCY LIGHT FIXTURE HEAD. WIRE TO BATTERY UNIT. TYPICAL FOR MEN'S ROOM.

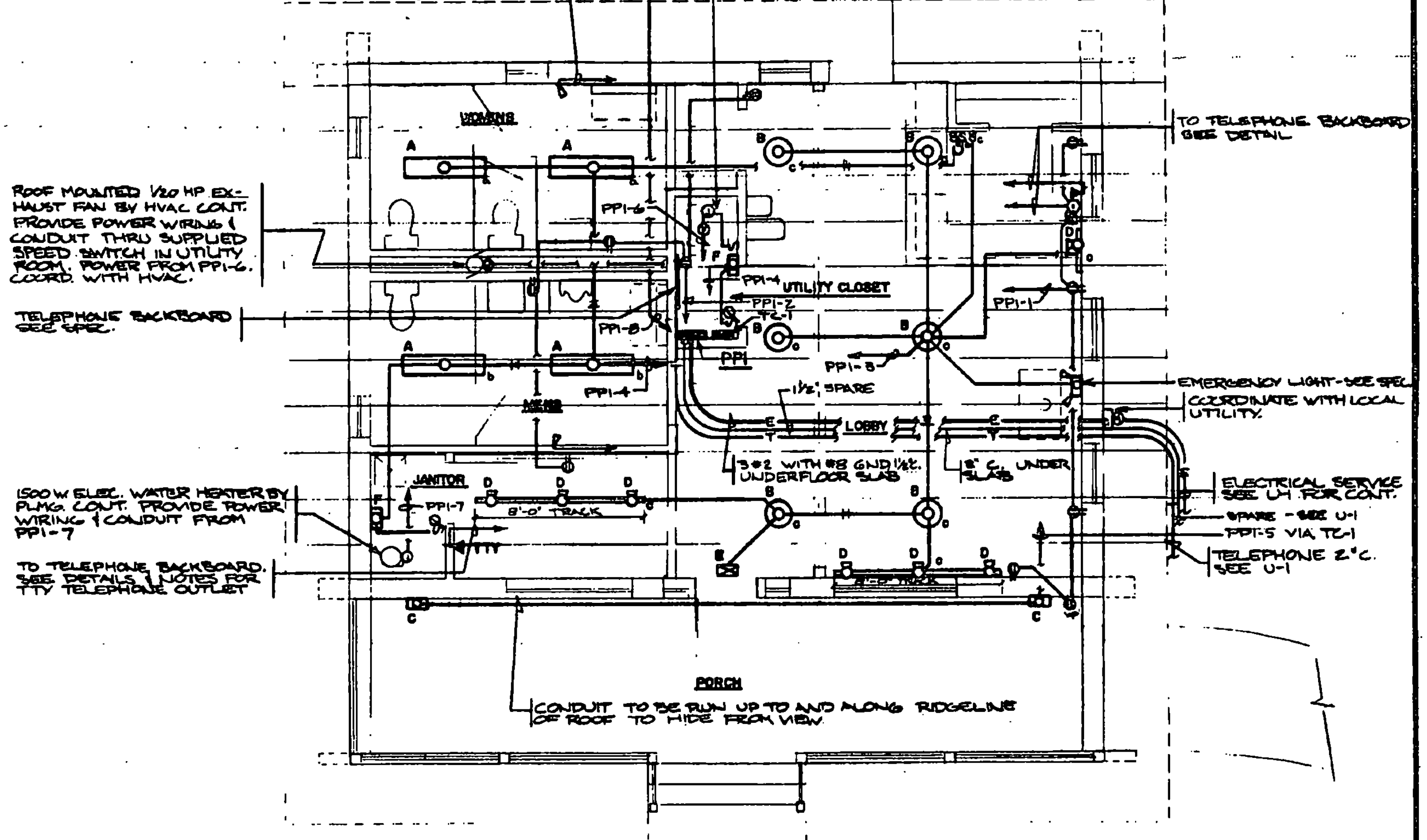

NOTES:

1. HVAC CONT. TO COORD. WITH ELEC. CONT. TO LOCATE TEMPERATURE CONTROL PANEL BELOW TC-1. PROVIDE POWER FROM PPI-2
2. ALL CONDUITS SHALL BE CONCEALED WHERE POSSIBLE. I.E. USE ROOF STRUCTURE, PARTITION, UNDER FLOOR SLAB, ETC., WHERE NOT POSSIBLE, I.E. SOLID LOS. SOUTH WALL. CONDUIT SHALL BE RUN NEATLY AND SQUARELY AND SECURED PAINT PER ARCH. REQUIREMENTS.
3. COORDINATE WITH LOCAL TELEPHONE CO. PHONE # 202-263-7911.

**ELECTRICAL - FLOOR PLAN**  
SCALE: 1/4" = 1'-0"

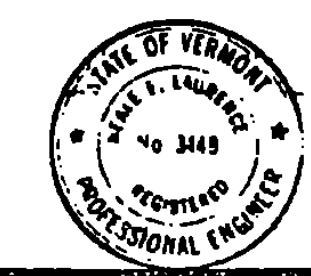

STATE OF VERMONT  
DEPARTMENT OF STATE BUILDINGS  
AGENCY OF ADMINISTRATION  
MONTPELIER, VERMONT

**ALBURG WELCOME CENTER  
ALBURG**

**ELECTRICAL - FLOOR PLAN,  
LEGEND, SCHEDULES & DETAILS**

DATE 3-9-96	SCALE AS NOTED	REVISIONS 2-10-96	DWG. NO. E-1
DRAWN BY GN	PROJECT NO. NH028-1117S	19 of 21	