

# STATE OF VERMONT AGENCY OF TRANSPORTATION

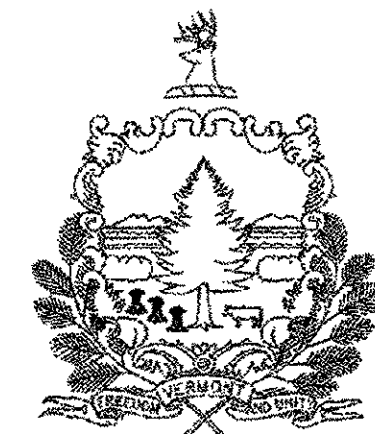

## PROPOSED IMPROVEMENT BRIDGE PROJECT TOWN OF LYNDON COUNTY OF CALEDONIA

### ROUTE NO. VT 114 (MAJOR COLLECTOR), BRIDGE NO. 2

PROJECT LOCATION: BEGINNING AT A POINT 0.940 km EASTERLY OF THE INTERSECTION OF VT 114 AND U.S. 5 AND EXTENDING EASTERLY 0.105 km.

PROJECT DESCRIPTION: REMOVAL OF EXISTING SUPERSTRUCTURE, PARTIAL REMOVAL OF EXISTING SUBSTRUCTURE, CONSTRUCTION OF A NEW STEEL BEAM, CONCRETE DECK SUPERSTRUCTURE ON NEW PILE-SUPPORTED INTEGRAL ABUTMENTS AND RELATED ROADWAY APPROACH, INTERSECTION, AND CHANNEL WORK.

LENGTH OF STRUCTURE: 30.570 m  
LENGTH OF ROADWAY: 149.430 m  
LENGTH OF PROJECT: 180.000 m

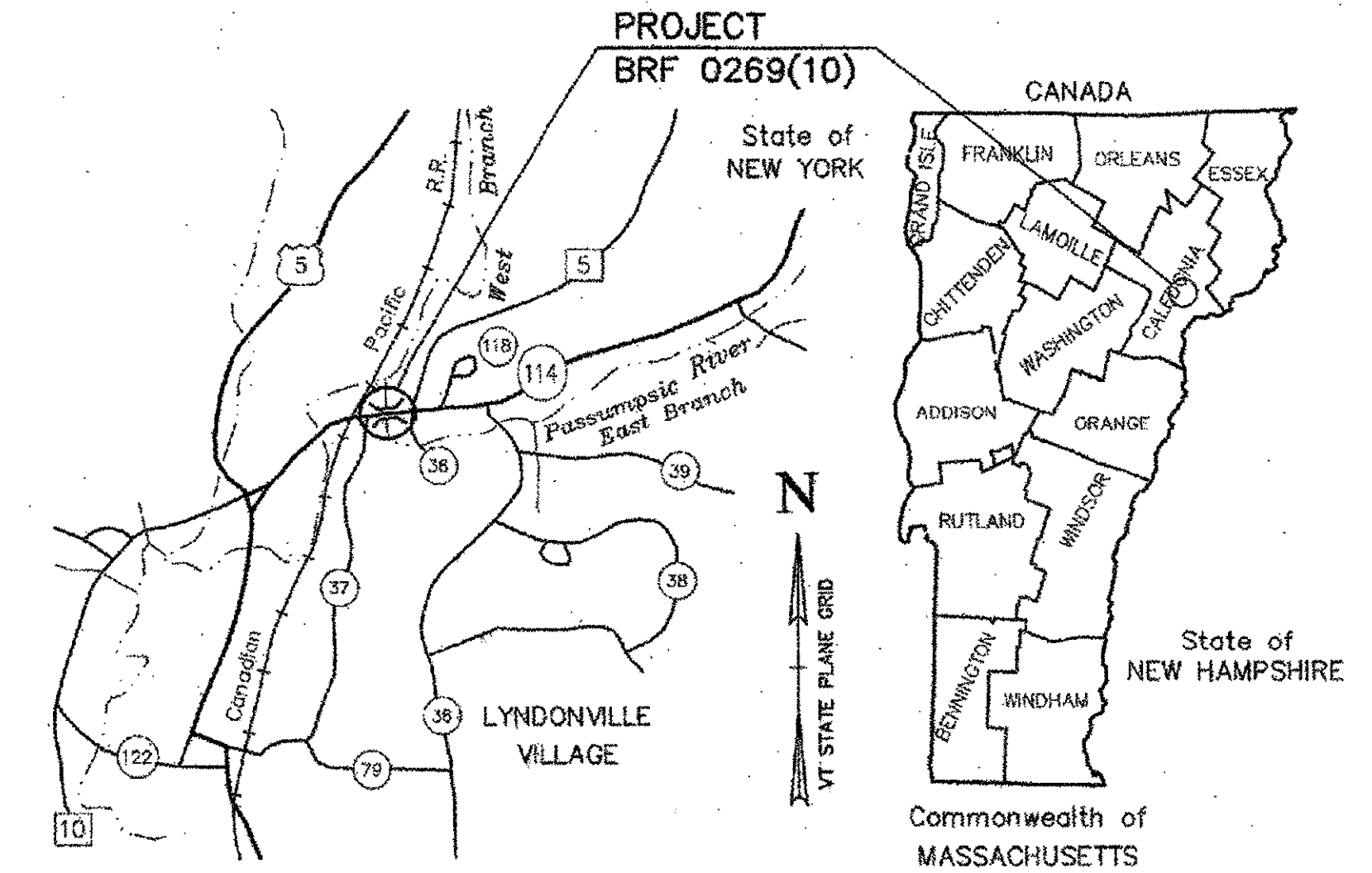

#### INDEX OF SHEETS

|       |  |
|-------|--|
| 1     | TITLE SHEET  |
| 2     | PRELIMINARY INFORMATION SHEET                              |
| 3     | QUANTITY SHEET (1 OF 3)                                    |
| 4     | QUANTITY SHEET (2 OF 3)                                    |
| 5     | QUANTITY SHEET (3 OF 3)                                    |
| 6     | ROW PLANS  |
| 7     | ROW PLANS  |
| 8     | ROW PLANS  |
| 9     | ROW PLANS  |
| 10    | ROW PLANS  |
| 11    | TIE SHEET AND TYPICAL DETAILS                              |
| 12    | PLAN (1 OF 2)  |
| 13    | PLAN (2 OF 2)  |
| 14    | VT 114 PROFILE AND BANKING DIAGRAM                         |
| 15    | TOWN HIGHWAY PROFILES                                      |
| 16    | TRAFFIC SIGN SUMMARY SHEET                                 |
| 17    | TRAFFIC CONTROL PLAN                                       |
| 18    | DETOUR PLAN (1 OF 2)                                       |
| 19    | DETOUR PLAN (2 OF 2)                                       |
| 20    | BORING LOGS & INFORMATION (1 OF 4)                         |
| 21    | BORING LOGS & INFORMATION (2 OF 4)                         |
| 22    | BORING LOGS & INFORMATION (3 OF 4)                         |
| 23    | BORING LOGS & INFORMATION (4 OF 4)                         |
| 24    | PLAN AND ELEVATION   |
| 25    | CONSTRUCTION NOTES   |
| 26    | DECK DETAILS   |
| 27    | DECK REINFORCING   |
| 28    | FRAMING PLAN   |
| 29    | BEAM ELEVATION AND DETAILS                                 |
| 30    | INTEGRAL ABUTMENT DETAILS                                  |
| 31    | APPROACH SLABS   |
| 32    | ABUTMENT REMOVAL   |
| 33    | ABUTMENT NO. 1   |
| 34    | ABUTMENT NO. 2   |
| 35    | WINGWALL DETAILS   |
| 36    | MISCELLANEOUS DETAILS                                      |
| 37    | BRIDGE RAILING (1 OF 2)                                    |
| 38    | BRIDGE RAILING (2 OF 2)                                    |
| 39    | REINFORCING STEEL SCHEDULE                                 |
| 40-51 | ROADWAY CROSS SECTIONS                                     |
| 52-55 | CHANNEL CROSS SECTIONS                                     |
| 56-60 | EXISTING BRIDGE PLANS                                      |
| 61    | EROSION CONTROL NARRATIVE                                  |
| 62    | EXISTING CONDITIONS SITE PLAN (1 OF 2)                     |
| 63    | EXISTING CONDITIONS SITE PLAN (2 OF 2)                     |
| 64    | EROSION PREVENTION & SEDIMENT CONTROL (EPSC) PLAN (1 OF 2) |
| 65    | EROSION PREVENTION & SEDIMENT CONTROL (EPSC) PLAN (2 OF 2) |
| 66    | FINAL CONDITIONS SITE PLAN (1 OF 2)                        |
| 67    | FINAL CONDITIONS SITE PLAN (2 OF 2)                        |
| 68    | EPSC 1-M   |
| 69    | EPSC 2-M   |
| 70    | EPSC 3-M   |
| 71    | EPSC 4-M   |
| 72    | EPSC 5-M   |

#### STANDARDS

|          |          |         |          |          |          |
|----------|----------|---------|----------|----------|----------|
| * A-76   | 03-03-03 | * E-108 | 08-18-95 | * E-170  | 11-04-99 |
| B-5M     | 01-03-00 | * E-110 | 08-08-95 | * E-171A | 08-09-95 |
| * B-71   | 07-08-05 | * E-121 | 08-08-95 | * E-171B | 08-09-95 |
| D-2M     | 06-13-97 | * E-140 | 08-30-96 | * E-171C | 08-09-95 |
| D-4M     | 06-13-97 | * E-141 | 09-20-95 | * E-172  | 08-09-95 |
| D-16M    | 06-13-97 | * E-142 | 09-20-95 | * E-175  | 11-17-93 |
| * E-100  | 01-02-04 | * E-143 | 06-15-04 | * E-190  | 08-30-03 |
| * E-101  | 05-30-03 | * E-146 | 09-20-95 | * E-191  | 02-01-99 |
| * E-102  | 06-30-03 | * E-160 | 05-20-99 | * E-193  | 08-18-95 |
| * E-102A | 05-01-04 | * E-161 | 08-18-95 | G-1M     | 01-03-00 |
| * E-106  | 03-01-04 | * E-162 | 05-20-99 | G-1dM    | 01-03-00 |
| * E-107  | 06-30-03 | * E-163 | 05-20-99 | G-4M     | 06-13-97 |
| * E-107A | 08-08-95 | * E-164 | 05-20-99 | G-18AM   | 07-10-97 |

\* INDICATES ENGLISH STANDARD USED

#### CONVENTIONAL SIGNS

|  |                     |
|--|---------------------|
|  | COUNTY LINE         |
|  | TOWN LINE           |
|  | LIMITS OF ACCESS    |
|  | POINT OF ACCESS     |
|  | FENCE LINE          |
|  | STONE WALL          |
|  | TRAVELED WAY        |
|  | GUARD RAIL          |
|  | RAILROAD            |
|  | SURVEY LINE         |
|  | CULVERT             |
|  | UTILITY POLE        |
|  | TREES               |
|  | CONTROL OF ACCESS   |
|  | PROPERTY LINE       |
|  | R.O.W.              |
|  | SLOPE RIGHTS        |
|  | TOP OF CUT          |
|  | TOE OF CONST. SLOPE |

SURVEYED BY: EIV TECHNICAL SERVICES, LLC  
SURVEYED DATE: 11/95

DATUM  
VERTICAL NAVD 88  
HORIZONTAL NAD 83-92

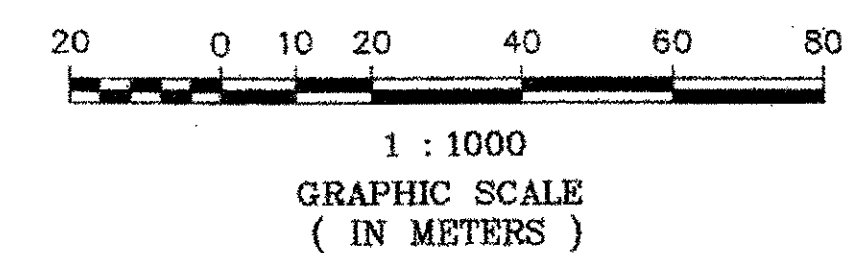
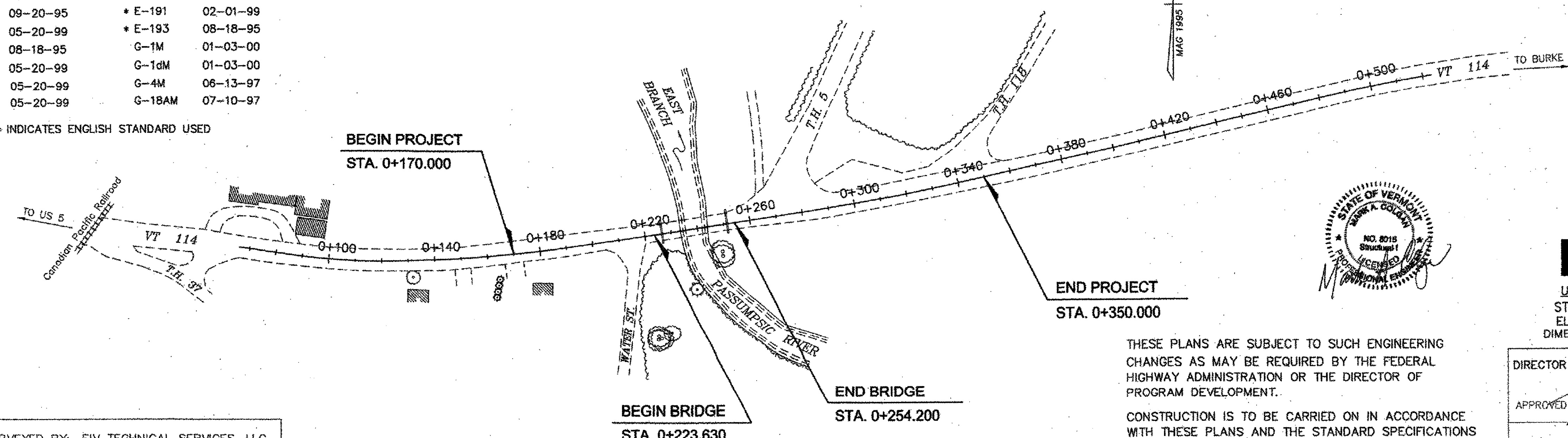

#### RECORD PLANS

CONTRACTOR: WINTERSET, INC. - LYNDONVILLE, VT  
RESIDENT ENGINEER: KEVIN MCCLURE  
CONSTRUCTION BEGAN: JULY 28, 2006  
CONSTRUCTION COMPLETE: AUGUST 7, 2007  
RECORD PLANS BY: KEVIN MCCLURE & N. GARBACIK

I HEREBY CERTIFY THAT ALL THE CONSTRUCTION REQUIRED BY THIS SET OF DRAWINGS HAS BEEN ACCOMPLISHED AS INDICATED HEREBIN.

BY Kevin McClure RESIDENT ENGINEER  
DATE 3-7-09

NOTE: Any further information concerning final quantities, amounts or other details relative to this project may be found at Central Files in the electronic archives.

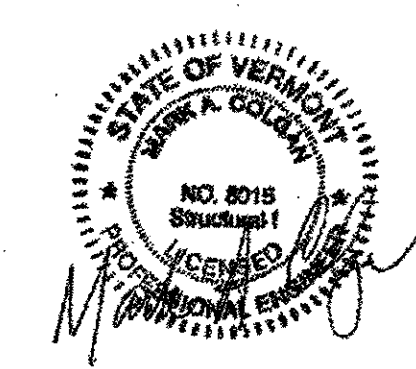

**Metric**  
UNLESS OTHERWISE NOTED  
STATIONS ARE IN KILOMETERS  
ELEVATIONS ARE IN METERS  
DIMENSIONS ARE IN MILLIMETERS

THESE PLANS ARE SUBJECT TO SUCH ENGINEERING CHANGES AS MAY BE REQUIRED BY THE FEDERAL HIGHWAY ADMINISTRATION OR THE DIRECTOR OF PROGRAM DEVELOPMENT.

CONSTRUCTION IS TO BE CARRIED ON IN ACCORDANCE WITH THESE PLANS AND THE STANDARD SPECIFICATIONS FOR CONSTRUCTION DATED 2001, AS APPROVED BY THE FEDERAL HIGHWAY ADMINISTRATION ON JANUARY 4, 2001 FOR USE ON THIS PROJECT, INCLUDING ALL SUBSEQUENT REVISIONS AND SUCH REVISED SPECIFICATIONS AND SPECIAL PROVISIONS AS ARE INCORPORATED IN THESE PLANS.

DIRECTOR OF PROGRAM DEVELOPMENT

APPROVED: [Signature] DATE 3/16/08

PROJECT MANAGER: ROGER R. WHITCOMB

PROJECT NAME: LYNDON  
PROJECT NUMBER: BRF 0269(10)

SHEET 1 OF 72 SHEETS

**VHB Vanasse Hangen Brustlin, Inc.**