

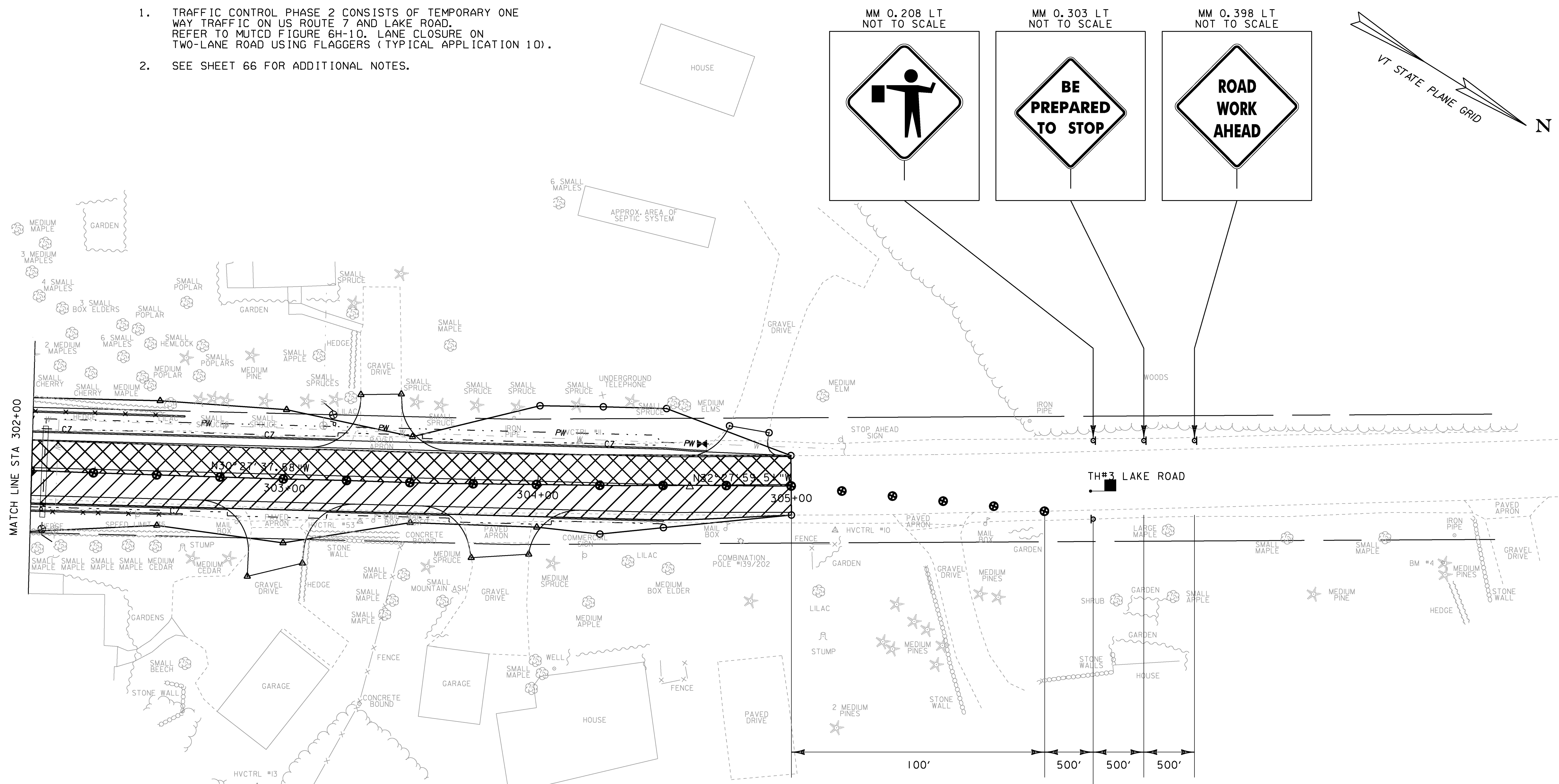

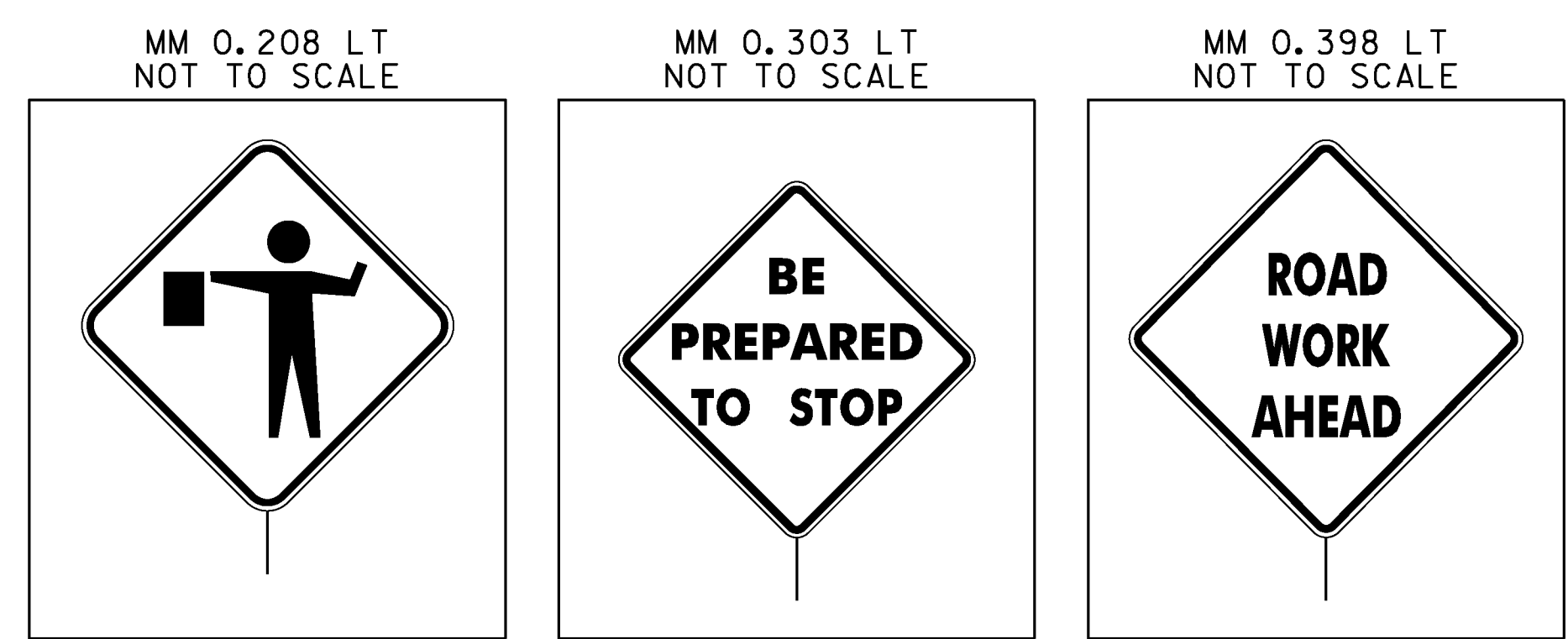

- NOTES:
1. TRAFFIC CONTROL PHASE 2 CONSISTS OF TEMPORARY ONE WAY TRAFFIC ON US ROUTE 7 AND LAKE ROAD. REFER TO MUTCD FIGURE 6H-10. LANE CLOSURE ON TWO-LANE ROAD USING FLAGGERS (TYPICAL APPLICATION 10).
  2. SEE SHEET 66 FOR ADDITIONAL NOTES.

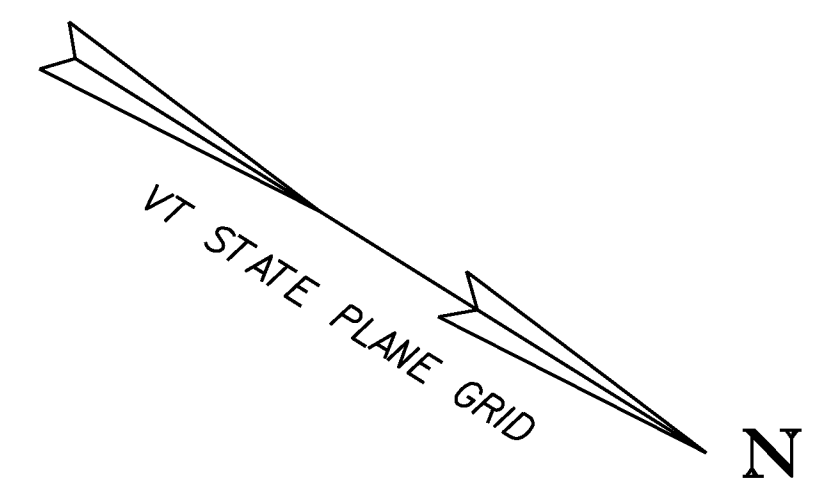

**LEGEND**

-  FLAGGER
-  CHANNELIZING DEVICE
-  PHASE II CONSTRUCTION ZONE
-  PHASE II TRAFFIC

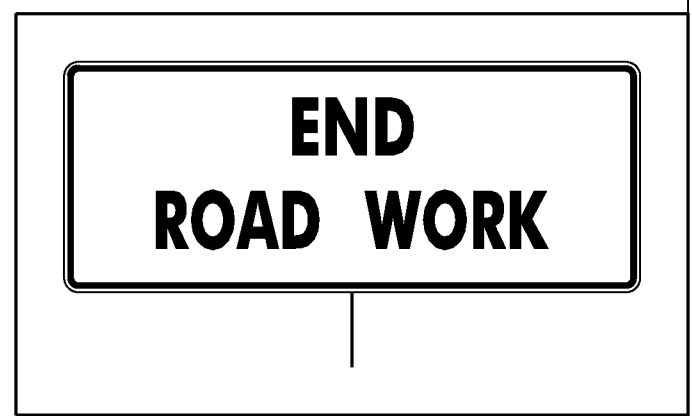

MM 0.208 RT NOT TO SCALE



EXISTING & PROPOSED WATERLINES ARE FOR REFERENCE ONLY. PLEASE REFER TO WATERLINE SHEETS 102-104

|                           |                    |              |                 |
|---------------------------|--------------------|--------------|-----------------|
| PROJECT NAME:             | MILTON             | PLOT DATE:   | 23-FEB-2011     |
| PROJECT NUMBER:           | STP 5800 (2)       | DRAWN BY:    | J. DEVLIN       |
| FILE NAME:                | +92D289+cp2bdr.dgn | DESIGNED BY: | D. LYMAN        |
| PROJECT LEADER:           | J. SCHULTZ         | CHECKED BY:  | J. DEVLIN       |
| TC PHASE 2 LAYOUT SHEET 4 |                    |              | SHEET 73 OF 104 |