

NOTES:

1. TRAFFIC CONTROL PHASE 2 CONSISTS OF TEMPORARY ONE WAY TRAFFIC ON US ROUTE 7 AND LAKE ROAD. REFER TO MUTCD FIGURE 6H-10. LANE CLOSURE ON TWO-LANE ROAD USING FLAGGERS (TYPICAL APPLICATION 10).
2. SEE SHEET 66 FOR ADDITIONAL NOTES.

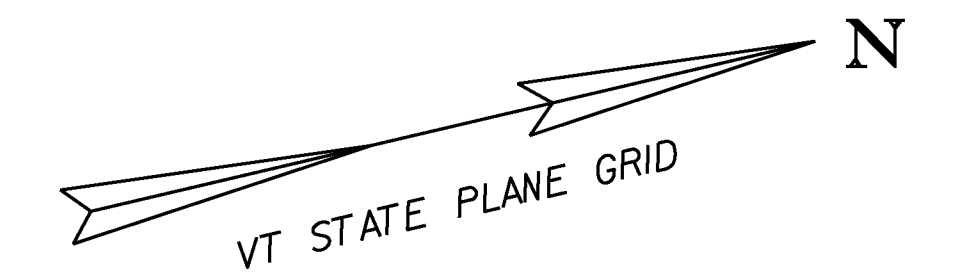

MM 5.623 LT  
NOT TO SCALE

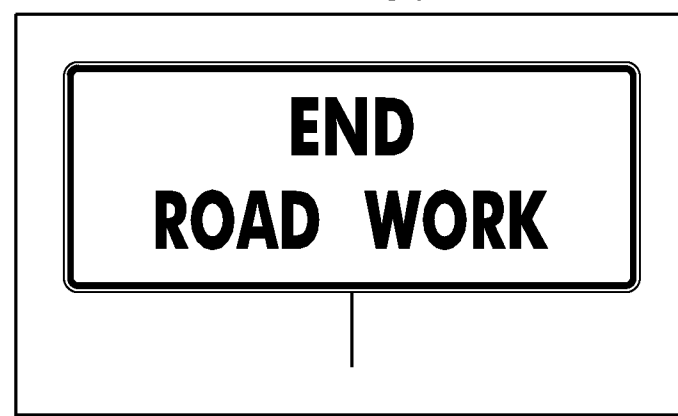

500' 500' 500' 100'

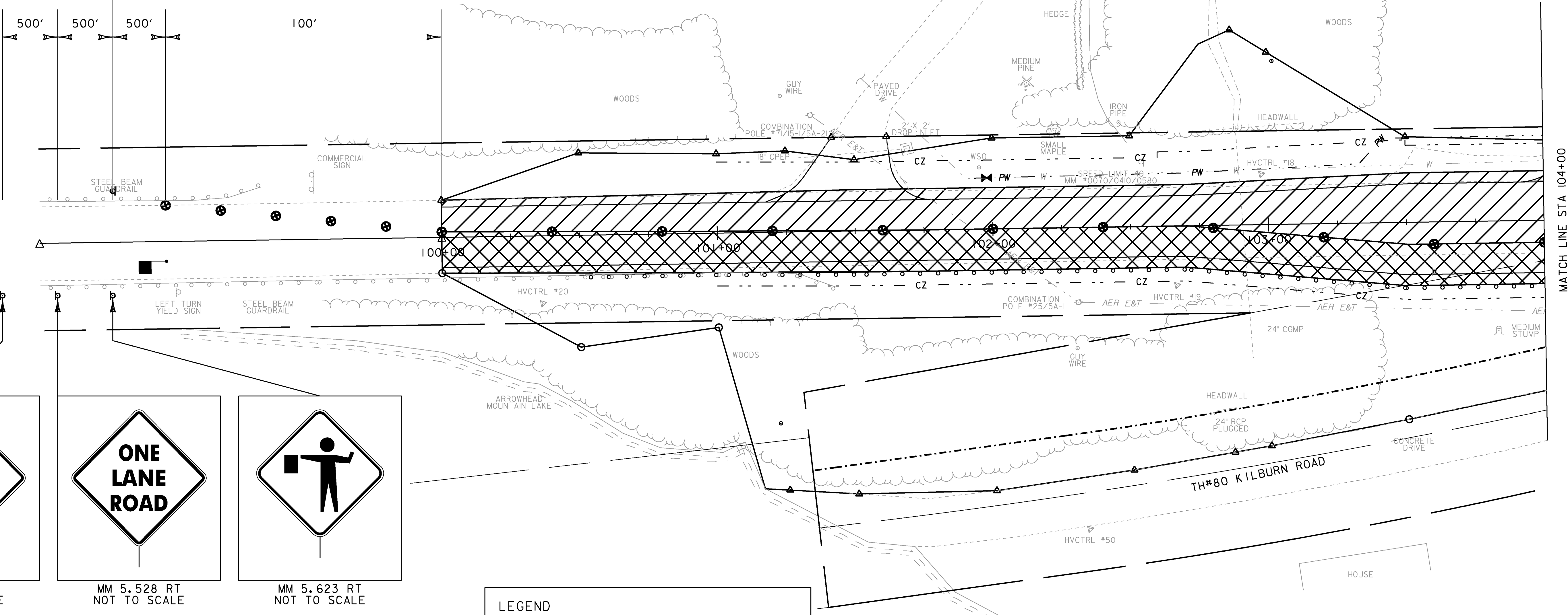

MATCH LINE STA 104+00



MM 5.434 RT  
NOT TO SCALE



MM 5.528 RT  
NOT TO SCALE

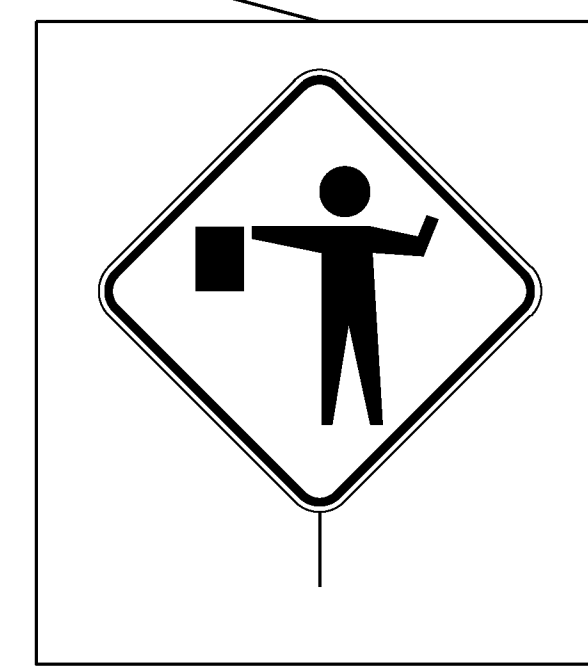

MM 5.623 RT  
NOT TO SCALE

**LEGEND**

- FLAGGER
- CHANNELIZING DEVICE
- PHASE II CONSTRUCTION ZONE
- PHASE II TRAFFIC

EXISTING & PROPOSED WATERLINES ARE FOR REFERENCE ONLY. PLEASE REFER TO WATERLINE SHEETS 102-104

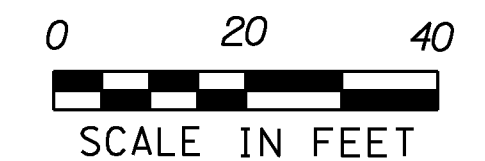

PROJECT NAME:	MILTON	PLOT DATE:	23-FEB-2011
PROJECT NUMBER:	STP 5800 (2)	DRAWN BY:	J. DEVLIN
FILE NAME:	+92D289+cp2bdr.dgn	CHECKED BY:	J. DEVLIN
PROJECT LEADER:	J. SCHULTZ	SHEET	70 OF 104
DESIGNED BY:	D. LYMAN		
TC PHASE 2 LAYOUT SHEET 1			