

NOTES:

1. TRAFFIC CONTROL PHASE 1 CONSISTS OF WIDENING EASTERLY OFF OF US ROUTE 7, EXTENDING FROM THE EXISTING SHOULDER TO THE PROPOSED EDGE OF PAVEMENT. REFER TO MUTCD FIGURE 6H-10. LANE CLOSURE ON TWO-LANE ROAD USING FLAGGERS (TYPICAL APPLICATION 10).
2. SEE SHEET 66 FOR ADDITIONAL NOTES.

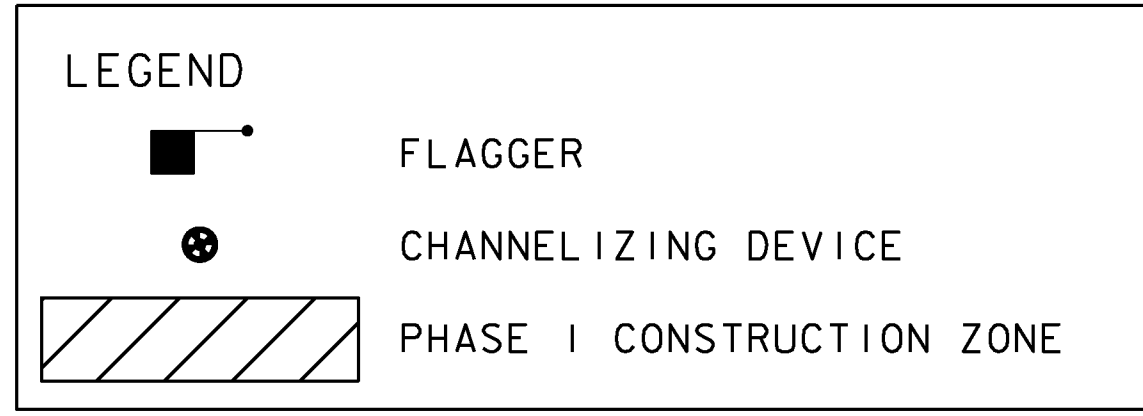
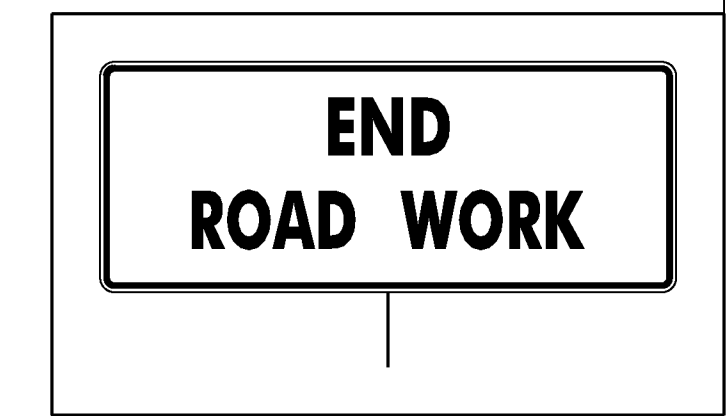
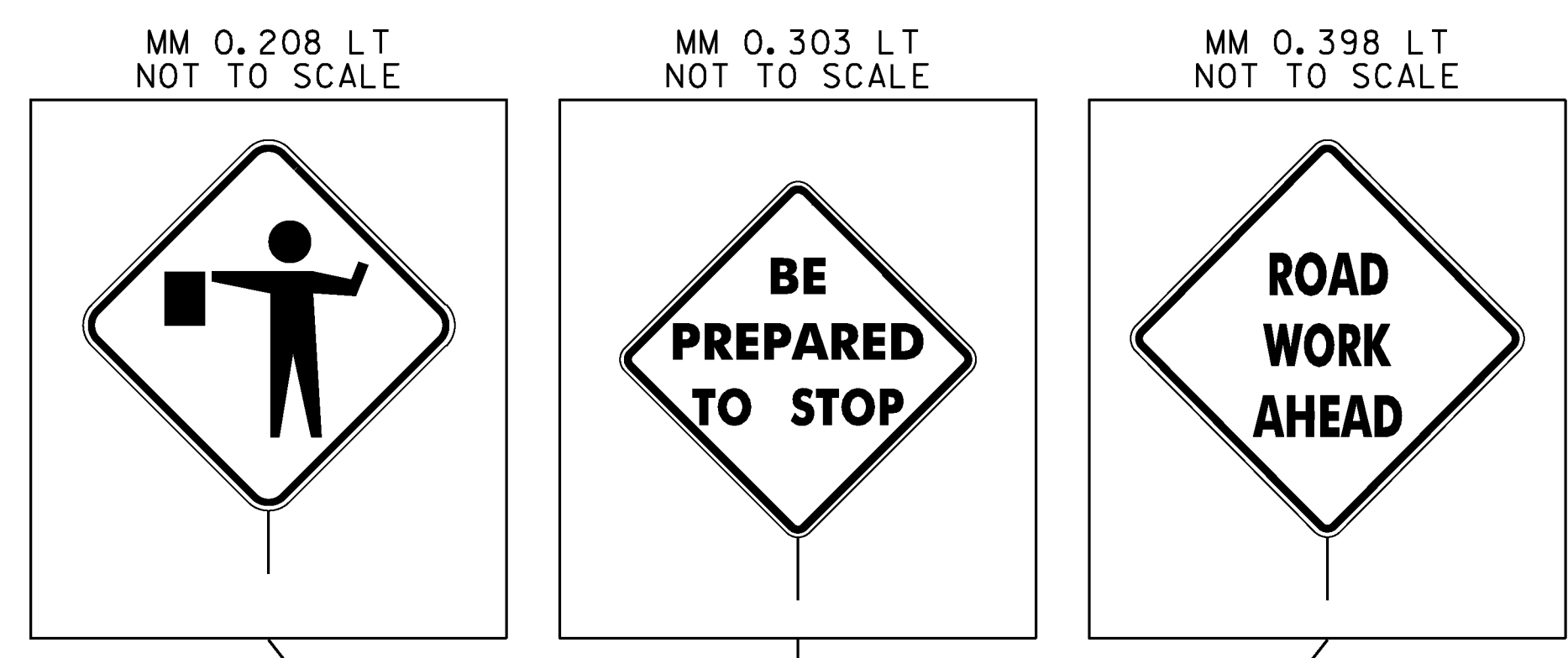
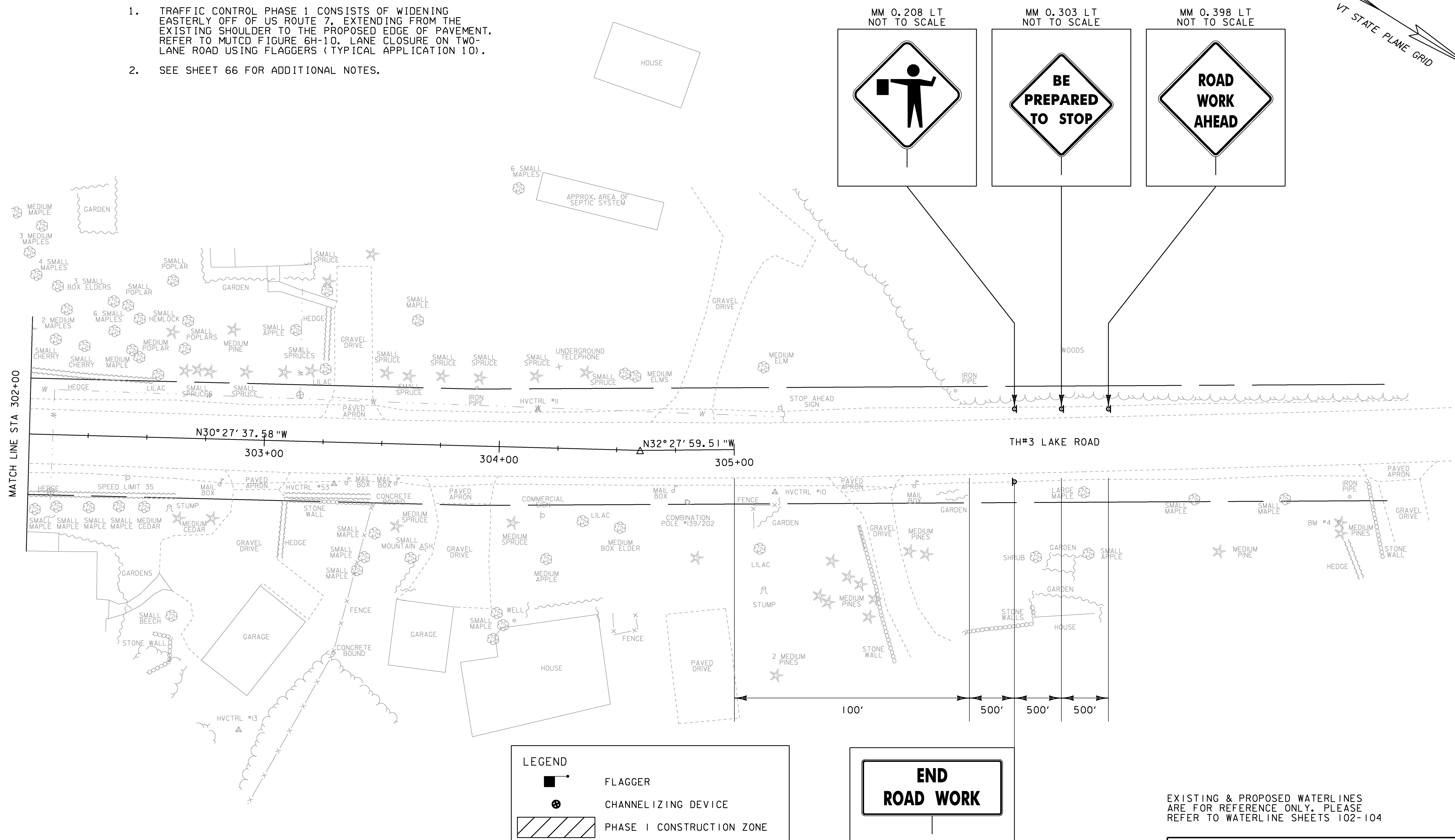
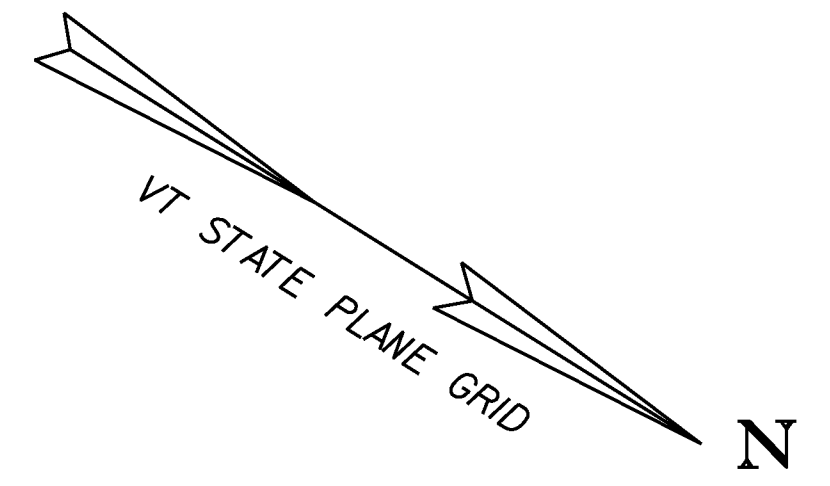

EXISTING & PROPOSED WATERLINES ARE FOR REFERENCE ONLY. PLEASE REFER TO WATERLINE SHEETS 102-104

PROJECT NAME:	MILTON	PLOT DATE:	23-FEB-2011
PROJECT NUMBER:	STP 5800 (2)	DRAWN BY:	J. DEVLIN
FILE NAME:	+92D289+cp1bdr.dgn	CHECKED BY:	J. DEVLIN
PROJECT LEADER:	J. SCHULTZ	SHEET	69 OF 104
DESIGNED BY:	D. LYMAN		
TC PHASE I LAYOUT SHEET 4			