

621.80 REMOVAL AND DISPOSAL OF GUARDRAIL  
 STA 100+50.00 RT - 101+42.67 RT  
 621.21 HD STEEL BEAM GUARDRAIL, GALVANIZED  
 STA 100+50.00 RT - 104+00.00 RT

CONSTRUCT DRIVE  
 STA 101+52.44 LT (20.0' - PAVED)  
 629.20 ADJUST ELEVATION OF VALVE BOX  
 STA 101+95.31 LT  
 210.10 COLD PLANING, BITUMINOUS CONCRETE PAVEMENT  
 STA 100+00.00 - 100+50.00

NOTE: MATCH PROPOSED HD STEEL BEAM GUARDRAIL INTO EXISTING GUARDRAIL AT STA 100+50.00 RT

②  
**MASON, PETER M.  
 & TONYA M.**

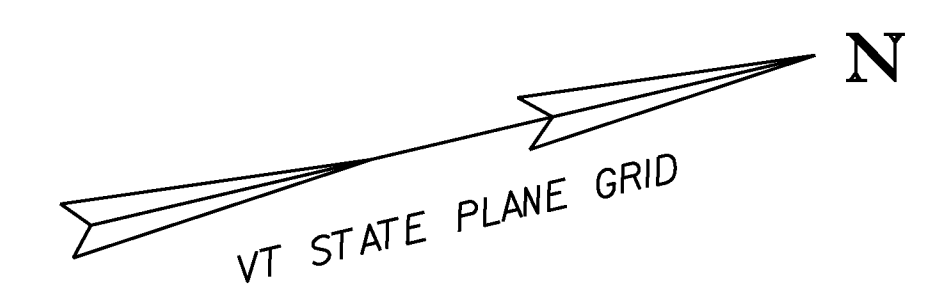

**NF  
 SEEHOLZER,  
 BRIAN & LINDA**

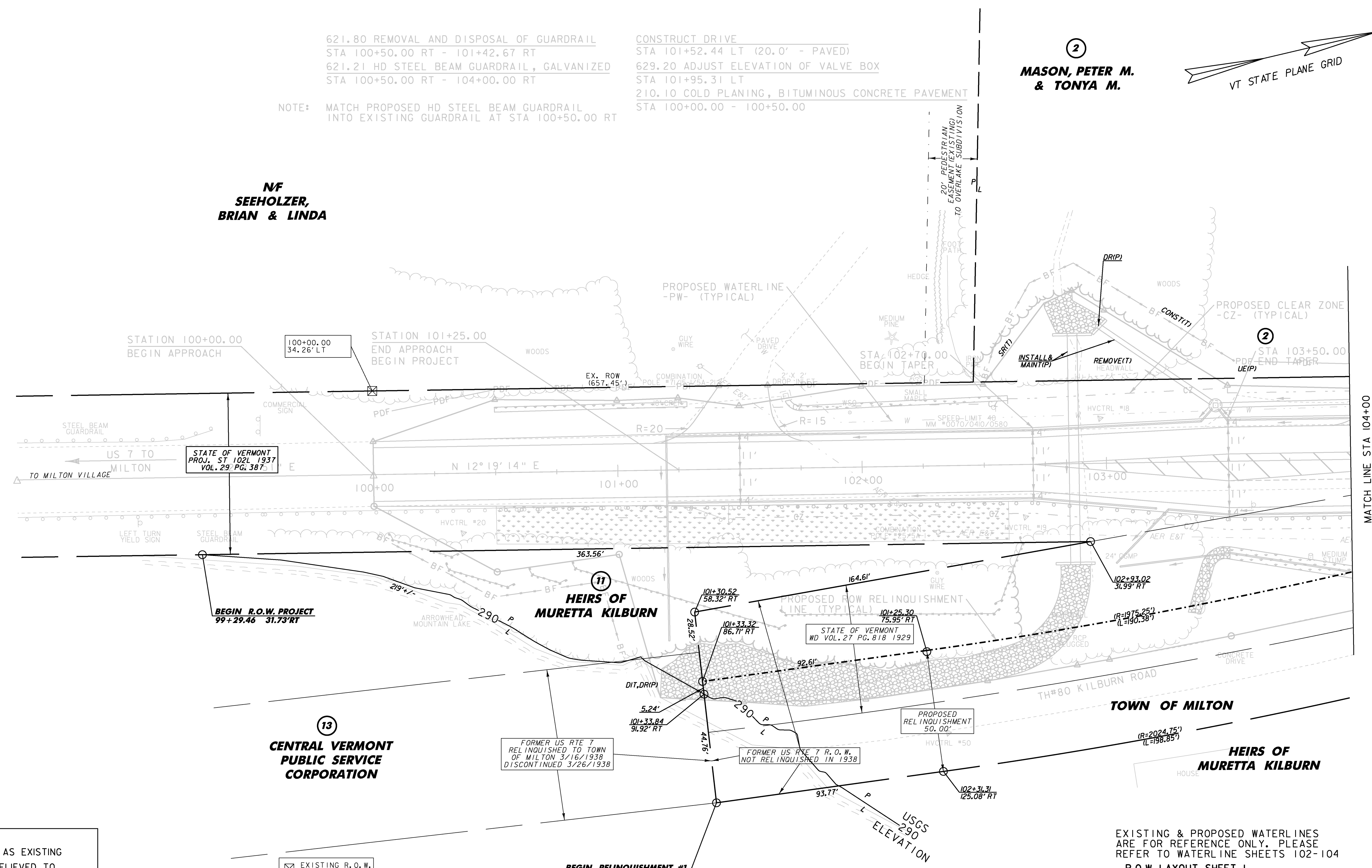

LINES SHOWN ON THIS PLAN AS EXISTING PROPERTY LINES P/L ARE BELIEVED TO BE ACCURATE BUT SHOULD NOT BE RELIED UPON FOR PURPOSES UNRELATED TO THE STATE OF VERMONT'S ACQUISITION OF LAND AND RIGHTS FOR THIS PROJECT.

EXISTING R.O.W. (CALCULATED)

**BEGIN RELINQUISHMENT #1**  
 101+38.24 136.48'RT  
 (= 1938 PROJ. 102-L STA. 452+50)

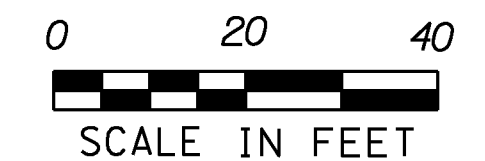

EXISTING & PROPOSED WATERLINES ARE FOR REFERENCE ONLY. PLEASE REFER TO WATERLINE SHEETS 102-104  
 R.O.W. LAYOUT SHEET 1

**FOR R.O.W. PURPOSES ONLY**

PROJECT NAME:	MILTON	PLOT DATE:	23-FEB-2011
PROJECT NUMBER:	STP 5800 (2)	DRAWN BY:	D. LYMAN
FILE NAME:	92d289\ROW\92d289r11.i	CHECKED BY:	J. DEVLIN
PROJECT LEADER:	J. SCHULTZ	SHEET	16 OF 104
DESIGNED BY:	D. LYMAN	R.O.W. SHEET	25 OF 28