

INTEGRAL ABUTMENT NO. 2 PLAN
SCALE 1/2" = 1'-0"

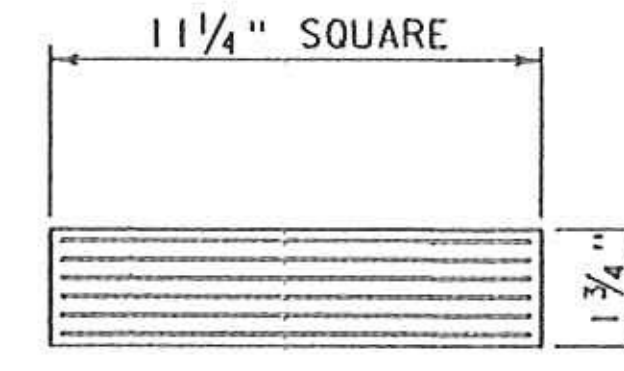

5/16" EXTERIOR ELASTOMER LAYER (TOP, BOTTOM & ALL-AROUND)
(2) 3/8" LAYERS OF INTERIOR ELASTOMER
(3) 0.125" STEEL REINFORCING PLATES

ELASTOMERIC BEARING PAD DETAIL
NOT TO SCALE

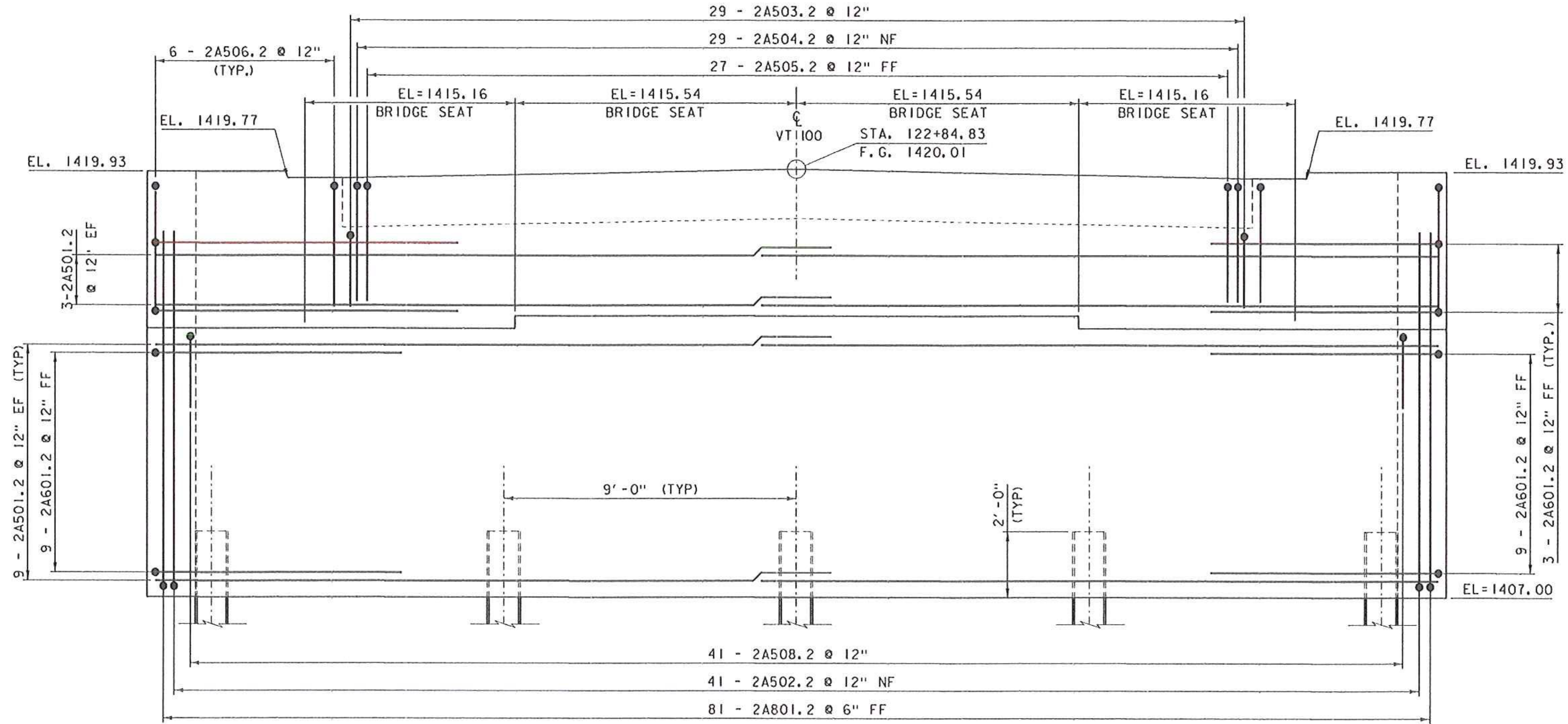

INTEGRAL ABUTMENT NO. 2 ELEVATION
SCALE 1/2" = 1'-0"

NOTE:
NF = NEAR FACE
FF = FAR FACE
EF = EACH FACE
▲ = CUT TO FIT IN FIELD
3" CLEAR, UNLESS OTHERWISE SPECIFIED ON THE PLANS.
2'-2" BAR LAP UNLESS OTHERWISE SPECIFIED ON THE PLANS.

KEY	DATE	BY	REVISION
▲	10/05/2015	VAOT	MODIFIED BEARING THICKNESS

PROJECT NAME:	WARDSBORO
PROJECT NUMBER:	BRF 013-1(I15)
FILE NAME:	s92b283sub.dgn
PROJECT LEADER:	C. CARLSON
DESIGNED BY:	D. PETERSON
ABUTMENT #2 PLAN & ELEVATION AND BEARING DETAIL SHEET	29 OF 51
PLOT DATE:	07-OCT-2015
DRAWN BY:	R. PELLETT
CHECKED BY:	D. PETERSON