

INDEX OF SHEETS

- 1. TITLE SHEET
- 2-3. TYPICAL SECTIONS
- 4. STORM DETAILS & SPECIFICATIONS
- 5. WATER DETAILS & SPECIFICATIONS
- 6-9. HORIZONTAL LAYOUT & CONSTRUCTION PLANS
- 10-11. PROFILE SHEETS
- 12-19. CROSS SECTION SHEETS
- 20. STORMWATER POND & INTERSECTION GRADING PLAN
- 21-24. PAVEMENT MARKING, SIGN LAYOUT & LANDSCAPING SHEETS
- 25-26. TRAFFIC SIGN SUMMARY SHEET
- 27. SIGNAL LAYOUT PLAN
- 28. MAST ARM CROSS SECTIONS
- 29. MISCELLANEOUS DETAILS
- 30. MAST ARM DESIGN CANTILEVER FOOTING
- 31. CANTILEVER SUPPORT & TRAFFIC SIGNAL NOTES
- 32. SPREAD SPECTRUM TELEMETRY INTERCONNECT PLAN
- 33. COORDINATION DATA

RECORD PLANS

CONTRACTOR: DON WESTON EXCAVATING, INC. - WILLISTON, VT
 RESIDENT ENGINEER: PETER HODGSON
 CONSTRUCTION BEGAN: APRIL 24, 2004
 CONSTRUCTION COMPLETE: NOVEMBER 15, 2004
 RECORD PLANS BY: P. HODGSON & LAMOUREUX & DICKINSON

I HEREBY CERTIFY THAT ALL THE CONSTRUCTION REQUIRED BY THIS SET OF DRAWINGS HAS BEEN ACCOMPLISHED AS INDICATED HEREIN.

BY *Peter Hodgson* RESIDENT ENGINEER
 DATE *January 17, 2008*

NOTE: Any further information concerning final quantities, amounts or other details relative to this project may be found at Central Files in the electronic archives.

**RECORD PLANS
 FEBRUARY 16, 2006**

CONTRACTOR: DON WESTON EXCAVATING, INC.
 RESIDENT ENGINEER: VTRANS
 DESIGN ENGINEER: LAMOUREUX & DICKINSON CONSULTING ENGINEERS, INC.

THESE RECORD PLANS REFLECT CHANGES NOTED BY THE RESIDENT ENGINEER DURING CONSTRUCTION AS WELL AS HORIZONTAL RECORD LOCATIONS FOR NEW UTILITIES LOCATED BY RECORD SURVEY

CONVENTIONAL SYMBOLS

- FENCE LINE
- STONE WALL
- TRAVELED WAY
- CULVERT
- POWER POLE
- TELEPHONE POLE
- TREES
- PROPERTY LINE
- TOP OF CUT
- TOE OF SLOPE

LAMOUREUX & DICKINSON
 Consulting Engineers Inc.
 14 Morse Drive
 Essex Junction, VT 05452
 (802) 878-4450
 Engineers-Planners-Surveyors

DATUM
 VERTICAL NAVD 88 (METERS)
 HORIZONTAL NAD 83 (METERS)

STATE OF VERMONT
 AGENCY OF TRANSPORTATION



PROPOSED IMPROVEMENT
 INTERSECTION RECONSTRUCTION
 TOWN OF ESSEX
 COUNTY OF CHITTENDEN
 VT ROUTE 15 & OLD STAGE ROAD
 (MINOR URBAN ARTERIAL)

BEGINNING ROADWAY CONSTRUCTION AT THE INTERSECTION OF ROUTE 15 AND BILLIE BUTLER DRIVE AND EXTENDING EASTERLY ALONG ROUTE 15 495.00 m AND EXTENDING NORTH ALONG OLD STAGE ROAD 148.00 m.
 LENGTH OF ROADWAY = 628.00 m
 LENGTH OF PROJECT = 1086.00 m
 WORK TO BE PERFORMED UNDER THIS PROJECT INCLUDES RECONSTRUCTION OF ROUTE 15 AND OLD STAGE ROAD WITH NECESSARY DRAINAGE, UTILITY RELOCATION, PAVEMENT, TRAFFIC SIGNAL INSTALLATION, TRAFFIC SIGNAL INTERCONNECT FROM VT 289 TO ESSEX WAY AND OTHER RELATED ITEMS.

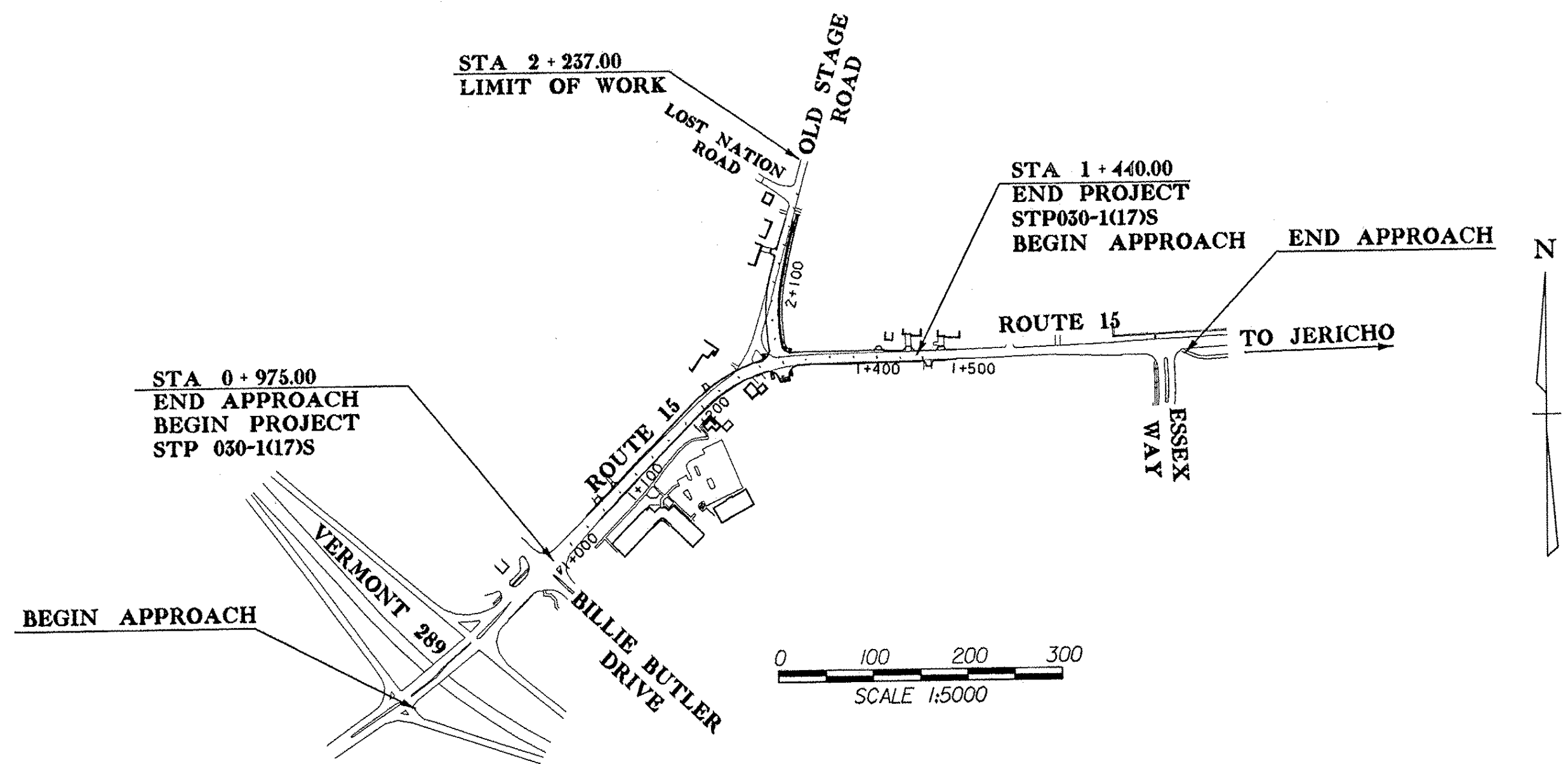

SCALE 1:5000

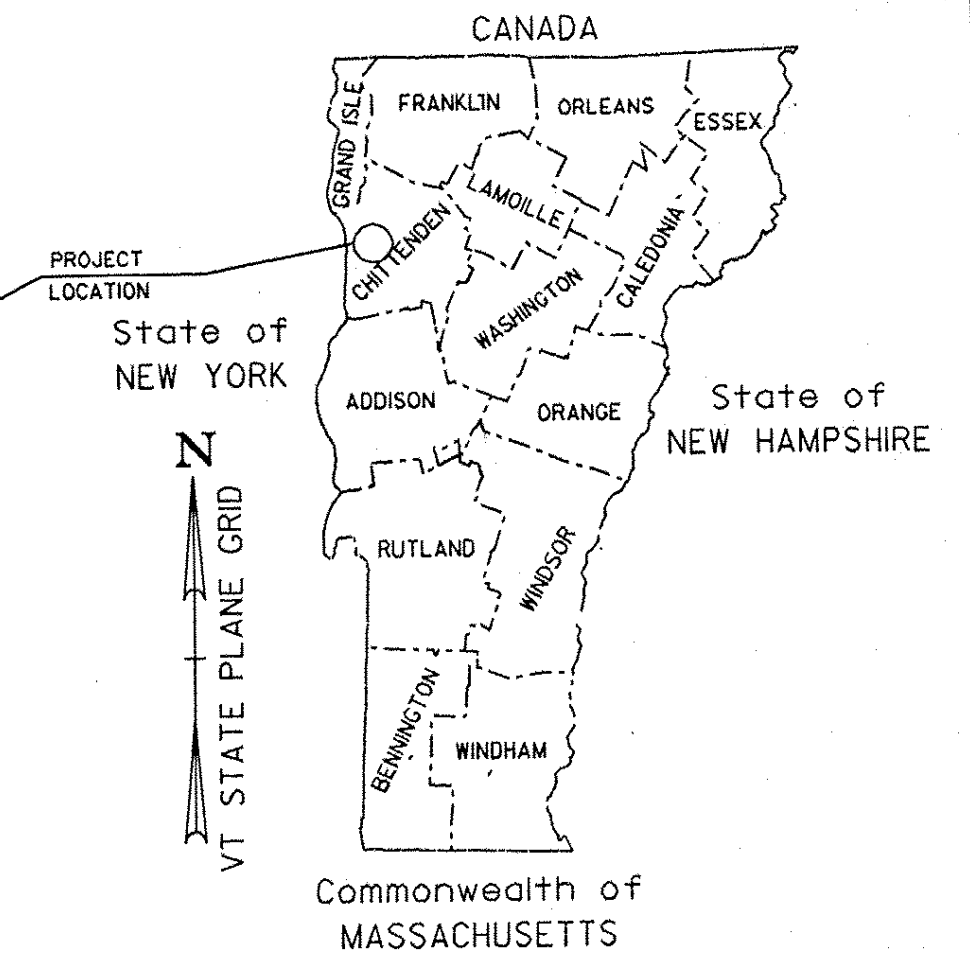
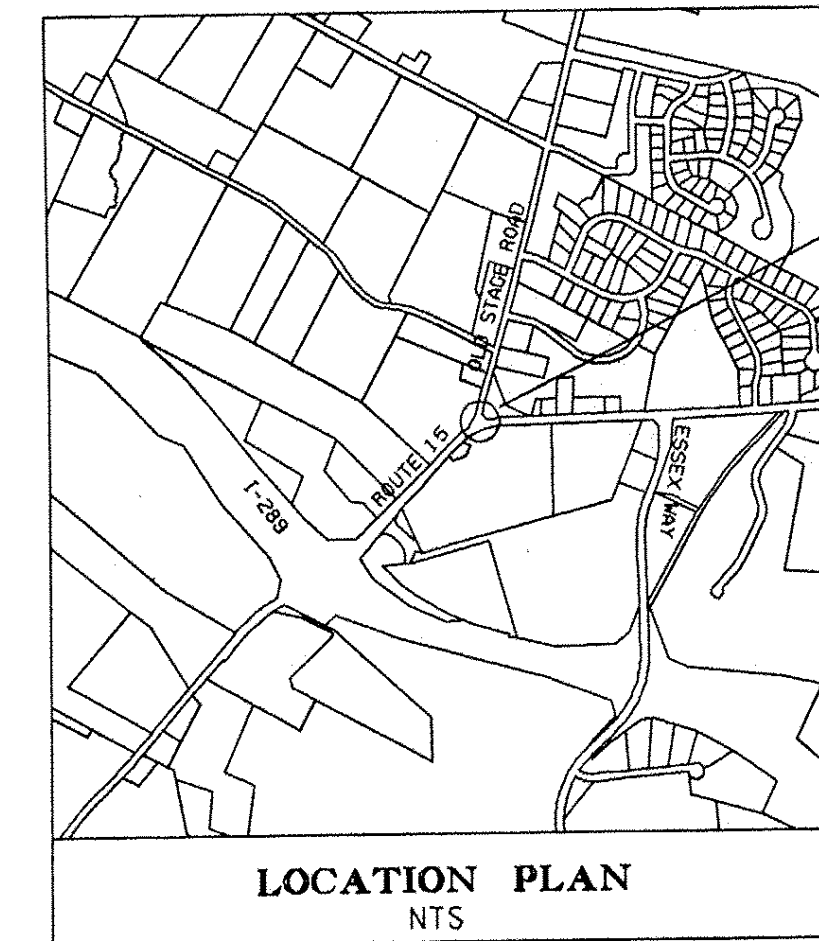

TRAFFIC DATA	VERMONT ROUTE 15		OLD STAGE ROAD
	EAST	WEST	NORTH
2002 AADT (vpd)	14,280	17,020	4,200
2007 AADT (vpd)	15,000	17,860	4,420
2007 DHV (vph)	1,750	2,110	700
D	58%	63%	66%
T	3%	2.5%	1%

ROUTE 15
 2002-2022 (20 YEAR) 18K ESAL = 4,240,738
 2002-2042 (40 YEAR) 18K ESAL = 10,096,996

THESE PLANS ARE SUBJECT TO SUCH ENGINEERING CHANGES AS MAY BE REQUIRED BY THE FEDERAL HIGHWAY ADMINISTRATION OR THE DIRECTOR OF PROJECT DEVELOPMENT.
 CONSTRUCTION IS TO BE CARRIED ON IN ACCORDANCE WITH THESE PLANS AND THE STANDARD SPECIFICATIONS FOR CONSTRUCTION DATED 2001, AS APPROVED BY THE FEDERAL HIGHWAY ADMINISTRATION ON JANUARY 4, 2001 FOR USE ON THIS PROJECT, INCLUDING ALL SUBSEQUENT REVISIONS AND SUCH REVISED SPECIFICATIONS AND SPECIAL PROVISIONS AS ARE INCORPORATED IN THESE PLANS.

Metric

UNLESS NOTED OTHERWISE
 STATIONS ARE IN KILOMETERS
 ELEVATIONS ARE IN METERS
 DIMENSIONS ARE IN MILLIMETERS

TOWN OF ESSEX
 APPROVED _____ DATE _____
 MUNICIPAL PROJECT MANAGER

PROJECT NAME : ESSEX
 PROJECT NUMBER : STP 030-1(17)S
 SHEET 1 OF 33 SHEETS