

TEMPORARY AND DURABLE 100 mm YELLOW LINE
 STA. 2+300.0 TO 2+317.0, SOLID LT. & RT.
 STA. 2+317.0 TO 2+542.0, SOLID LT., DASHED RT.
 STA. 2+542.0 TO 2+639.0, DASHED C/L
 STA. 2+639.0 TO 2+801.0, DASHED LT., SOLID RT.
 STA. 2+801.0 TO 3+000.0, SOLID LT. & RT.
 (WITH CENTERLINE BREAK FOR MT. VISTA RD.)
 STA. 2+977.3, DOUBLE SOLID LT. (MT. VISTA RD.)

TEMPORARY AND DURABLE 100 mm WHITE LINE
 STA. 2+300.0 TO 3+000.0, SOLID LT. & RT.
 (WITH EDGE LINE BREAK FOR MT. VISTA RD.)

DURABLE 600 mm STOPBAR
 STA. 2+977.3, LT.

TEMPORARY AND DURABLE LETTER OR SYMBOL
 STA. 2+977.3, LT. - "STOP"

REMOVING SIGNS
 AS SHOWN - 2

ERECTING SALVAGED SIGNS
 AS SHOWN - 1

REMOVAL AND DISPOSAL OF GUARD RAIL
~~STA. 2+300.0 TO 2+326.3, RT.~~
~~STA. 2+455.6 TO 3+000.0, RT.~~

MODIFIED ECCENTRIC LOADER TERMINAL
 STA. 2+324.7, RT.
 STA. 2+444.2, RT.

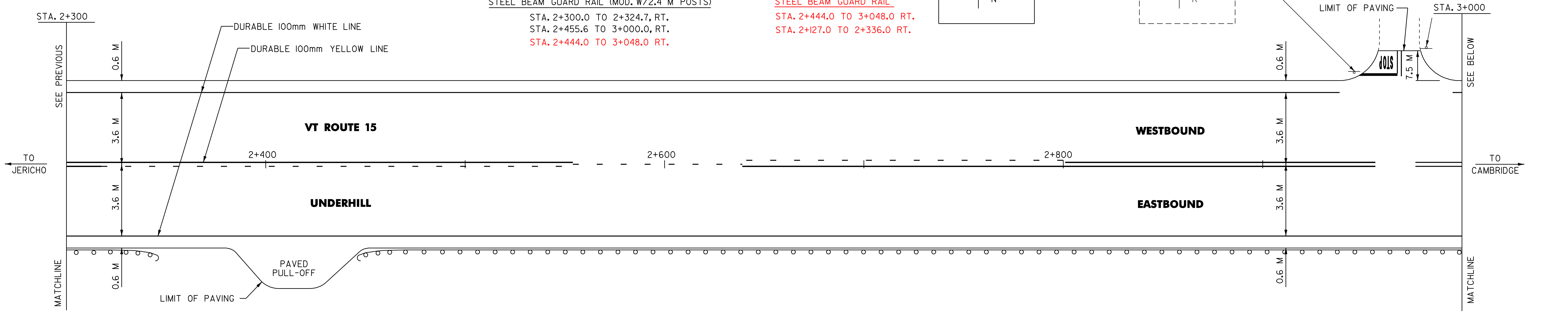
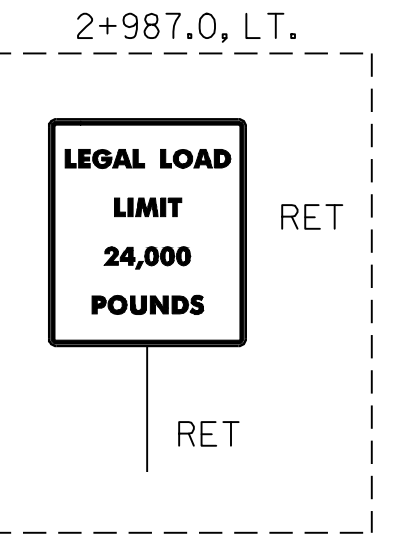
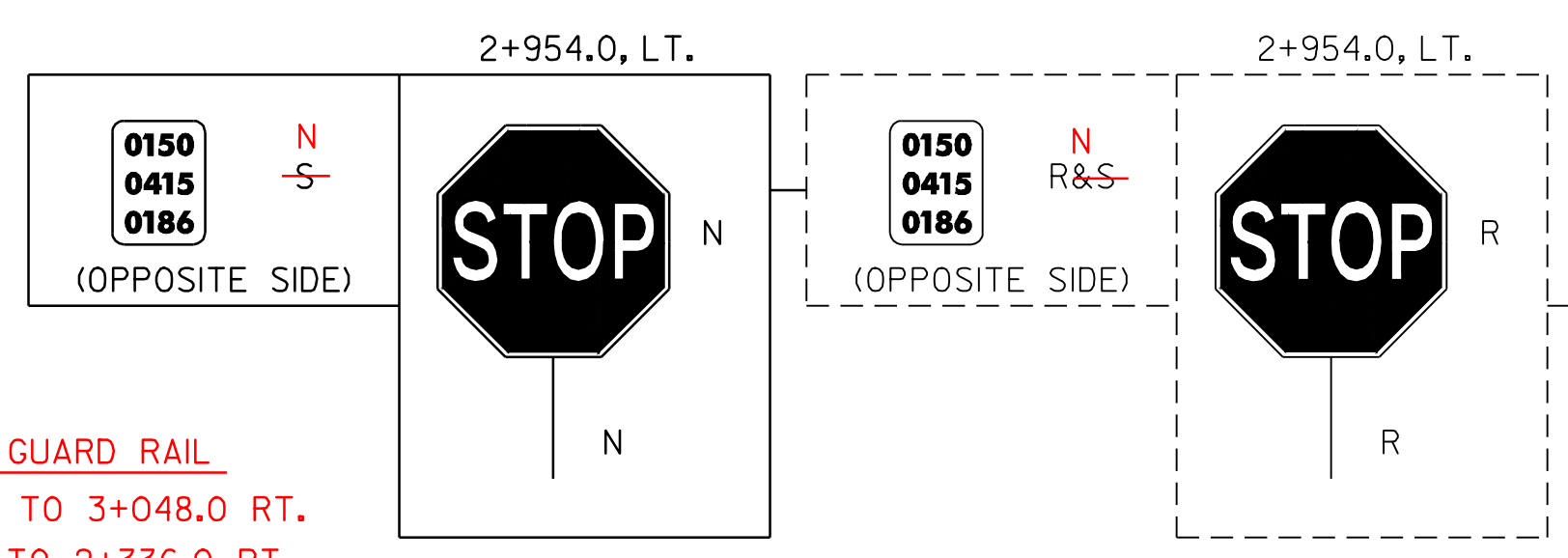

TEMPORARY AND DURABLE 100 mm YELLOW LINE
 STA. 3+000.0 TO 3+669.0, SOLID LT. & RT.
 (WITH CENTERLINE BREAK FOR KELLY RD.)
 STA. 3+669.0 TO 3+700.0, SOLID LT./DASHED RT.
 STA. 3+639.1, DOUBLE SOLID LT. (KELLY RD.)

TEMPORARY AND DURABLE 100 mm WHITE LINE
 STA. 3+000.0 TO 3+700.0, SOLID LT. & RT.
 (WITH EDGE LINE BREAK FOR KELLY RD.)

REMOVING SIGNS
 AS SHOWN - 4

ERECTING SALVAGED SIGNS
 AS SHOWN - 2

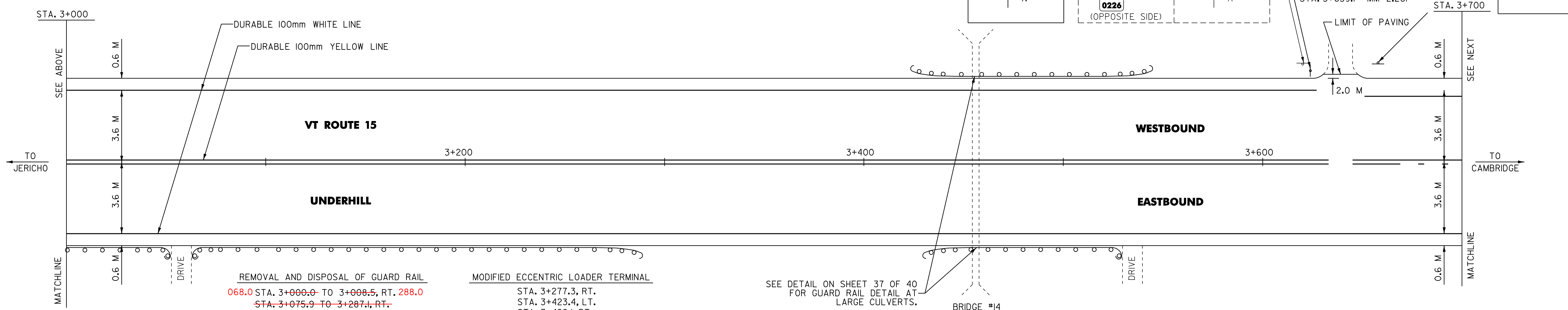
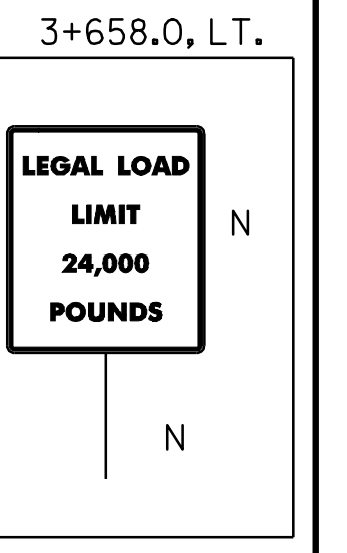
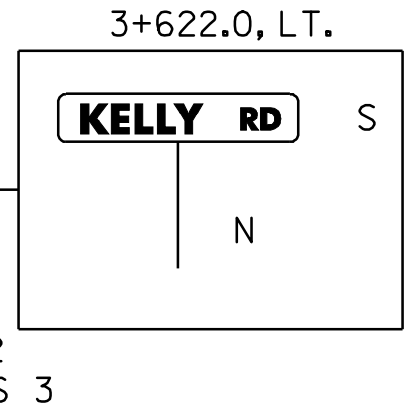
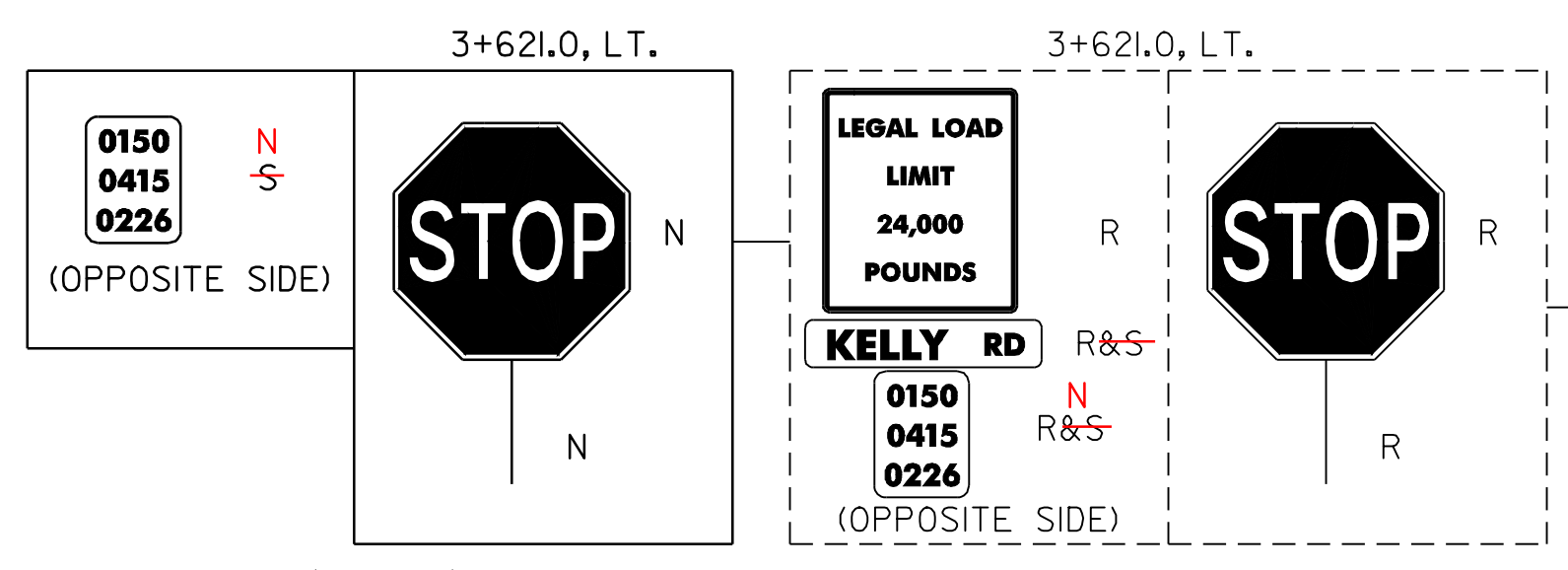

REMOVAL AND DISPOSAL OF GUARD RAIL
~~068.0 STA. 3+000.0 TO 3+008.5, RT. 288.0~~
~~STA. 3+075.9 TO 3+287.1, RT.~~
~~423.0 STA. 3+434.8 TO 3+533.6, LT. 545.0~~
~~429.0 STA. 3+440.5 TO 3+527.9, RT. 531.0~~

MODIFIED ECCENTRIC LOADER TERMINAL
 STA. 3+277.3, RT.
 STA. 3+423.4, LT.
 STA. 3+429.1, RT.
 STA. 3+533.6, LT.

STEEL BEAM GUARD RAIL
 STA. 3+068.0 TO 3+288.0 RT.

BRIDGE #14
 STA. 3+456.5 = MM 2.148

STEEL BEAM GUARD RAIL (MOD. W/2.4 M POSTS)
~~STA. 3+000.0 TO 3+048.4, RT.~~
~~068.0 STA. 3+068.3 TO 3+277.3, RT. 288.0~~
~~423.0 STA. 3+434.8 TO 3+453.8, LT. 545.0~~
~~429.0 STA. 3+440.5 TO 3+455.7, RT. 531.0~~
~~STA. 3+457.6 TO 3+533.6, LT.~~
~~STA. 3+459.5 TO 3+531.7, RT.~~

ANCHOR FOR STEEL BEAM GUARD RAIL
 STA. 3+048.4, RT. (2) |
 STA. 3+068.3, RT. (2) |
 STA. 3+531.7, RT. (2) |

HEAVY DUTY STEEL BEAM GUARD RAIL
 STA. 3+453.8 TO 3+457.6, RT.
 STA. 3+455.7 TO 3+459.5, LT.

**ARCHIVED
IN DPR**

NOTE: ALL DIMENSIONS IN MILLIMETERS EXCEPT WHERE OTHERWISE INDICATED

DATUM	
VERTICAL	N/A
HORIZONTAL	N/A

PAVING PROJECT LAYOUT #15	SURVEYED BY	W-M	DATE	12/95
	DESIGN BY	JLL/GAE	DATE	11/96
	DRAWN BY	W-M	DATE	11/96
	DESIGN FILE NO.	/pave/92b221/pb221.dgn		
	IPARM FILE	pb221i15.i	DATE	PLOTTED-SEP-2009 09
PROJ. NAME	ESSEX-UNDERHILL			
PROJ. NO.	STP 9469(1)S			
SHEET	24 OF 40 SHEETS			

NOTES: 1) FOR ANY TOWN HIGHWAY OR STREET DETAILS, SEE VAOT STANDARD E-193.
 2) ALL EXISTING SIGNS NOT SHOWN SHALL BE RETAINED AS DIRECTED BY THE RESIDENT ENGINEER.