

TEMPORARY AND DURABLE 100 mm YELLOW LINE
 ESSEX STA. 12+500.0 TO 13+090.6, SOLID LT. & RT.
 (WITH CENTERLINE BREAK FOR WEED RD.)
 ESSEX STA. 12+746.9, DOUBLE SOLID LT. (WEED ROAD)
 JERICO STA. 0+000.0 TO 0+100.0, SOLID LT. & RT.

TEMPORARY AND DURABLE 100 mm WHITE LINE
 ESSEX STA. 12+500.0 TO 13+090.6, SOLID LT. & RT.
 (WITH EDGELINE BREAK FOR WEED RD.)
 JERICO STA. 0+000.0 TO 0+100.0, SOLID LT. & RT.

REMOVING SIGNS
 AS SHOWN - 3

ERECTING SALVAGED SIGNS
 AS SHOWN - 2

TEMPORARY AND DURABLE 500 mm STOP BAR
 STA. 12+746.9, LT.

TEMPORARY AND DURABLE LETTER OR SYMBOL
 STA. 12+746.9, LT. *STOP*

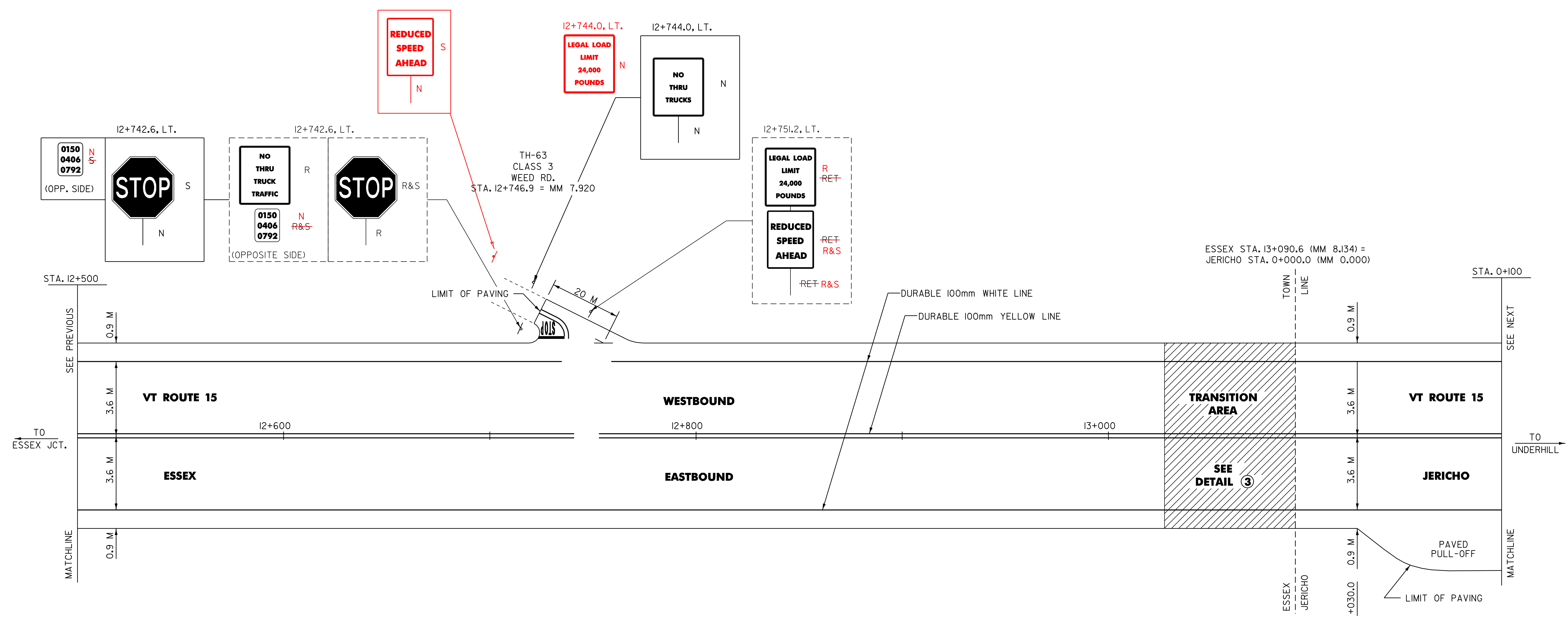

**ARCHIVED
 IN DPR**

NOTE: ALL DIMENSIONS IN MILLIMETERS EXCEPT WHERE OTHERWISE INDICATED

DATUM
 VERTICAL N/A
 HORIZONTAL N/A

NOTES: 1) FOR ANY TOWN HIGHWAY OR STREET DETAILS, SEE VAOT STANDARD E-193.
 2) ALL EXISTING SIGNS NOT SHOWN SHALL BE RETAINED AS DIRECTED BY THE RESIDENT ENGINEER.

PAVING PROJECT LAYOUT #5	SURVEYED BY	W-M	DATE	12/95
	DESIGN BY	JLL/GAE	DATE	11/96
	DRAWN BY	W-M	DATE	11/96
	DESIGN FILE NO.	/pave/92b221/pb221.dgn		
	IPARM FILE	pb221i05.i	DATE	PLOTTED-SEP-2009 09
	PROJ. NAME	ESSEX-UNDERHILL		
PROJ. NO.	STP 9469(1)S			
SHEET		14 OF 40 SHEETS		