

LINE	SEQ	SHIPPING END ASSEMBLY MARK	MARK	SHAPE	DESCRIPTION	LENGTH		REMARKS	MATERIAL ASTM A709-50 T2 U.N.O.				
						ft	in		MATL GRADE	MATL REMARK	WEIGHT	HEAT NO	
1													
2	ONE		M60A	PL	PL 3/8 x 20 1/4	4	1 3/4	BENT D.O.R. LENGTH			TUW Ltr	103.1	
3													
4	ONE		M60B	PL	PL 3/8 x 20 1/4	4	1 3/4	BENT D.O.R. LENGTH			TUW Ltr	103.1	

ALL HOLES TO BE PUNCHED U.N.O.

NO EXCEPTION TAKEN REJECTED  
 MAKE CORRECTIONS NOTED  
 REVISE AND RESUBMIT  
 SUBMIT SPECIFIED ITEM

CHECKING IS ONLY FOR GENERAL CONFORMANCE WITH THE DESIGN CONCEPT OF THE PROJECT AND GENERAL COMPLIANCE WITH THE INFORMATION GIVEN IN THE CONTRACT DOCUMENTS. ANY ACTION SHOWN IS SUBJECT TO THE REQUIREMENTS OF THE PLANS AND SPECIFICATIONS. CONTRACTOR IS RESPONSIBLE FOR DIMENSIONS WHICH SHALL BE CONFIRMED AND CORRELATED AT THE JOB SITE; FABRICATION PROCESSES AND TECHNIQUES OF CONSTRUCTION; COORDINATION OF HIS WORK WITH THAT OF ALL OTHER TRADES AND THE SATISFACTORY PERFORMANCE OF THE WORK.

DATE 7/9/12 BY CHA  
PKR

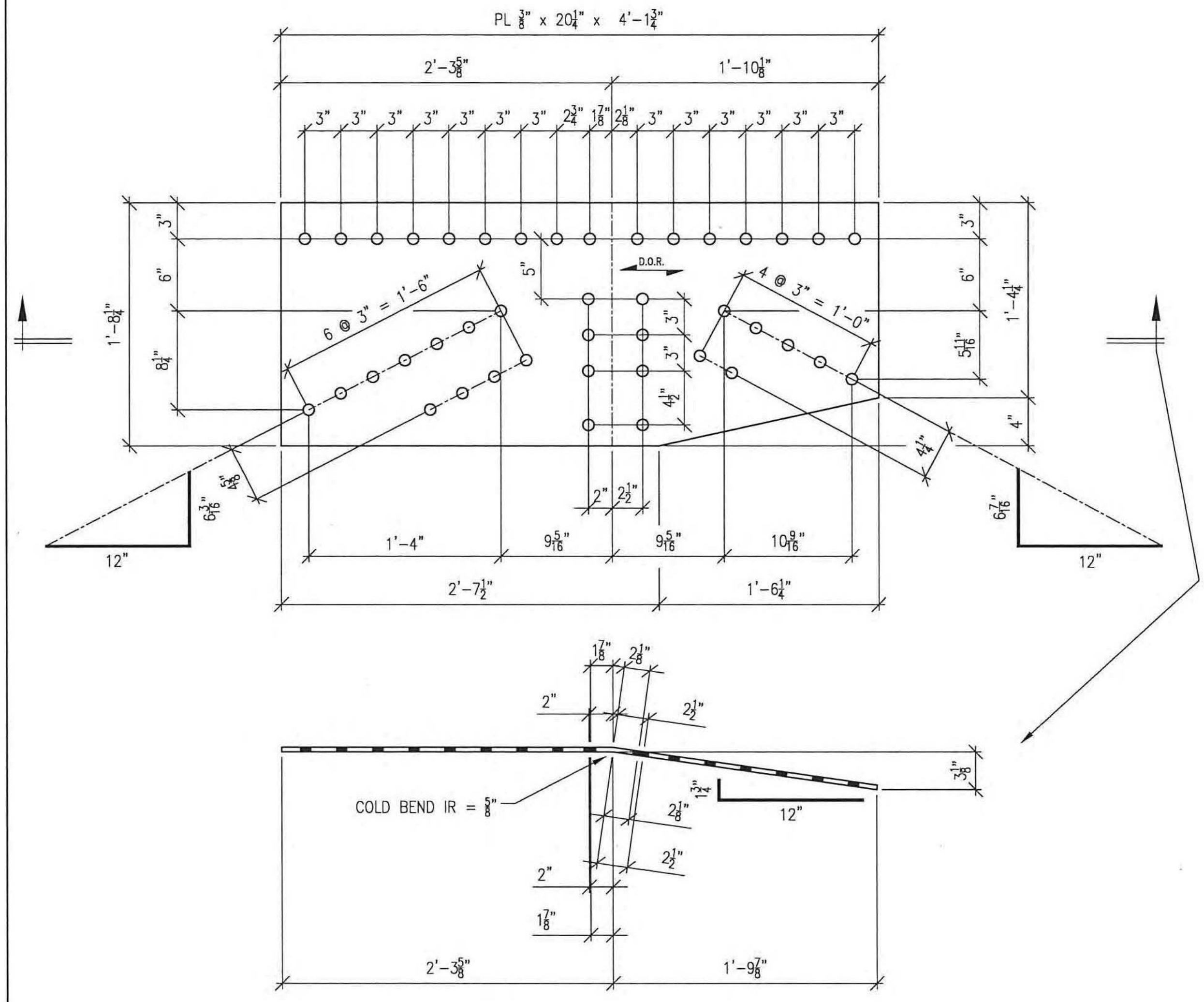

ONE REQ'D ~ Mk. M60A

LIFTING WEIGHT
103.1
lbs

**U4**

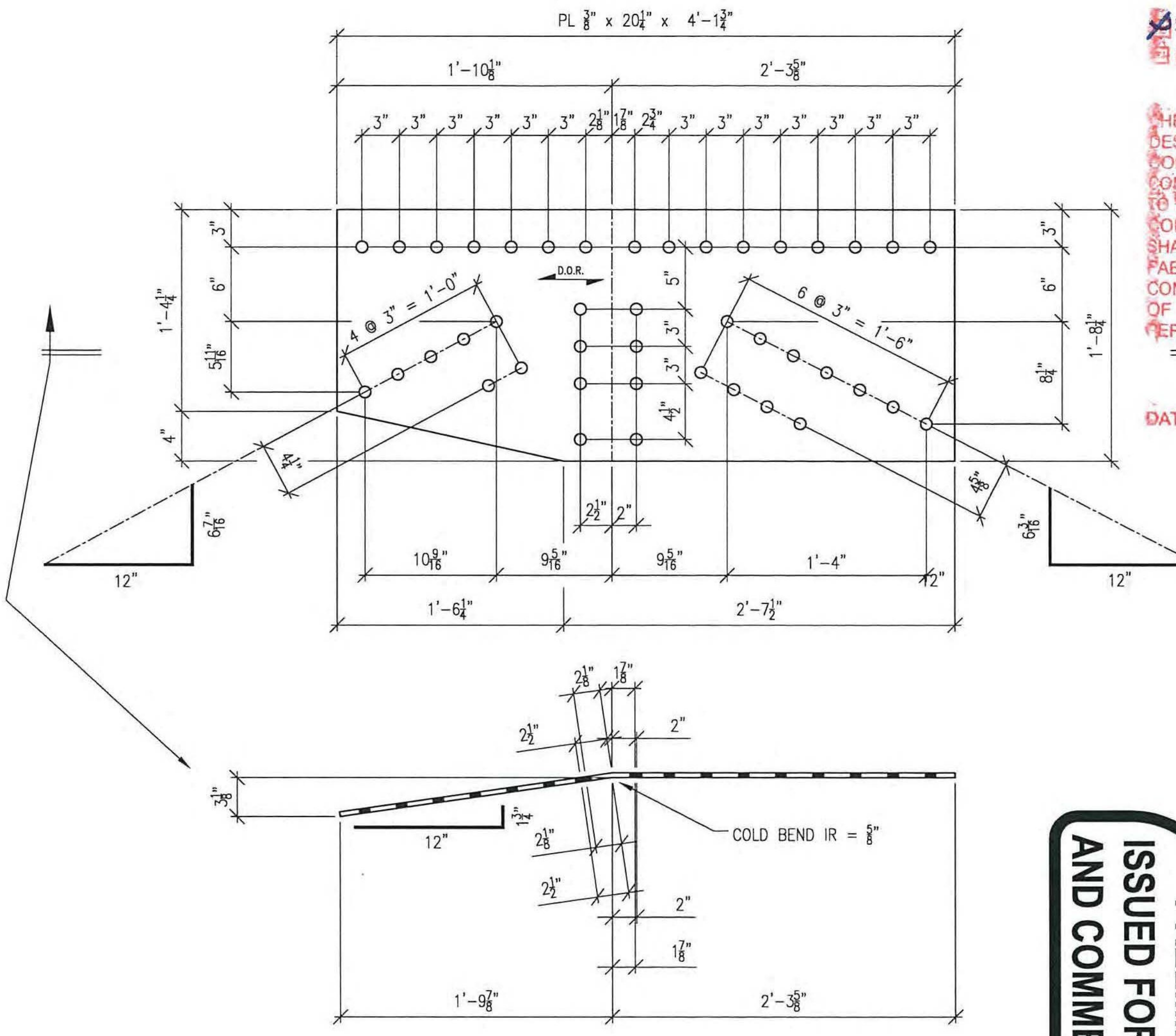

ONE REQ'D ~ Mk. M60B

LIFTING WEIGHT
103.1
lbs

**U14**

PAINT NOTES:

1. ALL ITEMS THIS SHEET TO RECEIVE UPPER STEEL PAINT SYSTEM PER GN1.
2. CLEAN AND PRIME BOLTED PARTS PRIOR TO ASSEMBLY.
3. PRIMER ONLY, WITHIN 3" FROM ALL OPEN HOLES. (A307) SHIPPING BOLTS AND NUTS OR TO NEAREST EDGE OR PERPENDICULAR SURFACE (WHICHEVER IS LESS) UNLESS SPECIFICALLY NOTED OTHERWISE.
4. ALL TORQUED BOLTS TO RECEIVE COMPLETE PAINT SYSTEM NOTED. NO PAINT ON (A307) SHIPPING BOLTS AND NUTS.

NOTES:

1. FOR GENERAL NOTES SEE DRAWING GN1.
2. ALL BOLTS THIS SHEET TO BE FULLY TORQUED UNLESS NOTED AS (A307) SHIPPING BOLTS.
3. INSTALL WASHER UNDER HEAD OF BOLT AS WELL AS NUT. ADDITIONAL WASHER IS NOT REQUIRED FOR (A307) SHIPPING BOLTS.
4. ALL HOLES MARKED "X" OR "X" ARE TO BE FIELD DRILLED HOLES. DO NOT SHOP DRILL.

- LEGEND:**
- CL = CENTERLINE
  - CTR'D = CENTERED
  - C/C = CENTER TO CENTER
  - FLG = FLANGE
  - TOP = TOP
  - BTM = BOTTOM
  - RDFH = RUNNING DIMENSIONS FROM HERE
  - = FIELD BOLTS (QUANTITY) DIAMETER x LENGTH
  - ◇ = ALTERNATE HOLE DIAMETER
  - TYP = TYPICAL
  - N/S = NEAR SIDE
  - F/S = FAR SIDE
  - B/S = BOTH SIDES
  - BTS = BOLT TO SHIP
  - SHPG BOLT = SHIPPING BOLT
  - ◇ = SHIPPING BOLT
  - D.O.R. = DIRECTION OF ROLL
  - T2 = CHARPY V-NOTCH TESTING REQUIRED
  - F2 = FRACTURE CRITICAL MATERIAL
  - X = FIELD DRILLED HOLE
  - X = FIELD DRILLED HOLE

**PRELIMINARY  
ISSUED FOR REVIEW  
AND COMMENT ONLY**

ALL DIMENSIONS HAVE BEEN FIELD VERIFIED  
 BY: \_\_\_\_\_ DATE: \_\_\_\_\_

NO.		DATE	BY	REVISION
A	07/04/12	RC		FOR APPROVAL

**STS STEEL, INC.**  
 ENGINEERS \* FABRICATORS \* ERECTORS  
 PH: (518) 370-2693 FAX: (518) 370-2696

DRAWING TITLE  
**UPPER STEEL ADDITIONAL GUSSETS (U4 & U14)**

PROJECT No. US RT 2 BRIDGE No 24 FEDERAL AID No.  
 ENGINEER : CHA  
 CUSTOMER : Harrison & Burrows Bridge Constructors, Inc.  
 PROJECT : RICHMOND, VT - TRUSS BRIDGE REHAB  
 RICHMOND, VT

HOLES: 15/16" U.N.O. PAINT: PER SPEC DATE: 07/04/12  
 BOLTS: A325 U.N.O. DR.BY: RC JOB NO. 1156  
 WELDS: AWS D1.5 CHK.BY: SG DWG NO. 60

