

2R2 DETAILS
(1) REQUIRED

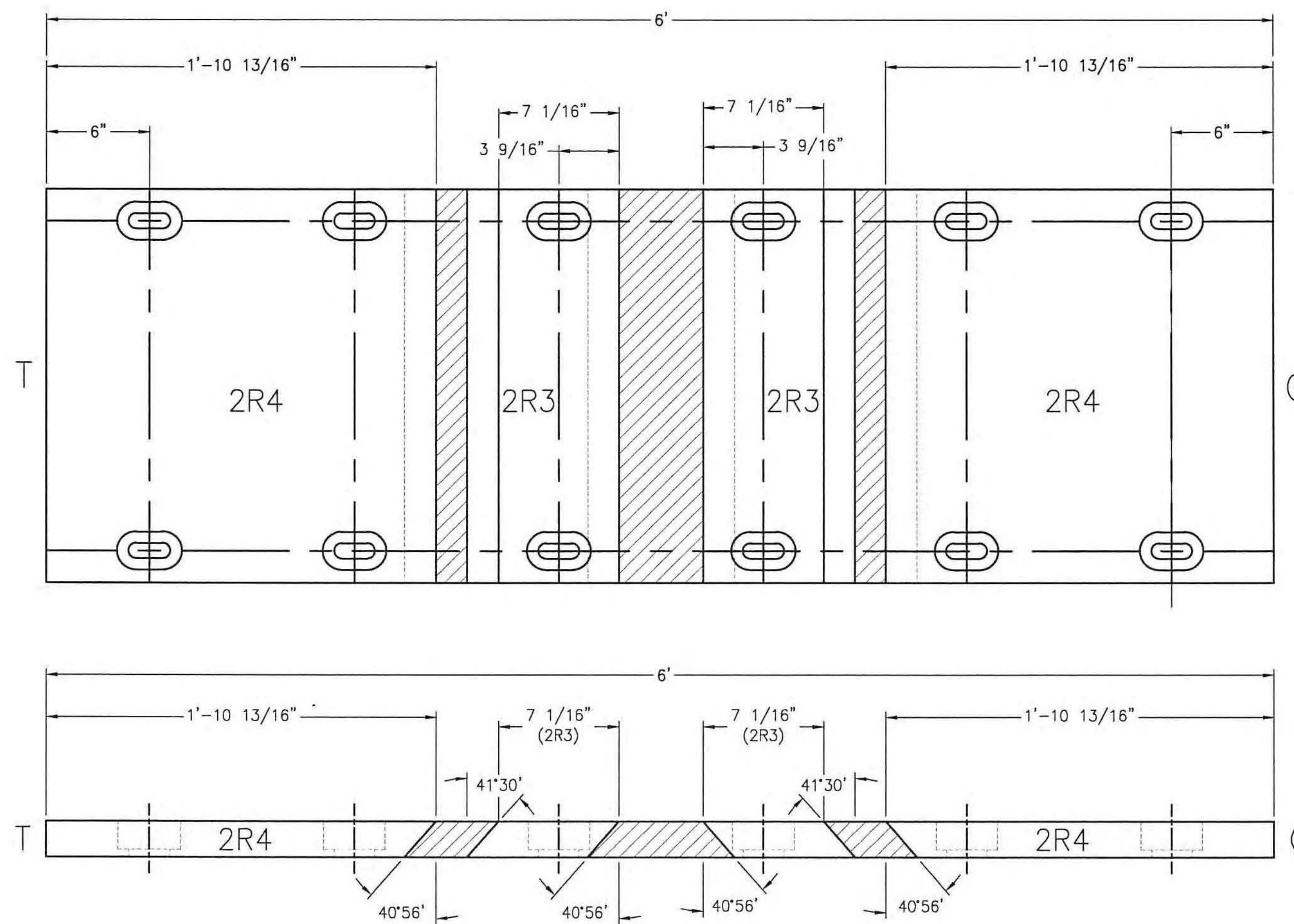

2R3 & 2R4 DETAILS
(1) REQUIRED

WAB143387AA QTY: 1 REQ'D.		STRUCTURED BILL OF MATERIALS				DWG# B-29906	
LV	PART NO.	QTY	UM	DESCRIPTION	MATERIAL	REVISION	
0	WAB143387AA	1	EA	WABOFLEX CUT PIECES; (U PL = 33'-0"	CUT SHEETS		
1	20922	12	FT	TRANSFLEX 400-A NEOPRENE			

WAB143387PS QTY: 1 REQ'D.		STRUCTURED BILL OF MATERIALS				DWG# B-29906	
LV	PART NO.	QTY	UM	DESCRIPTION	MATERIAL	REVISION	
0	WAB143387PS	1	EA	PARTS FOR SHIPPING (for WAB143387AA) (U			
1	5370	72	EA	BOLT 3/4 x6 HZA A449			
1	7602	72	EA	WASHER 3/4(A) ZINCPLETED F436-*			
1	8021	72	EA	NUT 3/4 (A) ZINCPLETED A325-*			
1	7771	72	EA	LOCKWASHER 3/4 (A) ZINCPLETED			
1	20922	24	FT	TRANSFLEX 400-A NEOPRENE			
1	2750	2	GA	URA SEAL SEALANT PART A			
1	2760	2	GA	URA SEAL SEALANT PART B			
1	2830	88	FT	SEALANT BEDDING TAPE			
1	2826	32	EA	NP1 ONE-PART POLYURETHANE SELN			
1	3167	40	FT	NEOPRENE GUTTER MEMBRANE 30" Δ			

- NO EXCEPTION TAKEN
- MAKE CORRECTIONS NOTED
- REJECTED
- REVISE AND RESUBMIT
- SUBMIT SPECIFIED ITEM

CHECKING IS ONLY FOR GENERAL CONFORMANCE WITH THE DESIGN CONCEPT OF THE PROJECT AND GENERAL COMPLIANCE WITH THE INFORMATION GIVEN IN THE CONTRACT DOCUMENTS. ANY ACTION SHOWN IS SUBJECT TO THE REQUIREMENTS OF THE PLANS AND SPECIFICATIONS. CONTRACTOR IS RESPONSIBLE FOR DIMENSIONS WHICH SHALL BE CONFIRMED AND CORRELATED AT THE JOB SITE; FABRICATION PROCESSES AND TECHNIQUES OF CONSTRUCTION; COORDINATION OF HIS WORK WITH THAT OF ALL OTHER TRADES AND THE SATISFACTORY PERFORMANCE OF THE WORK.

DATE 08/31/2012 BY *[Signature]*

MARK SYSTEM
SHEET NUMBER:
ITEM DESIGNATION:
ITEM NUMBER:
2e1

STATE: VERMONT
TOWN: RICHMOND
COUNTY: CHITTENDEN
PROJECT NO.: STP-RS 0284(11)
HIGHWAY NO.: U.S. ROUTE 2
PRODUCT NO.: WAB143387AA
JOINT TYPE: WABO TRANSFLEX

DRAWING ACTION:
SUBMITTED FOR APPROVAL
DATE: 8/10/12

Δ	ADDED GUTTER MEMBRANE AS PER REVIEWER'S REQUEST	JWM	8/21/12
----------	---	-----	---------

Watson Bowman Acme
WATSON BOWMAN ACME CORPORATION
95 PINEVIEW DRIVE, AMHERST, N.Y. 14228 TEL. (716) 691-7555 FAX (716) 691-9239

BASF
The Chemical Company

PROJECT: U.S. ROUTE 2; BRIDGE NO. 24
OVER WINOOSKI RIVER
CHITTENDEN COUNTY
WABO TRANSFLEX 400-A EXPANSION JOINT DETAILS

DATE:	5/12/12
CHECKED BY:	JWM
DATE:	5/12/12
CHECKED BY:	SM
SCALE:	NTS
WBA JOB NO.:	143387
SHEET NO.:	4 OF 4
DRAWING NO.:	B-29906