

FILE NAME = V:\Projects\161\161 BRIDGE DESIGN\161 BRIDGE DESIGN\161 BRIDGE DESIGN\161 BRIDGE DESIGN.dwg
 DATE/TIME = 3/14/2013
 USER = 3253

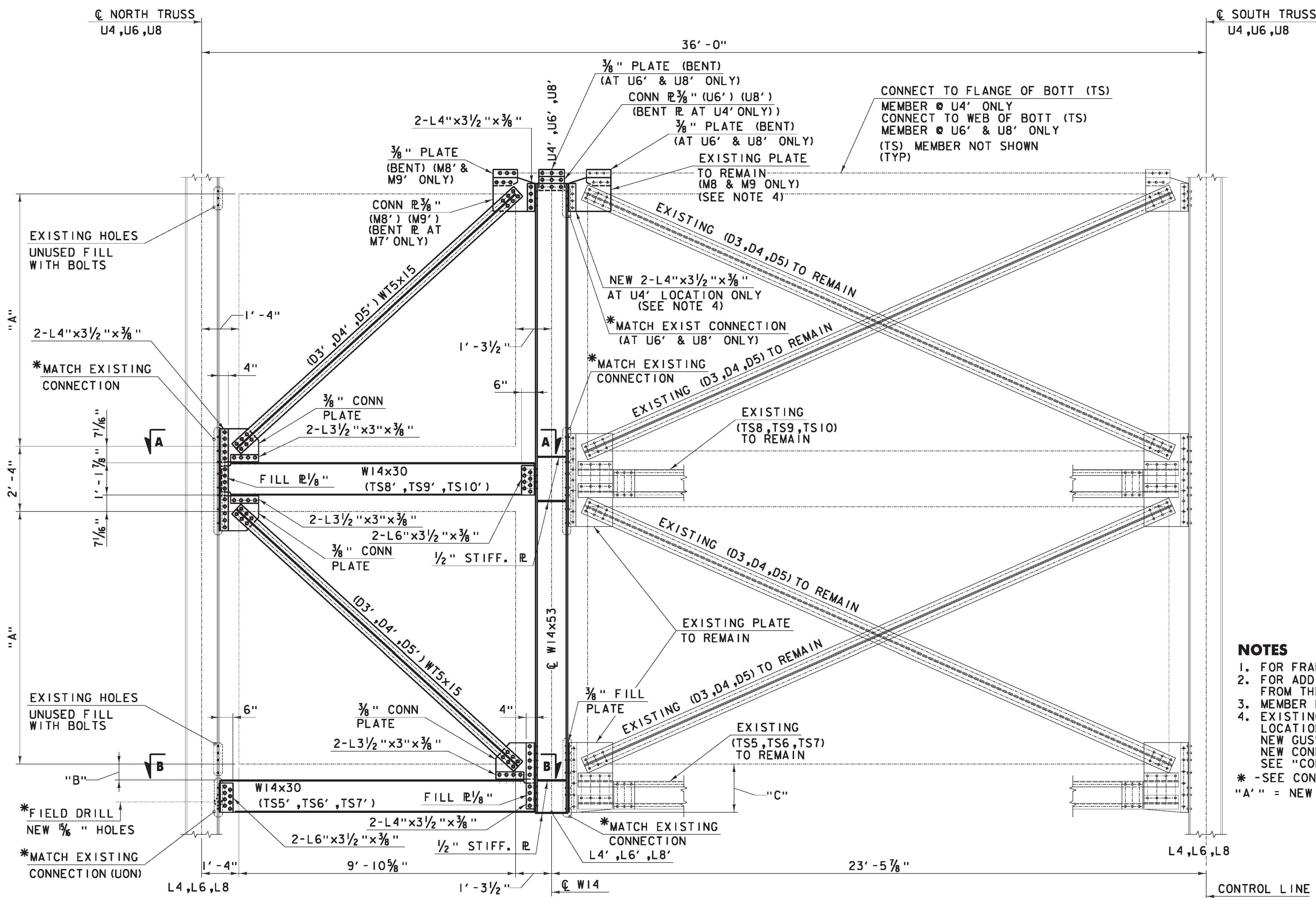

- NOTES**
1. FOR FRAMING PLAN AND SECTIONS, SEE DWG NO ST1.
 2. FOR ADDITIONAL INFORMATION, SEE SHEET E1, 2' 11, 16, 18, 19, 20 FROM THE 1929 FABRICATION DRAWINGS.
 3. MEMBER DESIGNATIONS TAKEN FROM 1929 FABRICATION DRAWINGS
 4. EXISTING M7 MEMBER TO BE REPLACED AT U4' AND U14' LOCATIONS ONLY:
 NEW GUSSET $\frac{3}{8}$ " (BENT)
 NEW CONN $L4 \times 3\frac{1}{2} \times \frac{3}{8}$ (2 REQ'D PER MEMBER)
 SEE "CONNECTION DETAIL AT U4"
 * - SEE CONNECTION INSTALLATION METHODS
 "A" = NEW JOINT NUMBER OR NEW MEMBER DESIGNATION.

DIMENSION TABLE				
LOCATION	"A"	"B"	"C"	
U4 & U14 (D3')	9'-0 $\frac{1}{2}$ "	8 $\frac{3}{8}$ "	1'-10 $\frac{1}{2}$ "	
U6 & U12 (D4')	11'-2"	8 $\frac{3}{8}$ "	1'-10 $\frac{1}{2}$ "	
U8 & U10 (D5')	11'-11"	8 $\frac{3}{8}$ "	1'-10 $\frac{1}{2}$ "	

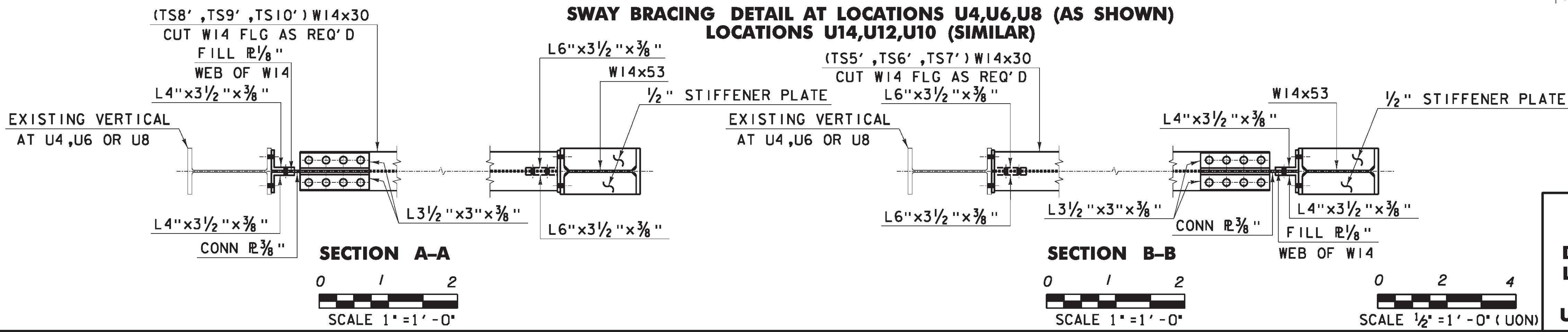

SWAY BRACING DETAILS AT LOCATIONS U4, U6, U8 U14, U12, U10

PROJECT NAME:	RICHMOND	PLOT DATE:	3/14/2013
PROJECT NUMBER:	STP-RS 0284(II)	DRAWN BY:	PKR
FILE NAME:	z90c092_port.dtl.02.dgn	DESIGNED BY:	RH
PROJECT LEADER:	DJV	DWG. NO.:	ST5
		CHECKED BY:	VC/KM
		SHEET	X OF X