

**NOTES:**

- \* FOR ADDITIONAL DETAILS SEE "TOP CHORD LAUNCHING BEAM TYPICAL SECTION" SHEET.
  - \*\* FOR ADDITIONAL DETAILS SEE "TRANSVERSE SUPPORT BEAM TYPICAL SECTION" SHEET.
  - \*\*\* FOR ADDITIONAL DETAILS SEE "TEMPORARY LONGITUDINAL STRINGER LAYOUT" SHEET.
  - \*\*\*\* FOR ADDITIONAL DETAILS SEE "TEMPORARY TOWER DETAILS" SHEET.
1. QUICK DECK SYSTEM AND CONNECTIONS TO TRANSVERSE BEAM IS TO BE DESIGNED BY OTHERS. FINLEY'S ASSUMED DESIGN LOAD IS 20 PSF. LOADS ARE APPLIED AS POINT LOADS TO TRANSVERSE SUPPORT BEAMS AT THE LOCATIONS SHOWN BELOW.

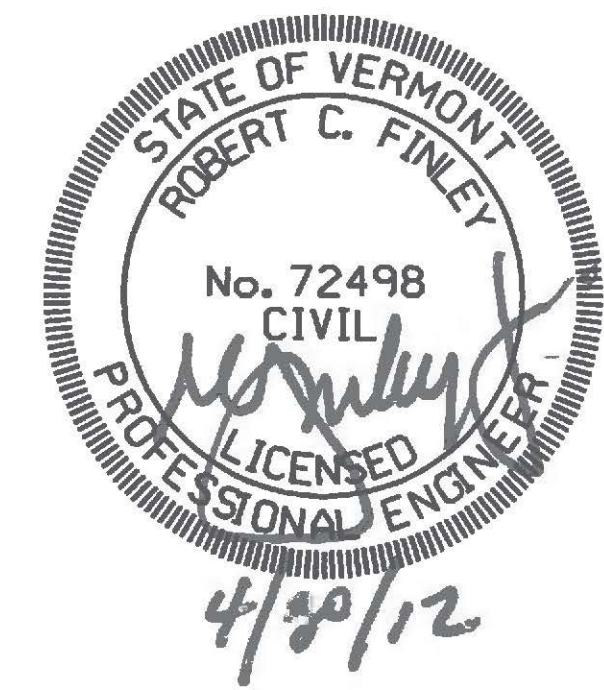
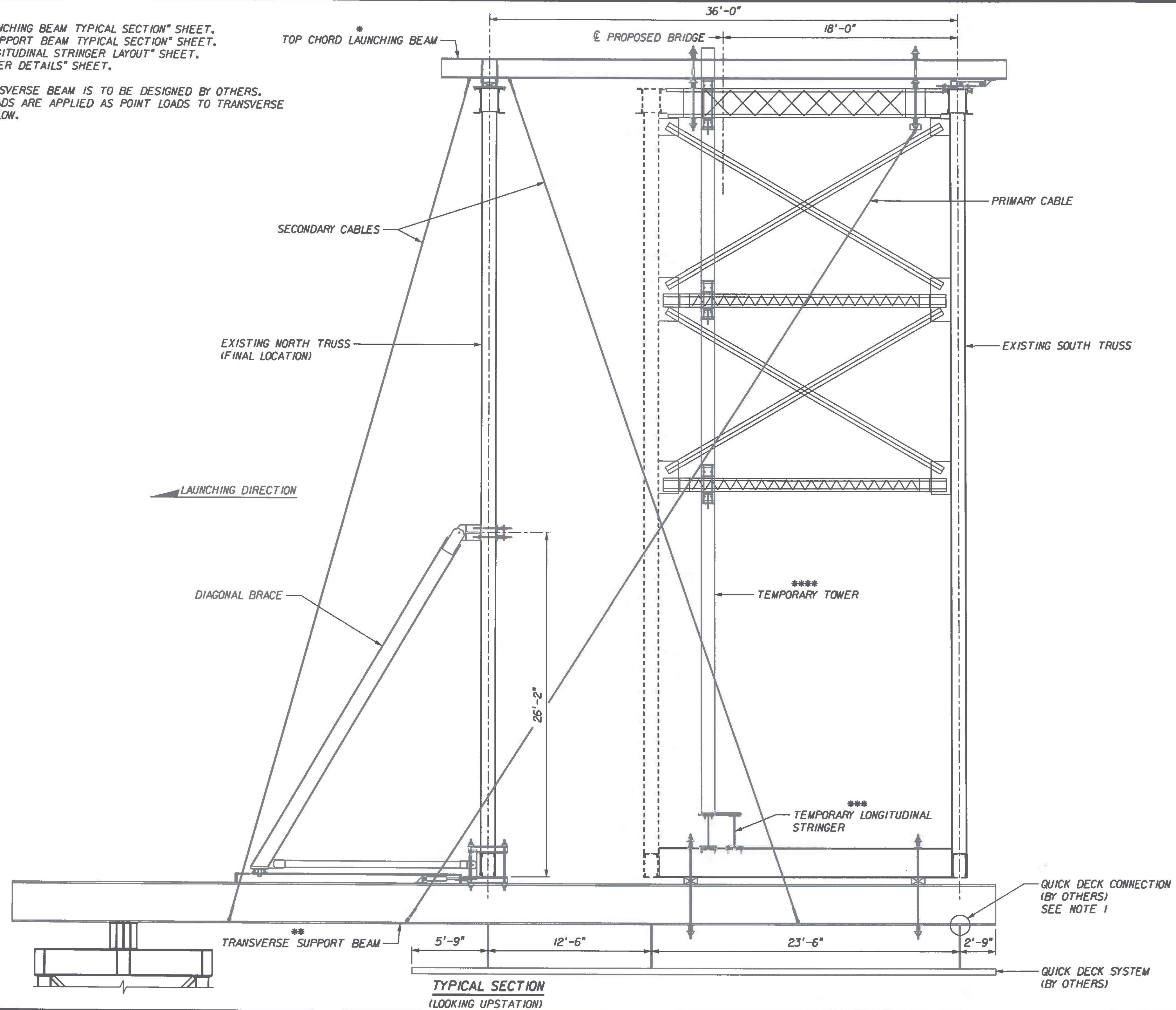

Revision	Drawn By	Date	Description	Revision	Drawn By	Date	Description	Name	Date	Project	Title	Sheet No.
1	JLB	04/24/12	Removed Mabey Truss and Added Temporary Bents					Drawn By: JLB	01/12	RICHMOND TRUSS WIDENING STATE OF VERMONT AGENCY OF TRANSPORTATION CHITTENDEN COUNTY U.S. ROUTE 2 BRIDGE NO. 24	TYPICAL SECTION	05
							Designed By: NMC	01/12				
							Approved By: JMP	01/12				