

646.602 TEMPORARY 4 INCH WHITE LINE, PAINT
 (ALL LINES WILL INCLUDE EDGE LINE BREAKS AND
 RADIUS FOR TOWN HIGHWAYS)
 RICHMOND:
 STA D 19+25.00 - STA D 22+50.00 EDGE LINE LT & RT

646.612 TEMPORARY 4 INCH YELLOW LINE, PAINT
 (ALL LINES WILL INCLUDE C/L BREAKS FOR
 TOWN HIGHWAYS) S=SOLID, D=DASHED
 RICHMOND:
 STA D 19+25.00 - STA D 22+50.00 LT S RT S

675.50 REMOVING SIGNS
 AS SHOWN - 5
 675.60 ERECTING SALVAGED SIGNS
 AS SHOWN - 3

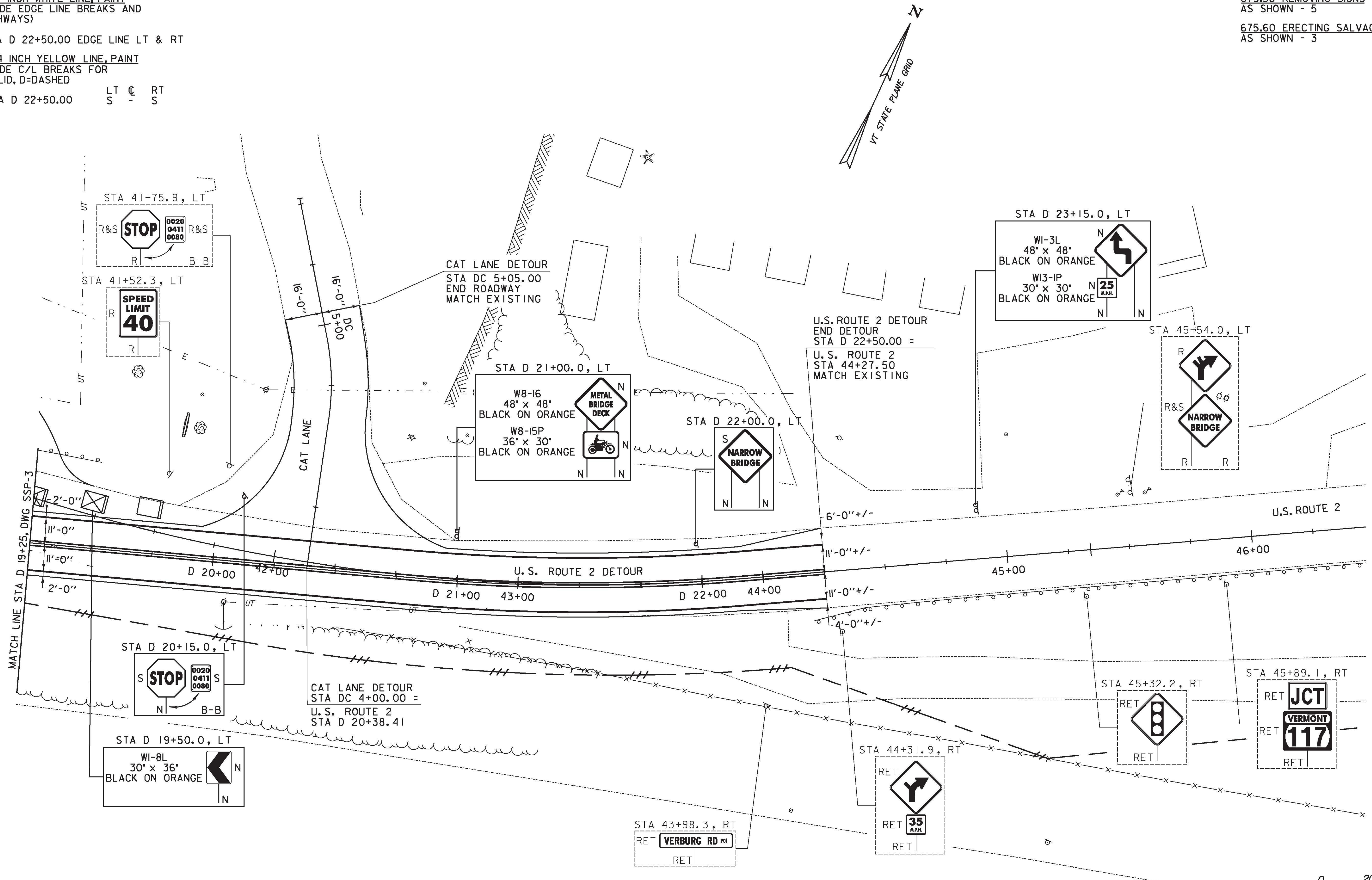

LEGEND

☒ TYPE III BARRICADE (MOD)

☐ TYPE III BARRICADE

NOTE:
 I. SEE NOTES ON SHEET 15.

SIGN LEGEND

R = REMOVE
 S = SALVAGE
 N = NEW
 RET = RETAIN
 B-B = BACK TO BACK
 EXISTING = -----
 NEW = _____
 Ⓢ = RETURN TO TOWN OF RICHMOND

SIGNING & STRIPING SHEET #4

PROJECT NAME: RICHMOND
 PROJECT NUMBER: STP-RS 0284(III)
 FILE NAME: z90c092_ssp_04_13.dgn
 PROJECT LEADER: D.E.G.
 DESIGNED BY: B.T.H.
 DWG. NO.: SSP-4

PLOT DATE: 6/20/2011
 DRAWN BY: C.A.K.
 CHECKED BY: D.E.G.
 SHEET 18 OF 29

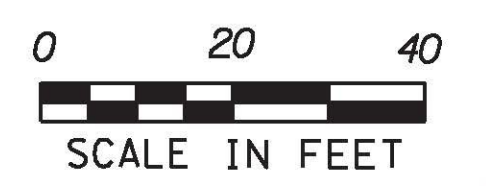

FILE NAME = V:\projects\2011\22076\CAOD\MSTN\BBS 01-131\DETOUR\z90c092_ssp_04_13.dgn
 DATE/TIME = 6/20/2011 10:58:30
 USER = 3086