

CONSTRUCT FIELD DRIVE
 E STA. 344 + 47.75 RT.
CONSTRUCT INTERSECTION WITH T.H. 34
 E STA. 344 + 04.00 LT.

BRIDGE RAILING - 3 RAIL ALUMINUM
 E STA. 344 + 08.8 LT. - E STA. 344 + 32.4 LT.
 E STA. 344 + 54.4 RT. - E STA. 344 + 66.5 RT.

ALUMINUM APPROACH RAILING
 M STA. 10 + 466.0 LT. - E STA. 344 + 08.8 LT.
 E STA. 344 + 32.4 LT. - T.H. 34 E STA. 98 + 79.5 LT.
 DRIVE STA. 1 + 57.2 LT. - E STA. 344 + 54 RT.
 E STA. 344 + 66.5 RT. - E STA. 344 + 91.3 RT.

SNOW FENCE
 M STA. 10 + 470.0 LT. - E STA. 344 + 00.0 LT.
 E STA. 344 + 10.0 LT. - M STA. 3 + 032.0 LT.
 E STA. 344 + 30.0 RT. - E STA. 344 + 36.0 RT.

SNOW FENCE LOCATES THE CONSTRUCTION LIMIT NEAR THE MILL AREA AND ALONG THE STONE WALL NEAR THE FIELD DRIVE. NO WORK SHALL BE PERMITTED OUTSIDE OF THIS LIMIT.

BM NO. 2
 CHISEL SQUARE
 TOP CONC. CURB
 UPSTREAM SIDE OF BRIDGE
 ELEV. = 591.775

BM NO. 1
 CHISEL SQUARE
 CONC. FOUND
 ELEV. = 595.894

STOP PROJECT STP 0126 (4) S
 BEGIN PROJECT TH2 - 9103
 METRIC STA. 10 + 480.000 -
 ENGLISH STA. 343 + 83.20

CHANNEL POB
 STA. 50 + 25.000

END BRIDGE
 STA. 344 + 48.90
 F.G. = 593.31

END PROJECT TH2 - 9103
 BEGIN PROJECT STP 0126 (4) S
 ENGLISH T.H. 34 STA. 99 + 08.14 -
 METRIC T.H. 34 STA. 3 + 020.000

T.H. 34 STA. 98 + 70.96 LT. - T.H. 34 STA. 98 + 72.05 RT.
 REMOVE EXISTING 6" CAST IRON PIPE W/ EXISTING 2" STEEL WATER PIPE INSIDE
 Δ = 111' 02" 19' LT.

VT 121 STA. 344 + 64.88 -
 T.H. 34 POB STA. 98 + 42.52
 Δ = 111' 02" 19' LT.

VT 121 STA. 344 + 87.86; 29.49' LT. - VT 121 STA. 344 + 87.86; 20.44' RT.
 NEW 18" X 50" CULVERT W/ REINFORCED CONCRETE DI AND TYPE D GRADE

END PROJECT TH2 - 9103
 RESUME PROJECT STP 0126 (4) S
 ENGLISH STA. 345 + 14.44 -
 METRIC STA. 10 + 520.000

EXISTING BRIDGE DATA:
 CONCRETE SLAB: 16'-0" X 6'-6"
 CLEAR HEIGHT: 6'-6"
 ROADWAY WIDTH: 18'-6"
 BRIDGE WIDTH: 24'-0"
 PERPENDICULAR SPAN: 10'-4"
 PARALLEL LENGTH: 27'-5"

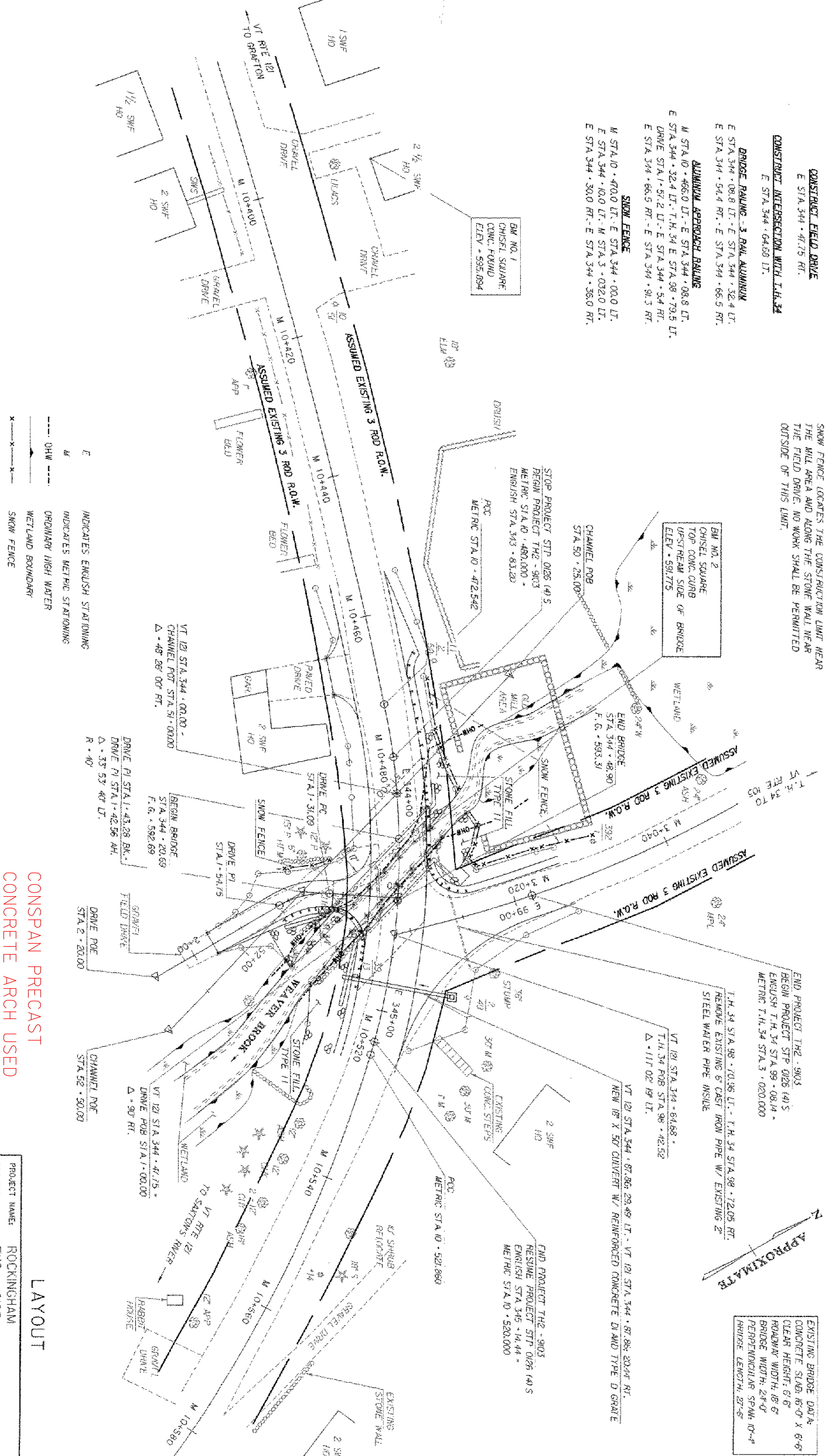

- E INDICATES ENGLISH STATIONING
- M INDICATES METRIC STATIONING
- OHW — ORDINARY HIGH WATER
- WETLAND BOUNDARY
- SNOW FENCE

SCALE: 1" = 20'-0"

CONSPAN PRECAST
 CONCRETE ARCH USED
 VALUE ENGINEERING
 SEE PAGES 040 TO 088.

LAYOUT

PROJECT NAME:	ROCKINGHAM
PROJECT NUMBER:	TH2 - 9103
FILE NAME:	900053\struc\ur\es\val\03\th2
PROJECT MANAGER:	R. R. WHITCOMB
DESIGNED BY:	G. ROY
PLOT DATE:	19-AUG-2003
DRAWN BY:	G. ROY
CHECKED BY:	R. WHITCOMB
SHEET	7 OF 38