

SEE SHEET 2 FOR INDEX OF SHEETS.

STATE OF VERMONT AGENCY OF TRANSPORTATION

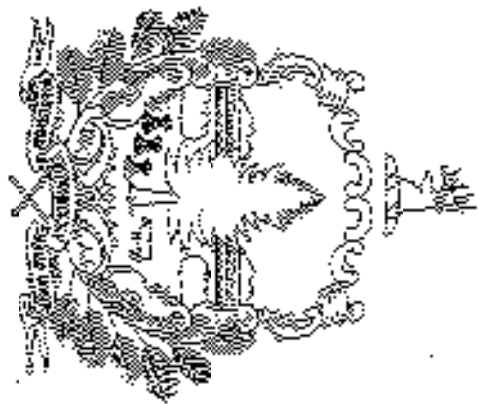

PROPOSED IMPROVEMENT BRIDGE PROJECT

TOWN OF ROCK INGHAM
COUNTY OF WINDHAM

ROUTE NO: VT 121; (T.H. 1 Class 2) BRIDGE NO: 7

PROJECT LOCATION : BEGIN 0.06 MILE EASTERLY FROM ROCK INGHAM - GRAFTON TOWN LINE
ALONG VT 121 AND EXTEND 0.025 MILE SOUTHEASTERLY ALONG VT121.
PROJECT DESCRIPTION : REPLACEMENT OF EXISTING BRIDGE WITH A NEW STRUCTURE,
INCLUDING ASSOCIATED CHANNEL AND APPROACH WORK.

LENGTH OF STRUCTURE : 28.21 FEET
LENGTH OF ROADWAY : 103.03 FEET
LENGTH OF PROJECT : 131.24 FEET

CONSPAN PRECAST
CONCRETE ARCH USED
VALUE ENGINEERING
SEE PAGES 040 TO 088.

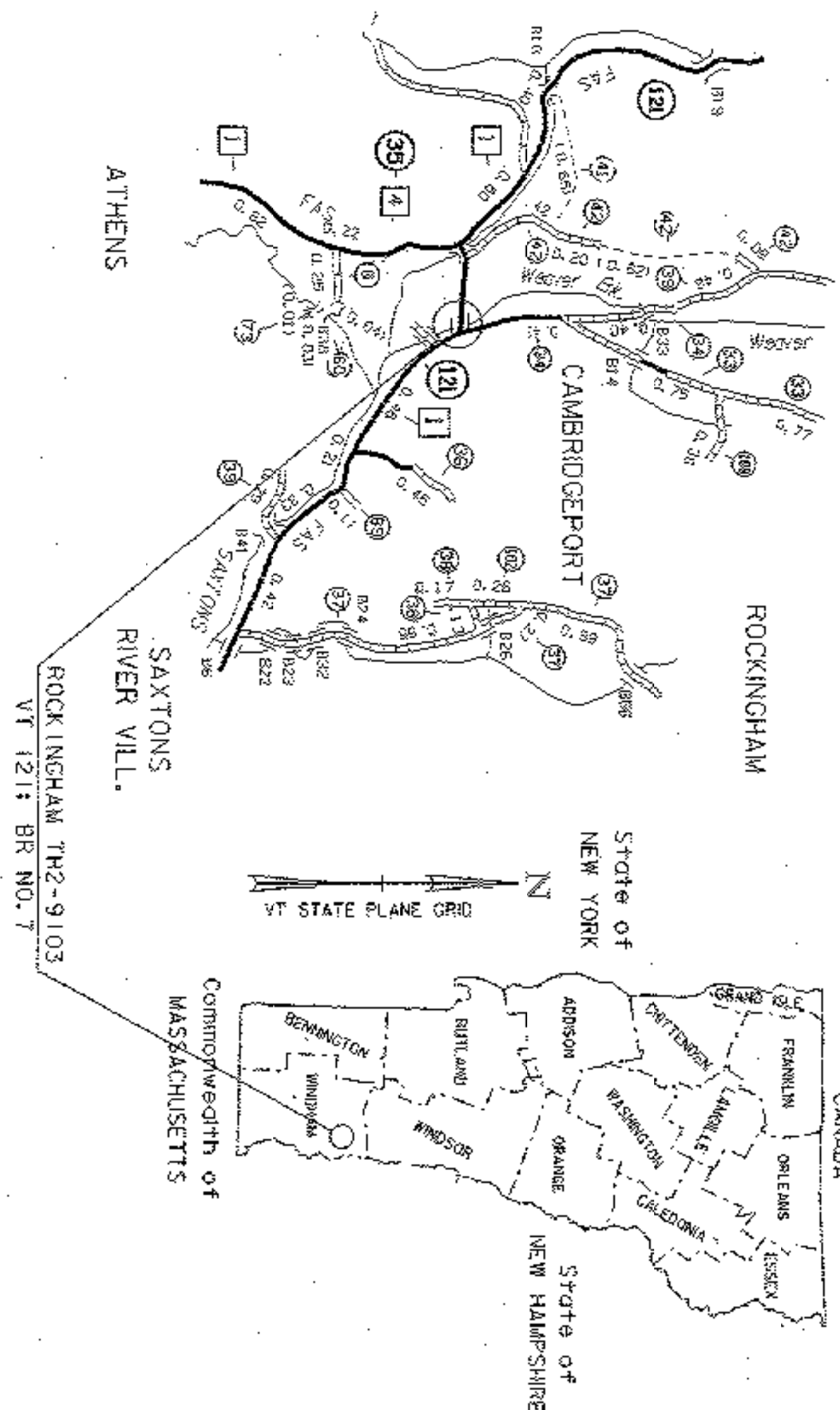

CONVENTIONAL SYMBOLS

| | |
|--------------------|--|
| COUNTY LINE | |
| TOWN LINE | |
| LIMITS OF ACCESS | |
| POINT OF ACCESS | |
| FENCE LINE | |
| STONE WALL | |
| TRAVELED WAY | |
| GUARD RAIL | |
| RAILROAD | |
| SURVEY LINE | |
| CULVERT | |
| TELEPHONE POLE | |
| POWERS POLE | |
| TREES | |
| CONTROL OF ACCESS | |
| PROPERTY LINE | |
| R.O.W. TAKING LINE | |
| SLOPE RIGHTS | |
| TOP OF CUT | |
| TOE OF SLOPE | |

SURVEYED BY : R. MOREAU
SURVEYED DATE : 7/1991

DATUM
VERTICAL NGVD 1929
HORIZONTAL ASSUMED

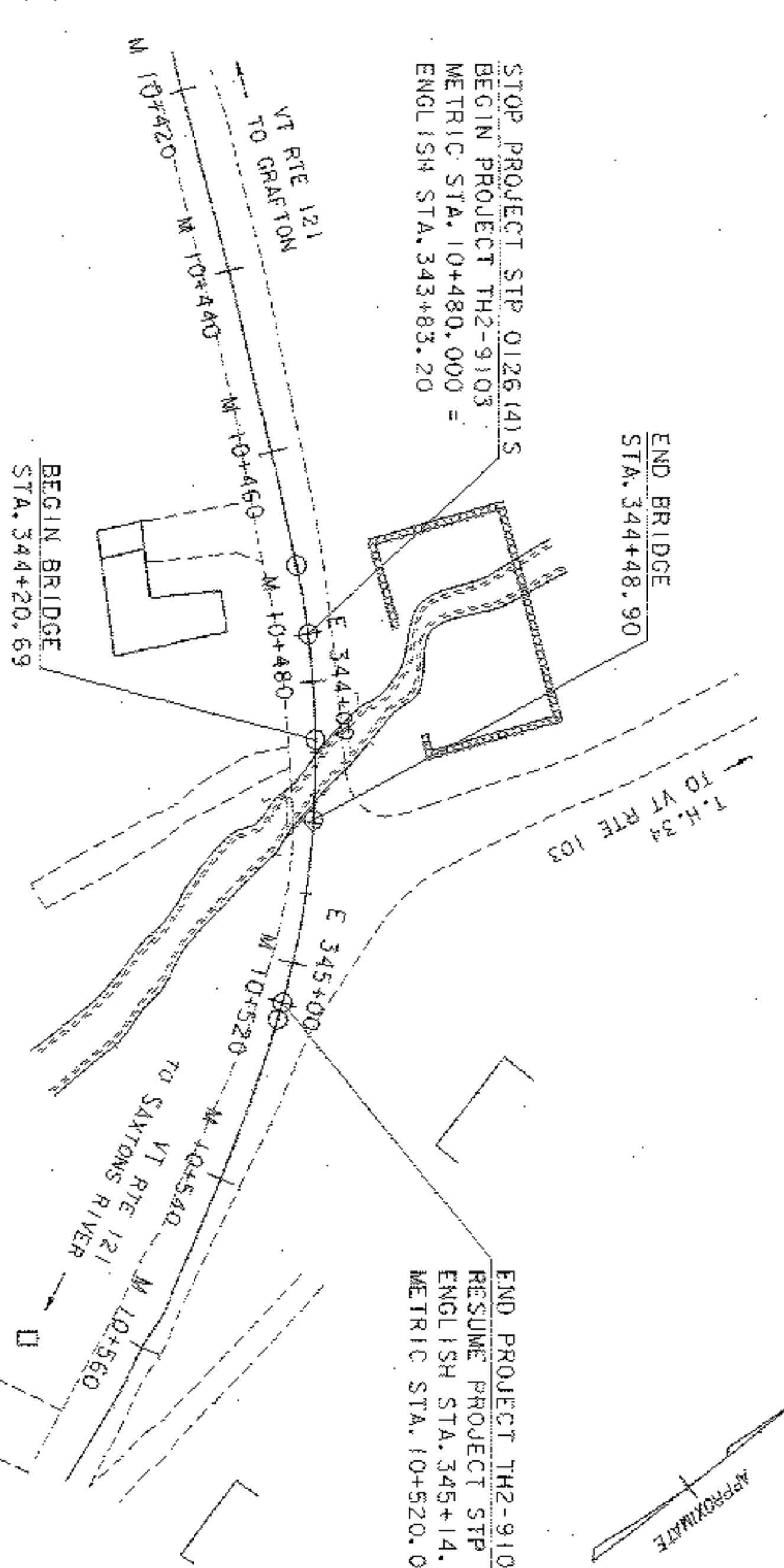

SCALE: 1" = 40'-0"

END PROJECT TH2-9103
RESUME PROJECT STP 0126 (4) S
ENGLISH STA. 345+14.44 =
METRIC STA. 10+520.000

STATE OF VERMONT
AGENCY OF TRANSPORTATION
FINAL PLANS
3.21.03

THESE PLANS ARE SUBJECT TO SUCH ENGINEERING CHANGES AS MAY BE REQUIRED BY THE FEDERAL HIGHWAY ADMINISTRATION OR THE DIRECTOR OF PROGRAM DEVELOPMENT.
CONSTRUCTION IS TO BE CARRIED ON IN ACCORDANCE WITH THESE PLANS AND THE STANDARD SPECIFICATIONS FOR CONSTRUCTION, DATED 2001, AS APPROVED BY THE FEDERAL HIGHWAY ADMINISTRATION ON JANUARY 4, 2001 FOR USE ON THIS PROJECT, INCLUDING ALL SUBSEQUENT REVISIONS AND SUCH REVISED SPECIFICATIONS AND SPECIAL PROVISIONS AS ARE INCORPORATED IN THESE PLANS.

| | |
|----------------------------------|-------------|
| DIRECTOR OF PROGRAM DEVELOPMENT | DATE: _____ |
| APPROVED | |
| PROJECT MANAGER : R. R. WHITCOMB | |
| PROJECT NAME : ROCK INGHAM | |
| PROJECT NUMBER : TH2 - 9103 | |
| SHEET 1 OF 38 SHEETS | |