

REMOVAL & DISPOSAL OF GUARDRAIL
 3+44 RT (RAMP 'M') - SL 36+64 RT
 STEEL BEAM GUARDRAIL
 3+44 RT (RAMP 'M') - SL 39+19 RT
 MODIFIED ECCENTRIC LOADER TERMINAL (MELT)
 SL 39+19 RT - SL 39+56.5 RT
 COLD PLANING - BIT. PAVEMENT
 31+50 (RAMP 'O') - SL 34+00
 REMOVING AND RESETTING CURB
 0+50 RT (RAMP 'N') - SL 33+53 LT
 31+50 LT - 32+39 LT (RAMP 'O')
 0+00 - 0+50 LT (RAMP 'N')
 31+50 - 32+26.5 (RAMP 'O' MEDIAN ISLAND)
 31+50 RT - 31+56 RT (RAMP 'O' ISLAND)
 BITUMINOUS CONCRETE GUTTERS & TRAFFIC ISLANDS
 31+50 - 32+26 (RAMP 'O' MEDIAN TRAFFIC ISLANDS)
 SILT FENCE *-*-*-*-*
 3+44 - 3+78 RT RAMP 'M'

NOTE:
 IF RESIDENT ENGINEER DECIDES THERE IS INSUFFICIENT
 SHOULDER WIDTH FOR STEEL BEAM GUARDRAIL FROM STA.
 31+50 RT ~ 39+25 RT, 8' POSTS WILL BE USED IN THE
 NEW GUARDRAIL INSTALLATION.

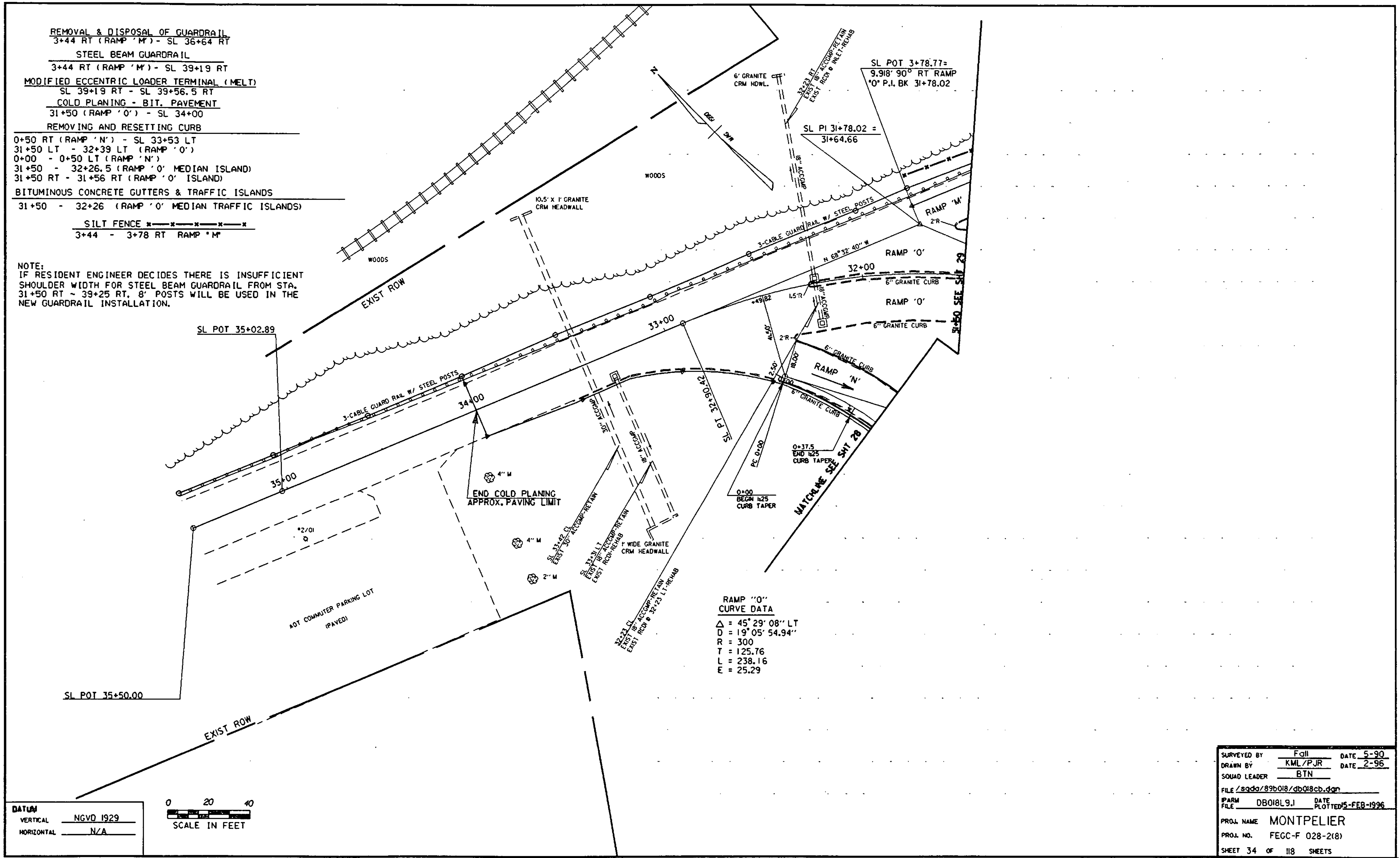

RAMP 'O' CURVE DATA
 $\Delta = 45^\circ 29' 08''$ LT
 $D = 19^\circ 05' 54.94''$
 $R = 300$
 $T = 125.76$
 $L = 238.16$
 $E = 25.29$

DATUM
 VERTICAL NGVD 1929
 HORIZONTAL N/A

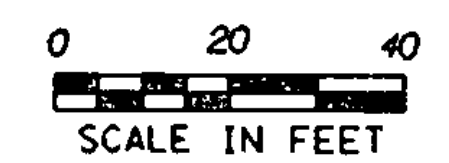

SURVEYED BY	Fall	DATE	5-90
DRAWN BY	KML/PJR	DATE	2-96
SQUAD LEADER	BTN		
FILE	/sqda/89b018/db018cb.dgn		
PARM	DB018L9.J	DATE	5-FEB-1996
FILE		PLOTTED	
PROJ. NAME	MONTPELIER		
PROJ. NO.	FEGC-F 028-2(8)		
SHEET	34	OF	118 SHEETS

Sheet Number: 34