

- STEEL BEAM GUARDRAIL
6+75 RT - 30+75 RT
19+50 LT (RAMP 'M' RT) - 35+50 LT
- REMOVE EXISTING GUARDRAIL
25+00 RT - 26+00 RT
28+20 LT - 30+50 LT
- COLD PLANING-BIT PAVEMENT
0+00 - 47+50
- CONSTRUCT SPECIAL DITCH W/STONE FILL TYPE II
25+00 RT - 30+50 RT
- CONSTRUCT SPECIAL DITCH W/EROSION MATTING
27+31 LT - 36+50 LT

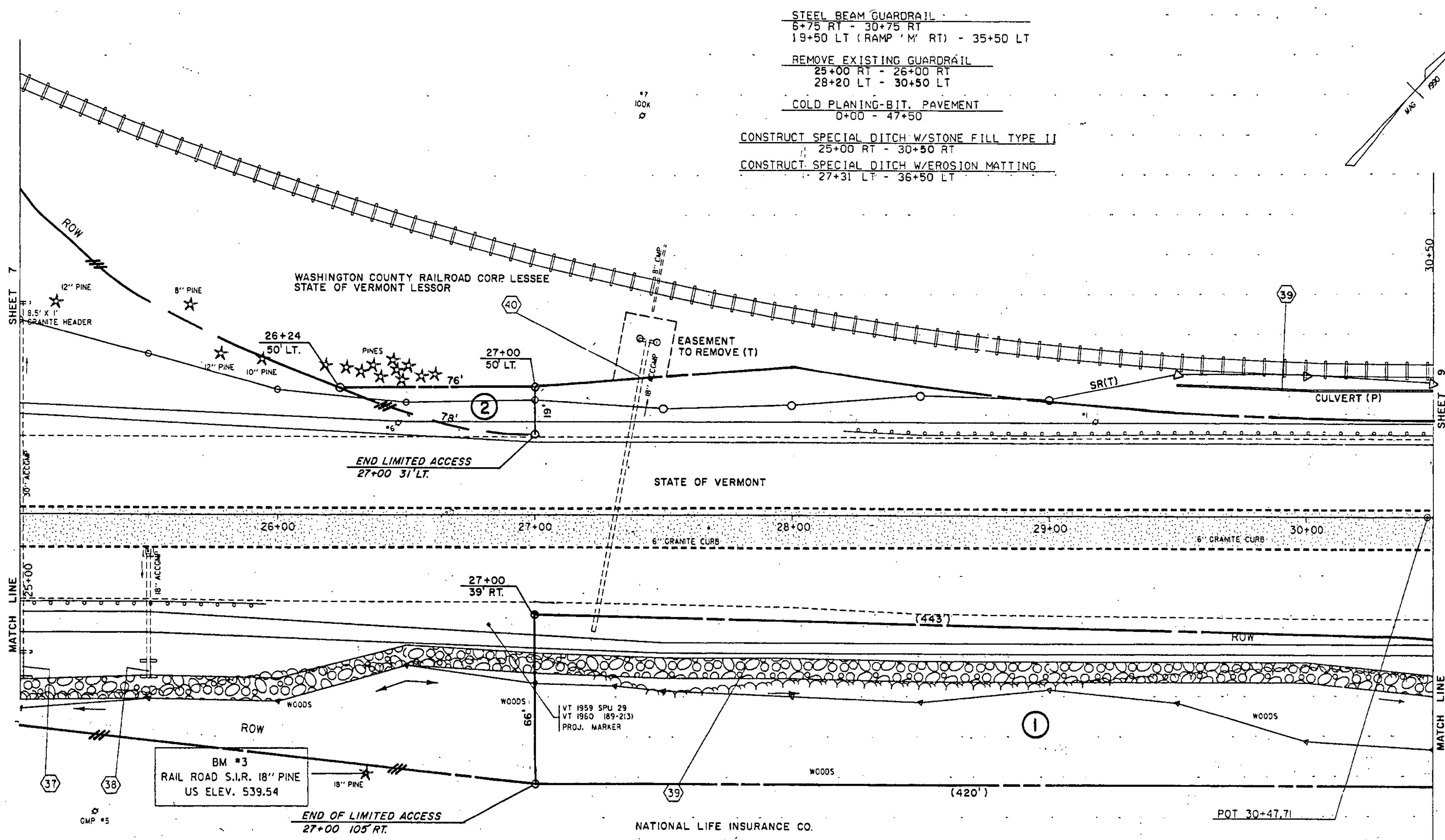

- DRAINAGE NOTES
- (37) 25+00 RT NEW 30' X 10' CSP (.079), REMOVE EXIST. HEADWALL, CONSTRUCT NEW HEADWALL.
 - (38) 25+50 RT NEW 18' X 6' CSP (.064), REMOVE EXIST. HEADWALL, CONSTRUCT NEW HEADWALL.
 - (39) 29+50 LT NEW 6" X 350' UNDERDRAIN W/ FB AT 29+50 LT.
 - (40) 27+31 CL ABANDON 18" PIPE, PLUG ENDS, REMOVE EXISTING HEADWALL.

DATUM
VERTICAL NGVD 1929
HORIZONTAL N/A



THIS SHEET FOR R.O.V. USE ONLY

03-10-95	REVISION 2
05-26-93	REVISION 1
SURVEYED BY	Fall DATE 5-90
DRAWN BY	Squade-jfg DATE 6-90
SQUAD LEADER	D.F.Hole
FILE	usr/zfa2/055050.dir/89b018
IPARM	89B018L5.1 DATE PLOTTED 30-DEC-1992
PROJ. NAME	MONTPELIER
PROJ. NO.	FEGC-F 028-2(8)S
SHEET	8 OF 15 SHEETS