

SEE SHEET 2 FOR INDEX OF SHEETS
AND LIST OF STANDARDS

STATE OF VERMONT AGENCY OF TRANSPORTATION

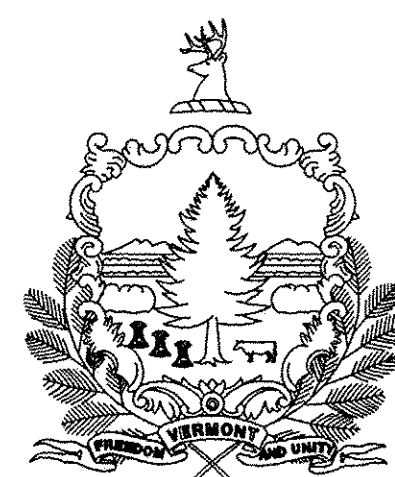

PROPOSED IMPROVEMENT BRIDGE PROJECT

TOWN OF CHESTER
COUNTY OF WINDSOR

ROUTE NO : VT 11 MINOR ARTERIAL BRIDGE NO : 43

PROJECT LOCATION : BEGINNING APPROXIMATELY 1300 FEET EAST OF THE ANDOVER-CHESTER TOWN LINE AND PROCEEDING IN AN EASTERLY DIRECTION FOR 250 FEET.

PROJECT DESCRIPTION : REPLACEMENT OF EXISTING BRIDGE ALONG WITH NECESSARY APPROACH WORK

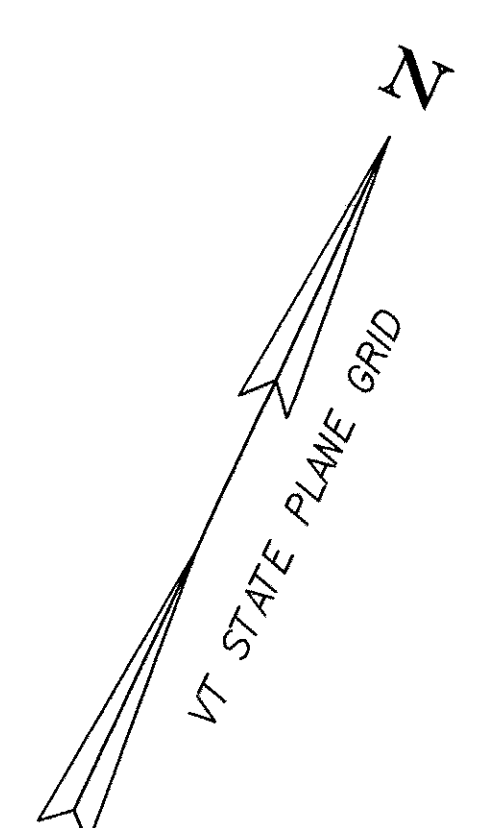
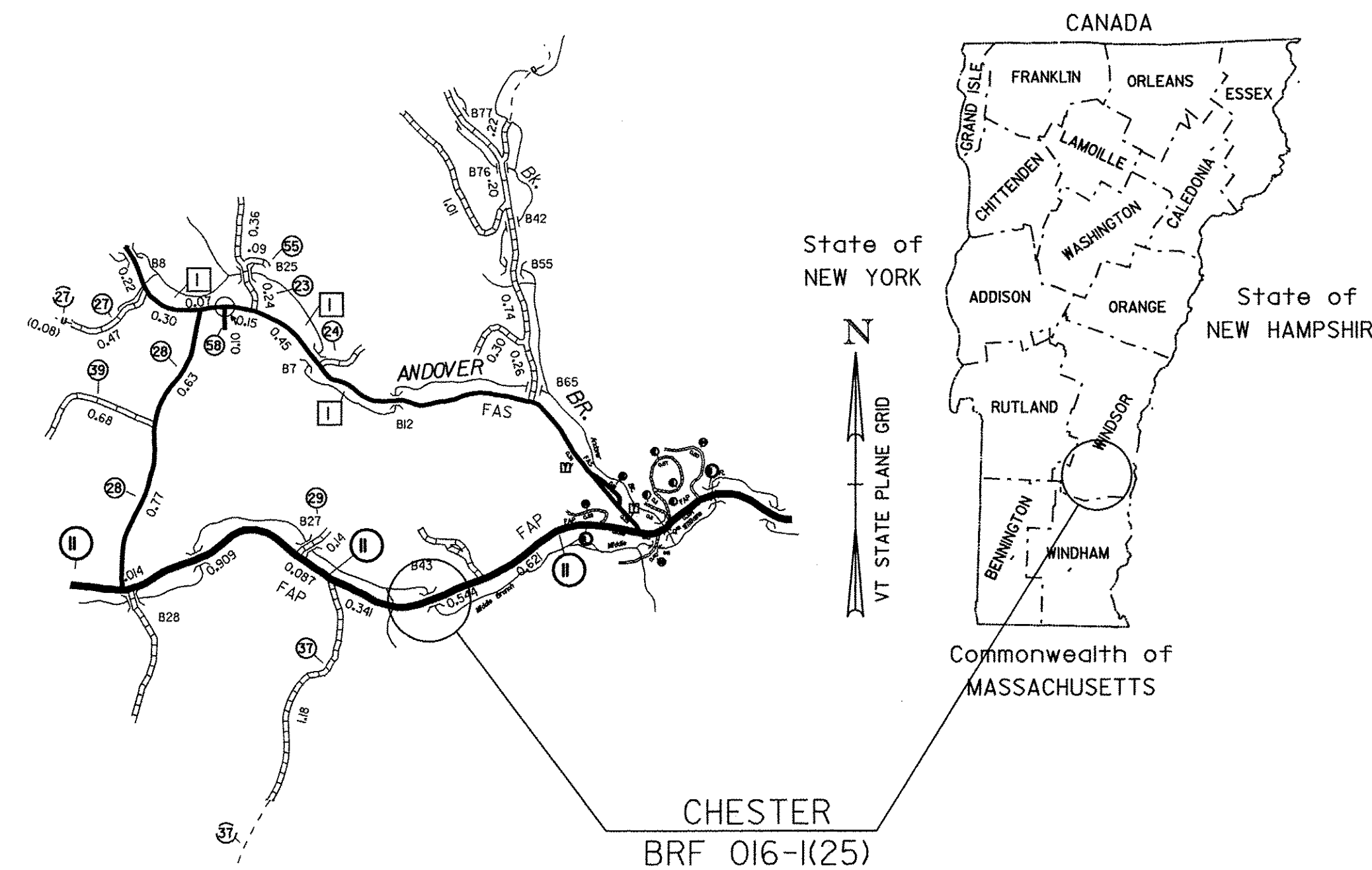

LENGTH OF STRUCTURE : 106 FEET.
LENGTH OF ROADWAY : 144 FEET.
LENGTH OF PROJECT : 250 FEET.

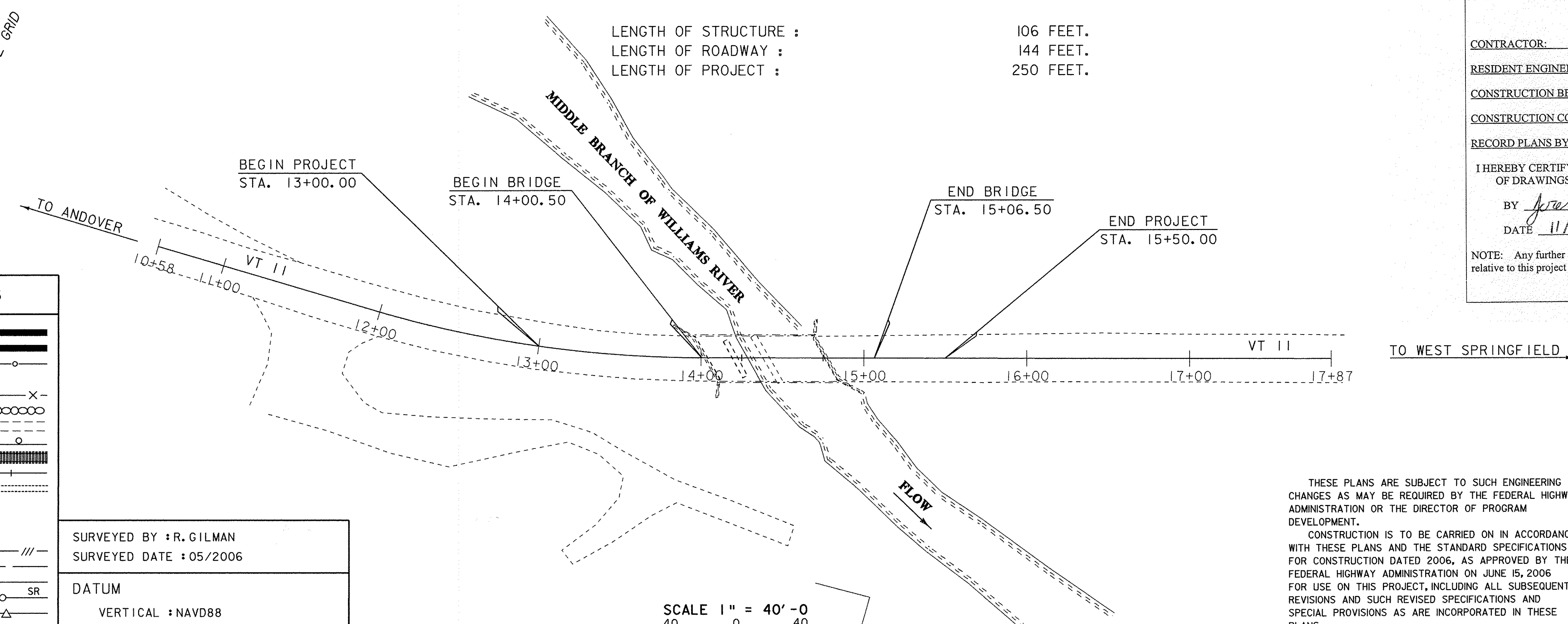

| RECORD PLANS | |
|--|---|
| CONTRACTOR: | MILLER CONSTRUCTION, INC. - WINDSOR, VT |
| RESIDENT ENGINEER: | JEREMY REED |
| CONSTRUCTION BEGAN: | SEPTEMBER 29, 2008 |
| CONSTRUCTION COMPLETE: | DECEMBER 16, 2009 |
| RECORD PLANS BY: | JEREMY REED & AMOS KEMPTON |
| I HEREBY CERTIFY THAT ALL THE CONSTRUCTION REQUIRED BY THIS SET OF DRAWINGS HAS BEEN ACCOMPLISHED AS INDICATED HEREIN. | |
| BY <i>Jeremy Reed</i> | RESIDENT ENGINEER |
| DATE 11/3/11 | |
| NOTE: Any further information concerning final quantities, amounts or other details relative to this project may be found at Central Files in the electronic archives. | |

| CONVENTIONAL SYMBOLS | |
|----------------------|--|
| COUNTY LINE | |
| TOWN LINE | |
| LIMITS OF ACCESS | |
| POINT OF ACCESS | |
| FENCE LINE | |
| STONE WALL | |
| TRAVELED WAY | |
| GUARD RAIL | |
| RAILROAD | |
| SURVEY LINE | |
| CULVERT | |
| POWER POLE | |
| TELEPHONE POLE | |
| TREES | |
| CONTROL OF ACCESS | |
| PROPERTY LINE | |
| R.O.W. TAKING LINE | |
| SLOPE RIGHTS | |
| TOP OF CUT | |
| TOE OF SLOPE | |

SURVEYED BY : R. GILMAN
SURVEYED DATE : 05/2006

DATUM
VERTICAL : NAVD88
HORIZONTAL : NAD 83 (96)

SCALE 1" = 40'-0"
40 0 40

THESE PLANS ARE SUBJECT TO SUCH ENGINEERING CHANGES AS MAY BE REQUIRED BY THE FEDERAL HIGHWAY ADMINISTRATION OR THE DIRECTOR OF PROGRAM DEVELOPMENT.

CONSTRUCTION IS TO BE CARRIED ON IN ACCORDANCE WITH THESE PLANS AND THE STANDARD SPECIFICATIONS FOR CONSTRUCTION DATED 2006, AS APPROVED BY THE FEDERAL HIGHWAY ADMINISTRATION ON JUNE 15, 2006 FOR USE ON THIS PROJECT, INCLUDING ALL SUBSEQUENT REVISIONS AND SUCH REVISED SPECIFICATIONS AND SPECIAL PROVISIONS AS ARE INCORPORATED IN THESE PLANS.

PLOTTED 21-FEB-2008

| | |
|-----------------------------------|----------------|
| DIRECTOR OF PROGRAM DEVELOPMENT | |
| APPROVED <i>Robin Fitzmaurice</i> | DATE 2-22-08 |
| PROJECT MANAGER : C.P. WILLIAMS | |
| PROJECT NAME : | CHESTER |
| PROJECT NUMBER : | BRF 016-1 (25) |
| SHEET 1 OF 1 SHEETS | |