

CROSSFRAME MK.CF3

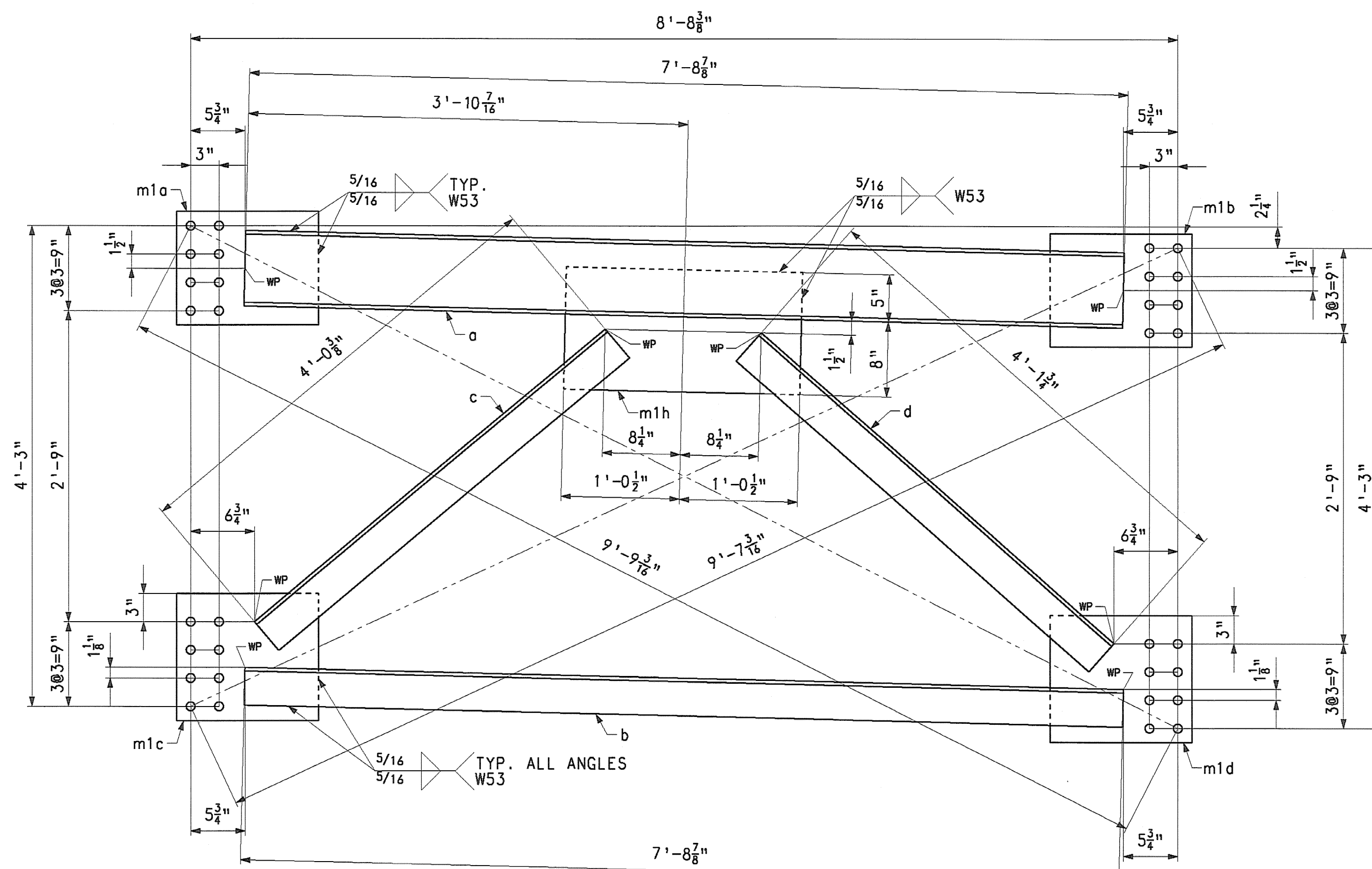

CROSSFRAME MK.CF4

BILL OF MATERIAL

SHIP	QTY EA.	MARK	COMM	DESCRIPTION	LENGTH	SPEC	GRADE	TEST	REMARKS	GRP	ITEM	GROSS WEIGHT EA.	DEDUCTED WEIGHT EA.	NET WEIGHT EA.	
I	3	CF3		CROSSFRAMES								454.37		454.37	
	3	a	C	8 x 18.75	7	8	7/8	M270	50W	T	11	1	145.12		145.12
	3	b	L	4 x 4 x 3/8	7	8	7/8	M270	50W	T	11	2	75.23		75.23
	3	c	L	4 x 4 x 3/8	4	1	3/4	M270	50W	T	11	2	40.30		40.30
	3	d	L	4 x 4 x 3/8	4	0	3/8	M270	50W	T	11	2	39.18		39.18
	3	m1a	PL	1/2 x 12	1	3		M270	50W	T	11	3	25.52		25.52
	3	m1b	PL	1/2 x 12	1	3		M270	50W	T	11	3	25.52		25.52
	3	m1c	PL	1/2 x 13 1/2	1	3		M270	50W	T	11	3	28.71		28.71
	3	m1d	PL	1/2 x 13 1/2	1	3		M270	50W	T	11	3	28.71		28.71
	3	m1h	PL	1/2 x 13	2	1		M270	50W	T	11	3	46.08		46.08
I	5	CF4		CROSSFRAMES								454.37		454.37	
	5	a	C	8 x 18.75	7	8	7/8	M270	50W	T	11	1	145.12		145.12
	5	b	L	4 x 4 x 3/8	7	8	7/8	M270	50W	T	11	2	75.23		75.23
	5	c	L	4 x 4 x 3/8	4	0	3/8	M270	50W	T	11	2	39.18		39.18
	5	d	L	4 x 4 x 3/8	4	1	3/4	M270	50W	T	11	2	40.30		40.30
	5	m1a	PL	1/2 x 12	1	3		M270	50W	T	11	3	25.52		25.52
	5	m1b	PL	1/2 x 12	1	3		M270	50W	T	11	3	25.52		25.52
	5	m1c	PL	1/2 x 13 1/2	1	3		M270	50W	T	11	3	28.71		28.71
	5	m1d	PL	1/2 x 13 1/2	1	3		M270	50W	T	11	3	28.71		28.71
	5	m1h	PL	1/2 x 13	2	1		M270	50W	T	11	3	46.08		46.08

TOTAL WEIGHT THIS SHEET: 3634.96 lbs.

RECEIVED
 OK'D BY RL OK'D BY _____
 JAN 30 2007
 RESUBMIT _____ APPROVED RL
 BY WY DATE 1-31-2007

NO.	REVISION	BY	DATE
 HIGH STEEL STRUCTURES, INC. 1770 Hempstead Road Lancaster, PA 17605-0008 Phone 717-299-9211 A Division of High Industries, Inc.			
CROSSFRAMES CF3 & CF4 VT. 12 (MAIN ST.) OVER THIRD BRANCH OF THE WHITE RIVER VT. 12 STA. 15+36.00 TO STA. 17+36.00 TOWN OF RANDOLPH, ORANGE COUNTY, VT. BRIDGE NO. 42 STATE OF VERMONT AGENCY OF TRANSPORTATION			
STATE CONTRACT OR REF. NO.	PROJECT NO. RANDOLPH BR 0241 (29)		
CONTRACTOR	WINTERSET, INC.		
IN CHARGE	BRITIGAN (IH)	MADE BY	RC CH'D. BY CS DATE: 11/8/06
CONTRACT NUMBER	VT-06215-1		DRAWING NUMBER: 2 OF 14

NOTES:
 HOLES: 15/16" Ø
 BOLTS: NONE
 PAINT: NONE
 FOR GENERAL SHOP NOTES, SEE DWG. GN1.

CODE: 63