

### BILL OF MATERIAL

| SHIP | QTY EA. | MARK | COMM | DESCRIPTION  | LENGTH | SPEC    | GRADE | TEST | REMARKS | GRP | ITEM | GROSS WEIGHT EA. | DEDUCTED WEIGHT EA. | NET WEIGHT EA. |
|------|---------|------|------|--------------|--------|---------|-------|------|---------|-----|------|------------------|---------------------|----------------|
| 1    | 2       | CF1  |      | CROSSFRAME   |        |         |       |      |         |     |      | 454.52           |                     | 454.52         |
|      | 2       | a    | C    | 8 x 18.75    | 7      | 8 15/16 | M270  | 50W  | T       | 11  | 1    | 145.21           |                     | 145.21         |
|      | 2       | b    | L    | 4 x 4 x 3/8  | 7      | 8 15/16 | M270  | 50W  | T       | 11  | 2    | 75.28            |                     | 75.28          |
|      | 2       | c    | L    | 4 x 4 x 3/8  | 4      | 1 15/16 | M270  | 50W  | T       | 11  | 2    | 40.45            |                     | 40.45          |
|      | 2       | d    | L    | 4 x 4 x 3/8  | 4      | 0 3/16  | M270  | 50W  | T       | 11  | 2    | 39.03            |                     | 39.03          |
|      | 2       | m1a  | PL   | 1/2 x 12     | 1      | 3       | M270  | 50W  | T       | 11  | 3    | 25.52            |                     | 25.52          |
|      | 2       | m1b  | PL   | 1/2 x 12     | 1      | 3       | M270  | 50W  | T       | 11  | 3    | 25.52            |                     | 25.52          |
|      | 2       | m1c  | PL   | 1/2 x 13 1/2 | 1      | 3       | M270  | 50W  | T       | 11  | 3    | 28.71            |                     | 28.71          |
|      | 2       | m1d  | PL   | 1/2 x 13 1/2 | 1      | 3       | M270  | 50W  | T       | 11  | 3    | 28.71            |                     | 28.71          |
|      | 2       | m1h  | PL   | 1/2 x 13     | 2      | 1       | M270  | 50W  | T       | 11  | 3    | 46.08            |                     | 46.08          |
| 1    | 1       | CF2  |      | CROSSFRAME   |        |         |       |      |         |     |      | 454.57           |                     | 454.57         |
|      | 1       | a    | C    | 8 x 18.75    | 7      | 8 15/16 | M270  | 50W  | T       | 11  | 1    | 145.21           |                     | 145.21         |
|      | 1       | b    | L    | 4 x 4 x 3/8  | 7      | 8 15/16 | M270  | 50W  | T       | 11  | 2    | 75.28            |                     | 75.28          |
|      | 1       | c    | L    | 4 x 4 x 3/8  | 4      | 1 7/8   | M270  | 50W  | T       | 11  | 2    | 40.40            |                     | 40.40          |
|      | 1       | d    | L    | 4 x 4 x 3/8  | 4      | 0 5/16  | M270  | 50W  | T       | 11  | 2    | 39.13            |                     | 39.13          |
|      | 1       | m1a  | PL   | 1/2 x 12     | 1      | 3       | M270  | 50W  | T       | 11  | 3    | 25.52            |                     | 25.52          |
|      | 1       | m1b  | PL   | 1/2 x 12     | 1      | 3       | M270  | 50W  | T       | 11  | 3    | 25.52            |                     | 25.52          |
|      | 1       | m1c  | PL   | 1/2 x 13 1/2 | 1      | 3       | M270  | 50W  | T       | 11  | 3    | 28.71            |                     | 28.71          |
|      | 1       | m1d  | PL   | 1/2 x 13 1/2 | 1      | 3       | M270  | 50W  | T       | 11  | 3    | 28.71            |                     | 28.71          |
|      | 1       | m1h  | PL   | 1/2 x 13     | 2      | 1       | M270  | 50W  | T       | 11  | 3    | 46.08            |                     | 46.08          |

TOTAL WEIGHT THIS SHEET: 1363.61 lbs.

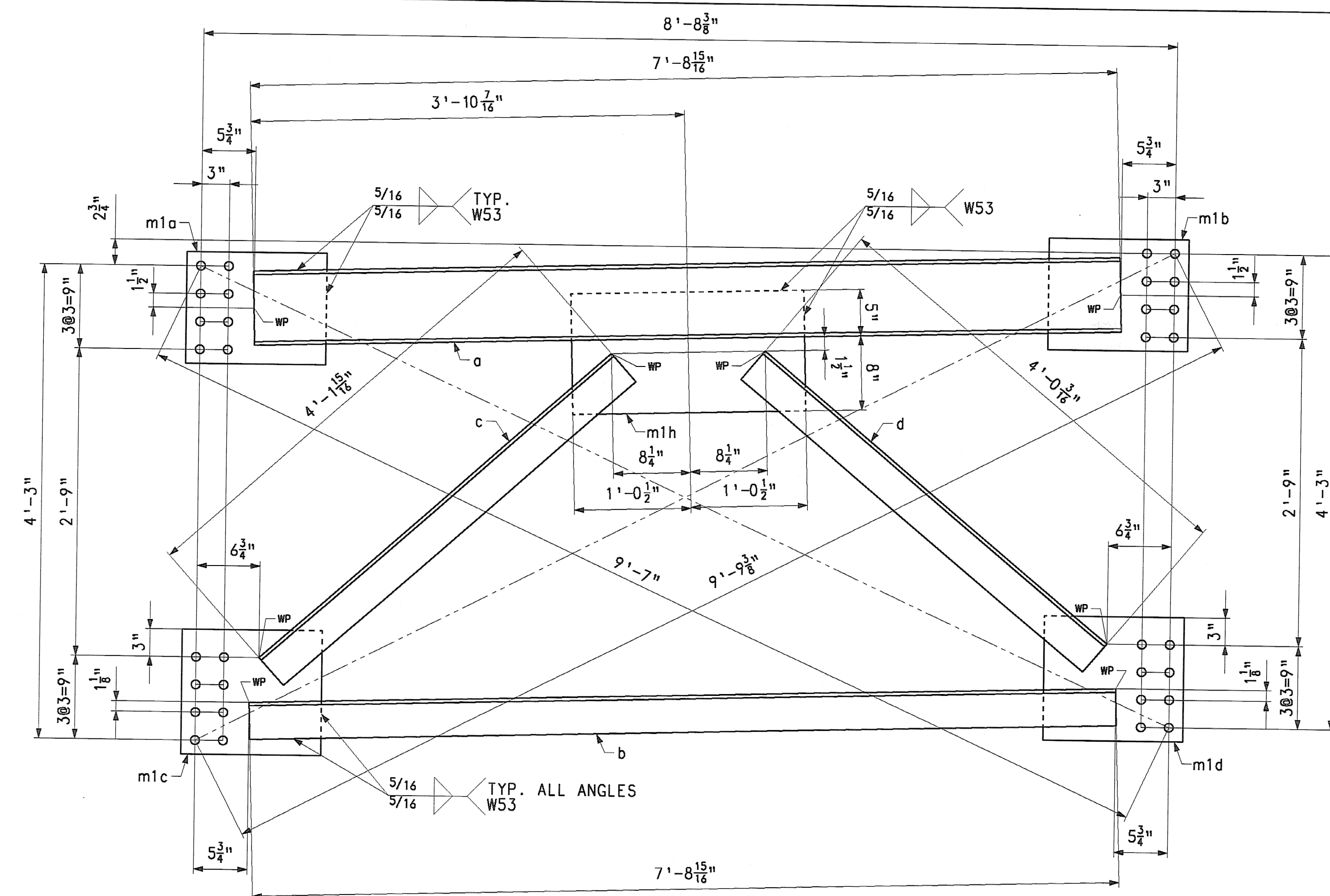

CROSSFRAME MK. CF1

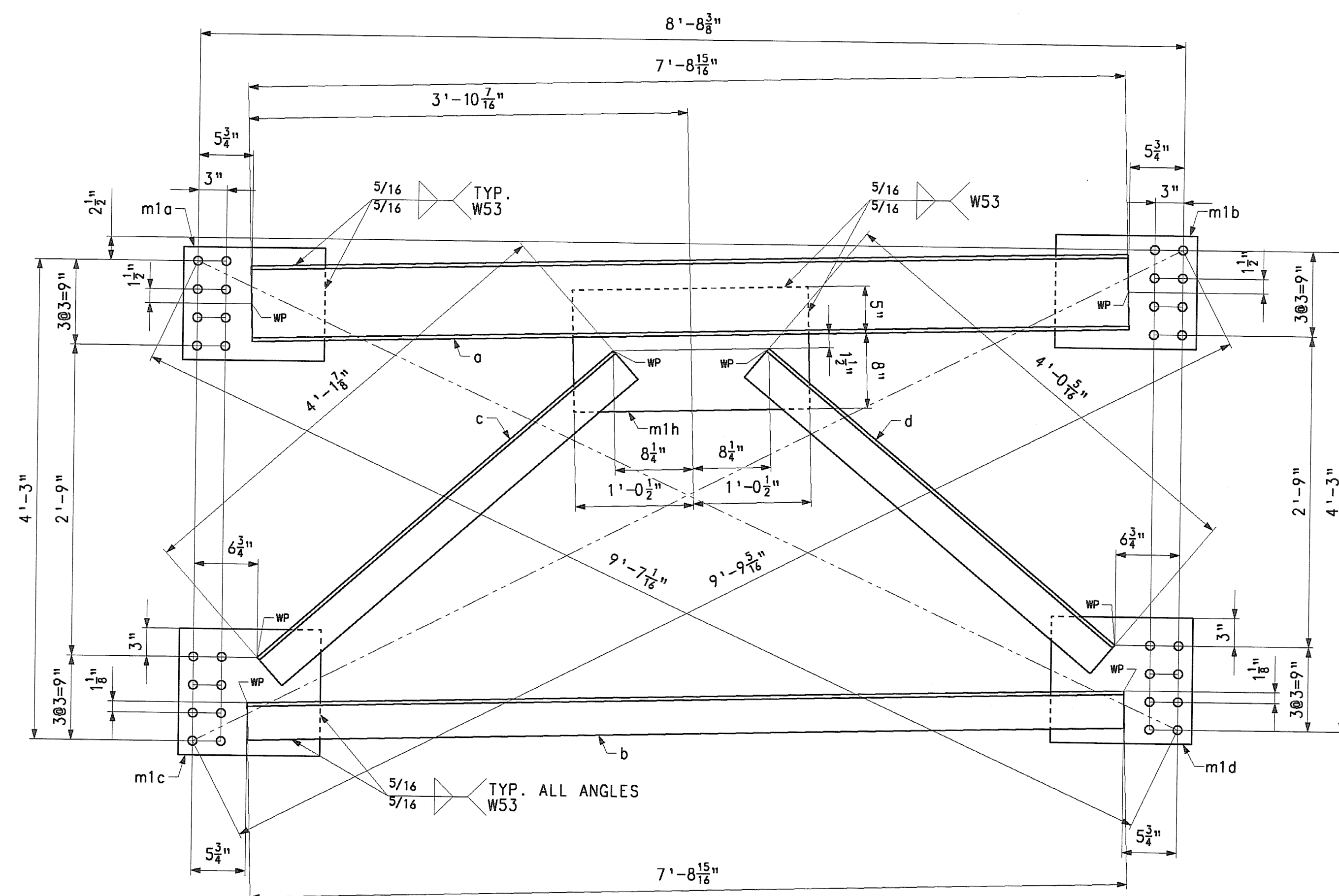

CROSSFRAME MK. CF2

**NOTES:**

- HOLES: 15/16" Ø
- BOLTS: NONE
- PAINT: NONE
- FOR GENERAL SHOP NOTES, SEE DWG. GN1.

RECEIVED  
 OK'D BY: *JKJ* OK'D BY: \_\_\_\_\_  
 JAN 30 2007  
 RESUBMIT: \_\_\_\_\_ APPROVED: *JKJ*  
 BY: *WJS* DATE: 1-31-2007

| NO. | REVISION | BY | DATE |
|-----|----------|----|------|
|     |          |    |      |

HIGH STEEL STRUCTURES, INC.  1770 Hempstead Road  
 Lancaster, PA 17605-0008  
 Phone 717-299-5211  
 A Division of High Industries, Inc.

CROSSFRAMES CF1 & CF2  
 VT. 12 (MAIN ST.) OVER THIRD BRANCH OF THE WHITE RIVER  
 VT. 12 STA. 15+36.00 TO STA. 17+36.00  
 TOWN OF RANDOLPH, ORANGE COUNTY, VT. BRIDGE NO. 42  
 STATE OF VERMONT  
 AGENCY OF TRANSPORTATION

STATE CONTRACT PROJECT NO. RANDOLPH BR 0241 (29)  
 OR REF. NO. \_\_\_\_\_  
 CONTRACTOR: WINTERSET, INC.  
 IN CHARGE: BRITIGAN (IH) MADE BY: RC CHD. CS DATE: 11/8/06  
 CONTRACT NUMBER: VT-06215-1 DRAWING NUMBER: 1 OF 14

CODE: 63