

RANDOLPH BRIDGE

NO WELD ZONE DIMENSIONS	
GIRDER 1	59'-5 3/4"
GIRDER 2	57'-0 7/8"
GIRDER 3	55'-0"
GIRDER 4	53'-11 1/8"
GIRDER 5	52'-6 1/4"

THE "NO WELD ZONE" IS CENTERED ABOUT THE PIER Δ

BILL OF MATERIAL			
MARK	NO. PCS.	LENGTH	DESCRIPTION
7'-10"	406	7'-10"	BRIDGE DECK 3" DEEP 8" PITCH 24" COVER CLOSED ENDS ASTM A653 GRADE 50 GALV. G-165 22 GAGE I=0.795 in ⁴ S=0.441 in ³
A	163	10'-0"	SUPPORT ANGLE 10 GAGE GALV.
B	16	10'-0"	CLOSURE 16 GAGE GALV.
SC-3	8	10'-0"	SHEET CLOSURE 22 GAGE GALV.
CA	150	2"	CLIP ANGLE 12 GAGE GALV.
BS-16	240	16 1/8"	BEAM STRAP 12 GAGE GALV. 2" WIDE FLAT
TEKS	4000	----	TEK SCREWS 1/4" X 1 1/4" X 13/16" CADMIUM PLTD.
V3080	1218	7'-10"	VOID FILLER

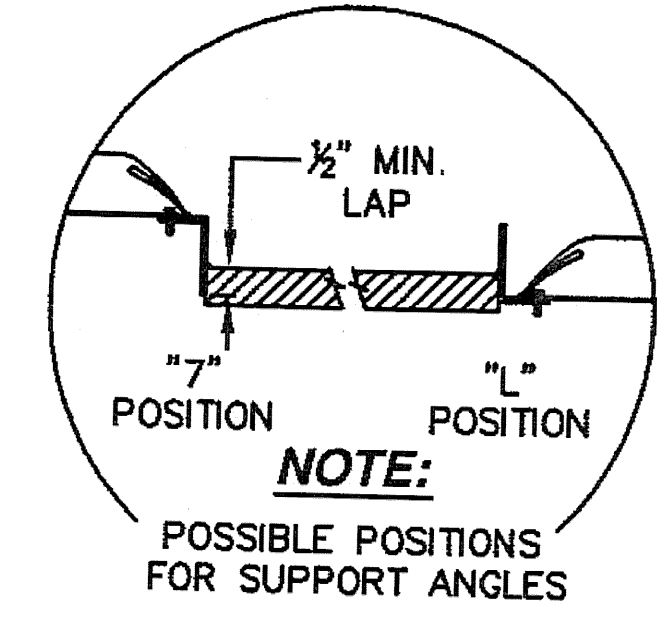
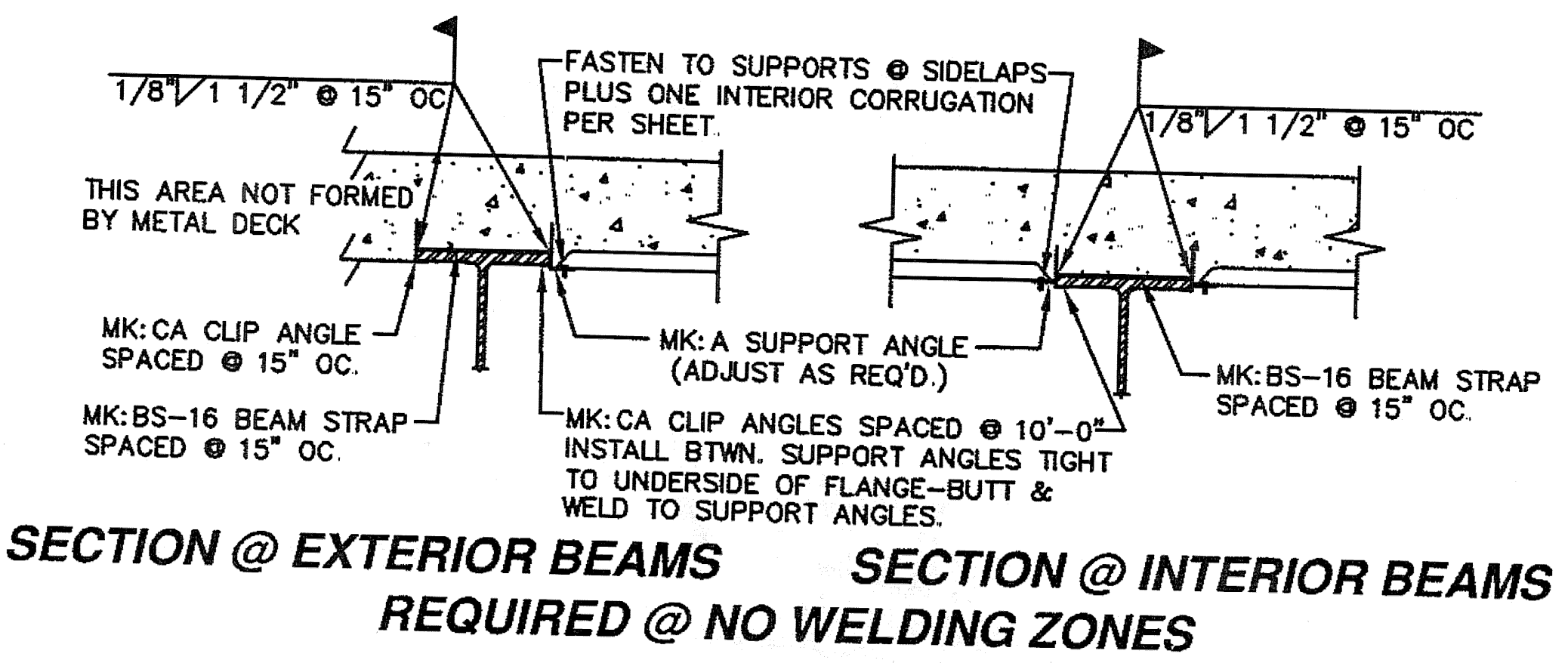
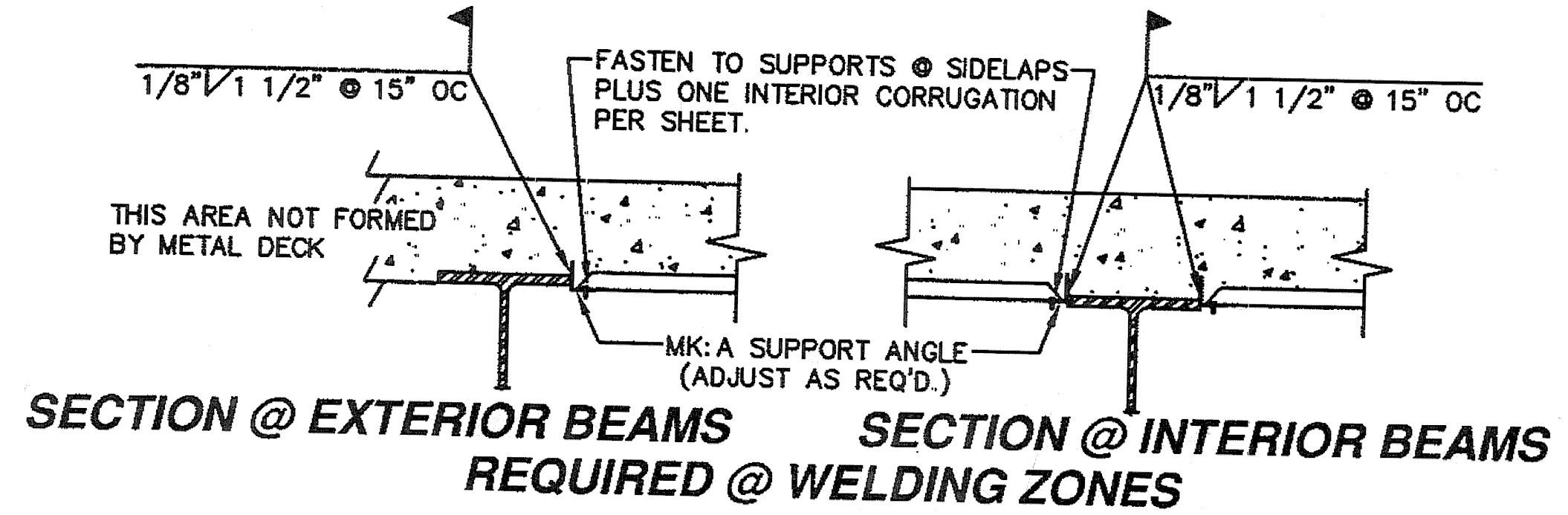
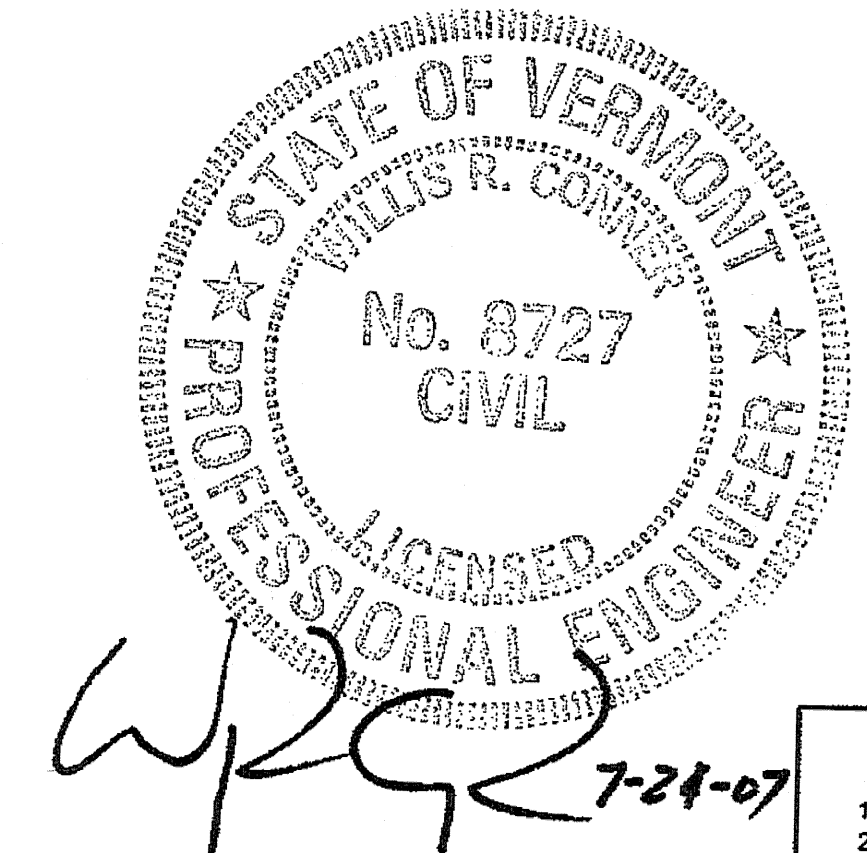
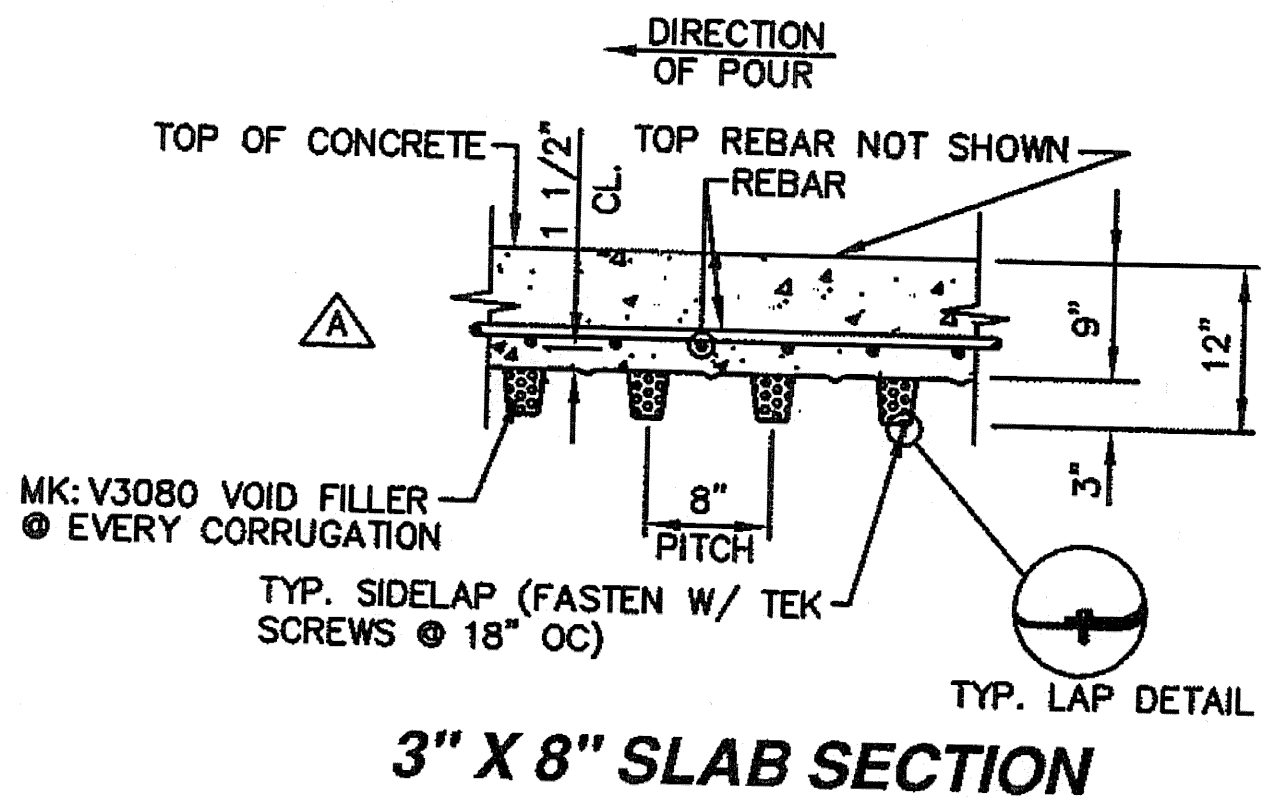
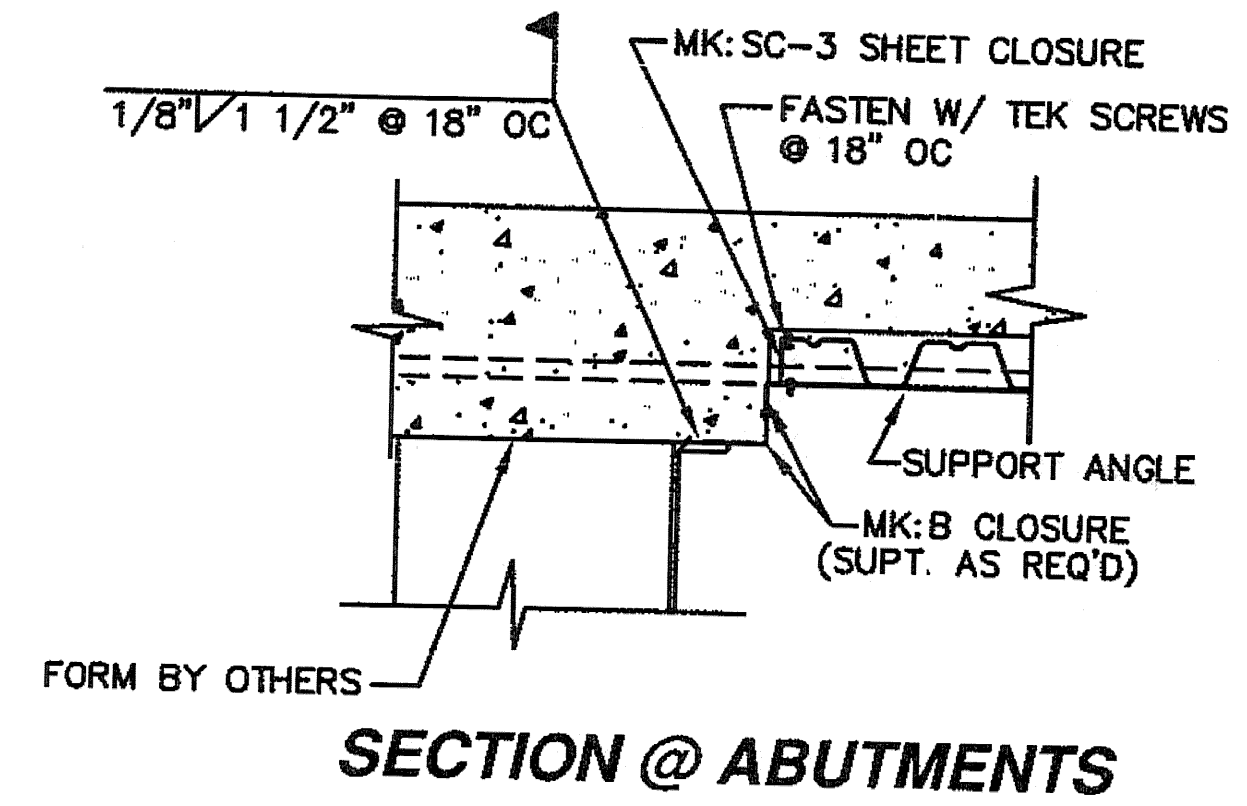

BRIDGE DECK GENERAL NOTES

- Consolidated Systems, Inc. will furnish only that material listed in the Bill of Materials.
- All material for bridge deck form shall conform to ASTM specification A-653 (Grades 40 and 50) having a coating designation of G-165.
- The contractor shall verify all dimensions.
- Extra concrete poured on deck slab as a result of these metal forms shall be provided by the General Contractor and will not be the responsibility of or to the account of Consolidated Systems, Inc.
- ALL DECK SHEETS SHALL HAVE A MINIMUM BEARING OF 1 1/2" AT EACH END OF THE DECK. CENTER FORMS ON SUPPORT ANGLES.
- FOR THE SAFETY OF THE WORKMEN, ALL DECK SHEETS SHALL BE SECURELY FASTENED TO THE SUPPORT ANGLE AS THEY ARE PLACED BEFORE CONSTRUCTION TRAFFIC IS PERMITTED.
- Reinforcing steel and supports for reinforcing steel shall be placed in accordance with applicable drawings and in conformance with good reinforced concrete practice and under the continuous supervision of a properly trained foreman.
- CALCIUM CHLORIDE (OR ANY ADMIXTURE CONTAINING CHLORIDE SALTS) SHALL NOT BE USED IN THE CONCRETE PLACED ON THE BRIDGE DECK.
- When pouring concrete, DO NOT allow overall depth to exceed the design slab depth plus three inches (3") otherwise, pour concrete over supporting beams and girders and spread to proper depth over bridge forms.
- If situations arise that are not specifically covered by these notes or placing plans, or if there is any doubt as to the correct procedure to be followed in erection, please contact Consolidated Systems, Inc. for additional instructions or clarification.
- Vertical adjustment of support angles shall be determined in the field to maintain the correct slab thickness and roadway slope.
- The metal closure shown in sections are intended for closure and alignment only and not intended to support the end of forms cut on a skew. Additional support and forming may be required.
- Attach styrofoam filler to deck pan flutes with adhesive. The adhesive must be for use on expanded polystyrene. Acceptable brands are HB FULLER or LEECH.

REMARKS

BRIDGE DECK LAYOUT, SECTIONS, BILL OF MATERIAL AND GENERAL NOTES
RANDOLPH BRIDGE

CS CONSOLIDATED SYSTEMS INC. MEMPHIS, TN **sdi**

CUSTOMER: WINTERSET, INC.
PROJECT: BRP 0241 (29)
LOCATION: ORANGE COUNTY, VT
ENGINEER: VERMONT DEPARTMENT OF TRANSPORTATION

REVISIONS: A

DATE: 7/07

COMMENTS: STATE MARK-UPS

FILE: H:\VIA_MARKS\2007\STATE\VT\070708

DRAWN: TLM DATE: JUNE 2007
CHECKED: TLM DATE: JUNE 2007

RECEIVED
BY: TMS
DATE: JUL 27 2007
SUBMIT: WJY
DATE: 7/30/07

DRAWING NO.: B0700159 1 of 1