

PROJECT DESCRIPTION AND LOCATION

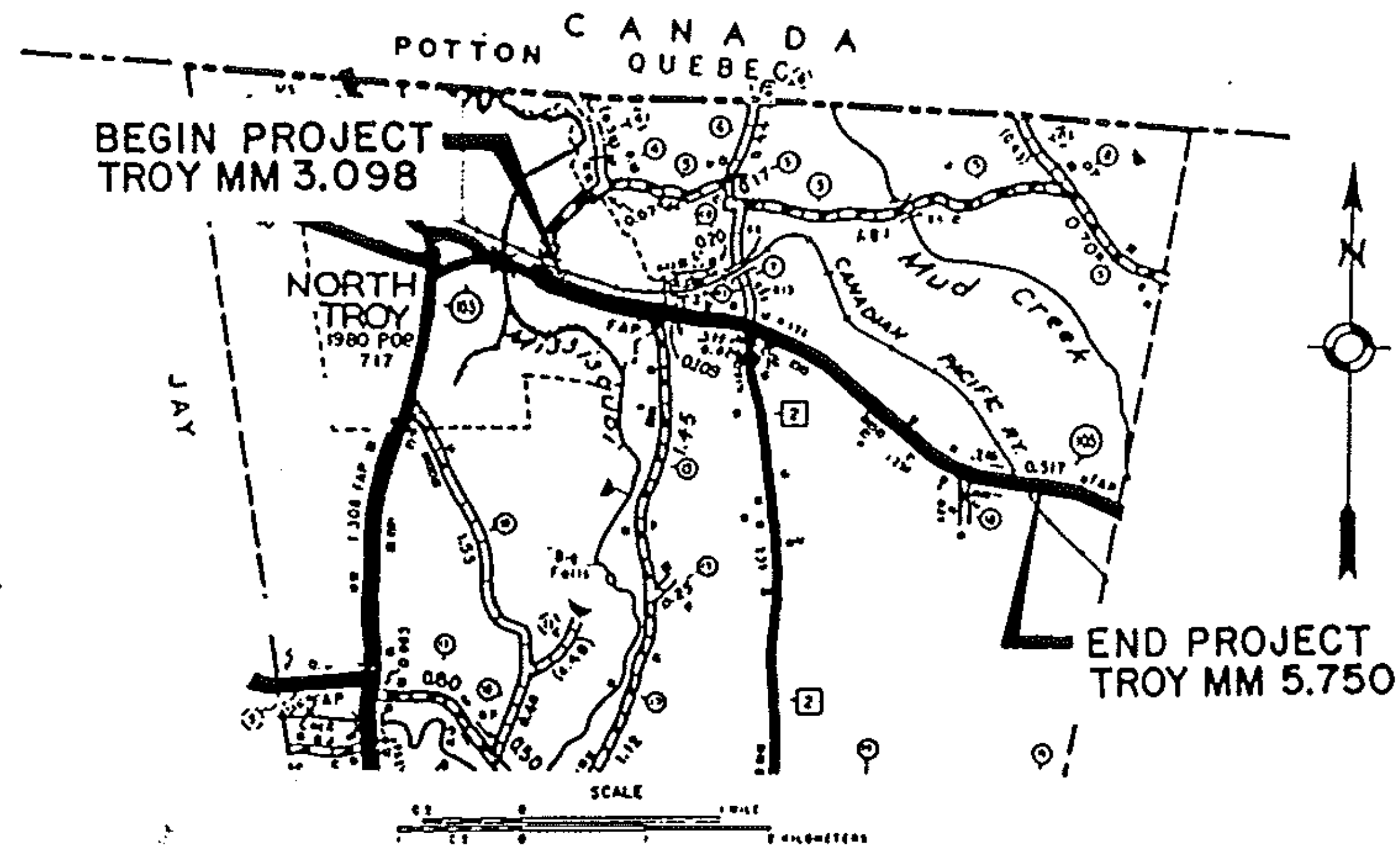

PROJECT LOCATION

BEGINNING IN THE TOWN OF TROY AT MM 3.098 AND EXTENDING EASTERLY ALONG VT 105 FOR 2.652 MILES TO MM 5.750 JUST PAST THE RAILROAD CROSSING.

PROJECT LENGTH

2.652 MILES (14,003 FEET)

PROJECT DESCRIPTION

RESURFACE WITH A LEVELING COURSE AND $1\frac{1}{4}$ " BITUMINOUS OVERLAY, PROVIDE PAVED SHOULDERS AND NEW PAVEMENT MARKINGS AS INDICATED ON THE PLANS OR AS DIRECTED BY THE ENGINEER.

TRAFFIC DATA

AADT 1290
V 30 MPH

PROJECT TROY

NO. HMA 2831

SHEET 23 OF 26 SHEETS