

PLANTING AREA DETAIL 317 (TORTILLA FLAT)  
STA. 40+80± ~ 41+74± LT.

Protect existing plants

Prop.#	STA	Quan.	Code	Latin Name	Common Name
317	40+89 & 41+19 LT	2	CS	Cornus stolonifera	Variegated Redtwig Dogwood
317	40+84 & 40+94 LT	2	RP	Rhododendron 'PJM'	PJM type Rhododendron
317	41+08 to 41+15 LT	5	YF	Yucca flaccida	Yucca

Existing plants shall be protected during construction. If they are damaged or destroyed, they shall be replaced with new material.

Replace plants (shown shaded)

Prop.#	STA	Quan.	Code	Latin Name	Common Name
317	41+48 LT	1	RP	Rhododendron 'PJM'	PJM type Rhododendron
317	41+43 & 41+52 LT	2	SA	Spiraea 'Anthony Waterer'	Anthony Waterer Spirea
317	41+27 to 41+50 LT	8	YF	Yucca flaccida	Yucca
	40+88 to 40+97 LT				
317	41+35 to 41+40 LT	3	PAN	Picea abies 'Nidiformis'	Birds Nest Spruce
317	41+48 LT	1	CS	Cornus stolonifera	Variegated Redtwig Dogwood
317	41+38± LT	3	JH	Juniperus horizontalis	Juniper - creeping type
317	41+35 to 41+53 LT	4	JV	Juniperus virginiana	Juniper - narrow upright type
317	41+31 to 41+36 LT	3	PF	Potentilla fruticosa	Potentilla
317	41+25 LT	1	PX	Prunus x cistena	Purpleleaf Sand Cherry

Note: In addition to the replacements shown 4 new Yuccas shall be installed where sign will be taken out. All new plants are included on the plant list on "landscape details/plant list" sheet.

Refer to plan Sheet #121.

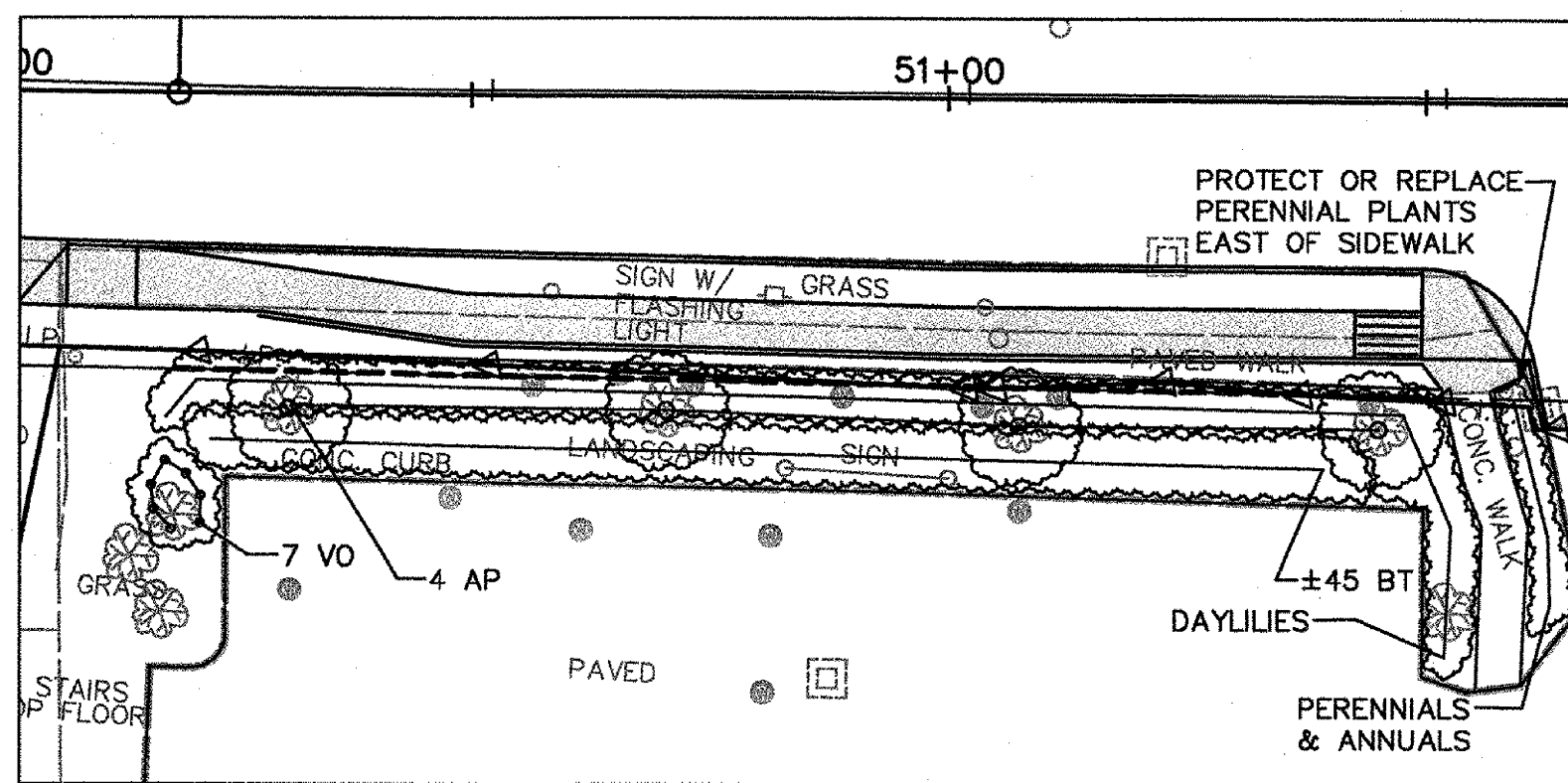

PLANTING AREA DETAIL 222A (SALMON RUN WEST)  
STA. 50+07± ~ 51+66± RT.

Protect existing plants

Prop.#	STA	Quan.	Code	Latin Name	Common Name
Salmon Run West (#222)	50+40 to 51+35 RT	4	AP	Acer platanoides	Norway Maple ✓
	50+33 to 51+50 RT	45±	BT	Berberis thunbergii	Japanese Barberry ✓
	50+03 to 50+15 RT	7	VO	Viburnum opulus	Cranberrybush Viburnum ✓
	50+05 to 51+55 RT		HS	Hemerocallis sp.	Daylilies

Existing plants shall be protected during construction. If they are damaged or destroyed, they shall be replaced with new material.

Refer to plan Sheet #123.

50+34 - 50+65 59 ORANGE DAYLILIES (HF) 6-1-07  
50+40 RT - 10 JAPANESE BARBERRY 6-5-07

✓ = OK II-28-06

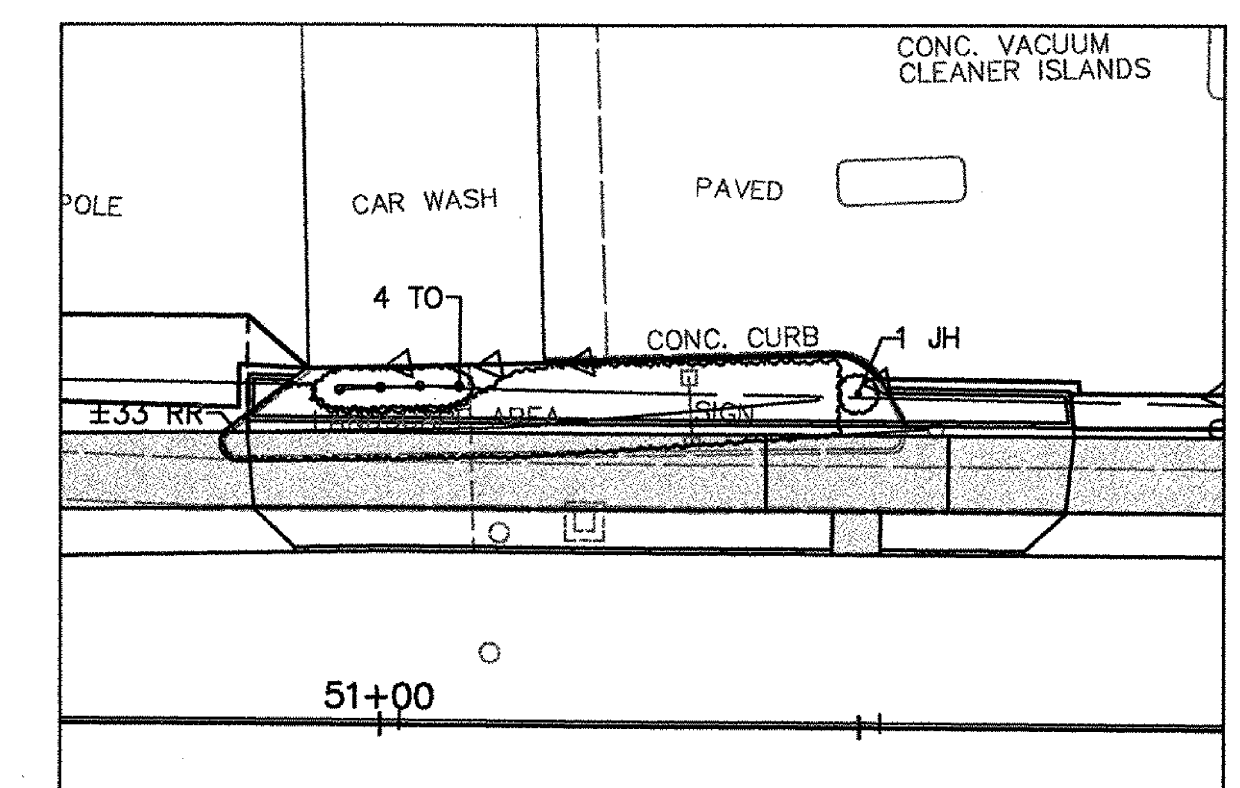

PLANTING AREA DETAIL 199  
STA. 50+83± ~ 51+56± LT.

Protect existing plants to the maximum extent possible

Prop.#	STA	Quan.	Code	Latin Name	Common Name
199	50+83 to 51+47 LT	33±	RR	Rosa rugosa	Rugosa Rose
199	50+93 to 51+17 LT	4	TO	Thuja occidentalis	Northern White Cedar
199	51+50 LT	1	JH	Juniperus horizontalis	Juniper - creeping type

Refer to plan Sheet #123.

EXISTING PLANTS OK II-30-06 (4 TO)

PROPERTY OWNER OK WITH TOPSOIL & GRASS ONLY IN ISLAND

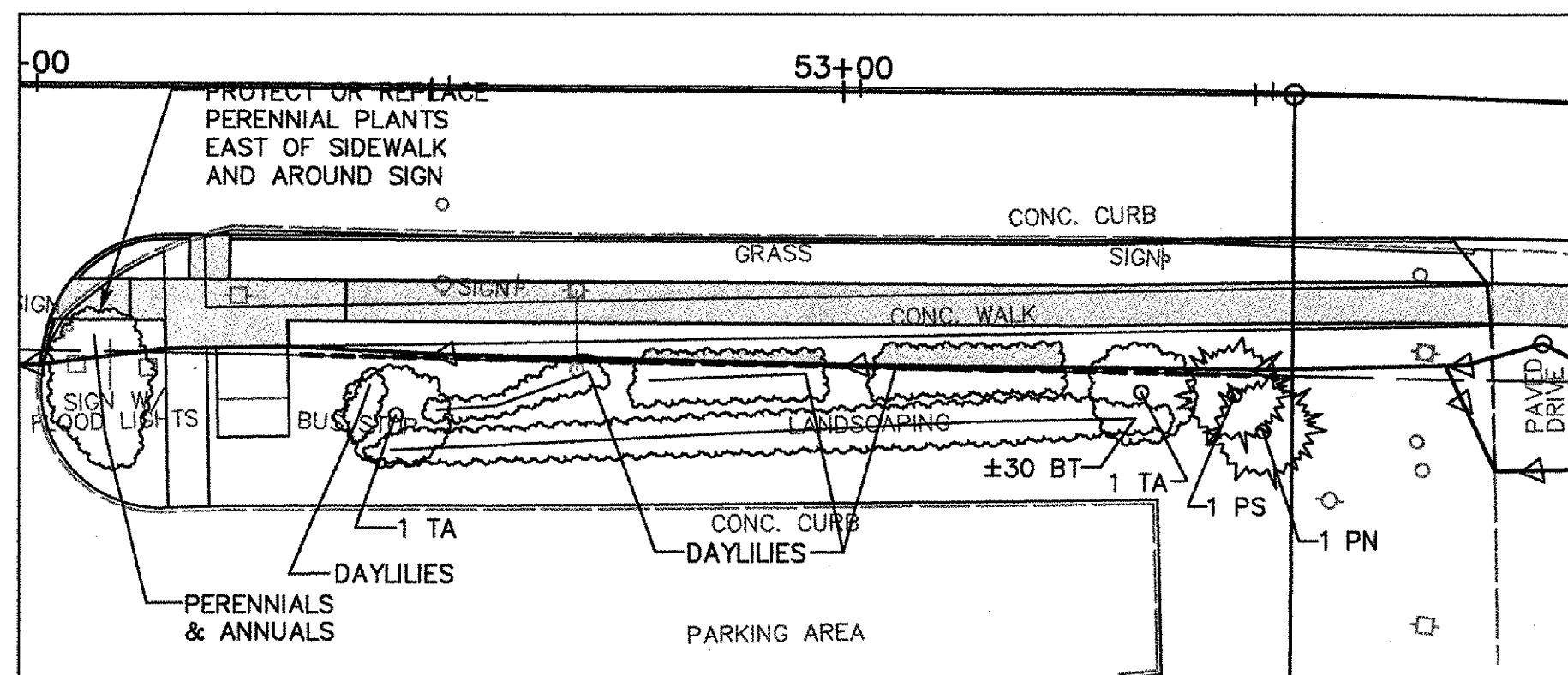

PLANTING AREA DETAIL 222B (SALMON RUN EAST)  
STA. 52+03± ~ 53+78± RT.

Protect existing plants

Prop.#	STA	Quan.	Code	Latin Name	Common Name
Salmon Run East (#222)	52+39 to 53+40 RT	30±	BT	Berberis thunbergii	Japanese Barberry
	52+47 and 53+34 RT	2	TA	Tilia americana	American Basswood
	53+47± RT	1	PS	Pinus strobus	Eastern White Pine
	53+50± RT	1	PN	Pinus nigra	Austrian Pine

Existing plants shall be protected during construction. If they are damaged or destroyed, they shall be replaced with new material.

Remove and replace daylilies (shown shaded)

Prop.#	STA	Quan.	Code	Latin Name	Common Name
Salmon Run	52+75 to 53+27 RT	30	HF	Hemerocallis fulva	Orange Daylilies

Refer to plan Sheet #123.

ALL PLANTS OK II-28-06

PLACED 17 ORANGE DAYLILIES 53+04 - 53+25 RT 6-1-07

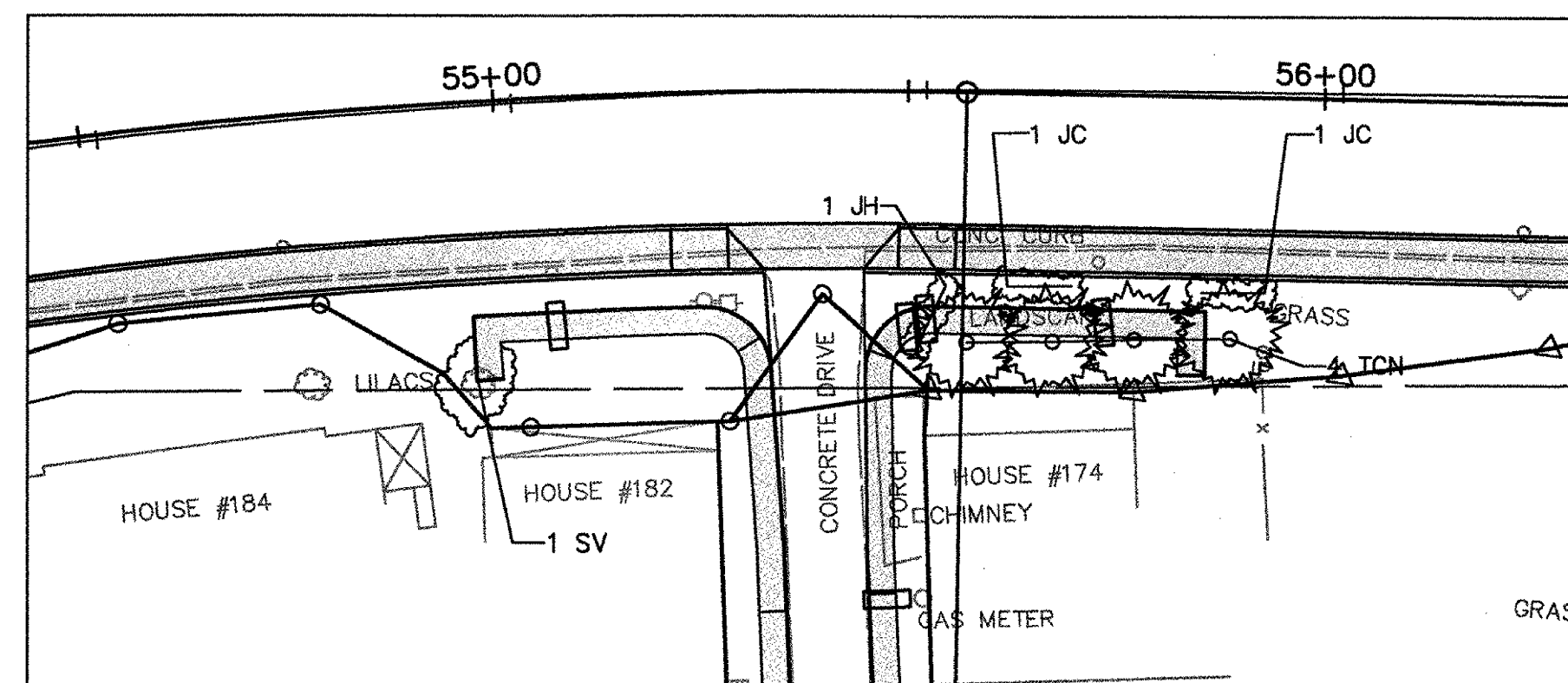

PLANTING AREA DETAIL 174  
STA. 55+40± ~ 56+50± RT.

Remove existing plants

Prop.#	STA	Quan.	Code	Latin Name	Common Name
182	54+97 RT	1	SV	Syringa vulgaris	Common Lilac (clump)
174	55+53 to 55+90 RT	4	TCN	Tsuga canadensis	Eastern Hemlock
174	55+83 to 55+90 RT	2	JC	Juniperus chinensis	Spreading Juniper
174	55+50 RT	1	JH	Juniperus horizontalis	Juniper - creeping type

Existing plants shall be removed.

Refer to plan Sheet #124.

ALL PLANTS REMOVED PER PLAN

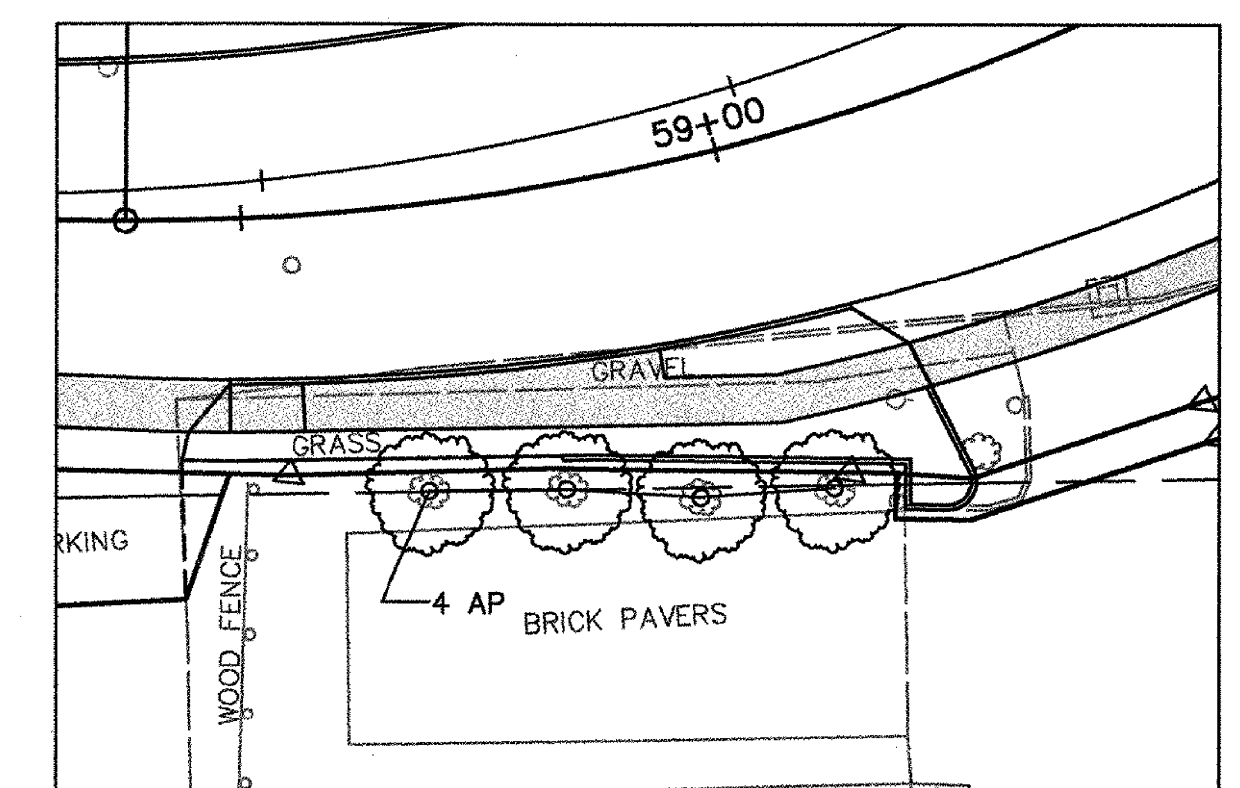

PLANTING AREA DETAIL 140  
STA. 58+49± ~ 59+13± RT.

Protect existing trees

Prop.#	STA	Quan.	Code	Latin Name	Common Name
140	58+68 to 59+07 RT	4	AP	Acer platanoides	Norway Maple 'Crimson King'

Existing trees shall be protected during construction. If they are damaged or destroyed, they shall be replaced with new material.

Refer to plan Sheet #124.

4 - TREES OK II-27-06

NOTE:  
The plants shown on the planting area details existed on site as of May 2004.

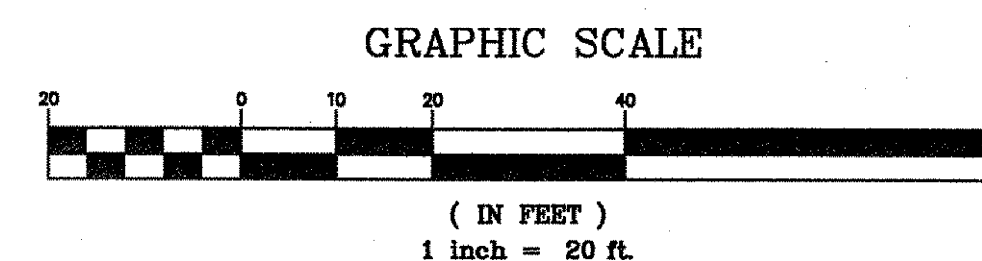

SURVEY OTHERS DESIGNED NK DRAWN NPN CHECKED NK SCALE 1" = 20' FILE NAME: POIR00		PLANTING AREA DETAILS-2 OF 2	DATE 6/14/04
		RIVERSIDE AVENUE	DRAWING NO. SHEET 129 OF 252
		BURLINGTON, VERMONT	PROJECT NO. 6409
		SUMMIT ENGINEERING, INC 50 Joy Drive P.O. Box 2225 South Burlington, VT 05407-2225 Bus. (802) 658-5588 Fax (802) 658-3829	
		©	