

MATCHLINE - SHEET SL10, STATION 65+50

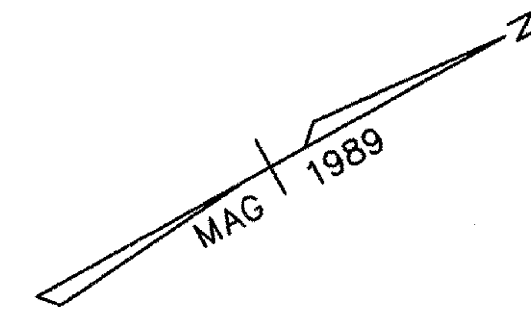

ELECTRICAL CONDUIT SLEEVE 6"  
68+86 LT-RT 4'  
68+94 - 69+63 RT 70'

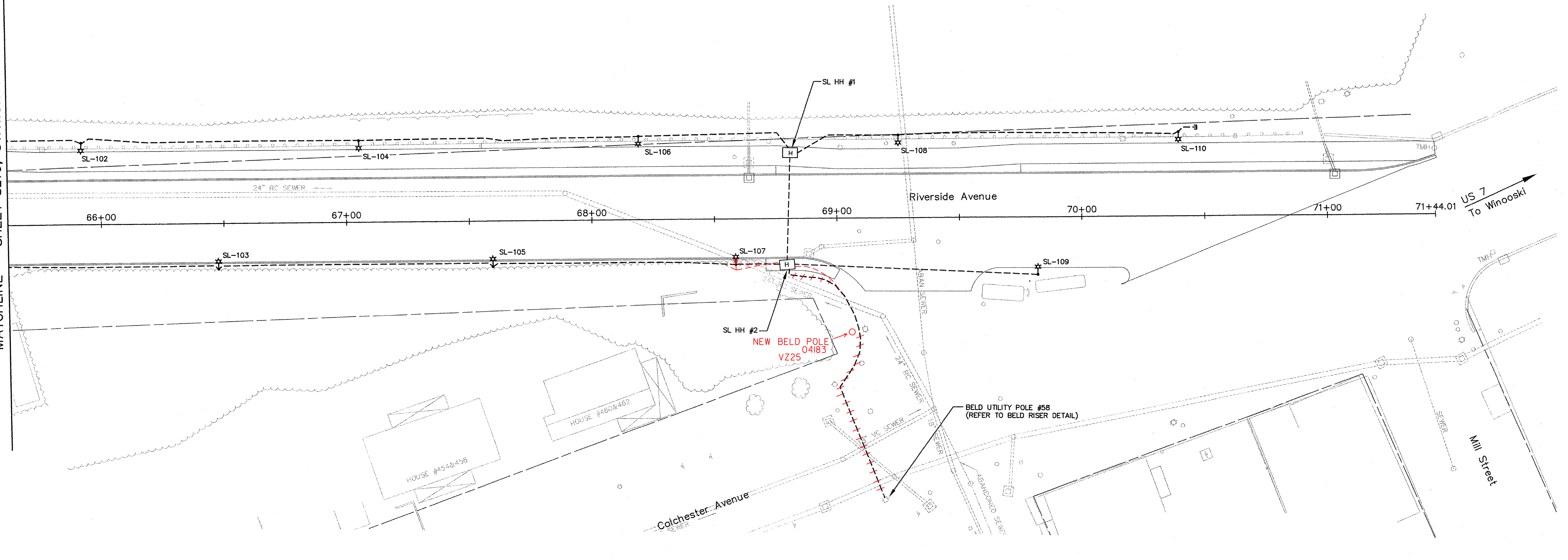

DATUM	NATIONAL GEODETIC
VERTICAL	VERTICAL DATUM 1929
HORIZONTAL	N/A

68+59

STREET LIGHTING LOCATIONS SCHEDULE							
STREET LIGHT NO.	POLE LOCATION	21.8' R POLE OFFSET	LUMINAIRE TYPE	POLE TYPE	LUMINAIRE MOUNTING HEIGHT	BRACKET ARM LENGTH	REMARKS
SL- 102	65 +91.9'	33.6' L	A	A	22'	29"	
SL- 103	66 +47.7'	18.8' R	A	A	22'	29"	
SL- 104	67 +05.1'	33.7' L	A	A	22'	29"	
SL- 105	67 +59.5'	18.7' R	A	A	22'	29"	
SL- 106	68 +19.2'	34.0' L	A	A	22'	29"	
SL- 107	68 +58.7'	18.7' R	A	A	22'	29"	
SL- 108	69 +25.2'	34.1' L	A	A	22'	29"	
SL- 109	69 +81.8'	23.6' R	A	A	22'	29"	
SL- 110	70 +39.5'	34.7' L	A	A	22'	29"	

**LEGEND**

- STREET LIGHTING AND ELECTRICAL CONDUIT
- [H] SL HH#X = STREET LIGHTING HANDHOLE
- ☼ TYPE A STREET LIGHT
- TYPE B STREET LIGHT
- BURIED CONDUIT SWEEP WITH CAP FOR FUTURE USE

SCALE IN FEET

**STREET LIGHTING LAYOUT PLANS**

**SHEET SL11**

SURVEYED BY	CLD	DATE	07/89
DRAWN BY	MLC/JTM/PBH	DATE	06/03
DESIGN BY	LAB/MLC		
DESIGN FILE NO.			
PRF FILE		DATE PLOTTED	
PROJ. NAME	BURLINGTON		
PROJ. NO.	MEGC 5000(15)		
SHEET 112	OF 252	SHEETS	