

SURV. PI #5 36+28.43  
= 36+27.82  
REV. PI #5 36+29.67  
= 36+29.17

REV. STA 36+87.10 =  
SURV. STA 36+86.09  
AHEAD ANGLE = 0°55'24"

**CAST-IN-PLACE CEMENT CONCRETE CURB, TYPE B**  
REV 36+58 - 37+33 LT 26  
57 REV 36+56 - 37+31 RT (BEHIND SW) 96  
REV 36+60.5 - 37+81 RT  
78 REV 37+83 - 38+36 LT 41.5  
REV 38+03 - 38+36 RT 34.5  
46.5 REV 38+41 - 38+94 LT 90.5  
95.5 REV 38+96 - 40+45 LT 50.5  
REV 38+45 - 38+45 RT (HILLSIDE TERRACE EAST)  
REV 38+83 - 38+86 RT (HILLSIDE TERRACE EAST)  
97 REV 38+98 - 39+34 RT 48+10.5  
REV 39+39 - 45+84 RT  
REV 40+85 - 41+96 LT  
84 95

**CHANGE ELEVATION OF SEWER MANHOLE**  
REV 37+00 RT  
REV 39+06 RT  
REV 41+16 RT

**REHABING D/CB OR MH CLASS II I**  
REV 39+52 RT  
REV 41+16 RT

**CONSTRUCT DRIVE**  
REV 36+38 LT - 30' W PAVED  
REV 36+48 RT - 12' W GRAVEL  
REV 37+58 LT - 40' W PAVED  
REV 37+85 RT - 12' W PAVED  
REV 40+65 LT - 30' W PAVED

**8" BITUMINOUS CONCRETE PED/BIKEWAY**  
REV 36+54 - 37+37 LT  
REV 37+78 - 40+50 LT  
REV 40+80 - 42+01 LT

**BRICK PAVING**  
REV 40+79 - 41+51 LT

**ADJUST ELEVATION OF VALVE BOX**  
REV 36+74 RT 36+12 LT 30'  
REV 36+80 RT II' 36+74 RT 12'  
REV 37+00 RT 37+64 RT 10'  
REV 37+07 RT II' 38+40 RT 32'  
G REV 40+83 LT 23' 38+40 RT 41'  
REV 41+51 RT 38+40 RT 57'

40+97 LT 23'  
G 39+98 LT 24'  
G 36+72 LT 22'  
G 36+86 RT 21'  
G 39+00 LT 22'

36+61 - 37+81 RT  
38+03 + 38+58  
**PORTLAND CEMENT CONCRETE SIDEWALK, 5"**  
REV 38+39 RT (5' WIDE)  
REV 38+39 LT (5' WIDE)  
38+88 REV 38+87 - 49+62 RT 48+10  
REV 38+94 RT (5' WIDE)  
REV 38+94 LT (5' WIDE)  
REV 39+36 RT (5' WIDE)

**CONSTRUCT SIDEWALK RAMP W/ DETECTABLE WARNING SURFACE (YELLOW)**  
REV 38+39 LT (TYPE 2)  
REV 38+40 RT (TYPE 1 MOD.)  
REV 38+90 RT (TYPE 1 MOD.)  
REV 38+94 LT (TYPE 2)  
REV 39+36 RT (TYPE 2)

**PORTLAND CEMENT CONCRETE SIDEWALK 8"**  
36+41 - 36+61 RT  
37+81 - 38+03 RT  
37+40 - 37+86 LT

REV. STA 40+93.02 =  
SURV. STA 40+92.12  
AHEAD ANGLE = 1°28'07"

SURV. PI #6 41+49.28  
= 41+46.40

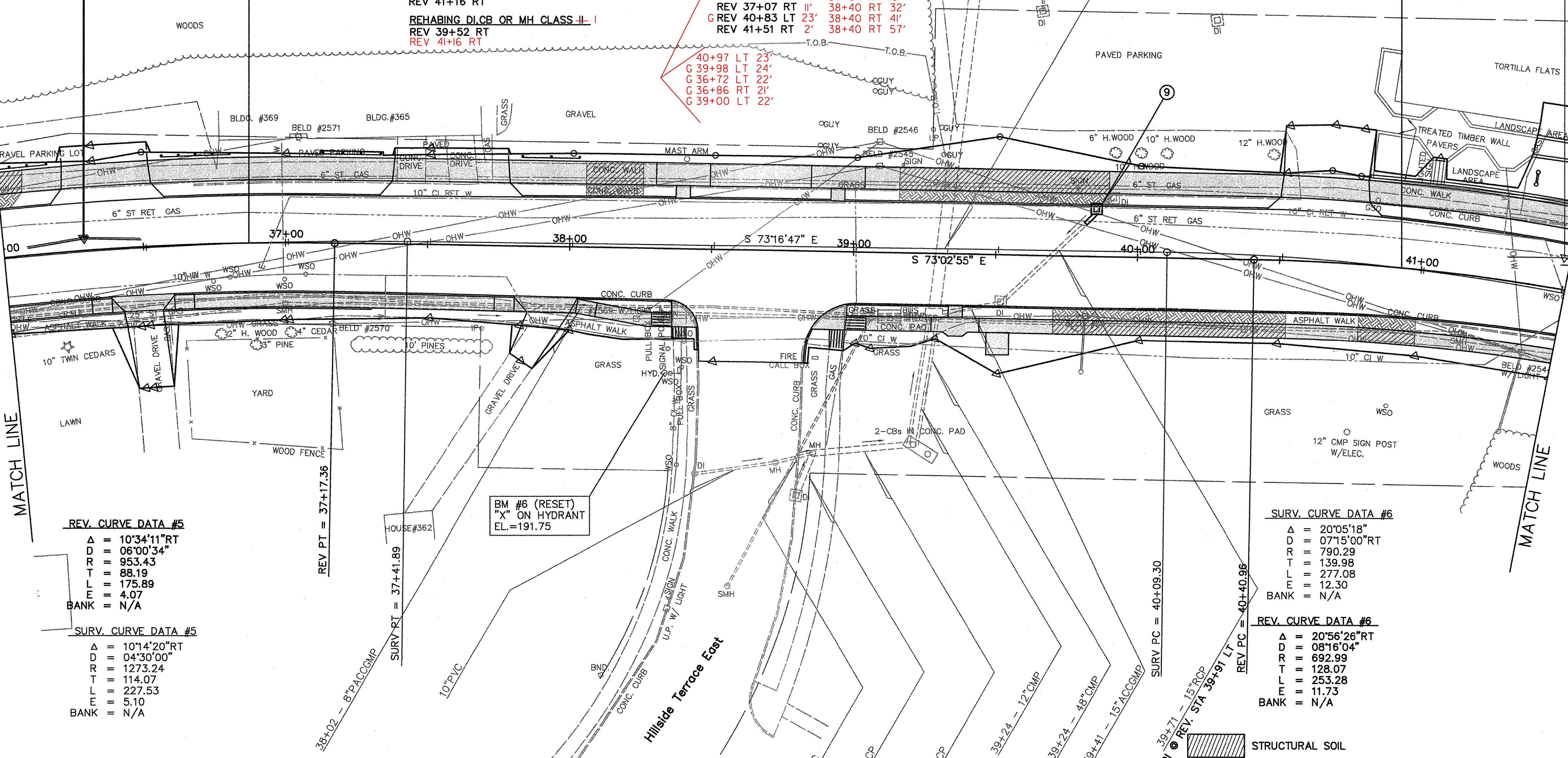

**REV. CURVE DATA #5**  
Δ = 10°34'11" RT  
D = 06°00'34"  
R = 953.43  
T = 88.19  
L = 175.89  
E = 4.07  
BANK = N/A

**SURV. CURVE DATA #5**  
Δ = 10°14'20" RT  
D = 04°30'00"  
R = 1273.24  
T = 114.07  
L = 227.53  
E = 5.10  
BANK = N/A

**SURV. CURVE DATA #6**  
Δ = 20°05'18"  
D = 07°15'00" RT  
R = 790.29  
T = 139.98  
L = 277.08  
E = 12.30  
BANK = N/A

**REV. CURVE DATA #6**  
Δ = 20°56'26" RT  
D = 08°16'04"  
R = 692.99  
T = 128.07  
L = 253.28  
E = 11.73  
BANK = N/A

STRUCTURAL SOIL  
TOPSOIL

**PORTLAND CEMENT CONCRETE SIDEWALK, 8" (MOD)**  
REV 39+50 RT (8'x8' 10" DEEP WITH #4 REINFORCING STEEL @ 10" O.C. EACH WAY)

**DEMOLITION AND DISPOSAL OF BUILDING (MOD)**  
REV 39+12 RT (RELOCATE BUS SHELTER TO REV 39+50 RT ANCHOR WITH 5/8" DIA GALVANIZED THREADED ROD SET IN EPOXY MORTAR, 5" EMBEDMENT. TYPICAL AT EACH POST)

REV 41+02 LT (RELOCATE SIGN AND LIGHTING TO REV 41+35 LT)

REMOVE AND REPLACE BRICK PAVING  
REV 41+33 - 41+52 LT

**REMOVING AND RESETTING CURBING (WOOD CURB)**  
REV 40+80 - 41+52 LT  
REV 41+33 - 41+48 LT (UTILITY RELOCATION)  
REV 41+33 - 41+52 LT (UTILITY RELOCATION)

**DATUM**  
VERTICAL NGVD 1929  
HORIZONTAL N/A

⑨ REV. STA 39+85 LT  
NEW 15" X 4" RCP CLASS III  
NEW 4' X 4' RCDI W/C.I. GRATE TYPE D

**GENERAL CONSTRUCTION PLAN**

SURVEYED BY	CLD	DATE	7/89
DRAWN BY	TUS	DATE	10/93
SQUAD LEADER	JAW		
DESIGN FILE NO.	89-108		
IPARM FILE	DATE PLOTTED		
PROJECT NAME:	BURLINGTON		
PROJECT NUMBER:	MEGC 5000(15)		
SHEET	59	OF 252 SHEETS	

