

EXISTING DRAINAGE

1 ML 199+55 CL ASKEW 53°15'24" METAL PIPE - REMOVE

NEW DRAINAGE

1 ML 200+00 LT
NEW 18" X 20" PCCSP (.064), CAAP (.060), RCP CL. III, OR CPEP (SL) W/ MES AND PRC PIPE DI; STONE FILL, TYPE I PAD @ OUTLET

BENCHMARKS

BM 1 BM #1 RAILROAD SPIKE IN POLE ELEV 591.26'

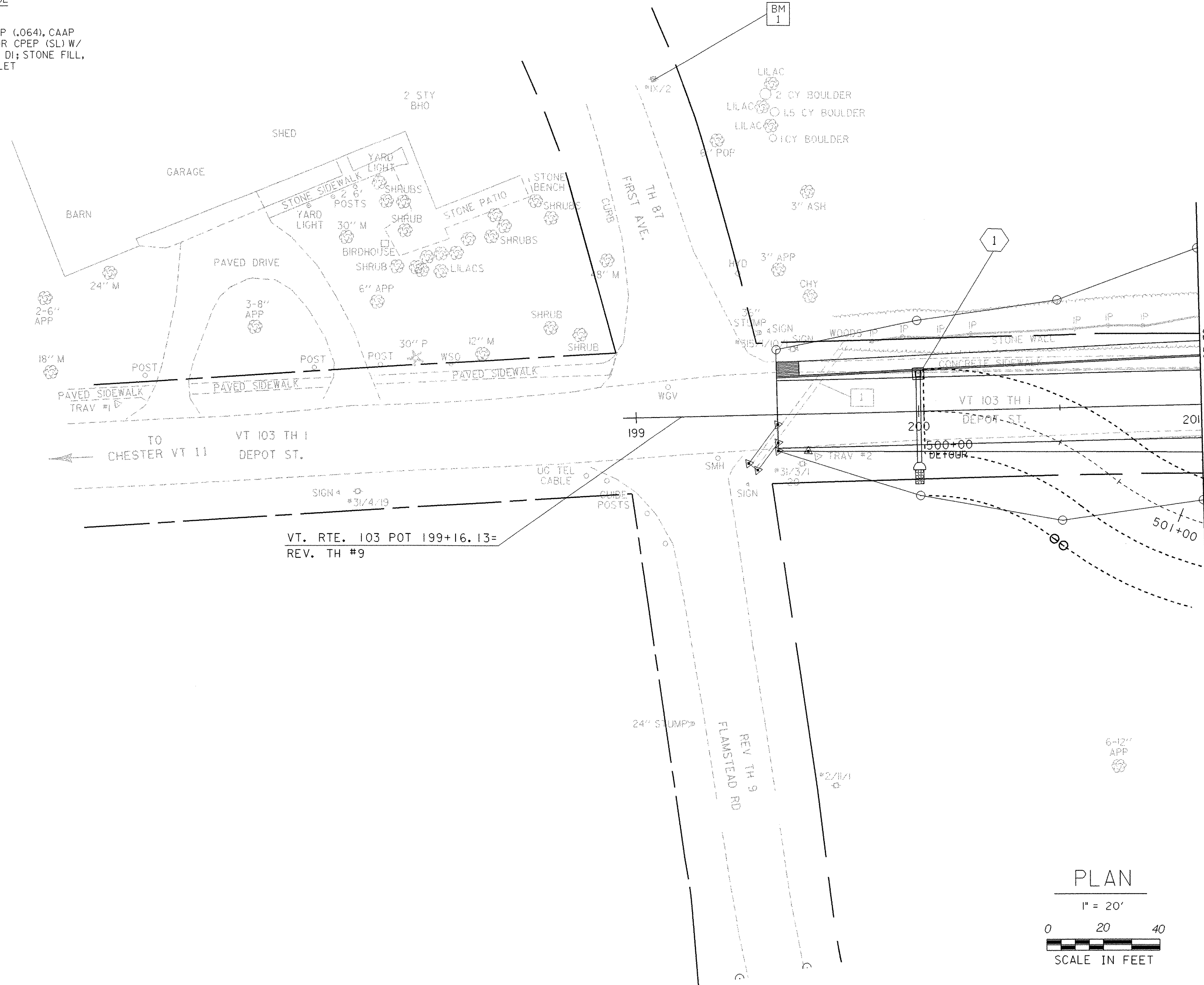

REMOVAL AND DISPOSAL OF GUARD RAIL
ML 200+78 RT. - ML 201+00 RT.

COLD PLANING - BITUMINOUS CONCRETE
ML 199+50 - ML 200+00

REPLACE - BITUMINOUS CONCRETE
EDGE OF EXISTING ROAD ABOVE EXISTING PIPE TO ML 199+50 -

CONSTRUCT SIDEWALK RAMP
ML 199+50 LT. - ML 199+58 LT. (TYPE I)

BITUMINOUS CONCRETE SIDEWALK
ML 199+50 LT. - ML 201+00 LT.

CAST-IN-PLACE CONCRETE CURB, TYPE B
ML 199+50 LT. - ML 201+00 LT.

STEEL BEAM GUARD RAIL
ML 200+54 RT. - ML 201+00 RT.

ANCHOR FOR STEEL BEAM RAIL
ML 200+54 RT.

DATUM
VERTICAL NGVD 1929
HORIZONTAL NAD 1927

PLAN

1" = 20'

0 20 40

SCALE IN FEET

SURVEYED BY	SHERIDAN	DATE	08-90
DRAWN BY	L. BULLOCK	DATE	11-90
SQUAD LEADER	PORTALUPI		
DESIGN FILE NO.	M:\1549101\VA07-Chester Curv		
PRF FILE	ZFI34LI.I	DATE PLOTTED	28-MAY-2003
PROJ. NAME	CHESTER		
PROJ. NO.	BRF 025-1(35)		
SHEET	21	OF	79 SHEETS