

POST DETAIL CHART FOR WW #1, WW #2 & WW #3 APPROACHES

POST No.	QTY	OFFSET BLOCK MTG. DIMENSIONS							BEV
		A	B	C	D	E	F (O.C.)	X	
P10	1	1 7/8"	1'-1 5/16"	2'-2 1/4"	9/16"	1 1/4"	3'-4 9/16"	1	
P11	1	1 7/8"	11 5/8"	2'-0 7/16"	9/16"	1 1/4"	3'-2 1/8"	1	
P12	1	1 7/8"	10"	1'-10 11/16"	9/16"	1 1/4"	2'-11 11/16"	1	
P13	1	1 7/8"	8 5/16"	1'-8 7/8"	9/16"	1 1/4"	2'-9 1/4"	1	
P14	1	1 11/16"	1'-1 1/8"	2'-2 1/8"	5/16"	1 7/16"	3'-4 3/4"	1/2	
P15	1	1 11/16"	11 1/2"	2'-0 3/8"	5/16"	1 7/16"	3'-2 5/8"	1/2	
P16	1	1 11/16"	9 13/16"	1'-10 5/8"	5/16"	1 7/16"	3'-0 1/2"	1/2	
P17	1	1 11/16"	8 1/8"	1'-8 7/8"	5/16"	1 7/16"	2'-10 7/16"	1/2	
P7	1	2"	1'-2 11/16"		0	2"	2'-4"	SQ	
P8	1	2"	1'-2 5/8"		0	2"	2'-3 9/16"	SQ	
P9	1	2"	1'-2 9/16"		0	2"	2'-3"	SQ	

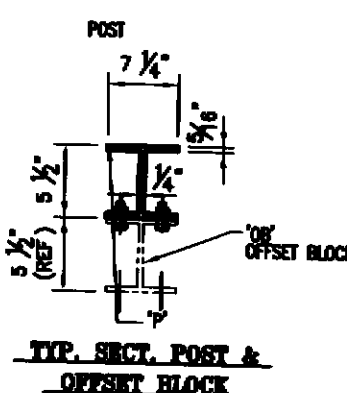

POST DETAIL CHART FOR WW #1 & WW #2 APPROACHES

POST No.	QTY	OFFSET BLOCK MTG. DIMENSIONS							BEV
		A	B	C	D	E	F (O.C.)	X	
P3	1	1 11/16"	1'-1 1/8"	2'-2 1/8"	5/16"	1 7/16"	3'-4 3/4"	1/2	
P4	1	1 11/16"	11 1/2"	2'-0 3/8"	5/16"	1 7/16"	3'-2 5/8"	1/2	
P5	1	1 11/16"	9 13/16"	1'-10 5/8"	5/16"	1 7/16"	3'-0 9/16"	1/2	
P6	1	1 11/16"	8 1/8"	1'-8 7/8"	5/16"	1 7/16"	2'-10 7/16"	1/2	
P18	1	2"	1'-2 11/16"		0	2"	2'-4"	SQ	
P19	1	2"	1'-2 5/8"		0	2"	2'-3 9/16"	SQ	
P20	1	2"	1'-2 9/16"		0	2"	2'-3"	SQ	

NOTE:
 2 CLAMPING BARS CB-01-H (#22288) PER POSTS P2-P4, P12
 4 CLAMPING BARS CB-03-A (#19447) PER POSTS P2-P4, P12
 W/ 1/2" x 13 UNC S.S. BOLT x 1" LG. FB1,
 1 1/16" O.D. x 17/32" WASHER FW1 (#15280 & # 19404) (8 PER POST)

NOTE:
 4 CLAMPING BARS CB-03-A (#19447) PER POSTS P2-P4, P12
 W/ 1/2" x 13 UNC S.S. BOLT x 1" LG. FB1,
 1 1/16" O.D. x 17/32" WASHER FW1 (#15280 & # 19404) (8 PER POST)

PROJECT No. BRP 023-03

APPROVED: [Signature] DATE: 11/08/02

DRY APPROV: [Signature] DATE: 12/28/02

L.B. FOSTER COMPANY
 1818 GREENHURST ROAD
 PITTSBOROUGH, VERMONT 05470

FOR: F. R. LAFFETTE, INCORPORATED
 VERMONT AGENCY OF TRANSPORTATION
 TOWN OF FARRIS, COUNTY OF FRANKLIN
 BRIDGE OVERLOOK FOR BRIDGE P21 BY THE 104 MAIN AVENUE
 IN ALUMINUM APPROACH RAIL POST DETAILS

DATE: 11/08/02, JOB No. 020002, SHEET No. 1212

ANODIZED
 (SEE NOTES ON LIST)

NOTE:
 FOR POST TOPS THAT HAVE MITERS
 LESS THAN OR EQUAL TO 1/8"
 - THE POSTS WILL BE TREATED
 SQUARE.