

163 STRUCTURAL  
STEEL

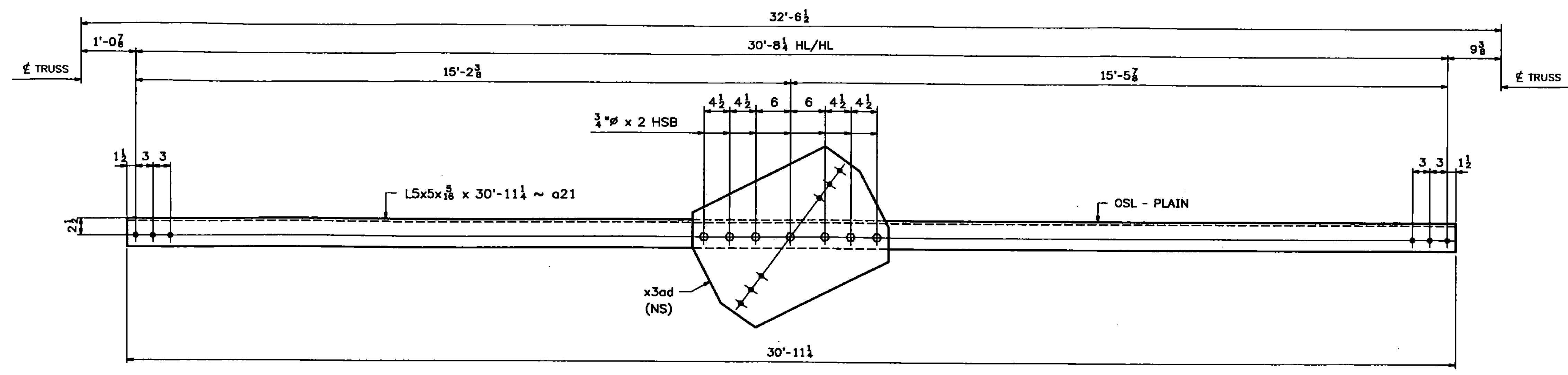

**2 - LATERAL BRACING - 21LB1**  
(FLOOR LATERAL BRACING)

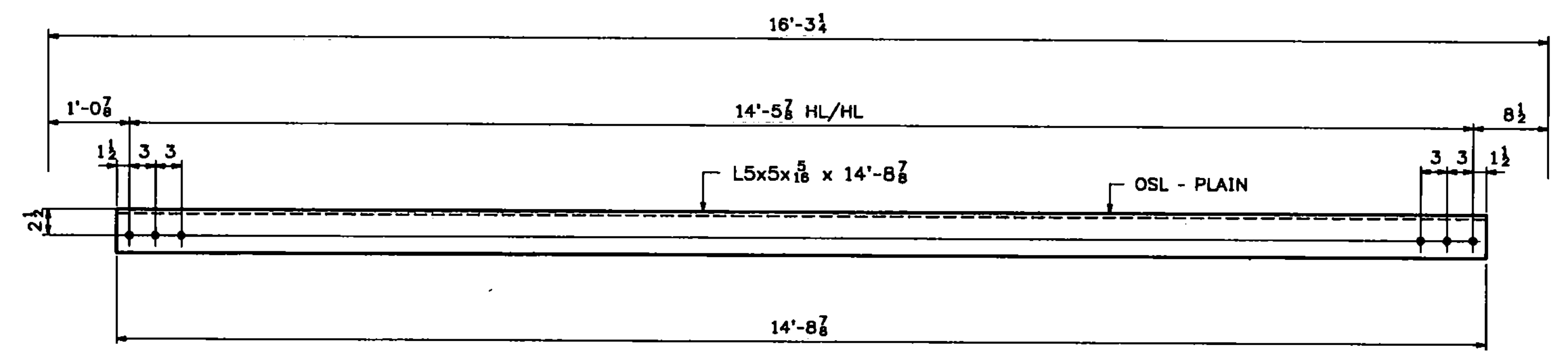

**2 - LATERAL BRACING - 21LB2**  
(FLOOR LATERAL BRACING)

ABM INFO		BILL OF MATERIAL				JOB NO.	DRAWING NO.	REV.	
PAGE	LINE	MARK	QTY	MARK	MATERIAL	LENGTH FT INCHES	REMARKS	WT	PROCUREMENT NOTES
		21LB1	2		LATERAL BRACING				
5	M		2	a21	L 5x5x1/8	30 11 1/4	(GALVANIZED)		
5	N		2	x3ad	PL 1/8 x 23	2 8	(GALVANIZED)		
10	C		14		3/4 HSB	0 2	(GALVANIZED)		
10	P		14		3/4 HSW		(GALVANIZED)		
					LATERAL BRACING				
5	M	21LB2	2		L 5x5x1/8	14 8 7/8	(GALVANIZED)		152

**SHOP NOTE:**  
ALL STEEL FOR LATERAL BRACING  
SHALL BE GALVANIZED

- NOTES:**
1. FOR GENERAL NOTES SEE DWG. GN1.
  2. FOR STANDARD DETAILS SEE DWG. X3.
  3. ALL BOLTS SHALL BE FULLY TORQUED (UN).
  4. BTS - DENOTES BOLT TO SHIP OR SECURE FOR SHIPMENT.
  5. OSL - DENOTES OUTSTANDING LEG OF ANGLE.

Vermont Agency of Transportation  
**RECEIVED**  
CK'D BY TCF OK'D BY SSS  
7:43 am, Apr 12, 2011  
RESUBMIT \_\_\_\_\_ APPROVED X  
BY KMH DATE 4-12-11

REV.	DATE	REMARKS	DWN	CHK	APVL	SHOP
0						
MATERIAL:		SURFACE PREP. & PAINT:	HOLES:		SHOP BOLTS:	
M270-50 (U.N.)		SEE DWG GN1	1/8"		AS NOTED	
DESCRIPTION: FLOOR LATERAL BRACING						
<b>CASCO BAY STEEL STRUCTURES, INC.</b>						
75 SPRING HILL ROAD			SACO, MAINE 04072			
PHONE (207) 282-7360			FAX. (207) 282-1179			
STRUCTURE:			DRAWN:	DATE:		
Vermont Route 100A			JM	03/03/11		
Bridge No. 14			CHKD:	DATE:		
Bridgewater			PWR	03/07/11		
County of Windsor						
LOCATION: BRIDGEWATER, VERMONT			JOB NO.	DWG NO.		
PROJ NO. BRS 0149(4)			454	21		
CUSTOMER: VT AOT				REV. $\Delta$		

11/11/11 10:00:00 AM /Users/psm/2011/2011\_03\_03\_11\_00\_00.dwg