

141 STRUCTURAL
STEEL

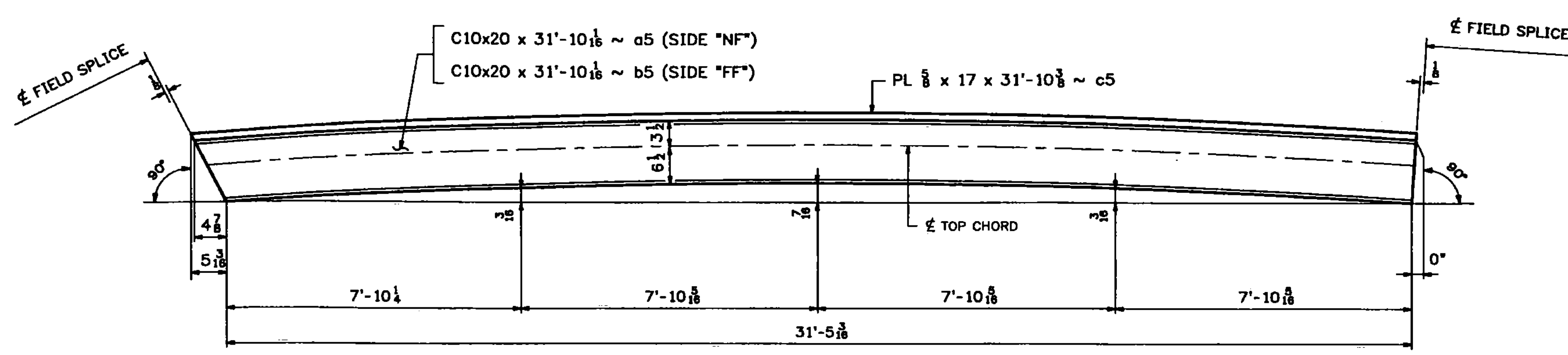

CAMBER DIAGRAM FOR 5TC1W & 5TC3E

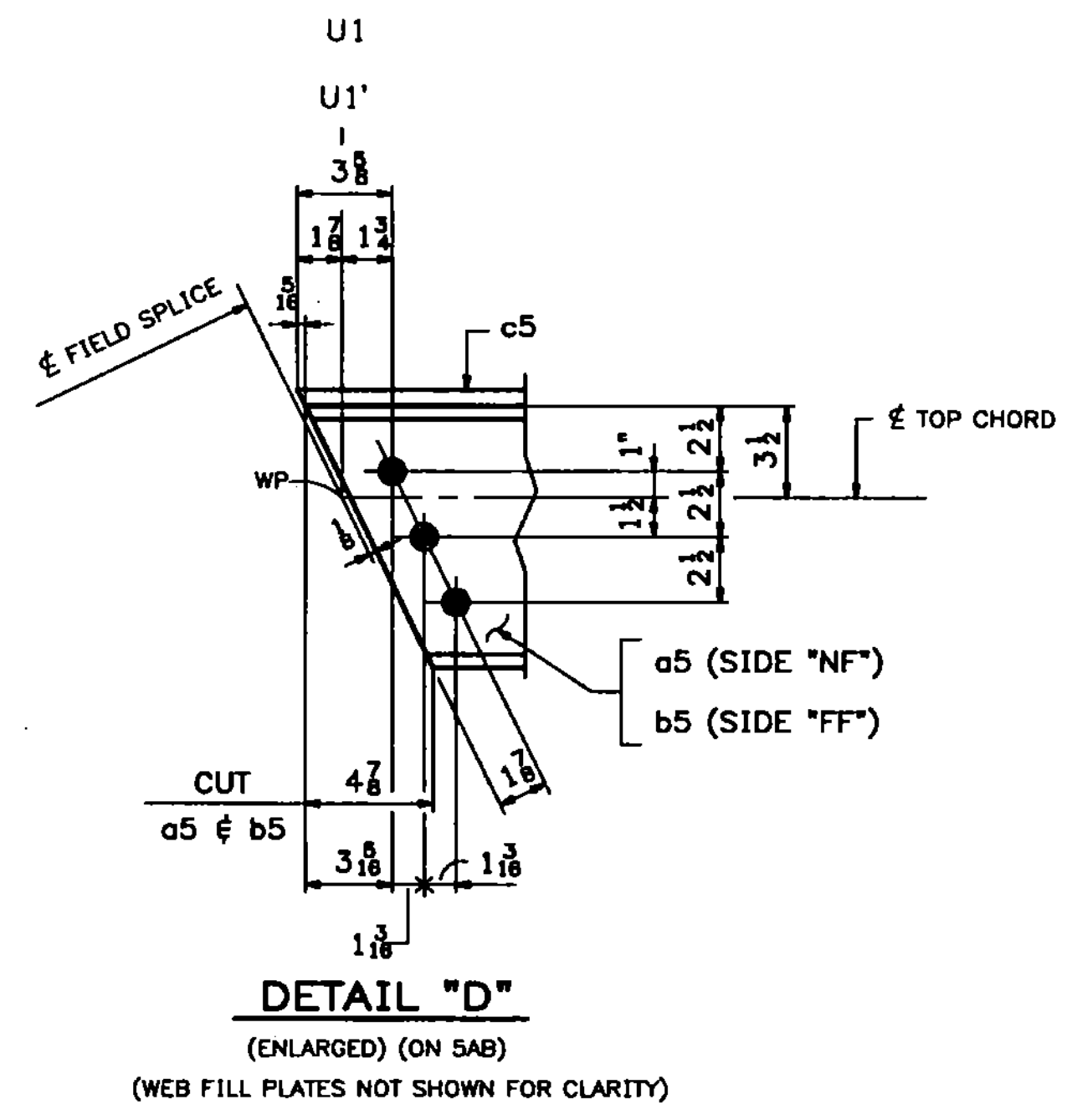

DETAIL "D"
(ENLARGED) (ON 5AB)
(WEB FILL PLATES NOT SHOWN FOR CLARITY)

| ABM INFO | | SHIP | BILL OF MATERIAL | | | | JOB NO. | DRAWING NO. | REV. |
|----------|------|-------|------------------|------|--------------------------|--------|------------------------|-------------|-------------------|
| | | | | | | | 454 | 5B | |
| PAGE | LINE | MARK | QTY | MARK | MATERIAL | LENGTH | REMARKS | WT | PROCUREMENT NOTES |
| | | | | | | FT | INCHES | | |
| | | 5TC1W | 1 | | TOP CHORD | | ALIKE EXCEPT | 356 | |
| | | 5TC3E | 1 | | TOP CHORD | | FOR MARK | 356 | |
| 2 | B | | 2 | a5 | C 10x20 | 31 | (GALVANIZED) M270-S072 | | |
| 2 | B | | 2 | b5 | C 10x20 | 31 | (GALVANIZED) M270-S072 | | |
| 2 | D | | 2 | c5 | PL 5/8x17 | 31 | (GALVANIZED) M270-S072 | | |
| 3 | M | | 4 | x1aa | PL 1/2x8 | 1 | (GALVANIZED) | | |
| 2 | G | | 4 | x2a | PL 1/2x34 1/2 | 3 | (GALVANIZED) M270-S072 | | |
| 2 | H | | 4 | x2b | PL 1/2x24 1/2 | 3 | (GALVANIZED) M270-S072 | | |
| 2 | J | | 4 | x2c | PL 1/2x28 1/2 | 3 | (GALVANIZED) M270-S072 | | |
| 2 | M | | 8 | x2g | PL 1/2x17 | 1 | (GALVANIZED) | | |
| 2 | P | | 72 | x2h | PL 1/2x2 1/2 | 1 | (GALVANIZED) | | |
| 2 | P | | 8 | x2ha | PL 1/2x2 1/2 | 1 | (GALVANIZED) | | |
| 7 | N | | 2 | x4ba | PL 1/2x9 | 2 | (GALVANIZED) | | |
| 10 | D | | 80 | | 1/2 # HSB | 0 | (GALVANIZED) A325-1 | 21 | |
| 10 | F | | 296 | | 1/2 # HSB | 0 | (GALVANIZED) A325-1 | 23 | |
| 10 | P | | 376 | | 1/2 # HSW | | (GALVANIZED) F436 | | |
| 10 | Q | | 376 | | BEVEL WASH FOR 3/8 # HSB | | (GALVANIZED) F436 | | |

T2 - DENOTES MATERIAL SUBJECT TO CHARPY V-NOTCH TESTING

Vermont Agency of Transportation
RECEIVED
CK'D BY TCF OK'D BY SSS
7:43 am, Apr 12, 2011
RESUBMIT APPROVED X
BY KMH DATE 4-12-11

WORK THIS DWG. WITH DWG. 5AB.

| | | | | | | |
|---|----------------------------------|------------------------------------|--------------------|----------------|----------------------|------|
| 03/02/11 | REVISED AS PER APPROVAL COMMENTS | JM | PWR | | | |
| REV. | DATE | REMARKS | DWN | CHK | APVL | SHOP |
| MATERIAL: M270-50 (U.N.) | | SURFACE PREP. & PAINT: SEE DWG GN1 | HOLES: 1/8" (U.N.) | | SHOP BOLTS: AS NOTED | |
| DESCRIPTION: TOP CHORD 5TC1W & 5TC3E | | | | | | |
| CASCO BAY STEEL STRUCTURES, INC. | | | | | | |
| 75 SPRING HILL ROAD | | | SACO, MAINE 04072 | | | |
| PHONE (207) 282-7360 | | | FAX (207) 282-1179 | | | |
| STRUCTURE: Vermont Route 100A | | DRAWN: RB | | DATE: 9/28/10 | | |
| Bridge No. 14 | | CHKD: WJL | | DATE: 10/18/10 | | |
| Bridgewater | | | | | | |
| County of Windsor | | | | | | |
| LOCATION: BRIDGEWATER, VERMONT | | | JOB NO. 454 | | DWG NO. 5B | |
| PROJ NO. BRS 0149(4) | | | | | REV. 1 | |
| CUSTOMER: VT AOT | | | | | | |