

ROOF FRAMING & UPPER BRACING PLAN

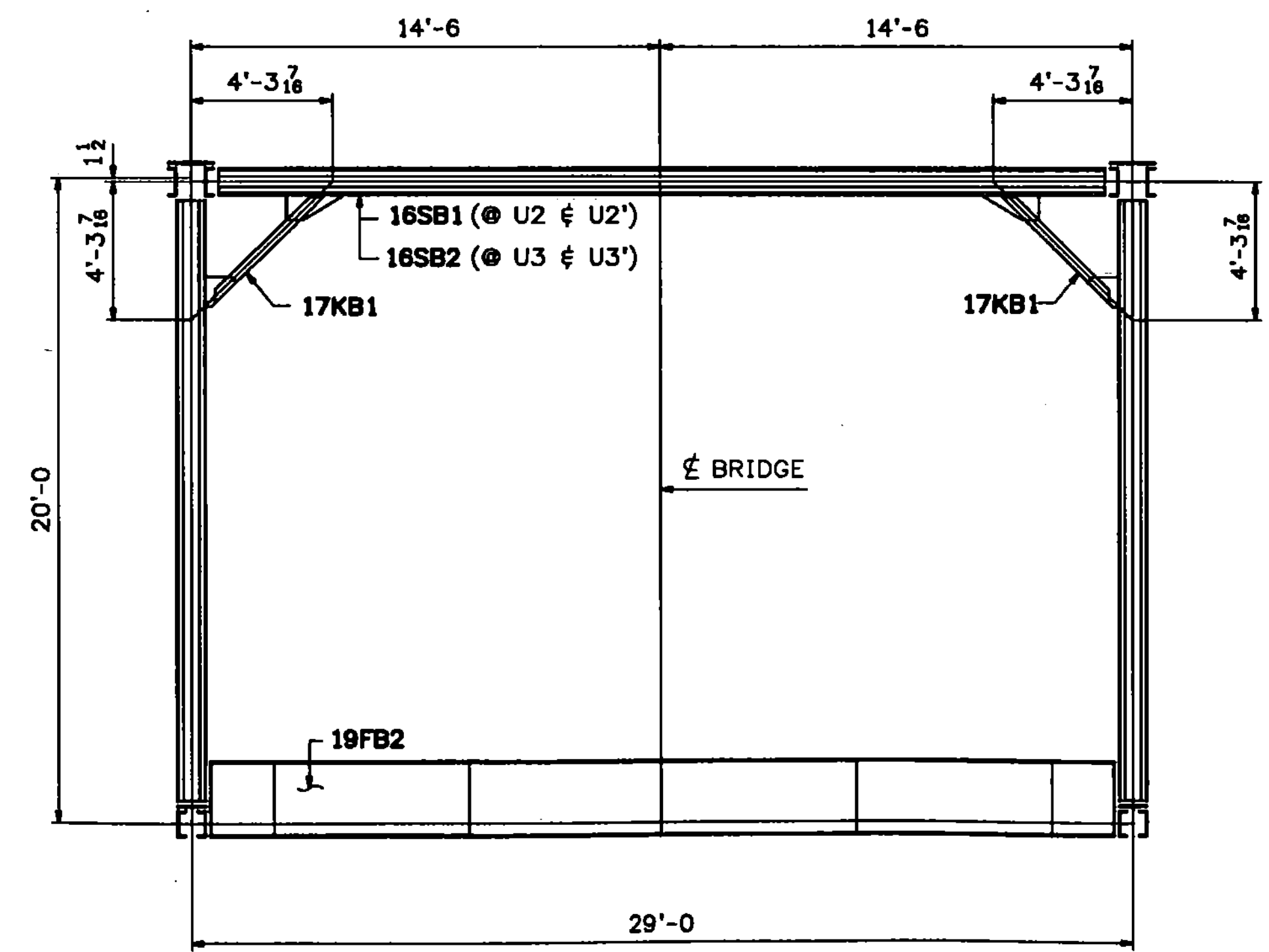

SECTION -A  
(ON E1)  
SWAY BRACE  
(STRINGERS NOT SHOWN FOR CLARITY)

Vermont Agency of Transportation  
**RECEIVED**  
CK'D BY TCF OK'D BY SSS  
7:43 am, Apr 12, 2011  
RESUBMIT APPROVED X  
BY KMH DATE 4-12-11

WORK THIS DWG. WITH DWG. E1, E2 & E4

03/09/11	RESUBMIT FOR APPROVAL	JM	PWR			
0						
REV.	DATE	REMARKS	DWN	CHK	APVL	SHOP
MATERIAL:		SURFACE PREP. & PAINT:		HOLES:		SHOP BOLTS:
DESCRIPTION: ROOF FRAMING PLAN & SWAY BRACES						
CASCO BAY STEEL STRUCTURES, INC.						
75 SPRING HILL ROAD SACO, MAINE 04072						
PHONE (207) 282-7360 FAX. (207) 282-1179						
STRUCTURE: Vermont Route 100A		DRAWN: RB		DATE: 10/11/10		
Bridge No. 14		CHKD: WJL		DATE: 10/19/10		
Bridgewater		JOB NO. 454		DWG NO. E3		
County of Windsor		CUSTOMER: VT AOT		REV. A		