

100.00
 DIST. NO. 18711
 1 OF 2
 3.02.1928

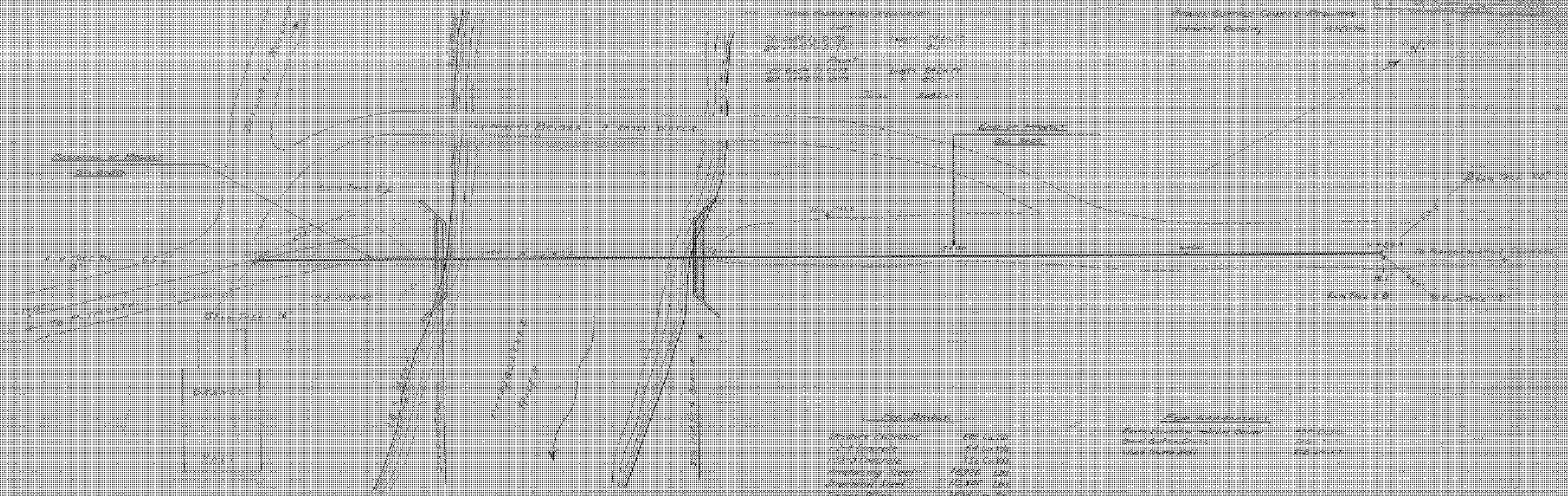

WOOD GUARD RAIL REQUIRED
 LEFT
 STA 0+50 TO 0+70 Length 20 Lin. Ft.
 STA 1+43 TO 2+73 " 80 "
 RIGHT
 STA 0+54 TO 0+78 Length 24 Lin. Ft.
 STA 1+43 TO 2+73 " 80 "
 Total 208 Lin. Ft.

GRAVEL SURFACE COURSE REQUIRED
 Estimated Quantity 125 Cu Yds

For Bridge
 Structure Excavation 600 Cu Yds.
 1-2-4 Concrete 64 Cu Yds.
 1-2-3 Concrete 336 Cu Yds.
 Reinforcing Steel 18,920 Lbs.
 Structural Steel 112,500 Lbs.
 Timber Piling 2875 Lin. Ft.

For Approaches
 Earth Excavation including Borrow 430 Cu Yds.
 Gravel Surface Course 125 " "
 Wood Guard Rail 208 Lin. Ft.

- SHEET No. 1 PLAN AND PROFILE STA 0+00 TO 4+84
- " 2 TYPICAL CROSS SECTION 2-4
- " 3 SUPERSTRUCTURE (5 B 20-110-6 1/2')
- " 4-B SUBSTRUCTURE
- " 9 TYPICAL DETAILS FOR STEEL BRIDGES.
- " 10-11 CROSS SECTIONS.

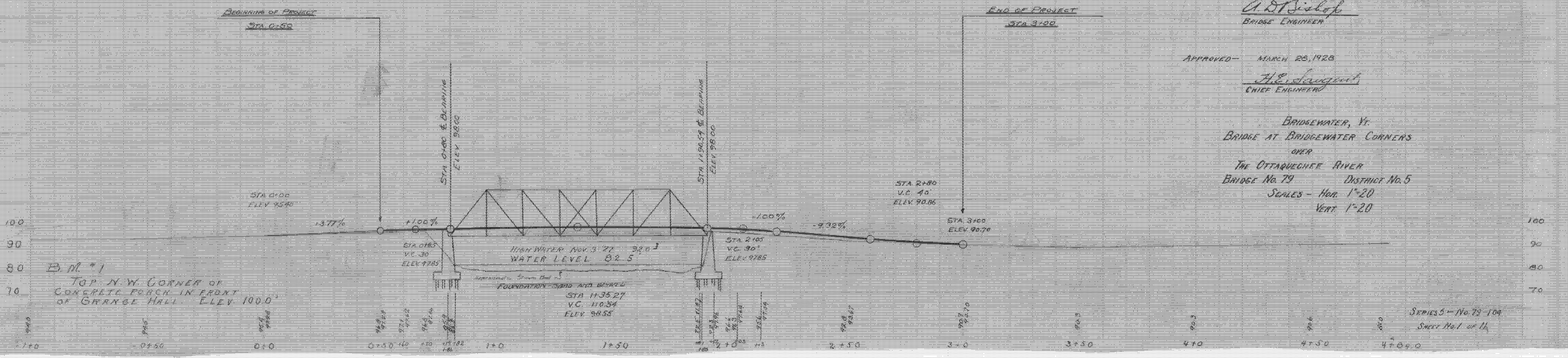

CORRECT
 A. D. Sislop
 BRIDGE ENGINEER

APPROVED - MARCH 25, 1928
 H. E. Sargent
 CHIEF ENGINEER

BRIDGEWATER, VT.
 BRIDGE AT BRIDGEWATER CORNERS
 OVER
 THE OTTAQUECHEE RIVER
 BRIDGE No. 79 DISTRICT No. 5
 SCALES - HOR. 1"=20'
 VERT. 1"=20'

SERIES 5 - No. 79-109
 SHEET No. 1 of 14