

SEE SHEET 2 FOR
INDEX OF SHEETS

STATE OF VERMONT AGENCY OF TRANSPORTATION



PROPOSED IMPROVEMENT BRIDGE PROJECT TOWN OF BRIDGEWATER COUNTY OF WINDSOR

VT. ROUTE 100A, BR14 - MAJOR COLLECTOR

RECORD PLANS	
CONTRACTOR:	MILLER CONSTRUCTION, INC - WINDSOR, VT
RESIDENT ENGINEER:	CHRIS BARKER
CONSTRUCTION BEGAN:	JUNE 25, 2010
CONSTRUCTION COMPLETE:	JULY 6, 2012
RECORD PLANS BY:	CHRIS BARKER & STEVE KENT
I HEREBY CERTIFY THAT ALL THE CONSTRUCTION REQUIRED BY THIS SET OF DRAWINGS HAS BEEN ACCOMPLISHED AS INDICATED HEREIN.	
BY:	RESIDENT ENGINEER
DATE:	09/09/13
NOTE: Any further information concerning final quantities, amounts or other details relative to this project may be found at Central Files in the electronic archives.	

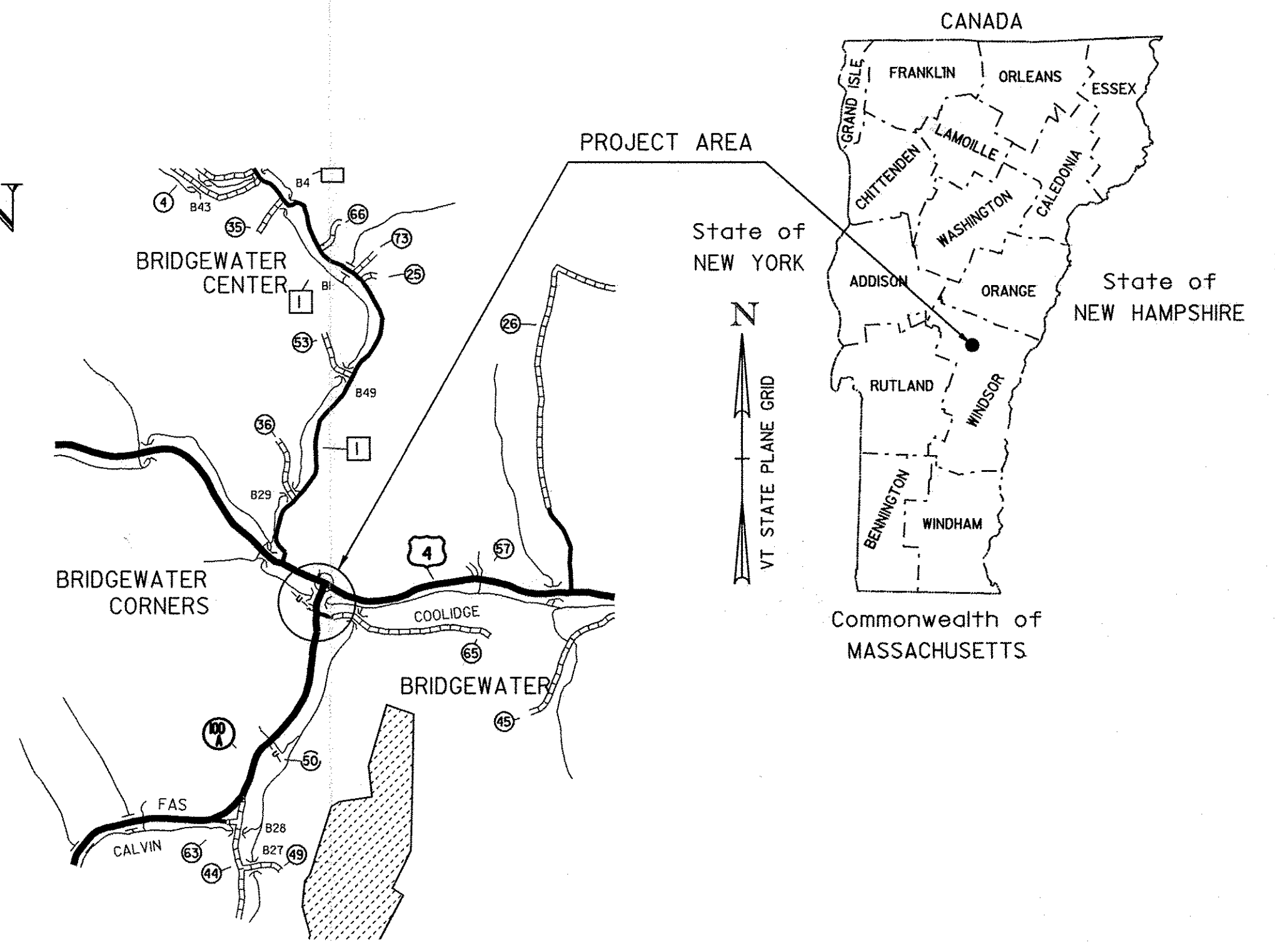

Project Location: Beginning at a point on Vt. Route 100A, approximately 650 feet south of the intersection of Vt. Route 100A and US Route 4, and extending northerly along Vt. Route 100A for approximately 250 ft.

Project Description: Work to be done under this project includes rehabilitation of the existing steel truss bridge, necessary roadway, channel and guardrail approach work and removal of existing temporary bridge, detour pavement and regrading area.

LENGTH OF STRUCTURE	115.54 FT	(0.022 MILES)
LENGTH OF ROADWAY	134.46 FT	(0.045 MILES)
LENGTH OF PROJECT	250.00 FT	(0.067 MILES)

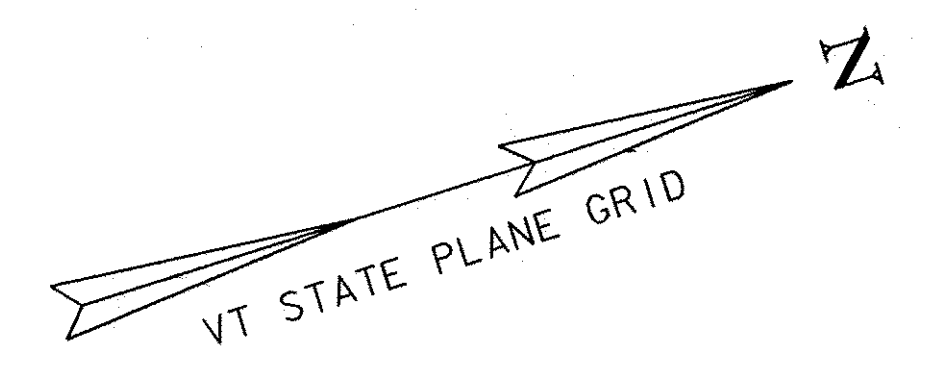
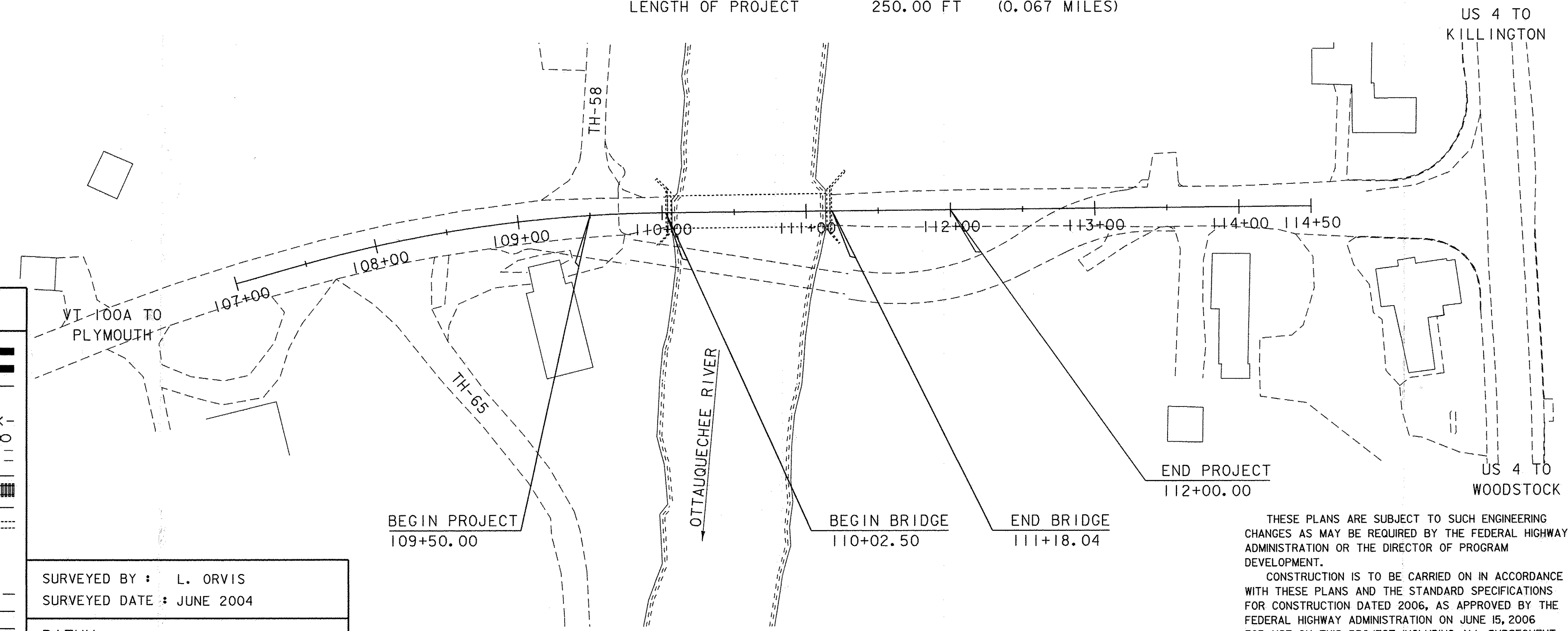

CONVENTIONAL SYMBOLS	
COUNTY LINE	
TOWN LINE	
LIMITS OF ACCESS	
POINT OF ACCESS	
FENCE LINE	
STONE WALL	
TRAVELED WAY	
GUARD RAIL	
RAILROAD	
SURVEY LINE	
CULVERT	
POWER POLE	
TELEPHONE POLE	
TREES	
CONTROL OF ACCESS	
PROPERTY LINE	
R.O.W. TAKING LINE	
SLOPE RIGHTS	
TOP OF CUT	
TOE OF SLOPE	

SURVEYED BY : L. ORVIS
SURVEYED DATE : JUNE 2004

DATUM
VERTICAL NAVD 88
HORIZONTAL NAD 83 (86)

SCALE 1" = 50' - 0
50 0 50

THESE PLANS ARE SUBJECT TO SUCH ENGINEERING CHANGES AS MAY BE REQUIRED BY THE FEDERAL HIGHWAY ADMINISTRATION OR THE DIRECTOR OF PROGRAM DEVELOPMENT.

CONSTRUCTION IS TO BE CARRIED ON IN ACCORDANCE WITH THESE PLANS AND THE STANDARD SPECIFICATIONS FOR CONSTRUCTION DATED 2006, AS APPROVED BY THE FEDERAL HIGHWAY ADMINISTRATION ON JUNE 15, 2006 FOR USE ON THIS PROJECT, INCLUDING ALL SUBSEQUENT REVISIONS AND SUCH REVISED SPECIFICATIONS AND SPECIAL PROVISIONS AS ARE INCORPORATED IN THESE PLANS.

86e062/se062111e.dgn se062111e.j

DIRECTOR OF PROGRAM DEVELOPMENT	
APPROVED	DATE 12-29-09
PROJECT MANAGER : KRISTIN HIGGINS	
PROJECT NAME : BRIDGEWATER	
PROJECT NUMBER : BRS 0149 (4)	
SHEET 1 OF 58 SHEETS	