

TRANSVERSE FIELD SPLICE DETAIL 1

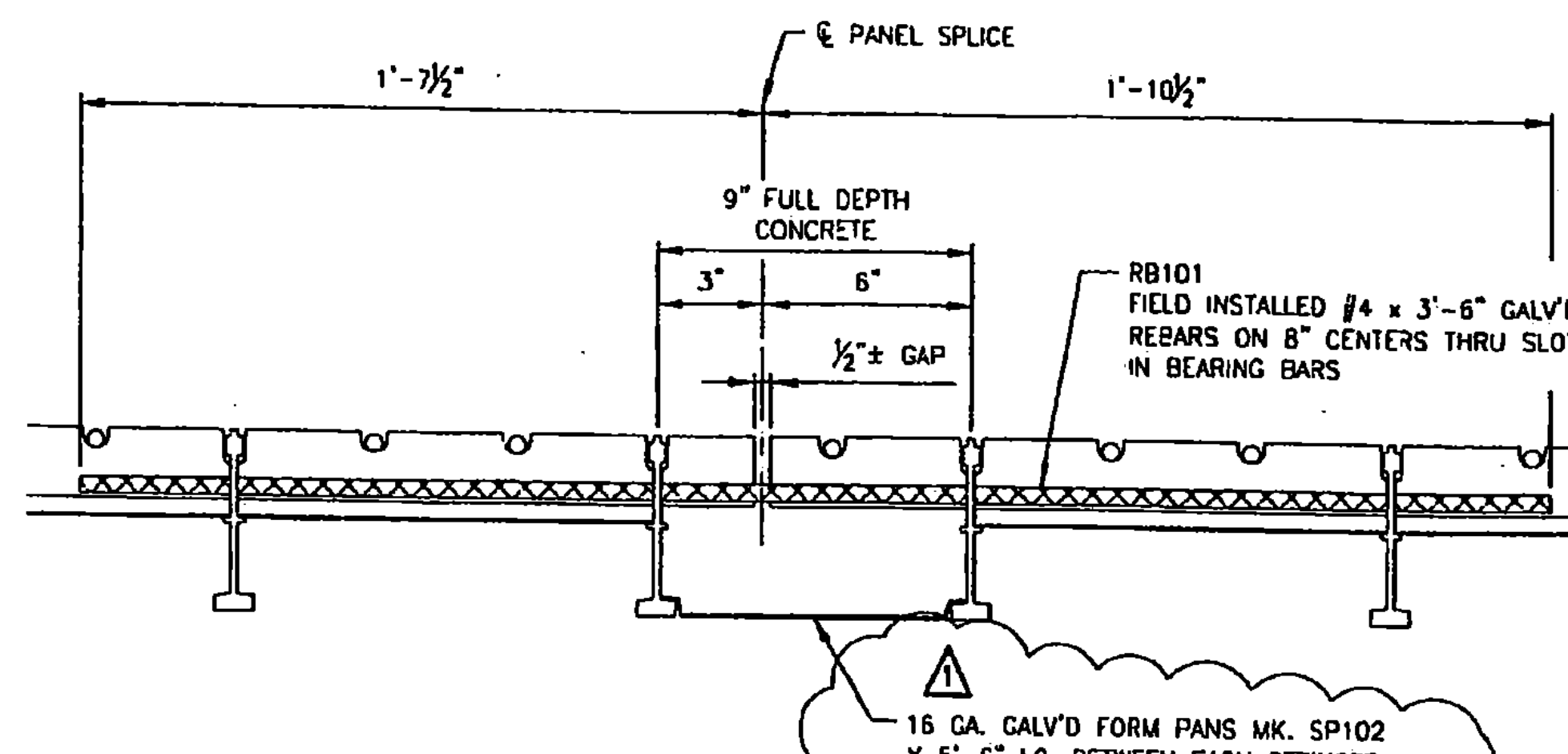

TRANSVERSE FIELD SPLICE DETAIL 2

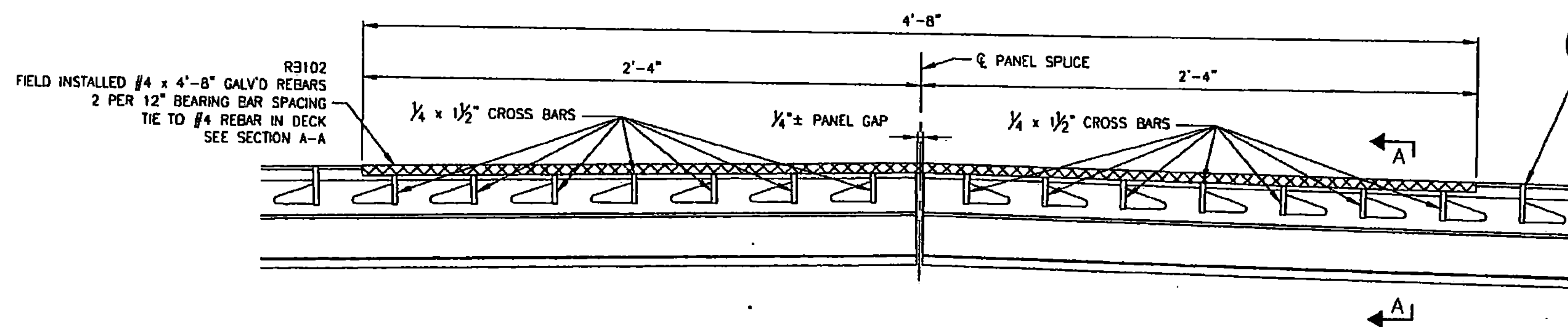

TYPICAL LONGITUDINAL FIELD SPLICE DETAIL @ C.L. BRIDGE

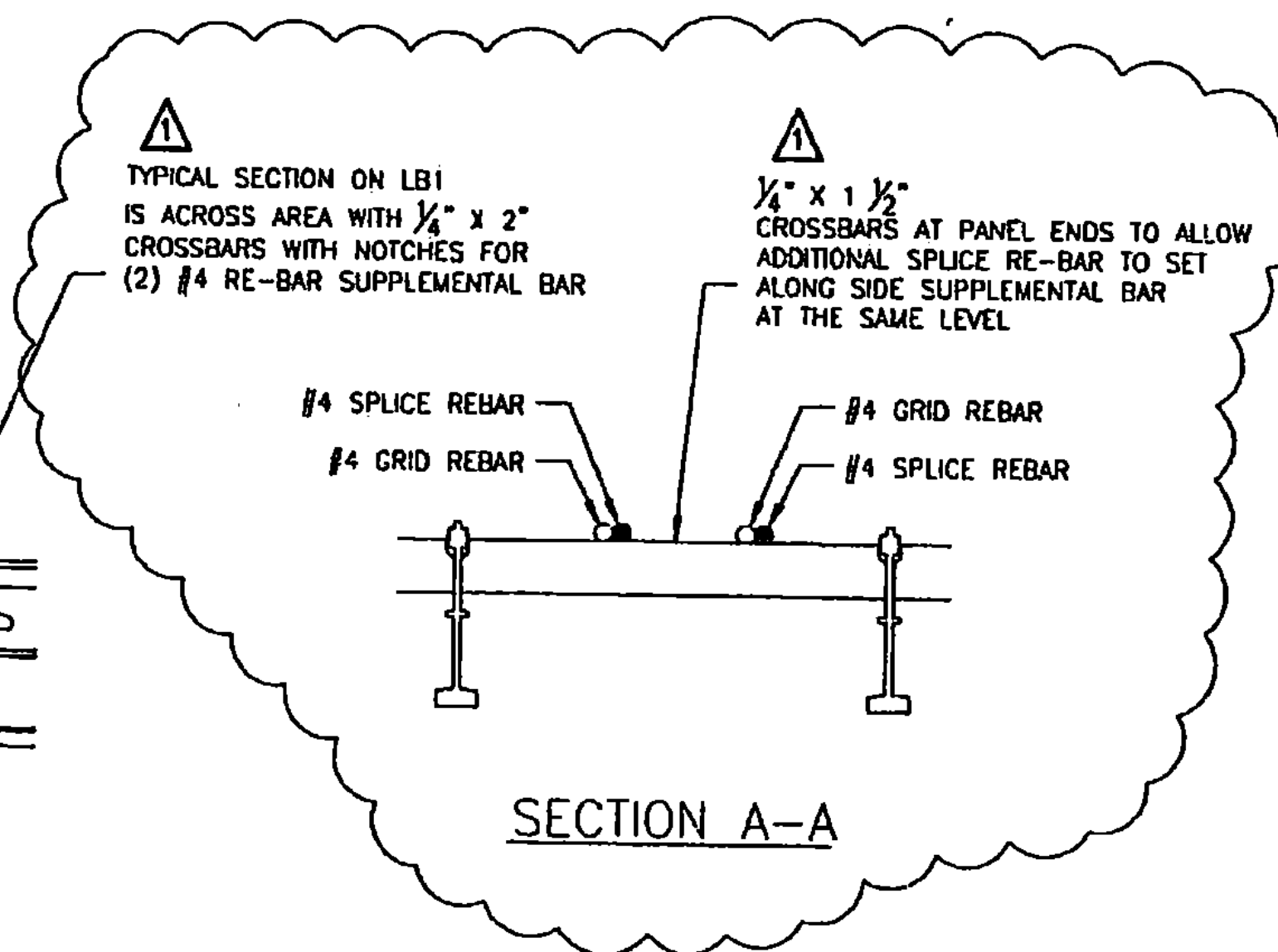

SECTION A-A

RECEIVED
 OK'D BY JLJ OK'D BY _____
 JAN 17 2011

RESUBMIT _____ APPROVED
 BY KMH DATE 1/20/11

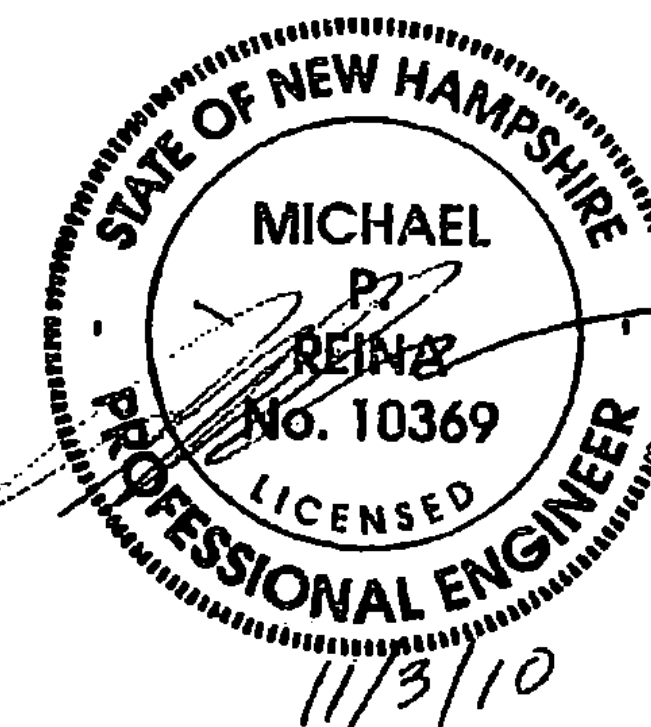

APPROVED:	DATE:
L. B. FOSTER CO. GENERAL OFFICE	
PITTSBURGH, PENNSYLVANIA 15220	
FOR: MILLER CONSTRUCTION	
STATE OF VERMONT AGENCY OF TRANSPORTATION	
TOWN OF BRIDGEWATER, COUNTY OF WINDSOR	
VT. ROUTE 100A, BR14 PROJ. NO. BRS 0149 (4)	
FIELD SPLICE DETAILS	
ISSUED WPO DATE 8/18/10	JOB NO. SD0339
ISSUED RLP DATE 9/11/10	DATE LBEJ
REV. NO.	1

REV.	DESCRIPTION	BY	DATE	CHK'D	DATE
1	REVISED PER APPROVER'S COMMENTS	B L J	10/28/10		

184 PREFAB DECK PANELS