

STRUCTURAL
147 STEEL

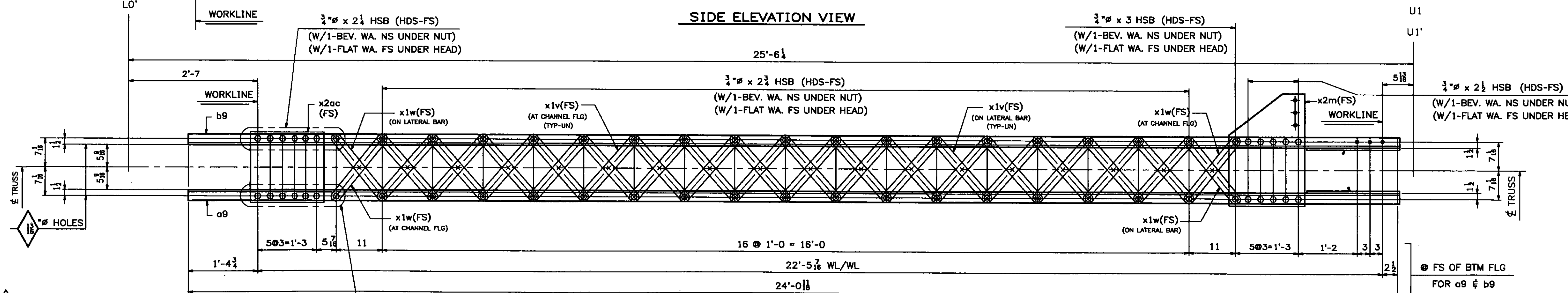
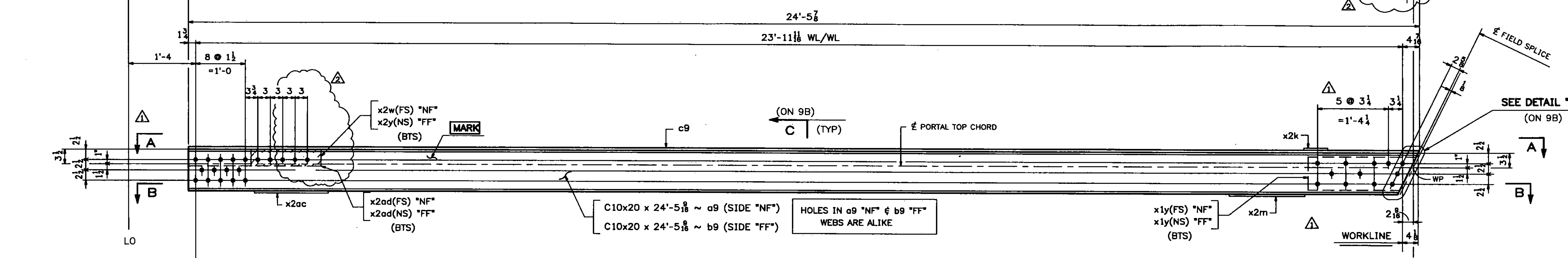
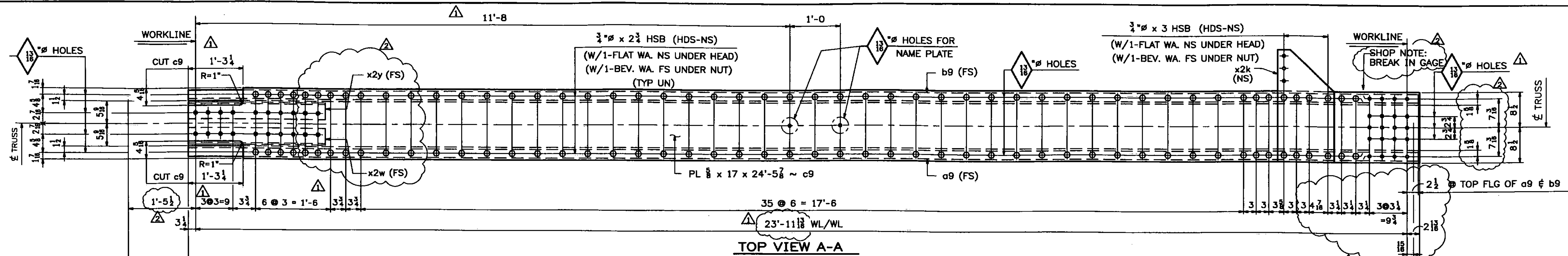

Vermont Agency of Transportation

RECEIVED

CK'D BY TCF OK'D BY SSS

7:43 am, Apr 12, 2011

RESUBMIT APPROVED X
BY KMH DATE 4-12-11

ONE - PORTAL TOP CHORD - 9D1E (LO-U1 EAST)
ONE - PORTAL TOP CHORD - 9D9W (LO-U1 WEST)

ALIKE EXCEPT FOR MARK

SHOP NOTE:
ALL STEEL FOR PORTAL TOP CHORD ASSEMBLIES SHALL BE GALVANIZED

- NOTES:
- FOR GENERAL NOTES SEE DWG. GN1.
 - FOR STANDARD DETAILS SEE DWG. X1 & X2.
 - "NF" - DENOTES NEAR FACE OF ASS'Y.
 - "FF" - DENOTES FAR FACE OF ASS'Y.
 - "BF" - DENOTES BOTH FACES OF ASSEMBLY.
 - ALL BOLTS SHALL BE FULLY TORQUED (UN).
 - BTS - DENOTES BOLT TO SHIP OR SECURE FOR SHIPMENT.
 - HDS - DENOTES BOLT HEADS.

REV.	DATE	REMARKS	DWN	CHK	APVL	SHOP
03/23/11		REVISED AS PER APPROVAL COMMENTS	JM	PWR		
03/02/11		REVISED AS PER APPROVAL COMMENTS	JM	PWR		
0						

WORK THIS DWG. WITH DWG. 9B.

MATERIAL:	M270-50 (U.N.)	SURFACE PREP. & PAINT:	SEE DWG GN1	HOLES:	1/8" (U.N.)	SHOP BOLTS:	AS NOTED
DESCRIPTION:	PORTAL TOP CHORD 9D1E & 9D9W						
CASCO BAY STEEL STRUCTURES, INC. 75 SPRING HILL ROAD SACO, MAINE 04072 PHONE (207) 282-7360 FAX. (207) 282-1179							
STRUCTURE:	Vermont Route 100A Bridge No. 14 Bridgewater County of Windsor	DRAWN:	RB	DATE:	9/30/10	CHKD:	WJL
LOCATION:	BRIDGEWATER, VERMONT	JOB NO.	454	DWG NO.	9AB	REV.	
PROJ NO.	BRS 0149(4)	CUSTOMER:	VT AOT				