

112 STRUCTURAL STEEL

ERECTOR NOTE:
INSTALL AND TIGHTEN WEB BOLTS OF TOP CHORD BEFORE ENTERING FLANGE BOLTS

Vermont Agency of Transportation

RECEIVED

CK'D BY TCF OK'D BY SSS

7:43 am, Apr 12, 2011

RESUBMIT APPROVED X
BY KMH DATE 4-12-11

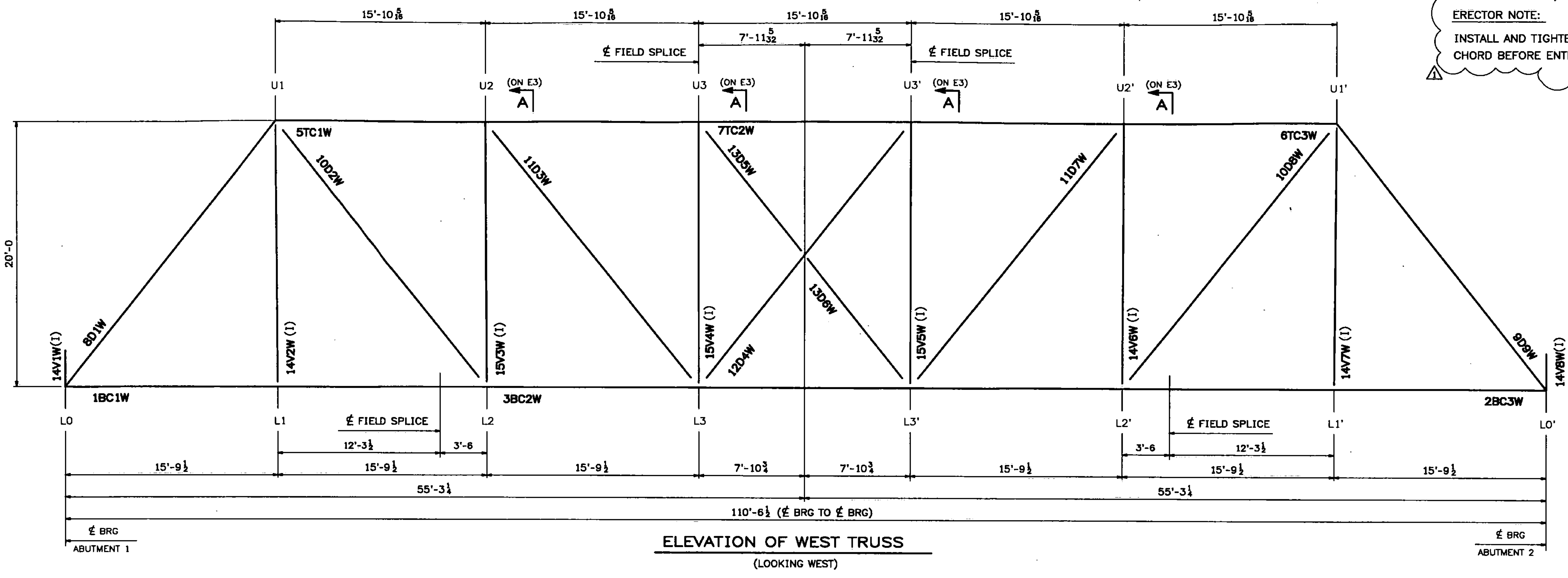

ELEVATION OF WEST TRUSS
(LOOKING WEST)

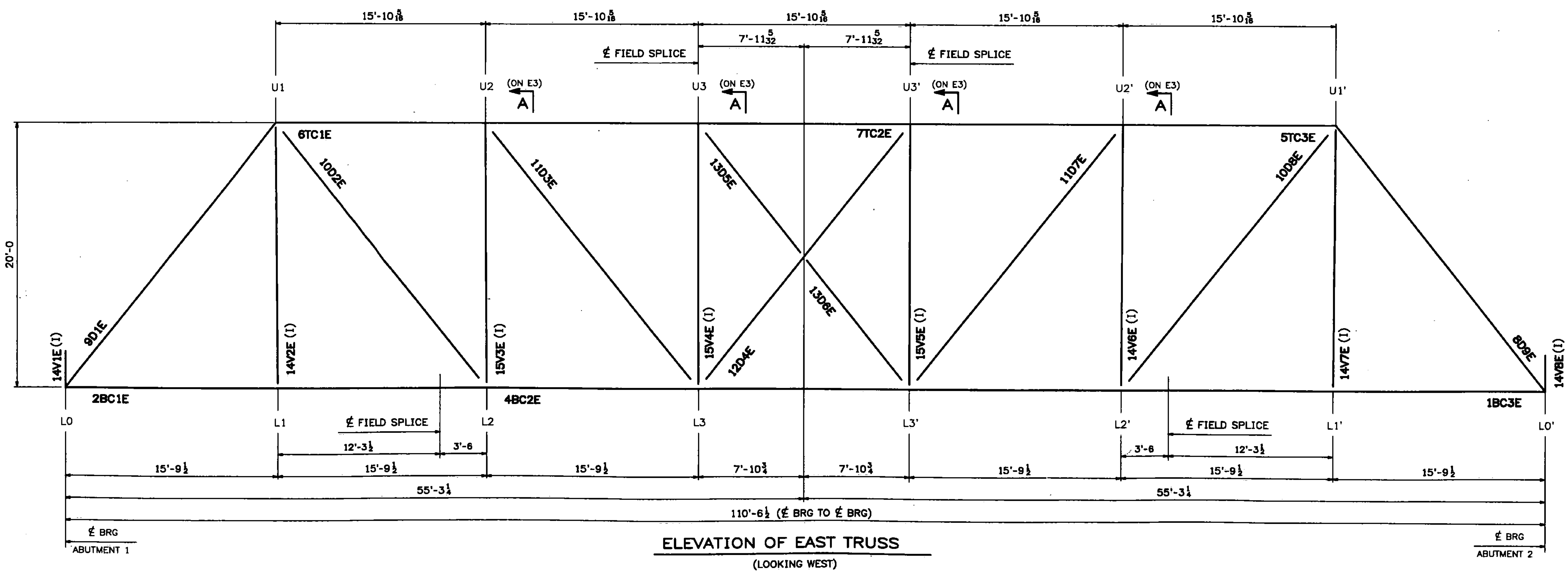

ELEVATION OF EAST TRUSS
(LOOKING WEST)

NOTE:
(1) INDICATES THAT THE SHIPPING MARK IS ON THE MEMBERS INNER FACE (FLOOR BEAM SIDE).

NOTES:
1. ALL DIMENSIONS ARE GIVEN IN THE FINAL POSITION OF BRIDGE.
2. FOR GENERAL NOTES SEE DWG. GN1.

WORK THIS DWG. WITH DWG. E2, E3 & E4

REV.	DATE	REMARKS	DWN	CHK	APVL	SHOP
0	02/25/11	ADDED NOTE	JM	PWR		
MATERIAL:		SURFACE PREP. & PAINT:	HOLES:		SHOP BOLTS:	
DESCRIPTION: FRAMING AT WEST & EAST TRUSS ELEVATION						
CASCO BAY STEEL STRUCTURES, INC.						
75 SPRING HILL ROAD			SACO, MAINE 04072			
PHONE (207) 282-7360			FAX. (207) 282-1179			
STRUCTURE: Vermont Route 100A		DRAWN: RB		DATE: 10/11/10		
Bridge No. 14		CHKD: WJL		DATE: 10/19/10		
Bridgewater		JOB NO. 454		DWG NO. E1		
County of Windsor		CUSTOMER: VT AOT		REV. A		