

Any suitable structure excavation used by the contractor for any other purpose other than for backfill or approach fill shall be replaced by an equivalent quantity of borrow by the contractor at his own expense unless same is ordered wasted by the engineer.

All work and material shall conform to the Standard Road and Bridge Specifications of the Vermont Department of Highways 1926.

The elevation of the footings may be changed by the engineer to meet the foundation requirements found in the field.

Cost of labor and materials required for installation of 4" weep holes to be included in unit price bid for 1-2 1/2 concrete.

Furnishing and placing 1/2" premoled expansion material to be included in unit price bid for 1-2 1/2 concrete.

NOTE: If files are omitted, the elevations of top of footings shall be 2 feet below stream bed.

ALL CONCRETE IN THIS ABUTMENT TO BE CLASS B (1-2 1/2)

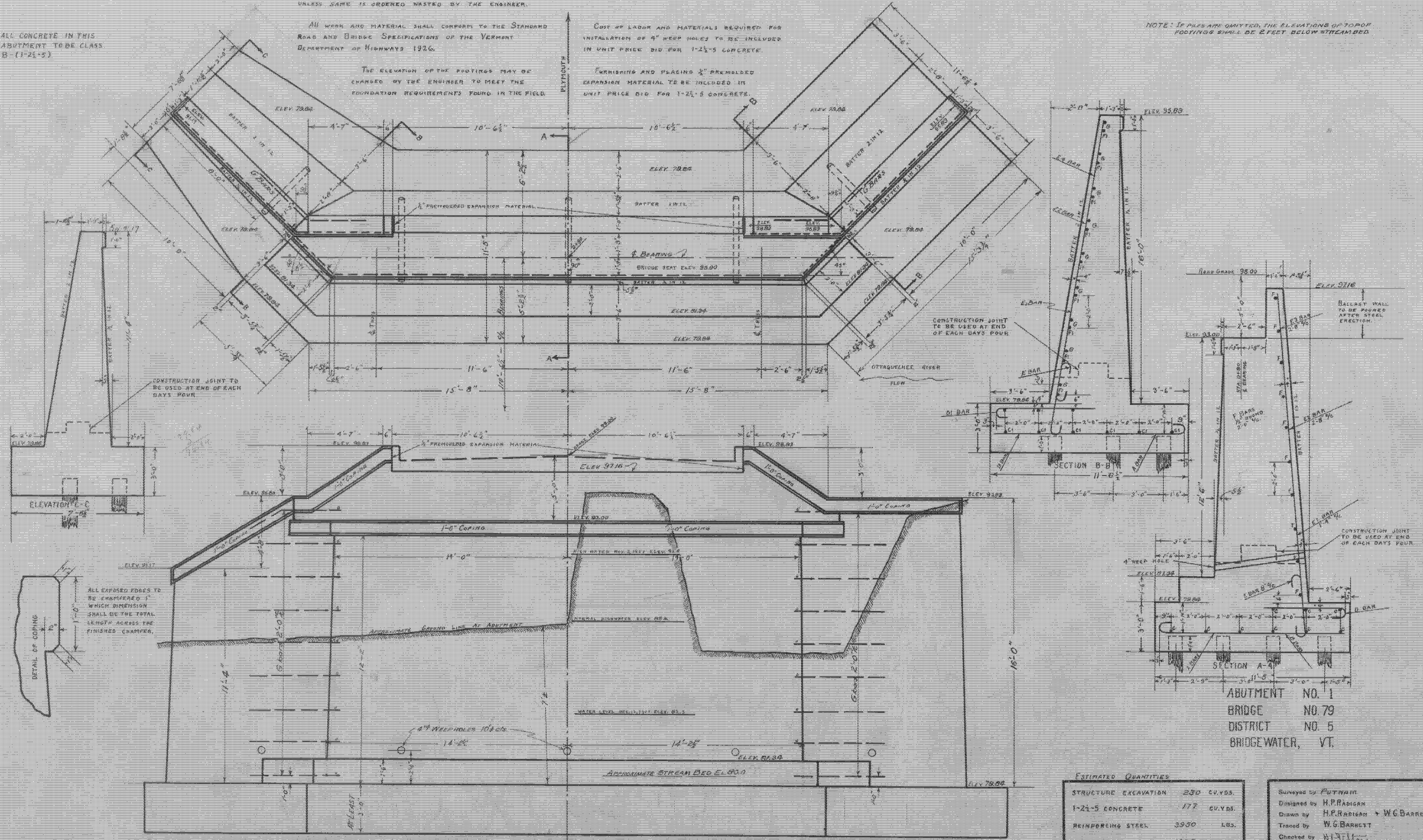

ABUTMENT NO. 1  
 BRIDGE NO. 79  
 DISTRICT NO. 5  
 BRIDGEWATER, VT.

Estimated Quantities

|                      |               |
|----------------------|---------------|
| STRUCTURE EXCAVATION | 230 CU. YDS.  |
| 1-2 1/2 CONCRETE     | 177 CU. YDS.  |
| REINFORCING STEEL    | 3930 LBS.     |
| TIMBER PILING        | 1425 LIN. FT. |

Surveyed by PUTNAM  
 Designed by H.P. RADIGAN  
 Drawn by H.P. RADIGAN + W.G. BARRETT  
 Traced by W.G. BARRETT  
 Checked by W. HILLMAN  
 Series 3 No. 79-109 Files  
 Sheet 4 of 11 Sheets