

STATE OF VERMONT AGENCY OF TRANSPORTATION

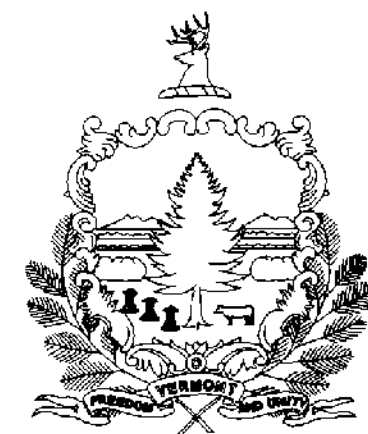

PROPOSED IMPROVEMENT BRIDGE PROJECT TOWN OF BRIDGEWATER COUNTY OF WINDSOR

VT. ROUTE 100A - MAJOR COLLECTOR

Project Location: Beginning at a point on Vt. Route 100A, approximately 630 feet south of the intersection of Vt. Route 100A and US Route 4, and extending northerly along Vt. Route 100A for approximately 300 ft.

Project Description: Work to be done under this project includes the installation of a temporary bridge along Vt. Route 100A, fill, grading, pavement, guardrails, signage, temporary traffic control, striping and approach work necessary to achieve this.

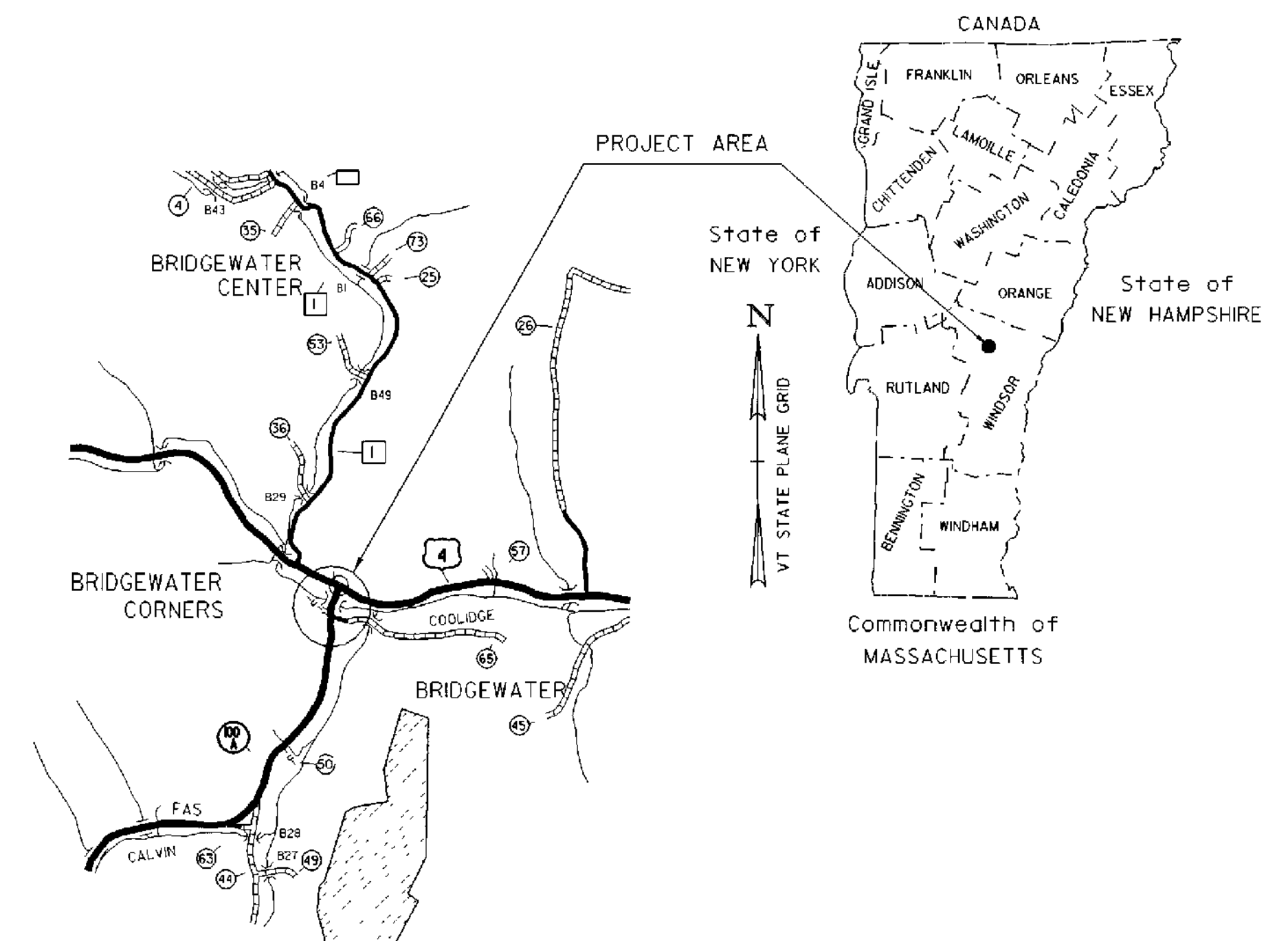

Length of Project = 300 ft
Length of Roadway = 143.5 ft
Length of Bridge = 156.5 ft

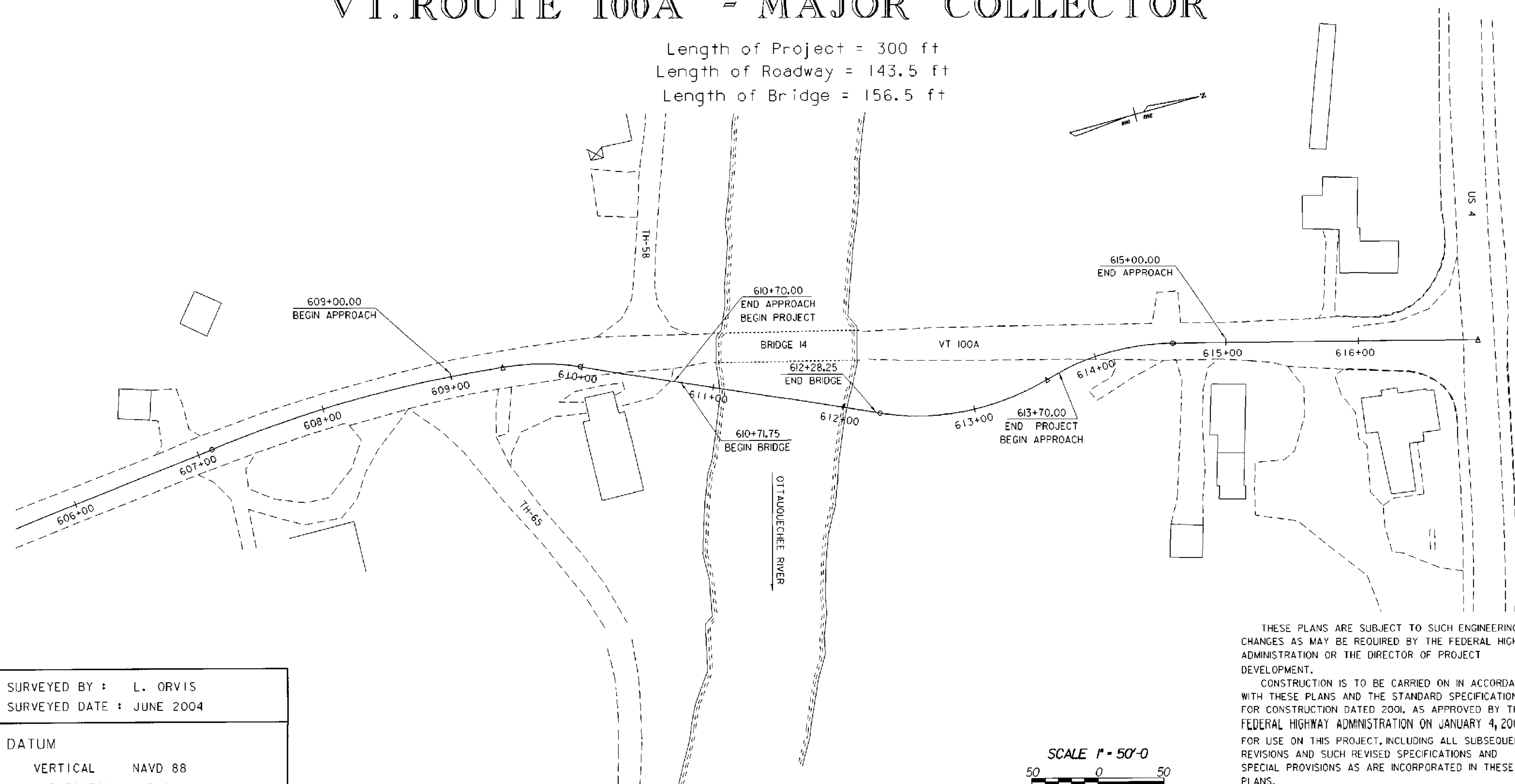

CONVENTIONAL SYMBOLS	
COUNTY LINE	
TOWN LINE	
LIMITS OF ACCESS	
POINT OF ACCESS	
FENCE LINE	
STONE WALL	
TRAVELED WAY	
GUARD RAIL	
RAILROAD	
SURVEY LINE	
CULVERT	
POWER POLE	
TELEPHONE POLE	
TREES	
CONTROL OF ACCESS	
PROPERTY LINE	
R.O.W. TAKING LINE	
SLOPE RIGHTS	
TOP OF CUT	
TOE OF SLOPE	

SURVEYED BY : L. ORVIS
SURVEYED DATE : JUNE 2004

DATUM
VERTICAL NAVD 88
HORIZONTAL NAD 91

THESE PLANS ARE SUBJECT TO SUCH ENGINEERING CHANGES AS MAY BE REQUIRED BY THE FEDERAL HIGHWAY ADMINISTRATION OR THE DIRECTOR OF PROJECT DEVELOPMENT.

CONSTRUCTION IS TO BE CARRIED ON IN ACCORDANCE WITH THESE PLANS AND THE STANDARD SPECIFICATIONS FOR CONSTRUCTION DATED 2001, AS APPROVED BY THE FEDERAL HIGHWAY ADMINISTRATION ON JANUARY 4, 2001 FOR USE ON THIS PROJECT, INCLUDING ALL SUBSEQUENT REVISIONS AND SUCH REVISED SPECIFICATIONS AND SPECIAL PROVISIONS AS ARE INCORPORATED IN THESE PLANS.

/PW/86e062/se062dt1.dgn se062dt1

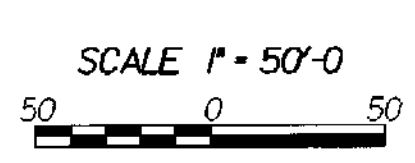

DIRECTOR OF PROJECT DEVELOPMENT	APPROVED _____ DATE _____
PROJECT MANAGER : CRAIG KELLER	
PROJECT NAME : BRIDGEWATER	PROJECT NUMBER : BRS 0149 (4)
SHEET 1 OF 18 SHEETS	