

ABUTMENT #1 FOOTING REINFORCING PLAN

SCALE 1/4" = 1'-0"  
 0 2 4 6

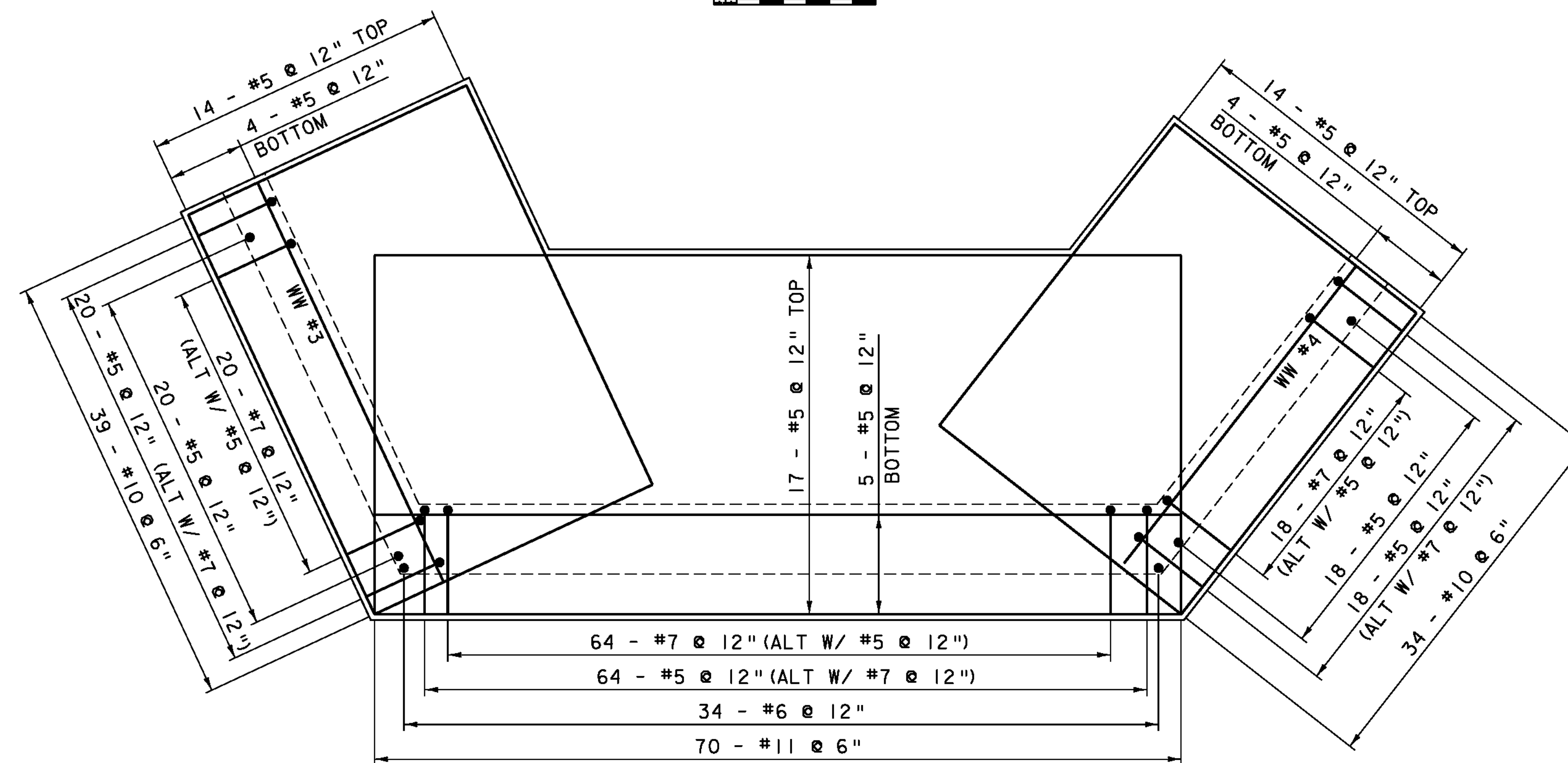

ABUTMENT #2 FOOTING REINFORCING PLAN

SCALE 1/4" = 1'-0"  
 0 2 4 6

NOTE:  
 CONTRACTOR IS RESPONSIBLE FOR DETERMINING THE LENGTHS AND REINFORCING BAR BENDS BASED ON THESE DRAWINGS. ALL LAP LENGTHS SHALL BE AT LEAST THE LENGTH SPECIFIED BELOW:

- #5 - 2'-2"
- #6 - 2'-7"
- #7 - 3'-5"
- #8 - 4'-6"
- #9 - 5'-8"
- #10 - 7'-3"
- #11 - 8'-10"

NOTE:  
 NF = NEAR FACE  
 FF = FAR FACE  
 EF = EACH FACE  
 ▲ = CUT TO FIT IN FIELD  
 3" CLEAR, UNLESS OTHERWISE SPECIFIED ON THE PLANS.  
 2'-2" BAR LAP UNLESS OTHERWISE SPECIFIED ON THE PLANS.

PROJECT NAME: BRIDGEWATER  
 PROJECT NUMBER: BRS 0149(4)

FILE NAME: s86e062sub.dgn  
 PROJECT LEADER: K. HIGGINS  
 DESIGNED BY: T. FILLBACH  
 FOOTINGS

PLOT DATE: 31-DEC-2009  
 DRAWN BY: R. PELLET  
 CHECKED BY: T. FILLBACH  
 SHEET 39 OF 58