

75 - BITUMINOUS CONCRETE PAVEMENT  
 380 - SUBBASE OF CRUSHED GRAVEL (COARSE GRADED)

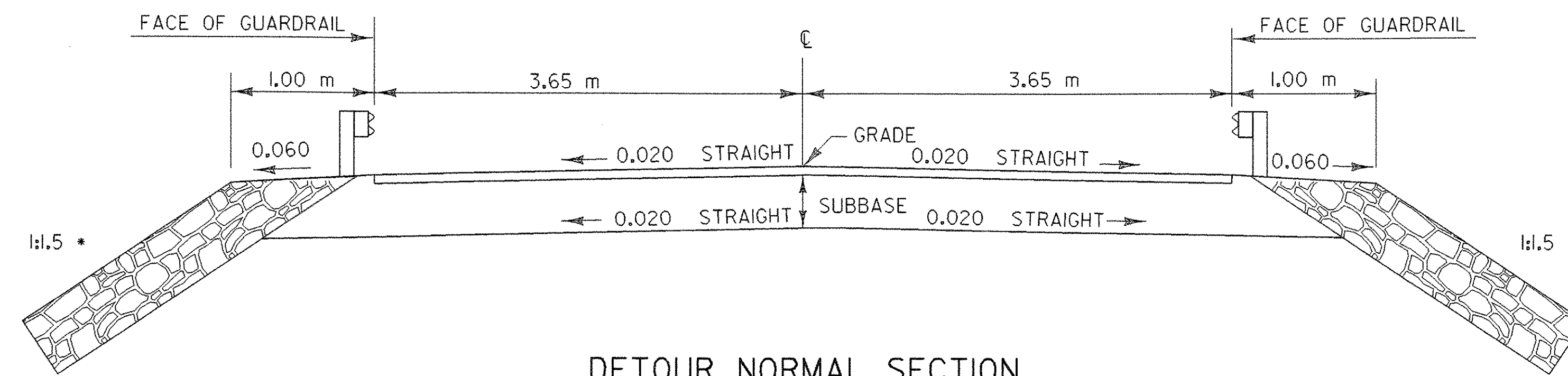

\* Note: Any slopes steeper than 1:2 shall be blanketed with 600 mm stone fill, type II.

DETOUR NORMAL SECTION  
 WITH GUARDRAIL  
 NOT TO SCALE

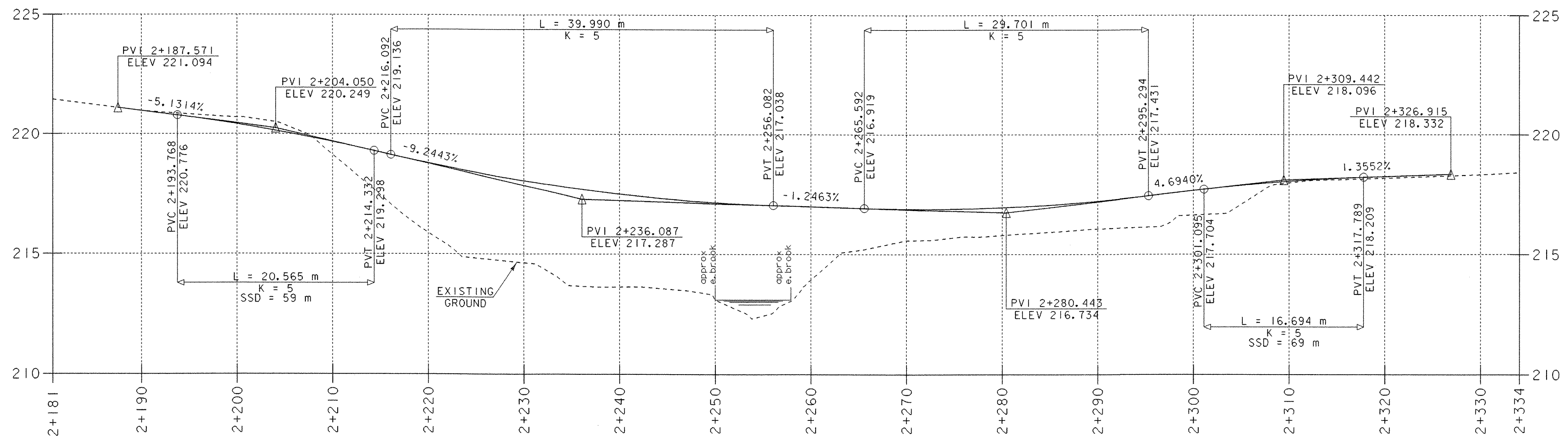

THE GRADES SHOWN TO THE NEAREST HUNDREDTH ARE THE ORIGINAL GROUND ELEVATIONS ALONG THE PROPOSED ALIGNMENT. THE GRADES SHOWN TO THE NEAREST THOUSANDTH ARE THE PROPOSED GRADES FOR THE NEW ALIGNMENT.

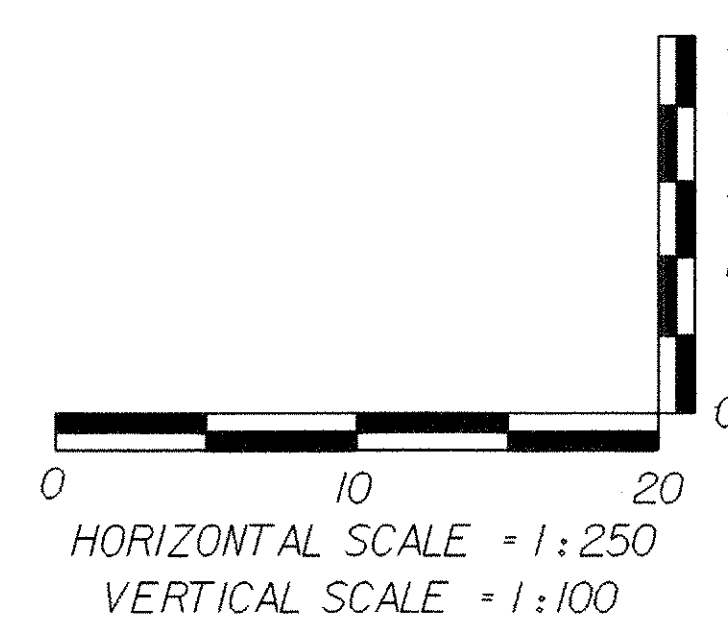

**DETOUR PROFILE (40 KPH)**

PROJECT NAME: DUXBURY	PLOT DATE: 20-OCT-2005
PROJECT NUMBER: STP 013-4(24)	DRAWN BY: Graw
FILE NAME: /str5/86e059/se059xsl.dgn	CHECKED BY: T. SUMNER
PROJECT LEADER: C. KELLER	SHEET 15 OF 62
DESIGNED BY: B. NYQUIST	